



DIB
Special Edition

OWNER'S MANUAL





PRODUCT INFORMATION

Safety Precautions.....4
Product Features.....8
Unit & Parts.....10
Dimensions.....12
Remote Control.....13

PRODUCT INSTALLATION

Installation.....14
Remote Control Installation.....16
Trial Operation.....18
Product Disassembly.....19
Operation.....22

TROUBLESHOOTING

Settings.....30
Maintenance & Cleaning.....34
Specifications.....36
Troubleshooting.....37
Warranty.....38



PLEASE OBSERVE THE FOLLOWING PRECAUTIONS AND INSTRUCTIONS BEFORE INSTALLATION AND USE.

- This product must be connected to a grounded 120V GFCI (ground fault circuit interrupt) outlet. Do not connect the power cord if it is damaged or broken. Do not plug the product into a loose electrical outlet.
- It is recommended to use this product on a dedicated circuit. Sharing a dedicated circuit could cause the breaker to trip or lights to flicker.
- If it is necessary to use an extension cord, use only a three-pronged extension cord plugged into a proper GFCI outlet. The marked rating of the extension cord should be equal to or greater than the electrical rating of the unit (10 amp). Consult a qualified electrician or service person if you are not sure whether the unit is properly grounded.
- Do not open this product for repair without authorization from the manufacturer. Only qualified service personnel should service this product. Do not use accessories not recommended by the manufacturer.
- Connect this product to a potable cold water supply line.
- Close supervision is necessary when this product is used by children, elderly, or adults with sensitive skin. A low-temperature burn may occur when the skin has been in contact with an object at relatively low temperature for an extended period of time.
- If using any chemical toilet bowl cleaner, be sure to wipe up any spills that splash onto the bidet. Do not use benzene or any acid chemical detergent, as they can cause discoloration. Only neutral detergents are permitted.
- Do not plug in the power cord before connecting the water supply hose.
- Install in an area with adequate ventilation to avoid high levels of humidity, which can damage the electronic components.
- Do not touch the power cord with wet hands or reach for a product that has fallen into water. Unplug immediately.

- Unplug the bidet seat when cleaning or detaching from the toilet bowl.
- Do not plug in until plumbing work has been completed.
- Keep the power cord away from heated surfaces to prevent a fire hazard. Keep any flammable materials away from this product at all times.



DIB Bidet has the following characteristics:

Continuous Warm Water Supply

Enjoy continuous warm water throughout the wash cycle.



Bubble Wash

Aerated water wash adds cleaning comfort.



Pulse & Oscillate

Pulsating wash repeatedly cycles from weak to strong. Nozzle moves back and forth for massage effect.



Energy Saving Function

When activated, Energy Saving Mode will set the heaters to a lower temperature to reduce energy consumption.



Touch Panel Remote Control

Convenient touch screen remote control provides easy user interface.



Vortex Wash

Soft but powerful water wash for added cleansing benefit.



Stainless Steel Nozzle

For better hygiene, a stainless steel nozzle is applied.



Deodorization Function

Deodorizing filter eliminates odors efficiently.

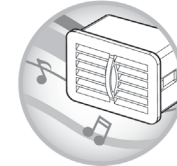

Child Settings

Optimized nozzle position and water pressure for children.



User Preset

User can preset and store the memory for control settings.



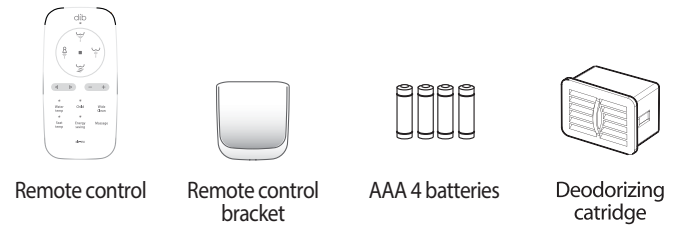
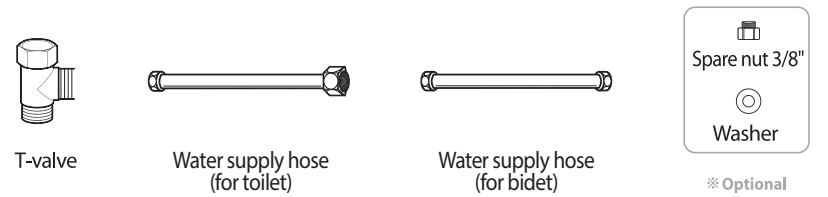
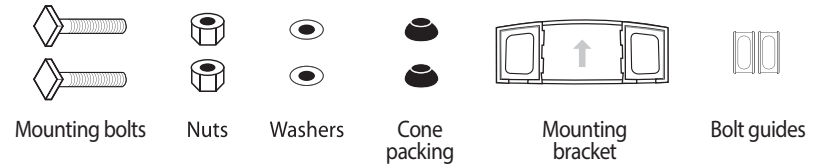
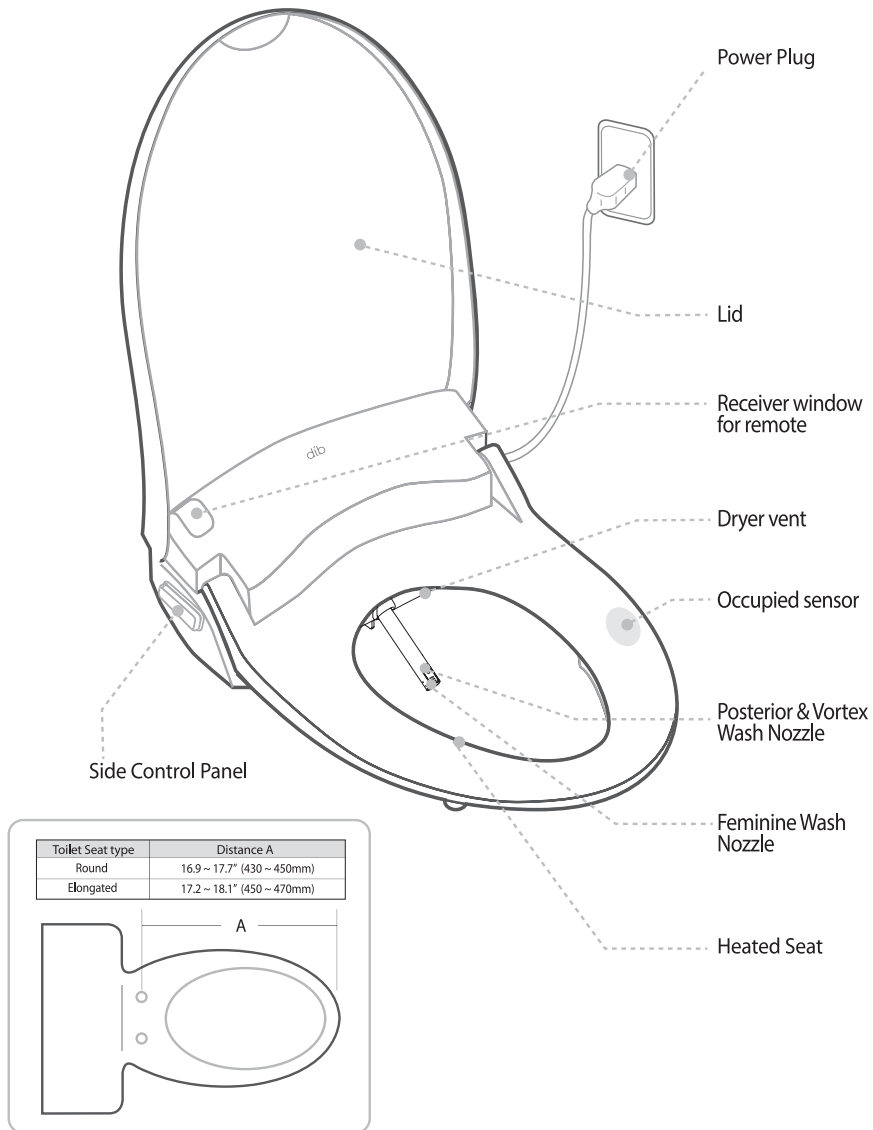



Elongated

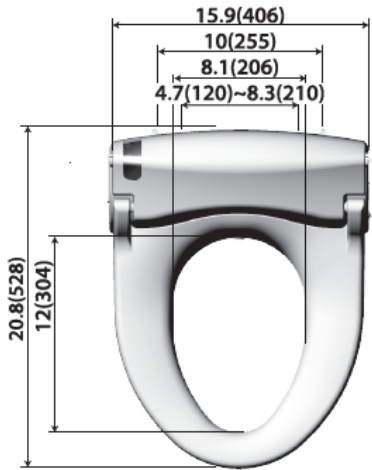

Round

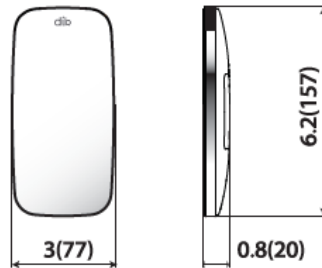
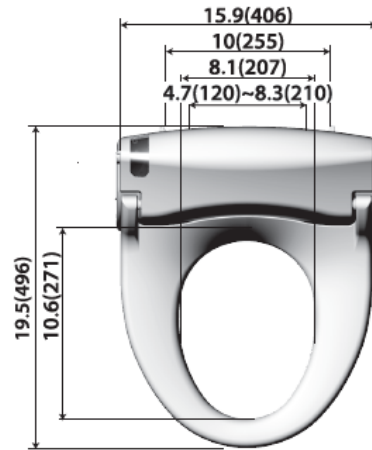

USER PRESET

User can preset and store the memory for control setting



ACTIVATING INDICATOR

FEMININE

To run the function (2 min. auto Shut-off)

DRY

To run the dry function (3 minutes)

NOZZLE CONTROL

To control the nozzle position

WATER TEMP

To adjust the water temp. by 4 steps (Low/Mid/High)

CHILD

children safety mode.

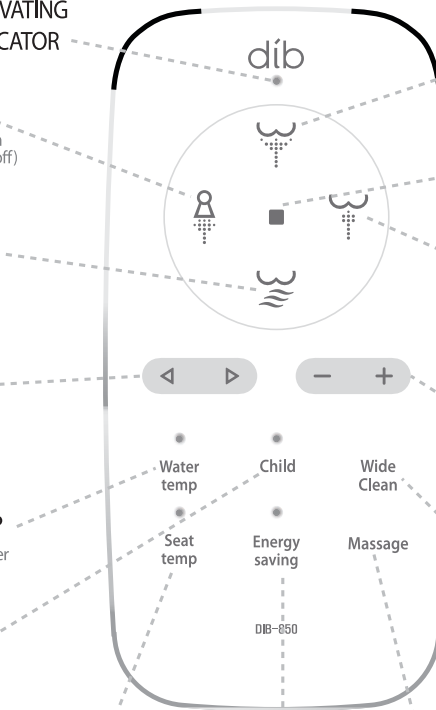

POSTERIOR

To run the function (2 min. auto Shut-off)

STOP

To stop all functions.

VORTEX WASH

To run the wash (2 min. auto Shut-off)

POWER CONTROL

Water pressure and dryer temp adjustment.

WIDE CLEAN (OSCILLATION)

Nozzle moves back and forth for wider cleansing. (Not in Vortex mode) Press again to stop.

SEAT TEMP

To adjust the seat temp. by 4 steps (Low/Mid/High)

ENERGY SAVING

MASSAGE (PULSE)

To run the Massage(Pulse) function during Posterior/Feminine/Vortex wash. Water pressure is rhythmically changed from strong to weak.



1. Toilet Seat Removal



- Lift hinge covers and use a screwdriver to remove the mounting bolts.
- Remove the toilet seat. Steps may vary by type of seat.

2. Turn Off Shut-Off Valve

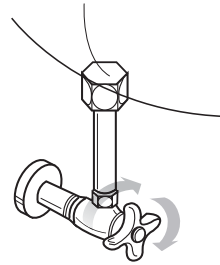

- Turn shut-off valve completely.
- Flush toilet and hold down handle to completely empty tank.

5. Install Mounting Bracket

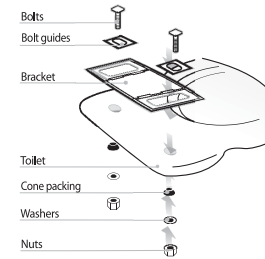

- Place adjustable mounting plate over mounting holes on toilet, flat side down, rubber side off mounting plate should be closest to the toilet tank.

6. Slide Seat onto Plate

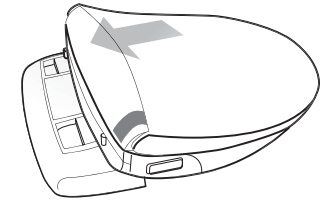

- Slide seat onto plate until it is secure and “clicks” into place.

3. Install T-Valve

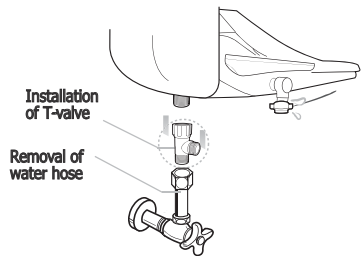

- Remove the existing water hose and then install T-valve to the bottom of the toilet tank. Ensure the rubber washer is properly seated and attach the original water hose to the T-Valve.

4. Water Supply Hose

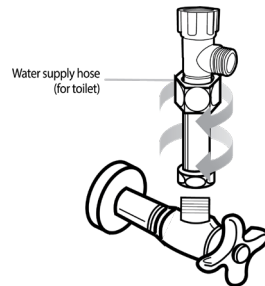

- Connect water supply hose for toilet.

7. Connect Bidet hose

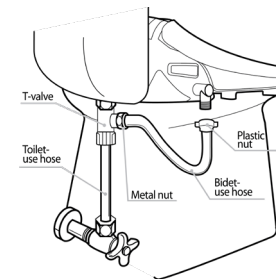

- Connect bidet hose, making sure the hose is firmly connected.
- Do not twist bidet hose, excessively bend it, or strip the plastic screw threads.

8. Insert Deodorizing Cartridge

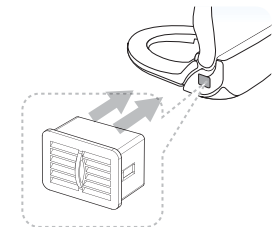



1. Remove Adhesive

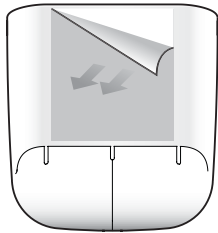

- Remove the adhesive protection to attach the remote control bracket to the wall or other surfaces.

2. Clean Area

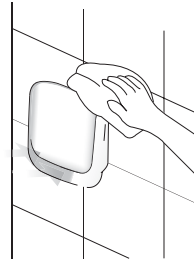

- Clean the area thoroughly before attaching the bracket.

3. Batteries

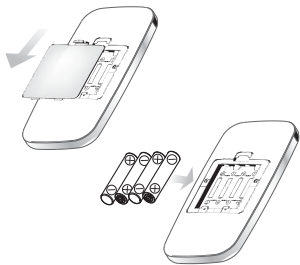

- Turn remote over and open the battery compartment. Inset four "AAA" type batteries (included) as indicated inside battery compartment and replace battery cover.

4. Mount Remote (Optional)



- Identify a location in the bathroom for the remote control that is visible and reachable from the toilet and mount remote using double stick tape (included).

5. Battery Life

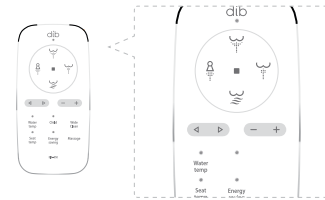

- When the batteries have reached the end of service life, all LEDs will blink. Replace the batteries with new AAA size (4pcs).
- CAUTION** - Do not use old and new batteries together. This could cause damage or failure of the remote control.

6. Unplug If Unit Does Not Work

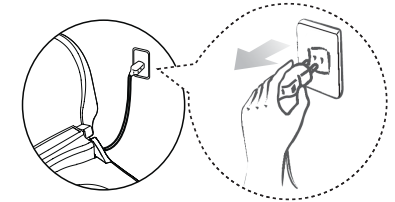

- If the unit does not work after replacing the batteries, unplug and wait for 3 seconds. Plug in again.
- After replacing the batteries, ID of the unit will be initialized as "00" and its ID will be equalized ID of the remote control that reaches the unit first. This ID assigning function will be needed to prevent signal interruption if more than 2 units are used at one place. In case of using one unit only, no setting is needed.



1. Open Water Supply

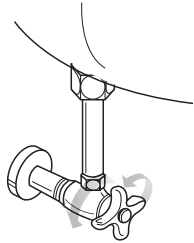

- Open the water supply valve by turning it counterclockwise.

2. Check For Leaks

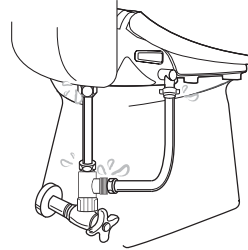

- Check that there are no leaks around the hose connection.

3. Nozzle

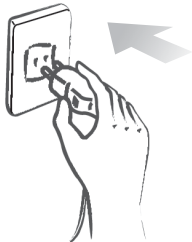

- Be sure that the nozzle comes out and retracts when powered on.
- Don't plug the power cord with wet hands. Risk of electric shock.

4. Test

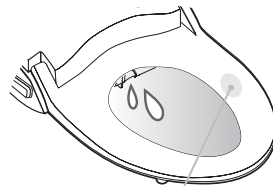

Occupied sensor

- Place your hand on the occupied sensor of the seat. The unit will fill with water. Check if water comes out from drain hold next to the nozzle for 1-2 seconds.

1. Unplug Power



- Unplug the power plug from the outlet.

2. Close Water Supply Valve

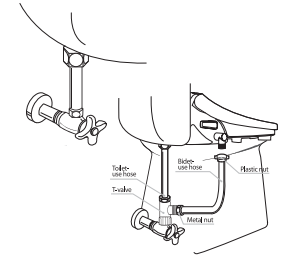

- Close the water supply valve by turning it clockwise. Completely drain out the toilet water tank, release the nuts at bidet body of the bidet hose, and then remove them from the main body.

3. Drain Water



- Press and release/drain button on the side of bidet. Completely drain the water out of the main body. While pressing the button, pull the main body forward and then remove it from the toilet.

4. Release & Remove

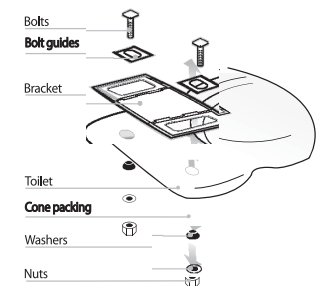

- Release the nuts, and then remove the brackets from the toilet.



5. Remove Bidet Hose

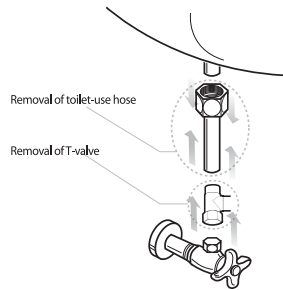

- Remove the bidet hose, toilet hose and T-Valve.

6. Connect Water Supply Hose

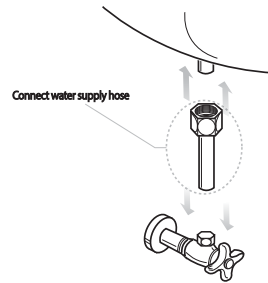

- Connect the water supply hose that was removed when the bidet was installed.

7. Open Water Supply Valve

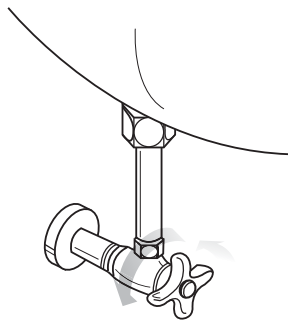

- Open the water supply valve by turning it counterclockwise.

8. Attach Toilet Seat



- Attach the toilet seat and cover that were removed when the bidet was installed.



1. Sit On Toilet Seat

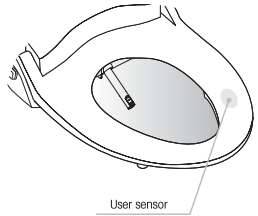

- Deodorization function starts automatically.

2. Press Posterior, Feminine, and Vortex Wash Buttons



- Selected function can be used as described. When selecting VORTEX WASH function, Oscillate function cannot be used). When selecting Child function, VORTEX WASH function may not operate).
- Dib's specialized water spray in VORTEX WASH function enters into rectum, and then helps relieve constipation and fecal stasis.
- Unless STOP button is pressed after Posterior and Feminine function, the dryer will start automatically.

3. Press Dry Button



- Dryer temperature is adjustable. (5 levels)
- Selected function may be used for up to 3 minutes.
- Dryer effect will be improved if you wipe the moisture lightly before operating the drying function.

4. Press STOP Button

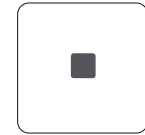

- Selected functions stop.
- Press STOP on the side control panel for 3 seconds to turn off the unit.



5. Wide Clean (Oscillation)



- When pressing the Wide Clean button during the operation of Posterior and Feminine, nozzle will move back and forth to wash a wider range.
- When pressing the Child button during the operation of Wide Clean, the nozzle position can be adjusted in 5 positions.
- Wide Clean function will not operate during the operation of Vortex wash.

6. Massage (Pulse)



- When pressing Massage button during operation of Posterior, Feminine, and Vortex wash, water pressure will repeat high and low for smooth pulsating wash.

7. Water Pressure Control



- Adjust Water Pressure.

8. Nozzle Position Control



- During the operation of Posterior, Feminine, and Vortex wash, nozzle position can be adjusted by pressing < or >.



9. Child Function



- Press the Child button to activate.
- Nozzle position will be one level move forward than normal.
- Water pressure will be one level weaker than normal.
- Seat temperature will be one level lower than normal.
- Vortex wash will not operate while Child mode is activating.

10. Seat Temperature Control

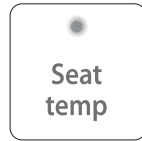

- Temperature of seat can be adjusted to the desired level by pressing Seat temp. button.
- Room temp
Low - Middle - High

11. Water Temperature Control

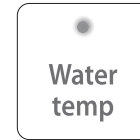

- Temperature of water can be adjusted to the desired level by pressing Seat temp. Button.
- Room temp
Low - Middle - High

12. Energy Saving Modes

Automatic Energy Save Mode

- This mode will be activated by pressing the Energy Saving button until yellow LED lamp lights on.
- Seat will be kept at 32°C.

Smart Energy Save Mode

- This mode will be activated by pressing the Energy Saving button until green LED lights on.
- Seat temperature will be kept at 32°C when it is not occupied and raised back to preset level according to memorized time of use.
- It may take 5-7 days to let the unit memorize the usage pattern.

Cancel Energy Save Mode

- Press the Energy Saving Button until LED is off to release the energy save modes.

This unit adopts the instant heating technology for water heating and does not consume energy for water heating when it is in stand by mode.



13. Deodorizing Function

- When sitting on the seat, deodorizing function starts automatically.
- Speed of deodorizing fan can be controlled. (Refer to the User setting facilities).
- After leaving the seat, the deodorizing function will operate for 1 additional minute.

14. Low Temperature Burn Protection

- To reduce the chance of low temperature burns, the seat has a seat heater auto adjustment function which turns on low temperature (32°C, 90°F) when user sits on the seat for more than 15 minutes consecutively.

15. User Preset

- Nozzle position, water pressure, dry/water/seat temperature can be present and stored for 2 different users.

How to Preset

1. Adjust nozzle position, water pressure, dry/water/seat temperature to your preference.
2. **Preset 1** - Press the “Stop” button and ◀ simultaneously for 3 seconds.

Preset 2 - Press the “Stop” button and ▶ simultaneously for 3 seconds.
3. Press the “Stop” button or wait. Red activating indicator will blink for 5 seconds when the setting is completed.



dib

Using the Preset Feature

1. Press selected preset button
2. Preset nozzle position, water pressure, and temperatures will be activated.





User Setting With Remote Control

- Seat Switch 'Off' Status
- Seat Switch 'On' Status
- ◐ Regardless of On/Off

Function		Seat Status	Switch Operation
1	On/Off Automatic Deodorizer Fan	●	Press the "Stop" and "Energy Saving" for 3 seconds. Then adjust the fan speed by pressing "-" or "+" button. Leave the remote control alone for 5 seconds to complete the setting.
2	Setting the ID of Remote Control	◐	Press the "Wide Clean" button for 3 seconds. Then set the ID 0-3 by pressing "-" or "+". Leave the remote control alone for 5 seconds to set the ID.
3	On/Off Night Light	◐	Press "+" button for seconds.

Description					Initial Status
Level	Fan Speed		Display of activating indicator	Energy saving (blinking)	High Speed in Both Modes
	Occu.	Unocc.			
default	High	High	Blinking	Red	
0	Off	Off	Blinking	Off	
1	Low	Low	Blinking	Blue	
2	Low	High	Blinking	Purple	
3	High	High	Blinking	Red	
Level	Display of activating indicator		Display of Seat temperature (blinking)		ID "0"
default	-		-		
0	Blinking		Off		
1	Blinking		Blue		
2	Blinking		Purple		
3	Blinking		Red		
Night light can be turned on and off by pressing "+" button on the remote.					Night Light is turned on



Extra Functions With Side Control Panel

- Seat Switch 'Off' Status
- Seat Switch 'On' Status
- ① Regardless of On/Off

Function		Seat Status	Switch Operation	Description
1	Manual Nozzle Cleaning	●	Press "Posterior" for longer than 3 second	Nozzle will move forward for cleaning
2	Power Off	●	Press "STOP"	Nozzle will retract and clean itself
3	Factory Default Setting	●	Press "STOP" for longer than 5 seconds	Press one of "Stop", "Posterior", or "Feminine" to power on
4	Selecting/ Canceling Silent Mode	●	Press "Feminine" for longer than 3 seconds	To on/off the chime sound.

Using Inline Carbon Filter

Use of external water filter is only recommended in areas with known hard water issues. If a filter is used, it must be replaced every 3 months. This product is designed and intended for use exclusively with Bio Bidet DIB water filters. The purchase or use of any other water filter is not the responsibility of BBC Innovation LLC. As such, any use of non DIB water filters is prohibited and will void the warranty for those Bio Bidet products. Bio Bidet will not be responsible for any resulting damages or claims related to the misuse or distribution of non Bio Bidet DIB filters.



Manual Nozzle Cleaning

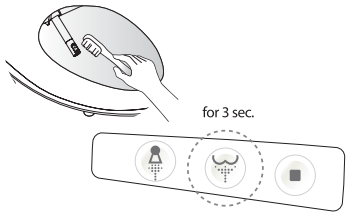

1. Press Posterior for longer than 3 seconds, and then nozzle will extract and stop (for 2 minutes).
2. Clean the nozzle with an unused toothbrush, etc., and press STOP. Nozzle will retract.

Cleaning of Bidet Body

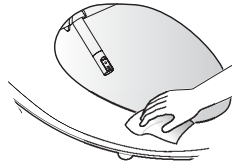

1. Exterior surface of bidet is made of plastic material, which may be damaged by scrubber, chemicals, etc.
2. Wipe the surface with a soft damp cloth. Do not spray water directly onto surface.
3. Clean the body after removing the power plug from the outlet. Be sure no water splashes onto the power plug or outlet.
4. Do not touch the power outlet with wet hands. Risk of electric shock.

Drain Remaining Water

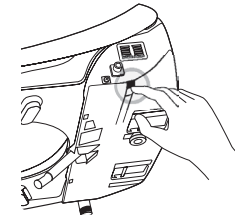

1. Remove the power plug from the outlet.
2. Close the water feed valve by turning it counterclockwise.
3. Press the button on the side of the main body to drain the water.

Maintenance During Winter

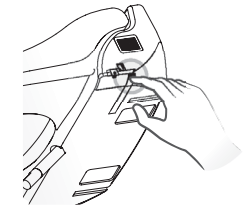

1. Insert the power plug into the outlet and be sure if the power is supplied.
2. When the bidet will not be used for a long time (more than a few days), close the water shut off valve and drain the water from the bidet.

SPECIFICATIONS

ITEM		DIB-850	
Rated Voltage		AC 120V, 60Hz	
Max. Consumption Power		1270W	
Power Cord Length		4ft.	
Water Feed Method		Directly Connected to Water Pipe	
Water Pressure		9.95 - 106.7 psi	
Wash	Feeding Volume	Posterior	0.16 gal/min
		Feminine	0.16 gal/min
		Vortex	0.16 gal/min
	Water Pressure Control		5-Step Control
	Temp. Control		Room Temp. - 100°F
	Heat Capacity		1200 W
	Safety Device		Temp. Fuse, Thermo Switch
Heated Seat	Temp. Control		Room Temp. - 107°F
	Heater Capacity		55W
	Safety Device		Temp. Fuse
Dry	Temp. Control		Room Temp. - 122°F
	Heater Capacity		250W
	Safety Device		Temp. Fuse, Bi-metal
Deodorization		Catalytic Deodorization	
Product Dimension inch (mm)	Elongated	15.9" (406) x 20.8" (528) x 6.5" (165)	
	Round	15.9" (406) x 19.5" (496) x 6.5" (165)	
Product Weight/ Gross Weight lb (kg)	Elongated	10.8 (4.9 kg)/17.4 (7.9 kg)	
	Round	10.6 (4.9 kg)/17.2 (7.8 kg)	

TROUBLESHOOTING

Please check the following points before requesting the repair of the product.

Problem	Check List
The bidet is not working	Check if the power plug is not connected. Check for power failure.
Water does not spray	Check if the water supply is suspended. Check if the water supply is suspended. Check if the nozzle is locked by foreign materials. Check if connection hose is bent.
Water pressure is low	Check if the water pressure is set at too low level
Water is not warm enough	Check if its temperature is set at 'off' or 'low' Check if energy save mode is on.
Seat is not warm enough	Check if its temperature is set at 'off' or 'low' Check if energy save mode is on.
Vortex wash is not operated	Check if it is set on CHILD mode. Check if energy save mode is on.



3 YEAR WARRANTY

Bio Bidet warrants its products to be free from manufacturing defects under normal use and service for a period of 3 year from the date of purchase. This warranty is extended only to the original purchaser.

For full warranty details, visit www.biobidet.com

Contact Bio Bidet customer support with any questions you may have.

847.458.2334

support@biobidet.com

www.biobidet.com

Thank You



Technical Support/Customer Service
7900 S Route 31 Crystal Lake, IL 60014
T: 847.458.2334
U.S. TOLL FREE: 877.339.5214

support@biobidet.com
www.biobidet.com