



INSTRUCTIONS MANUAL

TYL-EX0827

360° 16" CAROUSEL STAND FAN

Full oscillation for better air flow and ventilation



www.tylrhome.com

Table of Contents

IMPORTANT SAFETY INSTRUCTIONS	3
PARTS AND FEATURES	5
ASSEMBLING YOUR STAND FAN	7
OPERATING YOUR STAND FAN.....	11
Using the Remote Control.....	13
CARE AND MAINTENANCE	14
Storage.....	14
WARRANTY TERMS AND CONDITIONS.....	15

IMPORTANT SAFETY INSTRUCTIONS

Read this instruction manual thoroughly before using the appliance and save it for future reference. When using electrical appliances, basic safety precautions should be followed, to reduce the risk of fire, electrical shock and personal injury.

- Check if the electrical specifications of this appliance are compatible with your installation.
- To protect against the risk of electrical hazard, do not immerse in water or other liquids.
- This appliance is for indoor use only.
- Do not place objects on top of the unit.
- Do not use near water.
- This appliance is for indoor use only.
- Do not place objects on top of the unit.
- Do not unplug the unit if your hands are wet as electrical shock could occur.
- Do not carry the appliance while it is in operation.
- Place it on a secure and level area. Keep out of reach of children to prevent any accidents.
- Do not place any object into the appliance. Do not disassemble the appliance.
- This appliance can be used by children aged from 8 years and above and persons with reduced physical, sensory or mental capabilities or lack of experience and knowledge if

they have been given supervision or instruction concerning use of the appliance in a safe way and understand the hazards involved. Children shall not play with the appliance. Cleaning and user maintenance shall not be made by children without supervision.

- If the supply cord is damaged, it must be replaced by the manufacturer, its service agent or similarly qualified persons in order to avoid a hazard.

SAVE THESE INSTRUCTIONS!

PARTS AND FEATURES

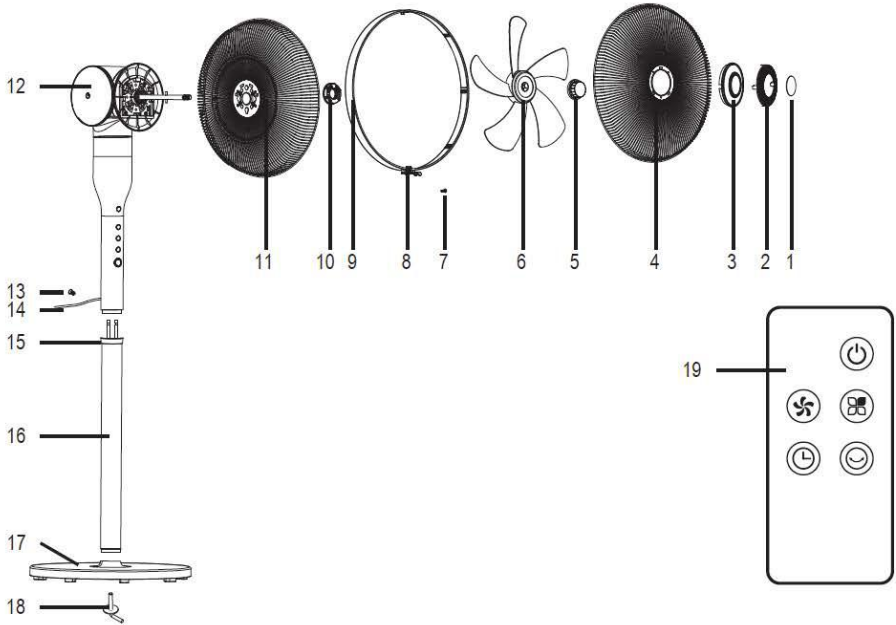

- 1 – Decorative Plate
- 2 – Decorative Plate
- 3 – Front Grill Cap
- 4 – Front Grill
- 5 – Blade Cap
- 6 – Fan Blade
- 7 – Screw
- 8 – Grill Ring Lock
- 9 – Grill Ring

- 10 – Grill Ring Cap
- 11 – Rear Grill
- 12 – Fan Head/Motor Unit
- 13 – Screw
- 14 – Power Cable
- 15 – Ring Connector
- 16 – Pole
- 17 – Base Plate
- 18 – L-Screw
- 19 – Remote Control

Control Panel

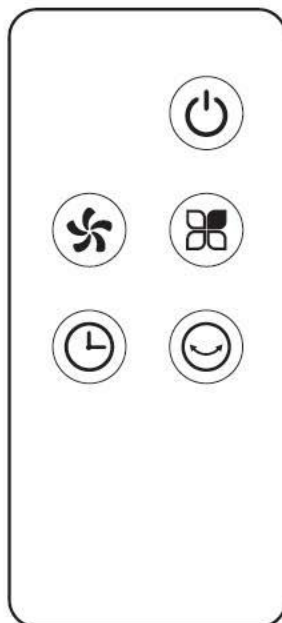
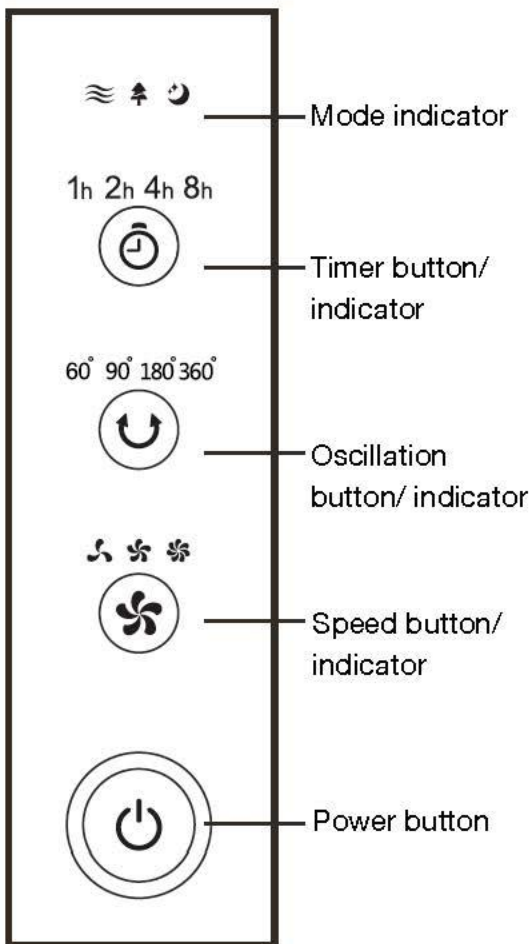

ASSEMBLING YOUR STAND FAN

1. The fan can be used either as a floor standing fan, or a tabletop fan.

Floor Standing Mode

Insert pole into the base plate. Lock in place with the L-screw.
(Fig. 1)

Tabletop Mode

Directly insert fan head directly into the base plate. Lock in place with the L-screw. (Fig. 1)

Fig. 1

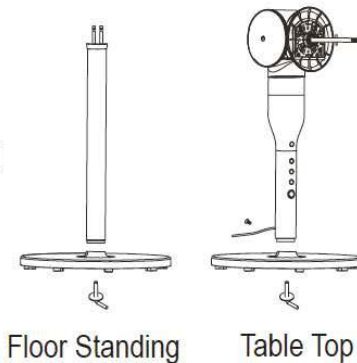

2. For floor standing mode: Attach pole to fan body. Secure with screw. (Fig. 2)

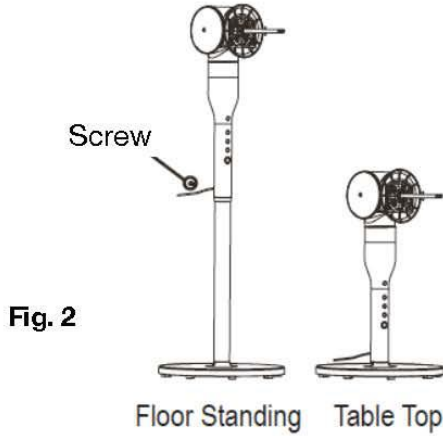

3. Slide rear grill onto motor head. Align grill to the holes on the fan head, then fasten with the grill ring cap. (Fig. 3 & 4)

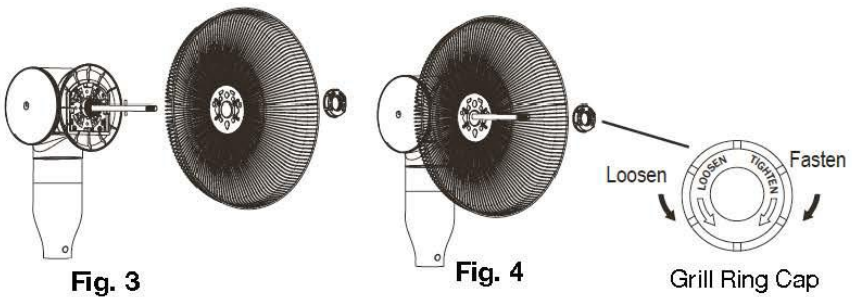

4. Mount fan blade onto the motor shaft and fasten tightly with blade cap in a counterclockwise direction. (Fig. 5 & 6)

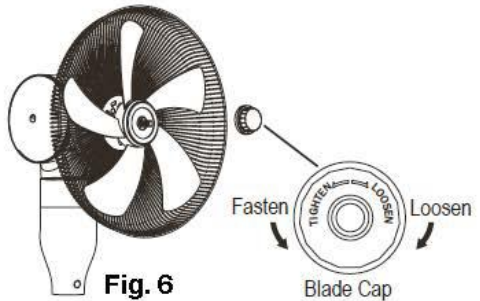
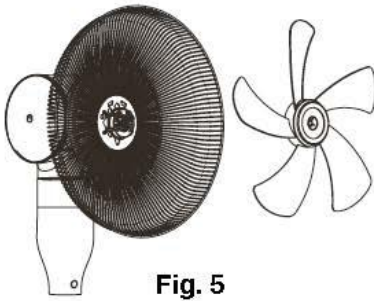

5. Attach front grill to rear grill and hold in place with the grill ring lock. Fasten into place with screw. (Fig. 7 & 8)

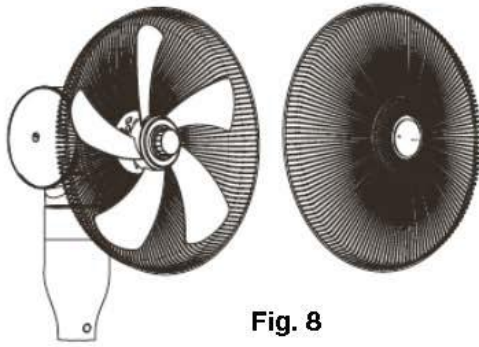
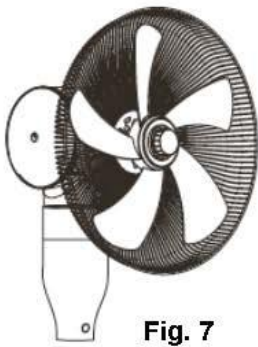

6. Once assembly is done, plug in the appliance and use according to **Operating Your Stand Fan.** (Fig. 9)

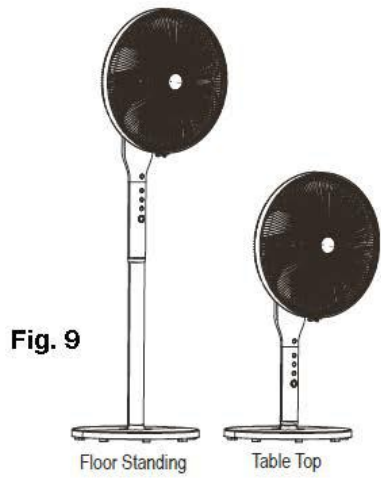

OPERATING YOUR STAND FAN

1. **POWER Button**

The fan will be in standby mode when plugged in. Press this button to turn the fan on. Default setting is LOW fan speed. (Fan will initially run at MEDIUM speed, then switch to LOW speed without oscillation after 3 seconds.)

2. **FAN SPEED Button**

Press this button to adjust wind speed. Each press of the button will cycle through LOW → MEDIUM → HIGH. The LED indicator will show the selected setting accordingly.

3. **TIMER Button**

Press this button to set fan timer. Each press of the button will cycle through 1H → 2H → 4H → 8H → OFF. The LED indicator will show the selected setting accordingly. After timer has been set, timer starts to run and unit automatically shuts off once time ends.

4. **OSCILLATION Button**

Press this button to set the horizontal oscillation angle desired. Each press of the button will cycle through 60° → 90° → 180° → 360° → 0° (no oscillation). The LED indicator will show the current oscillation angle. Press and hold the Oscillation button to exit any oscillation setting.

5. **MODE Button**

This button is only available on the remote control.

The fan is initially set at Normal mode. Press the Mode button to select from **Normal**, **Natural Breeze** and **Sleep** modes.

Normal Mode

There is no specific wind pattern for any fan speed.

Natural Breeze Mode

When fan is set to HIGH speed, wind pattern is:

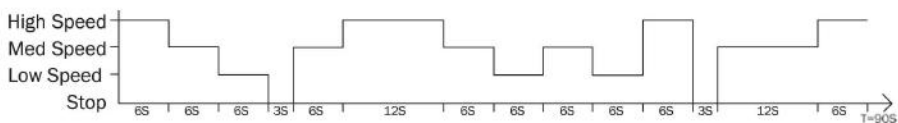

When fan is set to MEDIUM speed, wind pattern is:

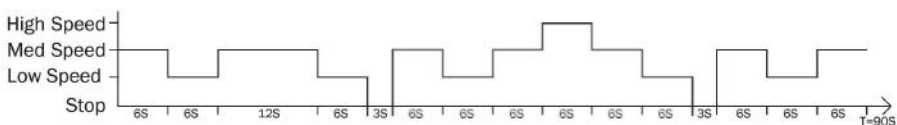

When fan is set to LOW speed, wind pattern is:

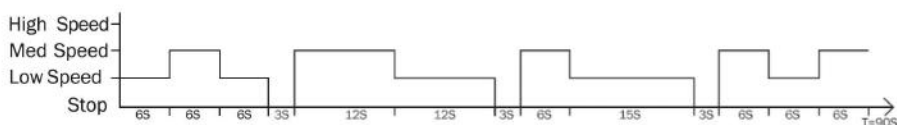

Sleep Mode

When fan is set to HIGH speed, wind pattern is:

30 minutes of High Natural Breeze → 30 minutes of Medium Natural Breeze → maintain at Low Natural Breeze

When fan is set to MEDIUM speed, wind pattern is:

30 minutes of Medium Natural Breeze → maintain at Low Natural Breeze

When fan is set to LOW speed, wind pattern is: Low Natural Breeze

NOTE: *The Fan Speed LED indicator does not change in Natural Breeze and Sleep modes.*

Using the Remote Control

1. Slide battery cover at the base of the remote control.
2. Insert a 3V CR2032 in the battery compartment. Replace battery cover.
3. During use, point remote control towards infrared receiver on the stand fan.

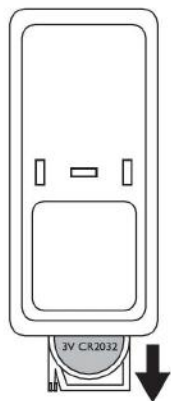

4. Remote control can be placed in the holder on stand fan, for easier accessibility.

CARE AND MAINTENANCE

CAUTION! *Always unplug the fan prior to cleaning.*

Accumulated dust and dirt on the fan will affect its performance. Cleaning the fan is recommended at least once a month.

- Clean both rear and front grills with a soft cloth moistened with a mild soap solution.
- Using a soft, moist cloth, carefully wipe the base plate, pole and fan head. Please use caution around the motor housing.
- Do not use any of the following as a cleaner: gasoline, thinner, benzene and any other harsh chemicals or abrasive cleaners.
- DO NOT IMMERSE THE FAN OR ANY WIRE IN WATER.
- Replace front grill before fan use.
- Allow fan to dry completely before use.

Storage

When fan is not used for an extended period, unplug from outlet and store in an enclosed dry place to protect it from dust and humidity.

WARRANTY TERMS AND CONDITIONS

ONE-YEAR LIMITED WARRANTY ON PARTS AND LABOR

TYLR provides a warranty to the original purchaser of this product against defects in materials and workmanship for one year. If a product covered by this warranty is determined to be defective within the warranty period, **TYLR** will repair or replace the defective part with a new or remanufactured part free of charge subject to terms and conditions stated herein.

To obtain warranty service, proof of purchase in the form of a sales invoice or copy thereof is required to show that a product is within the warranty period. If any one of the documents cannot be produced, corresponding fees for labor and replacement parts will be charged.

Parts and Labor

There will be no charge for parts and labor during the warranty period. Replacement parts or units may be new or recertified and are upon **TYLR**'s option and sole discretion. Replacement parts and units are warranted for the remaining portion of the original warranty. Our decision on all questions relating to complaints as a result of defects, either workmanship or materials, shall be conclusive and you shall agree to abide by such decision. Any unit or defective part that have been replaced shall become **TYLR**'s property. After the lapse of this warranty, a charge will be made on all labor and replacement of parts.

Types of Services

Defective Products must be sent to any **TYLR** service center to obtain warranty service. **TYLR** is neither responsible for transportation costs to the service center nor **TYLR** will cover return shipping to the customer. Product returns to **TYLR** service centers must utilize either the original carton box and shipping material or packaging that affords an equal degree of protection.

For home service, the transportation fee of **TYLR** service personnel will be charged to the customer, depending on the location. Our service personnel reserve all rights to refuse to attend to any equipment installed in an inaccessible location or any other hazardous situation.

LIMITATIONS AND EXCLUSIONS

TYLR one-year limited warranty only covers defects in materials and workmanship; however, this warranty does not cover the following:

1. Damage resulting from accidents, transport, misuse, abuse, alteration, tampering, or failure of the purchaser to follow normal operating procedures outlined in the user's manual.
2. Damage caused by negligence and poor maintenance.
3. Defects or damage due to spillage of food/liquids or improper usage of electrical supply or electrical circuit, major fluctuations in voltage, exposure to rain or moisture, wrong fuel or oil used.
4. Damage, losses, and defects as a result of fire, flood, or other Acts of God.
5. Normal wear-and-tear, corrosion, rusting, or stains.

6. Defects & damage arising from improper testing, operation, usage of the wrong component, demonstration, maintenance, installation, adjustment, or any alteration or modification of any kind.
7. Scratches & damage to the outer surface areas and externally exposed parts that are due to normal customer use.
8. General maintenance & routine servicing.
9. Claims for damaged/missing parts after 7 days from the date of purchase.
10. If any part or parts of the unit are replaced with a part or parts not supplied or approved by us, or if the unit has been dismantled or repaired by any person other than a **TYLR** authorized technician.
11. Any equipment/product which has its serial number removed or made illegible/tampered with.
12. If the warranty card is altered, defaced, or erased in any manner whatsoever.
13. If the unit is used for purposes other than household use, such as commercial use.

The one (1) year warranty covers the mainboard and control PCB, motor, heater and power supply. However, this warranty does not cover parts (i.e. accessories, front and rear cover, tray, rack, fan blade, tower blade, poles, remote control, fuse, gears, plastic cover, interior and exterior casing) that are subject to wear and tear, rust, stains, or corrosion.

This limited warranty does not cover Products sold “**AS IS**”, “**FACTORY RECTIFIED**”, or by a non-authorized reseller.

THERE ARE NO EXPRESS WARRANTIES OTHER THAN THOSE LISTED OR DESCRIBED ABOVE. ANY IMPLIED WARRANTIES, INCLUDING ANY IMPLIED WARRANTY OF MERCHANTABILITY AND FITNESS FOR A PARTICULAR PURPOSE, SHALL BE LIMITED IN DURATION TO THE PERIOD OF TIME SET FORTH ABOVE. **TYLR'S** TOTAL LIABILITY FOR ANY AND ALL LOSSES AND DAMAGES RESULTING FROM ANY CAUSE WHATSOEVER INCLUDING **TYLR'S** NEGLIGENCE, ALLEGED DAMAGE, OR DEFECTIVE GOODS, WHETHER SUCH DEFECTS ARE DISCOVERABLE OR LATENT, SHALL IN NO EVENT EXCEED THE PURCHASE PRICE OF THE PRODUCT. **TYLR** SHALL NOT BE RESPONSIBLE FOR LOSS OF USE, COMMERCIAL LOSS, LOST REVENUE OR LOST PROFITS, OR OTHER INCIDENTAL OR CONSEQUENTIAL DAMAGES. THIS WARRANTY IS SUBJECT TO CHANGE WITHOUT NOTICE.

IMPORTANT: Please present sales invoice as proof of purchase whenever you require our service during the warranty period.

www.tylrhome.com