



INSTRUCTIONS MANUAL

TYL-HZB20AN

COUNTERTOP

NUGGET ICE MAKER

Chewable and crunchy nugget ice on demand



www.tylrhome.com

Table of Contents

IMPORTANT SAFEGUARDS	2
KNOW YOUR ICE MAKER	4
Control Panel	4
SETTING UP YOUR ICE MAKER	5
Before first use	5
Finding a suitable location	5
OPERATING YOUR ICE MAKER	7
Getting ready to make ice	7
Making ice	9
Getting ice	10
CLEANING AND MAINTENANCE	11
Cleaning the parts	11
Running a cleaning cycle	11
TROUBLESHOOTING	13
WARRANTY TERMS AND CONDITIONS	15

IMPORTANT SAFEGUARDS

When using electrical appliances, basic safety precautions should be followed to reduce the risk of fire, electric shock, and injury to persons or property. Read all instructions before using any appliance.

- Do not operate this appliance with a damaged cord.
- If the supply cord is damaged, it must be replaced by the manufacturer or its service agent or a similarly qualified person in order to avoid a hazard.
- Place power cord in such a way that it cannot be pulled on by children or cause a tripping hazard.
- Place power cord in such a way that it is not in contact with hot surfaces.
- Connect this appliance to properly grounded outlets only.
- Plug your appliance into an exclusive, properly installed, grounding wall outlet.
- We do not recommend the use of an extension cord due to potential safety hazards under certain conditions. However, if you must use an extension cord, use no. 0.75mm² minimum size and rated no less than 16A/250V~ with a plug.
- Exercise caution and use reasonable supervision when appliance is used near children.
- Do not use your ice maker outdoors. Position the ice maker away from direct sunlight and make sure that there is at least 15 cm (6 inches) of space between the back of your unit and wall. Keep a minimum distance of 6 inches on each side of your unit free.
- Do not use any liquid with the ice maker other than water.
- Do not clean your ice maker with flammable fluids. The fumes can create a fire hazard or explosion.
- Do not tip the appliance over.

- If the ice maker is brought in from outside in wintertime, give it a few hours to warm up to room temperature before plugging it in.
- Use this appliance only for its intended purpose as described in this manual.
- Unplug this appliance before cleaning by hand, and when not in use.

Important:

The wires in this mains lead are colored in accordance with the following codes:

Green or Green with a strip yellow
Blue
Brown

Grounding
Neutral
Live

**SAVE THESE INSTRUCTIONS. FOR INDOOR USE ONLY.
NOT FOR COMMERCIAL USE.**

KNOW YOUR ICE MAKER

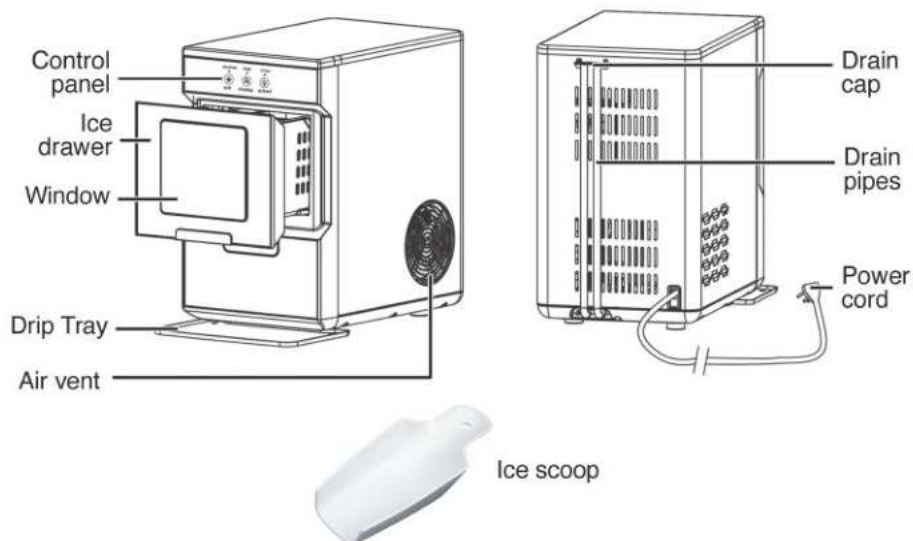

Control Panel

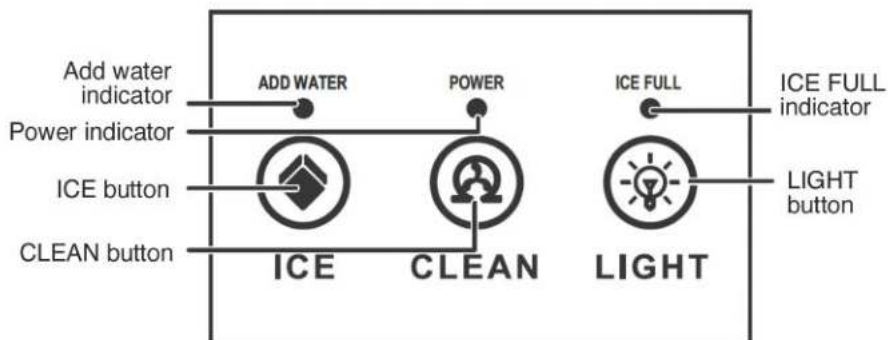

SETTING UP YOUR ICE MAKER

Before first use

1. Unpack the appliance and remove all packing materials, then check to make sure that all the accessories are complete.
2. The incline angle of the ice maker should not exceed 45° during transportation or use. Do not turn the ice maker upside down. Doing so could cause the compressor or refrigerating system to operate incorrectly.
3. Before using the ice maker for the first time, wait for at least 2 hours after the unit has been positioned, unmoved, in a stable and level surface to allow the refrigerant fluid to settle.
4. Clean the ice maker (refer to page 11 for **Cleaning and Maintenance**), then run 2 or 3 cycles of ice making and dispose of the ice to remove any residue or odor from the manufacturing or shipping process.

Finding a suitable location

- This ice maker is designed to be free standing only, and should not be recessed or built in.
- Place your ice maker on a countertop that is strong enough to support it when the ice drawer is full.
- Allow 6 inches (15 cm) of space between the back and sides of the ice maker and any surrounding walls to allow for proper air ventilation.

- Place the ice maker away from direct sunlight and sources of heat, such as a stove, heater, or radiator. Extremely cold temperatures may also prevent the ice maker from performing properly.
- **For optimal results, operate the ice maker in an environment with an ambient temperature between 10°C and 25°C.** Refrain from using in an environment with ambient temperature lower than 10°C.

OPERATING YOUR ICE MAKER

Getting ready to make ice

NOTE:

- Do not fill the water reservoir with hot water. This may damage the ice maker.
- Change water in the water reservoir every 24 hours to make sure that it is fresh. If the unit will not be used for an extended period, drain the water and dry the water reservoir.

1. Remove the ice drawer from the ice maker.

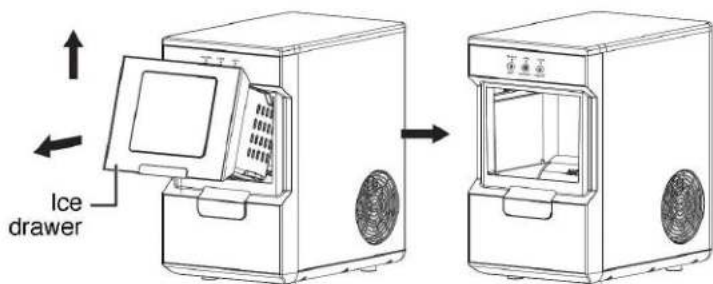

2. Fill the water reservoir with drinking water up to the MAX line. The water reservoir holds 2.2 liters of water.

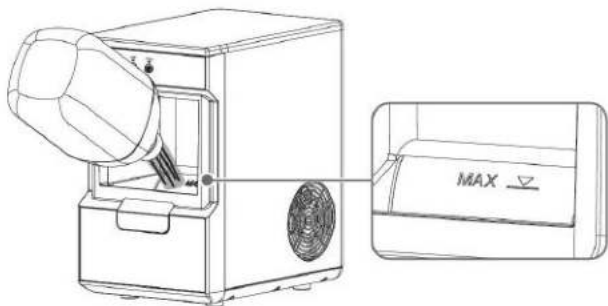

3. Place the ice drawer into the ice maker.

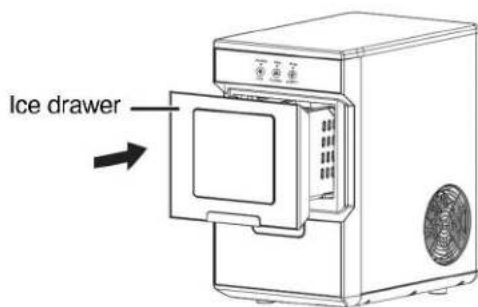

4. Put the drip tray into position.

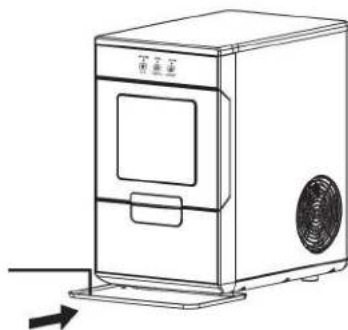

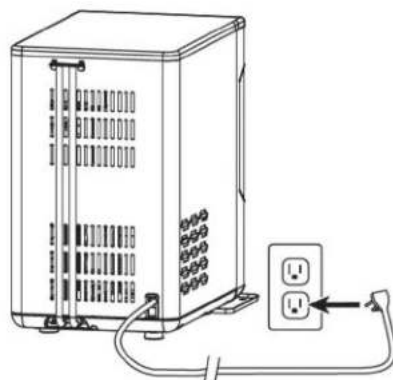

5. Plug the ice maker into a wall outlet; the power indicator turns on.

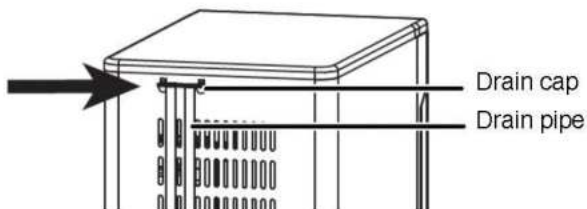

Making ice

1. Make sure the drain cap has been inserted into the drain pipe; otherwise, the ice maker will not work properly.



2. Make sure that the water reservoir is full of water and that the ice drawer and drip tray are in place.
3. Press the  ICE button. The ice indicator turns on and the ice maker begins making ice.

While ice is being made, you can view inside the ice drawer by pressing the  LIGHT button and looking through the drawer window.

NOTE: If the ice maker runs out of water, it stops automatically and the “ADD WATER” indicator turns on. Add water to continue making ice.

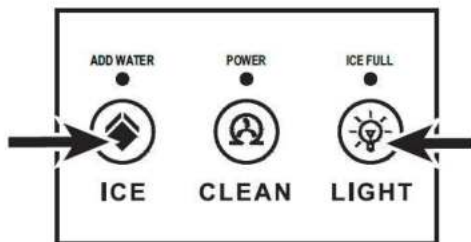

- To stop making ice, press the  ICE button again and the ice maker stops making ice. If you don't stop the ice maker, it will automatically stop when the ice drawer is full and the "ICE FULL" indicator turns on.

Getting ice

- Open the ice drawer and use the ice scoop to get the ice. You can also get the ice by hand.

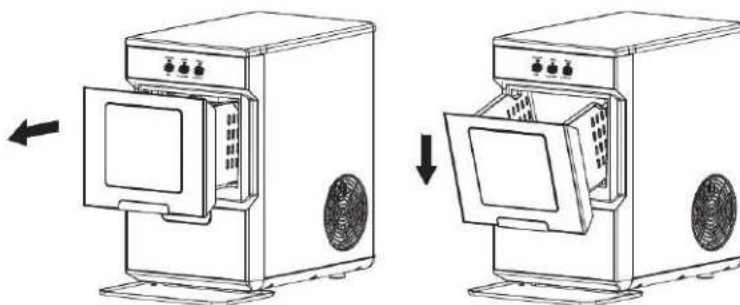

- If the ice drawer is full, you can remove dump the ice into a container and store it in your freezer. To remove the ice drawer, pull it out, then tip up the front of the drawer to remove it.

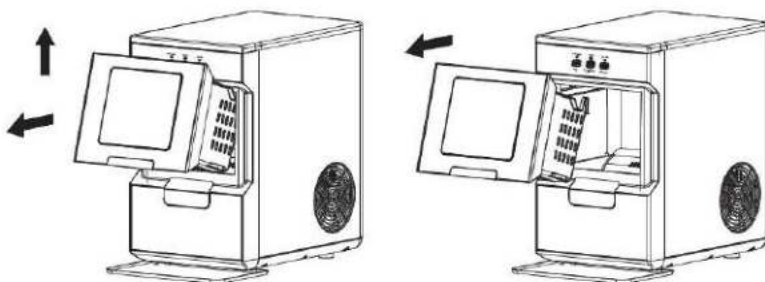

CLEANING AND MAINTENANCE

Your ice maker is designed for year-round use with only minimal cleaning and maintenance.

CAUTION:

- *To prevent damage to the finish, do not use gasoline, benzine, thinner, or other similar*
- *solvents, or abrasive cleaners to clean the exterior.*
- *Do not use bleach or vinegar to clean the internal components of your ice maker.*



Cleaning the parts

- Wash the inside with a damp, warm cloth and a baking soda solution (two tablespoons in 946 ml of water), then wipe dry with a dry cloth. Do this periodically to keep your ice maker looking new.
- Remove the ice drawer and clean it, then replace it in the ice maker.

Running a cleaning cycle

Run a cleaning cycle before using your ice maker for the first time. After that we suggest running a cleaning cycle at least every three days.

1. Before cleaning your ice maker, make sure that the drain cap has been inserted into the drain pipes at the back of the ice maker; otherwise, the ice maker will not work properly.

2. Press the  CLEAN button. The cleaning indicator light turns on. The cleaning cycle runs for at least 20 minutes, then the indicator light turns off and the ice maker stops cleaning.
You can also press the  CLEAN button again to turn off the auto clean cycle midway through.
3. After running a cleaning cycle, move your ice maker to the edge of the countertop, turn it around, then place a large container under it.
4. Pull the drain pipes from the back of the ice maker and remove the drain plug from the drain pipes.
5. Run the drain pipes into a large container and let the water drain from the tank.

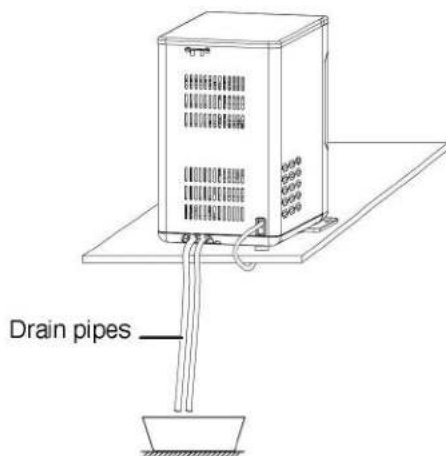

TROUBLESHOOTING

PROBLEM	POSSIBLE CAUSES	SOLUTION
ADD WATER indicator light is on.	No water or low water in the water reservoir.	Add water to the reservoir, then press the ICE button to begin making ice.
ICE FULL indicator light is on.	Too much ice in the drawer.	Remove some ice from the drawer.
	With no ice in the drawer.	Something is blocking the infrared light in the ice drawer. Remove the obstacle from the ice drawer or clean the inside of the drawer.
		Press the (ICE) button for five seconds (to override). Makes ice for 80 minutes.
LIGHT and ICE FULL indicators blink simultaneously.	The ambient temperature or the water temperature in the inner tank is too high.	The ice maker should be operated below 32° C (90°F) ambient temperature. Pour colder water into the tank.

	Refrigerant liquid leakage.	Press the ICE button twice to restart the ice making process, then wait for 50 minutes. If the problem does not resolve by itself, contact customer service.
	The motor cover is broken.	
	A pipe in the cooling system is broken.	
The ice making cycle is normal, but no ice is made.	The room temperature or water temperature may be too high.	The room temperature should be 10°C ~ 25°C (50°F ~ 77°F). The water temperature should be 7°C ~ 32°C. (45°F ~ 90°F).
	The refrigerant liquid may have leaked.	Contact customer service.
	A pipe in the cooling system may be blocked.	Contact customer service.
Ice-making output is too slow.	The air vent is blocked.	Check the air vent and remove any blockage.
	The water temperature in the inner tank is too high.	The water temperature must be between 7° and 32°C (45° and 90°F).
	The refrigeration system has a malfunction.	Contact customer service.
<i>The ice maker is leaking water</i>	The drain plug is loose or missing.	Replace the drain plug into the drain line.
	A pipe joint in the ice maker may be loose.	Contact customer service.
	The seal has reached the end of its service life.	Contact customer service.

WARRANTY TERMS AND CONDITIONS

ONE-YEAR LIMITED WARRANTY ON PARTS AND LABOR

TYLR provides a warranty to the original purchaser of this product against defects in materials and workmanship for one year. If a product covered by this warranty is determined to be defective within the warranty period, **TYLR** will repair or replace the defective part with a new or remanufactured part free of charge subject to terms and conditions stated herein.

To obtain warranty service, proof of purchase in the form of a sales invoice or copy thereof is required to show that a product is within the warranty period. If any one of the documents cannot be produced, corresponding fees for labor and replacement parts will be charged.

Parts and Labor

There will be no charge for parts and labor during the warranty period. Replacement parts or units may be new or recertified and are upon **TYLR**'s option and sole discretion. Replacement parts and units are warranted for the remaining portion of the original warranty. Our decision on all questions relating to complaints as a result of defects, either workmanship or materials, shall be conclusive and you shall agree to abide by such decision. Any unit or defective part that have been replaced shall become **TYLR**'s property. After the lapse of this warranty, a charge will be made on all labor and replacement of parts.

Types of Services

Defective Products must be sent to any **TYLR** service center to obtain warranty service. **TYLR** is neither responsible for transportation costs

to the service center nor **TYLR** will cover return shipping to the customer. Product returns to **TYLR** service centers must utilize either the original carton box and shipping material or packaging that affords an equal degree of protection.

For home service, the transportation fee of **TYLR** service personnel will be charged to the customer, depending on the location. Our service personnel reserve all rights to refuse to attend to any equipment installed in an inaccessible location or any other hazardous situation.

LIMITATIONS AND EXCLUSIONS

TYLR one-year limited warranty only covers defects in materials and workmanship; however, this warranty does not cover the following:

1. Damage resulting from accidents, transport, misuse, abuse, alteration, tampering, or failure of the purchaser to follow normal operating procedures outlined in the user's manual.
2. Damage caused by negligence and poor maintenance.
3. Defects or damage due to spillage of food/liquids or improper usage of electrical supply or electrical circuit, major fluctuations in voltage, exposure to rain or moisture, wrong fuel or oil used.
4. Damage, losses, and defects as a result of fire, flood, or other Acts of God.
5. Normal wear-and-tear, corrosion, rusting, or stains.
6. Defects & damage arising from improper testing, operation, usage of the wrong component, demonstration, maintenance, installation, adjustment, or any alteration or modification of any kind.
7. Scratches & damage to the outer surface areas and externally exposed parts that are due to normal customer use.
8. General maintenance & routine servicing.

9. Claims for damaged/missing parts after 7 days from the date of purchase.
10. If any part or parts of the unit are replaced with a part or parts not supplied or approved by us, or if the unit has been dismantled or repaired by any person other than a **TYLR** authorized technician.
11. Any equipment/product which has its serial number removed or made illegible/tampered with.
12. If the warranty card is altered, defaced, or erased in any manner whatsoever.
13. If the unit is used for purposes other than household use, such as commercial use.

The two (2) year warranty period covers the compressor and one (1) year for the mainboard, control switch, water pump, sensors, heating, and power supply. However, this warranty does not cover parts (i.e., accessories, trays, hose, silicone tubes, door gasket, doors, hinges, shelves, drawer, bins, interior, and exterior casing) that are subject to wear and tear, rust, stains, or corrosion.

This one-year limited warranty does not cover Products sold **“AS IS”**, **“FACTORY RECTIFIED”**, or by a non-authorized reseller.

THERE ARE NO EXPRESS WARRANTIES OTHER THAN THOSE LISTED OR DESCRIBED ABOVE. ANY IMPLIED WARRANTIES, INCLUDING ANY IMPLIED WARRANTY OF MERCHANTABILITY AND FITNESS FOR A PARTICULAR PURPOSE, SHALL BE LIMITED IN DURATION TO THE PERIOD OF TIME SET FORTH ABOVE. **TYLR'S** TOTAL LIABILITY FOR ANY AND ALL LOSSES AND DAMAGES RESULTING FROM ANY CAUSE WHATSOEVER INCLUDING **TYLR'S** NEGLIGENCE, ALLEGED DAMAGE, OR DEFECTIVE GOODS, WHETHER SUCH DEFECTS ARE DISCOVERABLE OR LATENT, SHALL IN NO EVENT EXCEED THE PURCHASE PRICE OF THE

PRODUCT. **TYLR** SHALL NOT BE RESPONSIBLE FOR LOSS OF USE, COMMERCIAL LOSS, LOST REVENUE OR LOST PROFITS, OR OTHER INCIDENTAL OR CONSEQUENTIAL DAMAGES. THIS WARRANTY IS SUBJECT TO CHANGE WITHOUT NOTICE.

IMPORTANT: Please present sales invoice as proof of purchase whenever you require our service during the warranty period.

www.tylrhome.com