



INSTRUCTIONS MANUAL

TYL-CZ500

CAR VACUUM CLEANER

12V portable and lightweight



www.tylrhome.com

Table of Contents

IMPORTANT SAFETY INSTRUCTIONS.....	2
PARTS AND FEATURES.....	4
HOW TO OPERATE	5
Using Attachments	5
CARE AND CLEANING	6

IMPORTANT SAFETY INSTRUCTIONS

WARNING! To reduce the risk of fire, electric shock, or injury to persons:

- Read and follow instructions
- Use only for intended use as described in this manual. Do not use other than manufacturer's recommended attachments.
- Do not operate with damaged cord, or damaged cigarette lighter adapter. If appliance is not working properly, has been dropped, damaged, exposed to weather or dropped in water, return it to a service center for examination and repair. Do not disassemble the cleaner, it is not user serviceable.
- If the supply cord is damaged, it must be replaced by the manufacturer, its service agent or similarly qualified persons in order to avoid a hazard.
- Do not abuse the cord. Do not carry the vacuum by its cord or pull on the cord.
- Do not use an extension cord. Plug directly into cigarette lighter.
- Do not operate with any opening blocked; keep free of dust, lint, hair, and the like.
- Do not put any object into openings.
- Keep hair, loose clothing, fingers, and the like away from any openings and moving parts.
- Do not pick up cigarette butts, hot ashes, matches, or similar materials.
- Do not pick up flammable or combustible liquids such as gasoline or use in areas where they may be present.
- Never use the appliance without a dust container or filter.
- Operate the appliance with the car adapter only.
- Do not operate when the vehicle's engine is running.

- This appliance is not intended for use by persons (including children) with reduced physical, sensory or mental capabilities, or lack of experience and knowledge, unless they have been given supervision or instruction concerning use of the appliance by a person responsible for their safety.
- Children should be supervised to ensure that they do not play with the appliances.
- Store in a safe place.

SAVE THESE INSTRUCTIONS!

PARTS AND FEATURES

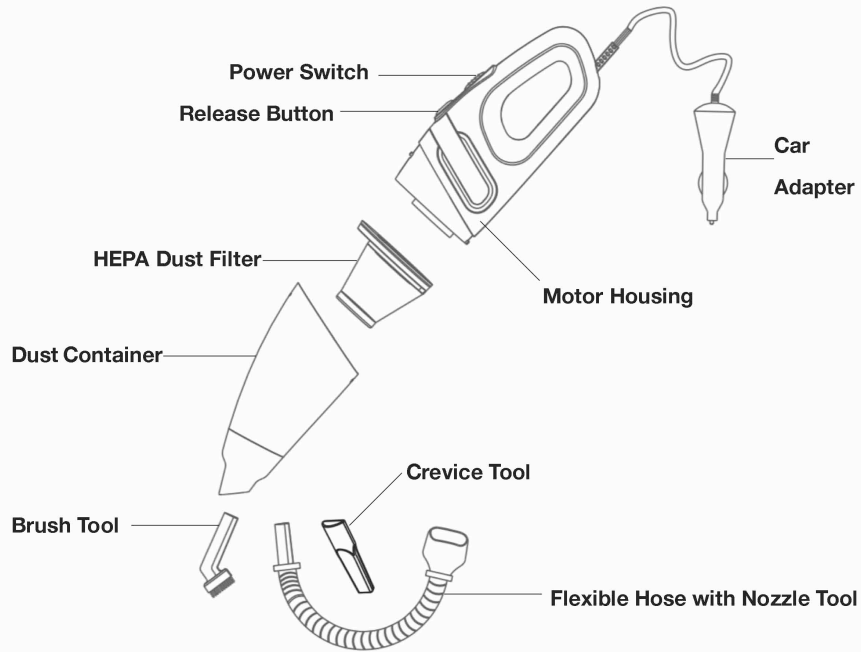

HOW TO OPERATE

1. Remove cigarette lighter from storage receptacle.
2. Insert the car adaptor into the cigarette lighter socket.
NOTE: *Ensure adapter is fully inserted into the lighter socket.*
3. Push the power switch forward to operate vacuum.
4. Push the power switch backward to turn off the vacuum.

Using Attachments

To use the attachments, simply push the required tool into the nozzle.

- Use the **flexible hose with nozzle tool** for basic, thorough cleaning in the vehicle.
- Use the **crevice tool** to clean difficult to reach places.
- Use the **brush tool** to clean car mats and seats.

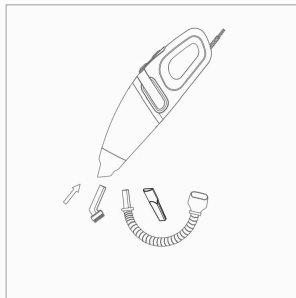

CARE AND CLEANING

To remove the dust container, press down on the release button and gently tilt the dust container forward, as shown.

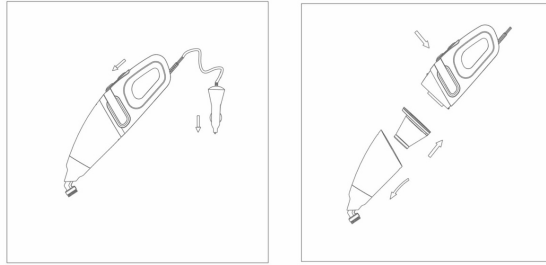

Remove the HEPA filter from the dust container and wash with water, then allow to dry thoroughly.

Empty, wash and dry the inside of the dust container. Make sure the dust container is dry and replace the filter before reusing. Replace dust container by attaching bottom of container with vacuum and raising up to lock in place.

