



INSTRUCTIONS MANUAL

TYL-AC1609KR

3in1 PORTABLE AIR CONDITIONER

Pure cool, pure comfort anywhere



www.tylrhome.com

Table of Contents

- IMPORTANT SAFETY INSTRUCTIONS2**
- PARTS AND FEATURES4**
 - Control Panel6
 - Remote Control7
- SETTING UP YOUR PORTABLE AIR CONDITIONER.....8**
 - Exhaust Hose Assembly.....8
 - Window Slider Kit Assembly9
- OPERATING YOUR PORTABLE AIR CONDITIONER 12**
 - Setting the Mode 13
 - Setting the Timer..... 14
 - Using the Sleep Function 15
 - Controlling the Air Flow Direction..... 15
 - Turning off the Portable Air Conditioner..... 15
- CLEANING AND MAINTENANCE 16**
 - Draining the Water 16
 - Cleaning the Air Filters 18
 - Cleaning the Body..... 19
- STORAGE..... 19**
- TROUBLESHOOTING20**

IMPORTANT SAFETY INSTRUCTIONS

When using electrical appliances, basic safety precautions should be followed, including the following:

- Make sure this unit is connected to a correctly grounded power supply outlet. Do not use an extension cord.
- If the supply cord is damaged, it must be replaced by the manufacturer, its service agent or similarly qualified persons in order to avoid a hazard.
- After the air conditioning is installed, ensure that the power plug is intact and firmly plugged into the power outlet, and place the power cord orderly to prevent someone from tripping or pulling out the plug.
- The portable air conditioner is only suitable for indoor use.
- Do not block airflow around the unit. Place the unit in a flat and dry place and keep a distance of above 50cm between the unit and the surrounding objects or walls.
- Keep the air inlet and outlet free from obstructions.
- When moving the unit, make sure that it is in an upright position.
- Do not store or use gasoline or other flammable vapors and liquids in the vicinity of this or any other appliances.
- Do not repair, disassemble and/or modify the unit by yourself.
- Always turn off the portable air conditioner when cleaning.
- Do not use the unit in wet surroundings or in surroundings

with excessively humid environment, such as the bathroom or toilet.

- The unit should not be located next to ovens, grills or other sources of high heat.
- Do not pull the plug to turn off the unit. Always use the power button.
- Do not operate this unit without the air filters in place.
- Do not use harsh chemicals to clean the filter(s). Dry thoroughly before inserting the filter(s) into the unit.
- Do not place anything on top of the unit, and do not sit on the unit.
- Do not let water or any other liquid or flammable detergent enter the unit to avoid electric shock and/or a fire hazard.
- The appliance can be used by children aged from 8 years and above and persons with reduced physical, sensory or mental capabilities if they have been given supervision or instruction concerning use of the appliance in a safe way and understand the hazards involved.
- Children shall not play with the appliance. Cleaning and maintenance shall not be made by children without supervision.

**SAVE THESE INSTRUCTIONS.
FOR HOUSEHOLD USE ONLY.**

PARTS AND FEATURES

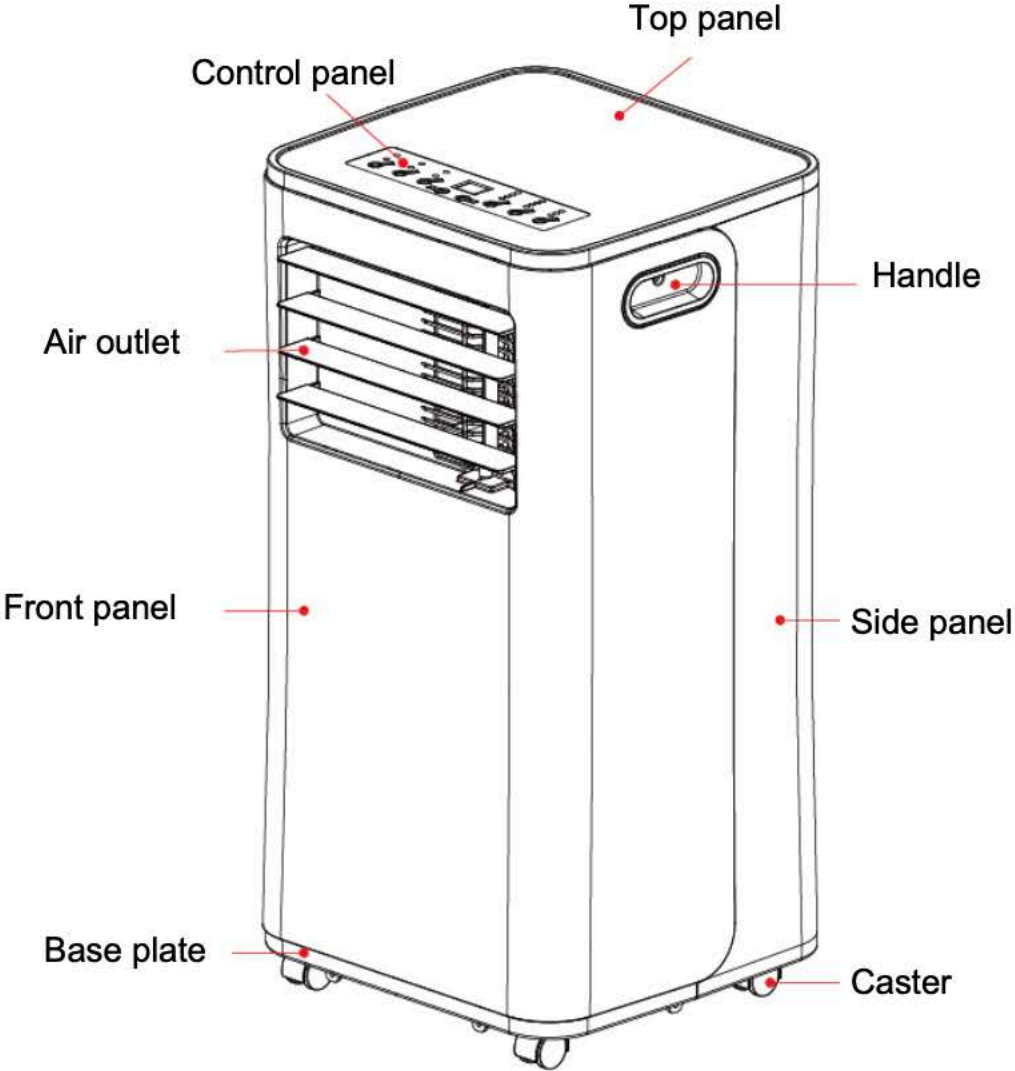

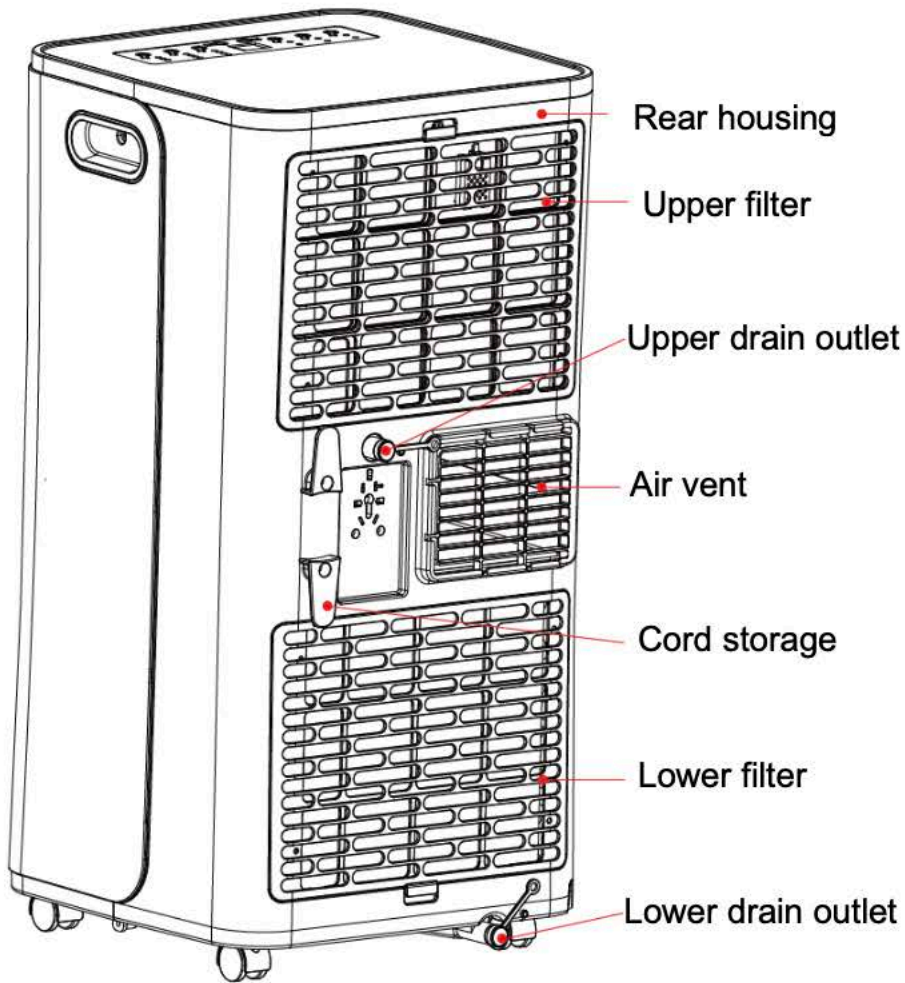

Air vent connector

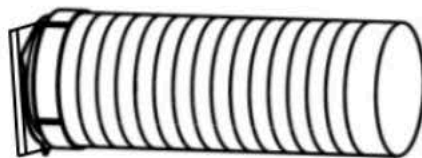

Exhaust hose



Window slider connector

Window slider



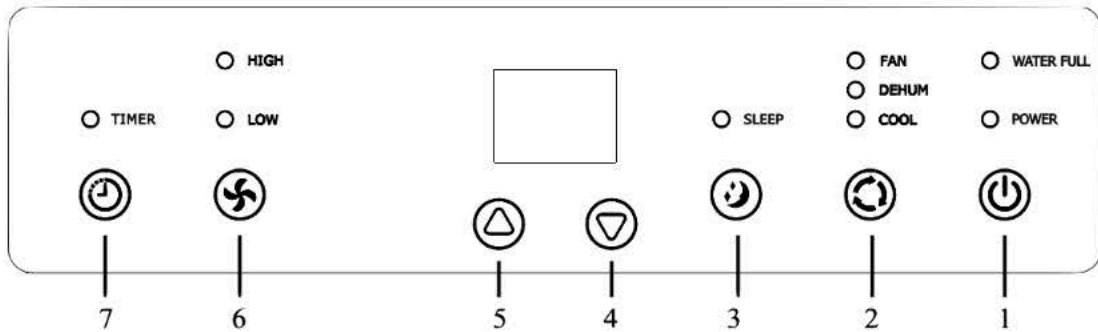

Control Panel



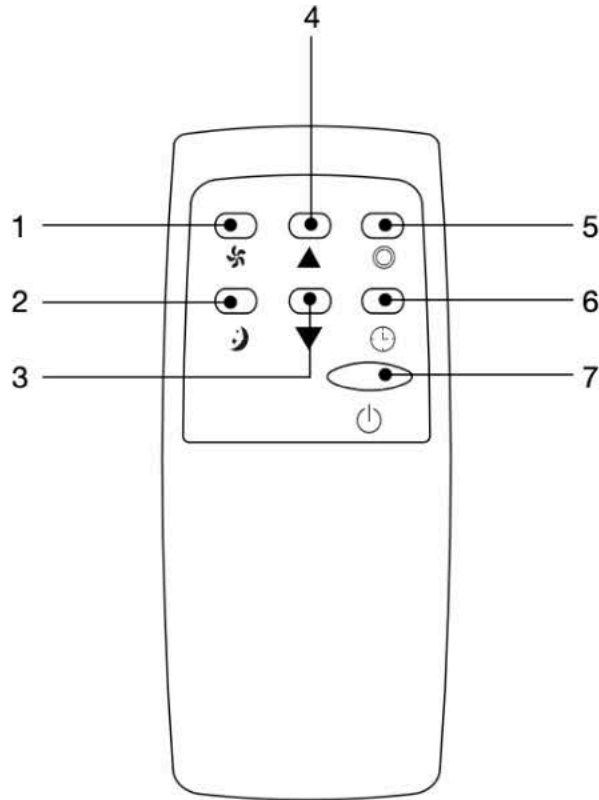

- 1 – Power button
- 2 – Mode selection button: Cool, Dehumidify and Fan
- 3 – Sleep button
- 4 – Down button
- 5 – Up button
- 6 – Fan Speed button
- 7 – Timer button

Remote Control



1 – **Fan:** Press the  key to select LOW or HIGH speed.

2 – **Sleep:** Press the  key to enable the Sleep function.

3 – **Down:** Press the  key to decrease the temperature or time.

4 – **Up:** Press the  key to increase the temperature or time.

5 – **Mode:** Press the  key to set the mode.

6 – **Timer:** Press the  key to set the timer.

7 – **Power:** Press the  key to turn the unit on or off.

SETTING UP YOUR PORTABLE AIR CONDITIONER

Important:

- Before using the unit, keep it upright for at least two hours.
- Do not use extension cord. Only plug the unit into a grounded wall outlet.
- Do not use the unit in bathrooms or other excessively humid environments.
- Place the unit in a flat and dry place and keep a distance of above 50cm between the unit and the surrounding objects or walls.

Exhaust Hose Assembly

1. Insert the air vent connector and window slider connector on both sides of the exhaust hose. Rotate the connectors to fit and secure the exhaust hose to the connectors' threads.
2. Unfurl the exhaust hose to the necessary length.

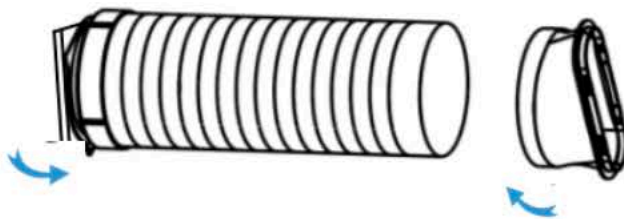

Window Slider Kit Assembly

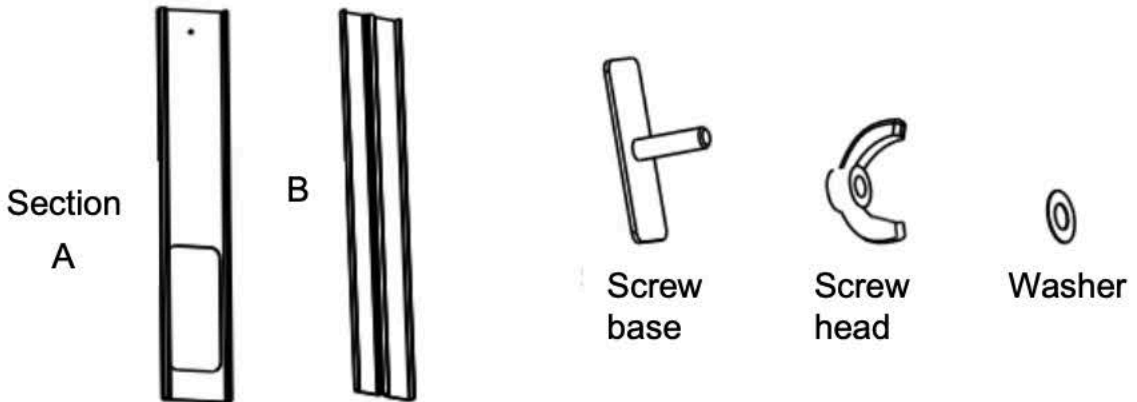

1. Insert the screw base into one end of section A.

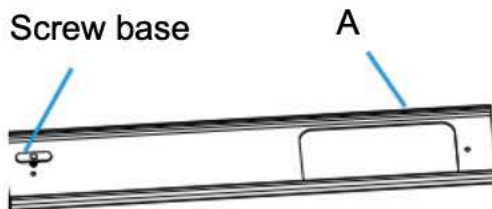

2. Thread section B onto the end of section A and make sure the screw base is also inserted into groove of section B.

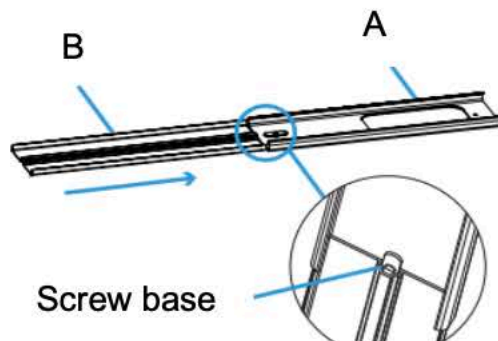

3. Flip over sections A & B to the other side, and place the washer, screw head, then loosely tighten sections A & B together.

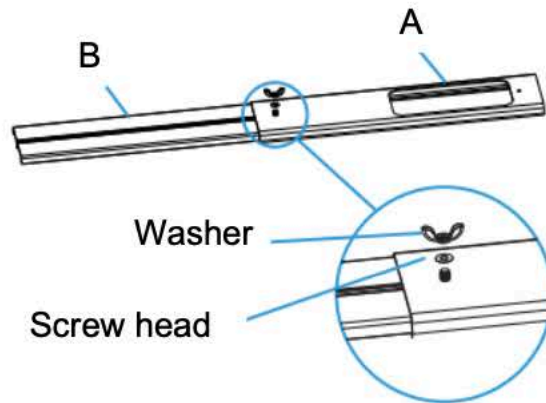

4. Insert the exhaust hose (window slider connector end) into the hole on the window slider, making sure it is aligned. Screw the window slider connector into Section A to secure it.
5. Adjust the window slider according to the width or height of your window.
6. Partially open your window, then mount the window slider onto the window opening. The window can be mounted vertically or horizontally.
7. Close the window securely against the window slider. Turn the screw head to tighten or loosen the screw fastener and adjust the sections as needed.
8. Move the portable aircon unit near the window. Make sure the unit is placed at least 50 cm away from any wall.
9. Connect the exhaust hose assembly to the portable air conditioner by sliding the air vent connector end from right to left into the air vent on the rear panel of the unit. Push to lock into place.

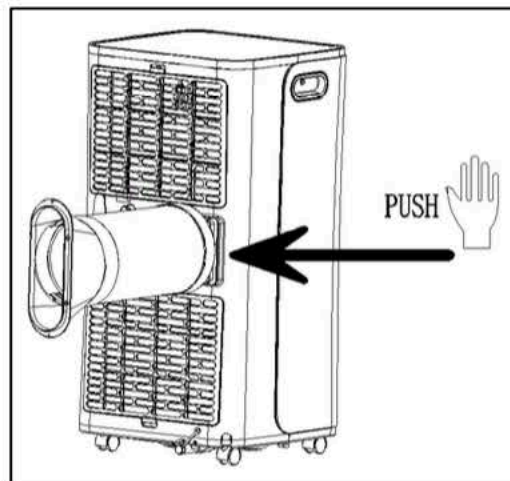
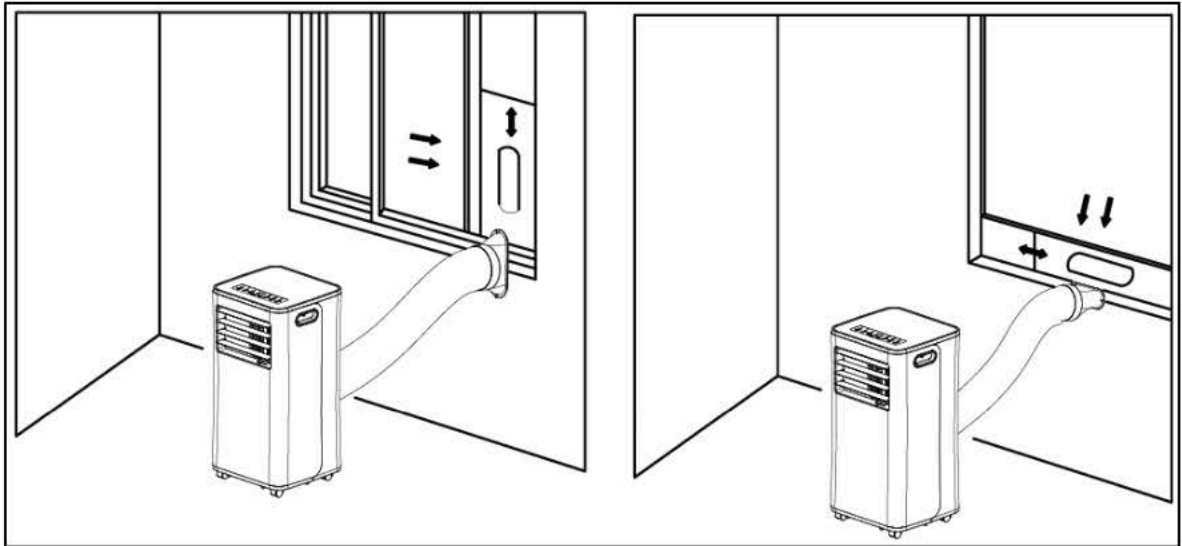

Notes:

- *The air conditioner should be placed on a firm floor to minimize noise and vibration. For safe and secure positioning, place the unit on a smooth, level floor strong enough to support the unit.*
- *To ensure proper function, DO NOT overextend or bend the hose. A bent hose will block exhaust air and cause the unit to malfunction or shut-off.*

- *Do not place the unit in front of curtains or drapes as this could obstruct the airflow.*
- *The window slider is designed to fit most standard vertical and horizontal window applications. It may however be necessary to improvise/modify some aspects of the installation procedure for certain types of window openings.*

OPERATING YOUR PORTABLE AIR CONDITIONER

1. Plug the unit into a power outlet. An alarm will sound, and the Power button indicator will also come on. The unit will be on standby mode and the display screen will show the current ambient temperature.

2. Press the Power button to turn on the unit.

Note: *Never turn the air conditioner off by unplugging from the mains. Always press the Power button to turn it off, then wait for a few minutes before unplugging. This allows the appliance to perform a cycle of checks to verify operation.*

3. Press the Power button to turn on the unit.

Setting the Mode

Press the Mode Selection button until the indicator of your required mode lights up (COOL, DEHUM and FAN).

COOL (Cooling)

In this mode, the unit will regulate temperature as selected.

- Use the ▲ or ▼ buttons to set the desired temperature (from 16° to 31°C)
- Use the  button to choose between Low and High fan speeds.
- The display shows the current room temperature.

DEHUM (Dehumidifying)

In this mode, the unit will remove moisture from the air.

- The display screen shows 'dh'.
- The fan speed is automatically set to low and cannot be adjusted.
- The temperature cannot be adjusted.

FAN





In this mode, the fan will work to circulate air.

- The display screen shows 'FA'.
- Use the  button to choose between Low and High fan speeds.
- The temperature cannot be adjusted.



Setting the Timer

Use the timer button to set the unit start-up or shutdown. This avoids wasting electricity by optimizing operating periods.

Programmed Shutdown

- With the unit on, press the  button and the timer indicator comes on.
- While the display screen is flashing, set the time when you want the appliance to turn off using the  or  buttons (from 1 to 24 hours, in 1-hour intervals).
- When the display stops flashing, the timer is set.
- At the end of the set time, the appliance switches off automatically.
- To cancel the setting, press the  button until the indicator goes off.

Programmed Start Up

- With the unit off (in standby mode), press the  button and the indicator comes on.
- While the display screen is flashing, set the time when you want the appliance to turn on using the  or  buttons (from 1 to 24 hours, in 1-hour intervals).
- When the display stops flashing, the timer is set.
- At the end of the set time, the appliance switches on automatically with the settings used prior to switching to standby mode.
- To cancel the setting, press the Timer button until the indicator goes off.

Using the Sleep Function

When the Sleep function is selected, the fan speed is set to Low. The set temperature will increase by 1°C in the first 60 minutes, then by another 1°C after the next 60 minutes. This new temperature will remain the same until the unit is turned off.

- With the unit on and in COOL mode, press the Sleep button to enable the Sleep function. The Sleep button indicator comes on.
- Press the Sleep button again to disable the Sleep function.
- This feature only works while the unit is in COOL mode.

Controlling the Air Flow Direction

The louvers can be adjusted manually. To adjust the air flow direction, manually move the vertical louver left and right, or the horizontal louvers up or down to the desired position.

Turning off the Portable Air Conditioner

Press the Power button to turn the unit off. If using the Cool mode, switch to Fan mode for about 15 seconds before turning the unit off. Wait for at least 15 seconds before turning on the unit again.

CLEANING AND MAINTENANCE

Draining the Water

When the water reservoir inside is full, the unit will sound an alarm and the WATER FULL indicator will come on to indicate that the unit needs draining.

Manual Drainage

1. Turn off the unit and unplug from power outlet.
2. If needed, move the unit to a suitable location for drainage.
Note: *If relocating the unit before draining, move it carefully so as not to spill the water inside the reservoir.*
3. Set a container below the upper and lower drain outlets for water runoff.
4. Remove the drain plugs and allow water to flow into the container. To ensure all water has been drained, the unit may be tilted slightly backwards until no more water flows out.
Note: *The water container may not hold the full contents of the water tank. A number of fills may be required.*
5. Reinstall the drain plugs.
Note: *Be sure to reinstall the drain plugs before restarting the unit.*

Continuous Drainage (Optional – applicable to dehumidifying mode)

1. Connect a drainage hose (not included) to the upper and/or lower drain outlets.
2. Set a bucket under the upper drainage hose; and/or set the end of the drainage hose connected to the lower drain outlet to a drainage where water can continuously flow.
3. When WATER FULL indicator comes on, turn off the unit and unplug from power outlet.
4. Remove the drain plug/s and allow water to flow.
5. Reinstall the drain plugs.

Note: *Be sure to reinstall the drain plugs before restarting the unit.*

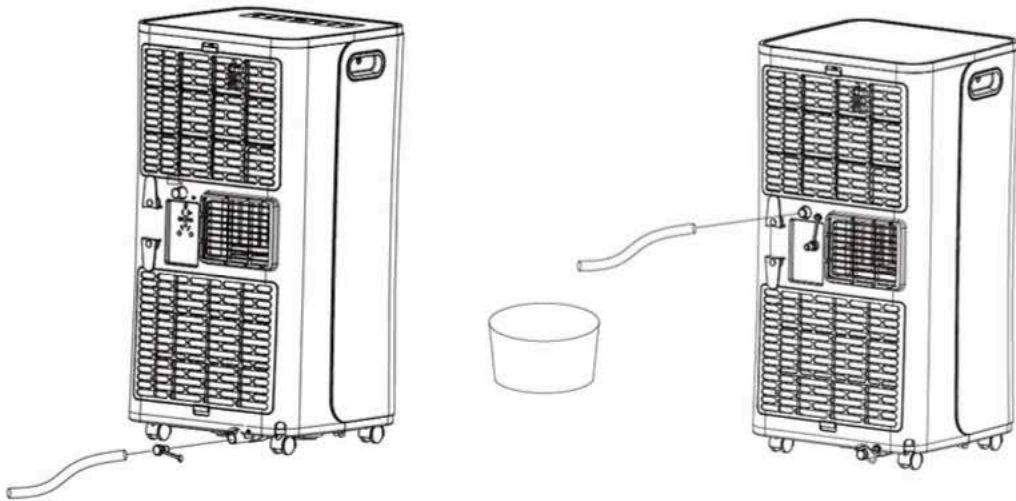

Cleaning the Air Filters

To ensure the air intake is filtered properly and to assure that your air conditioner runs efficiently, it is recommended to clean the air filters at least once every two weeks, or when the filter screen is clogged with dust.

1. Turn off the unit and pull out both the upper and lower filter grills.
2. Remove the filter screens from the filter grills.
3. Use a vacuum cleaner or tap lightly to remove loose dust and dirt from the filters screen, then rinse them thoroughly under warm or cold running water (no hotter than 40°C).
4. Dry thoroughly before re-inserting the filters.

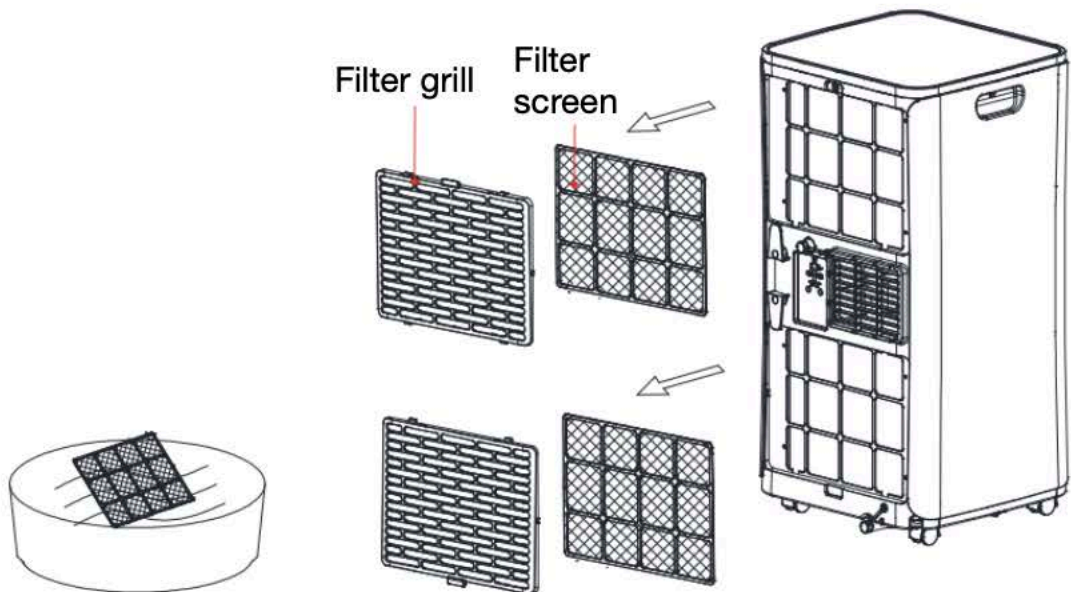

Cleaning the Body

1. Always switch off the air conditioner and disconnect the plug from the power supply outlet before cleaning.
2. Use a soft damp cloth to wipe the body of the unit.
3. Never use harsh chemicals, oil-based products, detergents, chemically treated cloths or other cleaning solutions. These could possibly damage the body of the air conditioner.

STORAGE

1. Make sure that condensed water fully drained from the unit.
2. Turn on the unit and set to FAN mode for about half a day so that the inside of the unit can dry out completely,
3. Turn off the air conditioner and disconnect plug from the wall outlet.
4. Wrap the power cord around the cord storage.
5. Store the unit in a cool, dry place. It is recommended to store the unit in its original packaging.

TROUBLESHOOTING

Problem	Possible Causes	Possible Solutions
The unit does not turn on.	There is no power.	Make sure the unit is plugged into working outlet.
The unit turns on, but the compressor does not turn on (the fan runs but the unit is not cooling).	<p>The internal water reservoir is full, and the WATER FULL indicator is on.</p> <p>The ambient temperature is too low or too high.</p> <p>In Cool mode, the room temperature is lower than the set temperature</p> <p>In Dehumidifying mode, the ambient temperature is low.</p>	<p>Drain the water from the unit.</p> <p>Place the unit in a room with an ambient temperature of 7-35°C.</p> <p>Change the temperature settings.</p> <p>Place the unit in a room with an ambient temperature of greater than 17°C.</p>
The air coming out of the unit is not very	The filters are dirty or obstructed.	Clean the air filters.

<p>cold, or the airflow volume is weak</p>	<p>The air intake or exhaust is obstructed.</p> <p>The unit is set in DEHUM or FAN mode.</p> <p>The unit is set to low fan speed</p>	<p>Clear obstructions.</p> <p>Set the unit to the COOL mode,</p> <p>Set the unit to High fan speed.</p>
<p>The unit has worked for a long time, but the room is not cold enough.</p>	<p>Windows or doors are open.</p> <p>There are too many people in the room; or the room is too large.</p> <p>There is direct sunshine into the room.</p>	<p>Close all windows and doors</p> <p>You may need additional cooling or another air conditioner.</p> <p>Close curtains or blinds and try to minimize the amount of direct sunlight into the room.</p>
<p>The unit is very noisy.</p>	<p>The unit is not placed on a level surface,</p>	<p>Move the unit to a location with a flat, level and hard floor surface.</p>

<p>The unit leaks water.</p>	<p>The unit is tilted or not level.</p> <p>The water reservoir is full.</p>	<p>Make sure the unit is on a flat, level surface.</p> <p>Drain the water from the unit.</p>
<p>Display screen shows 'E1'.</p>	<p>The room temperature sensor is faulty.</p>	<p>Contact customer service.</p>
<p>Display screen shows 'E2'.</p>	<p>The hose temperature sensor is faulty.</p>	<p>Contact customer service.</p>