









VISUAL ALARM	AUDIBLE ALARM	FAULT	SOLUTION
Control Unit does not operate 		Power or fuse issue	<ol style="list-style-type: none"> 1 Check the power cord is firmly plugged into the mains outlet and into the Control Unit; and check that mains power is on 2 Check the Control Unit is turned on; turn off Power, unplug and reinsert the power cord before turning on Control Unit again 3 Check the Control Unit fuse to determine if the internal wire in the fuse casing is broken – <i>see over for fuse replacement</i>
Lights + audible alarm 		Initial failure	<ol style="list-style-type: none"> 1 Reset the alarm – press the Alarm Mute button then turn off Power 2 Check the CPR tag is fully inserted and the quick connectors are firmly fitted to the Control Unit 3 Check all air hoses along the inside of the mattress – each should be firmly connected. Check each air cell is securely attached to its connecting air pipe 4 Check all cells, pipes and hoses for any air leakage 5 Turn on Power
Lights + audible alarm 		Pressure too low	<ol style="list-style-type: none"> 1 Reset the alarm – press the Alarm Mute button then turn off Power 2 Check the CPR tag is fully inserted and the quick connectors are firmly fitted to the Control Unit 3 Check all air hoses along the inside of the mattress – each should be firmly connected. Check each air cell is securely attached to its connecting air pipe 4 Check all cells, pipes and hoses for any air leakage 5 Check that the air filter cover is correctly secured and the air filter is clean – <i>see over for Air Filter replacement</i> 6 Turn on Power
Lights + audible alarm 		Pressure too high	<ol style="list-style-type: none"> 1 Reset the alarm – press the Alarm Mute button then turn off Power 2 Check for twists in the air hoses between Mattress and Control Unit 3 Turn on Power
Audible alarm only 		Power failure	<ol style="list-style-type: none"> 1 Press the Alarm Mute button to silence the audible alarm 2 Check the power cord is firmly plugged into the mains outlet and into the Control Unit; and check that mains power is on 3 Check the Control Unit fuse to determine if the internal wire in the fuse casing is broken – <i>see over for fuse replacement</i>
Lights + audible alarm 		Alternation mode failure	<ol style="list-style-type: none"> 1 Reset the alarm – press the Alarm Mute button 2 Check for twists in the air hoses between Mattress and Control Unit
Patient is sinking on the mattress 		Pressure may be set incorrectly	<ol style="list-style-type: none"> 1 Increase the pressure setting by pressing the 'pressure up' arrow 2 To check effective system performance, conduct a "bottoming out" test 2 Check for leaks – see "Pressure too low"

Warning & safety

- ⚠️ Clean the mattress in accordance with local infection control policy and government regulations for blood borne pathogens. Failure to do so could cause patient or personal injury.
- ⚡ The mattress is not protected against excessive amounts of water. Disconnect power supply before cleaning. Failure to do so could result in equipment damage or electric shock.
- ⚡ Switch off and disconnect the control unit from power supply before cleaning. Do not immerse the control unit in water.
- ⚠️ Do not use high temperature autoclave steam cleaning devices or phenolic-based products for cleaning. This could result in damage and loss of waterproof qualities of the top cover.
- ⚠️ Do not try to open the Control Unit. Opening the unit could cause personal injury or equipment damage.

Disinfection

- ⚠️ To prevent cross contamination, the mattress should be examined and disinfected between patient use or when visible signs of fluids or substances are present.

The mattress, top cover and control unit may be decontaminated by using ETO (Ethylene Oxide).

Cleaning & infection control

- ⚠️ It is recommended that the system is cleaned every two weeks if in constant use.

Base cleaning

Once deflated, disconnect air cells from the base by unfastening the press studs at each end. Remove double tubing from main base air tubes and slide the cell out from the cell straps. Swab the cell with a solution of sodium hypochlorite or similar (up to 10,000 ppm available chlorine).

Dry thoroughly before refastening.

- ⚠️ Do not machine wash the mattress base.

Top cover cleaning

Remove the top cover from the base before cleaning. For basic care and cleaning, wipe down with warm water containing detergent. The top cover can also be machine washed at 70°C and soaked in disinfectant during wash cycle.

For infection control, swab with a solution of sodium hypochlorite or similar (up to 10,000 ppm available chlorine), ensuring surface is completely covered. Dry thoroughly before use.

- ⚠️ Do not use system without top cover.

Control unit cleaning

Gently wipe down the external case with a soft cloth.

Soak the cloth in warm water containing detergent, and twist dry any excess water before use.

Repeat the process with a dry cloth to remove excess moisture.

Air filter replacement

- 1 Switch off power supply to the control unit and disconnect the air hoses and power cord.
- 2 Place the control unit face down on a soft, flat surface with back panel uppermost (use a soft cloth to prevent scratches).
- 3 Use a small screwdriver to carefully remove the air filter cover. Clean the dust from the filter or discard and replace with a new filter.
- 4 Refit the air filter cover to the control unit before use.

It is recommended that the air filter be replaced each year. Replacement air filters are available.

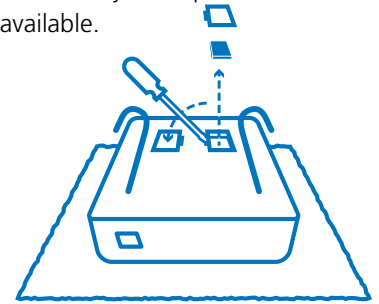

Fuse replacement

- 1 Switch off power supply to the control unit and remove the power cord from the socket in the base of the unit.
- 2 Insert a small screwdriver into the groove and turn anti-clockwise (quarter turn).
- 3 Remove the 'blown' fuse from the fuse holder clip and discard.
- 4 Insert a new fuse into the plug. Push against the force of the spring and turn clockwise with the screwdriver (quarter turn).

When changing the replaceable fuse, use same rating fuse only (T1AL/250V).

