

Initializing Door/Window Sensors

Pry the two halves of the Door/Window Sensor apart and install 2 AAA alkaline batteries inside. Observe polarity. Set switch to MAX (left) for doors, or MIN (right) for windows. Press and hold the button inside the Sensor for 3-4 seconds and then release it. This initializes the Sensor and picks a random code that is used when it is registered with the Console. **Replace the cover to deactivate the tamper switch.** Place the magnet next to the Sensor (with the arrows aligned). See Owner's Manual for your Security System if you want to use an additional magnetic contact switch.

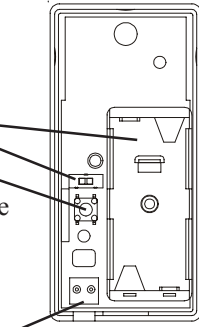

Registering Door/Window Sensors with the Console

Press either of the Menu up/down buttons (under the Console's lid, to the left of the display). The display then shows ENTER PIN (Personal Identification Number) in the top line.



The default PIN is 0000, so press 0000 on the keypad, or enter your PIN if you changed it (see Security System Owner's Manual). This clears the top line and shows * for each number entered.

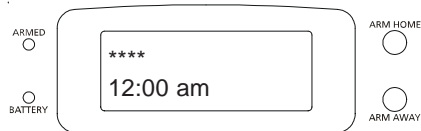

This takes you to the first level of the menu at step 1. This is the INSTALLATION level. When you see INSTALL on the display, press OK. The display then looks like this:

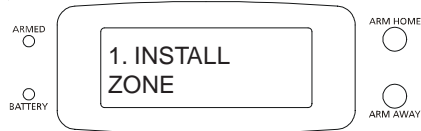

Now move the magnet away from the Door/Window Sensor. The Console acknowledges that it has been registered with a chime and by displaying ZONE 1 SET.

Repeat this for any other Door/Window Sensors you want to register. The display increments to ZONE 2 SET, etc., as you install more Door Window Sensors. If you connected a second magnetic switch to the contacts on the sensor (as shown on the next page) you can move its magnet away to install the second magnetic switch as a separate zone (otherwise it will be the same zone).

If desired, you can specify what zone you want the Door Window Sensor to be registered into. Just press the number of the zone you want on the Console's keypad, before you move the magnet away to register the Door Window Sensor.

Press Clear to back out of the menus. You are asked to confirm, 1. YES, 2 NO. Press 1 to go back to the HOME CONTROL screen. Press 2 to stay in the INSTALL menu.

Installing the Door/Window Sensor

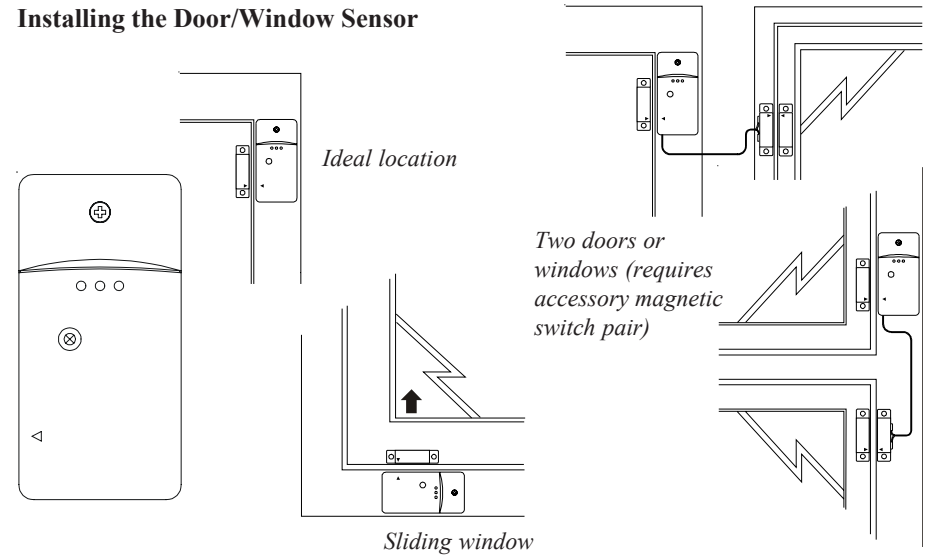

- Attach the Door/Window Sensor to the wall using the mounting screws provided.
- Fit the Door/Window Sensor as high as possible at the top of the door/window.
- Make sure the arrows on the magnetic and the Door/Window Sensor are facing each other and that they separate cleanly when the door or window is opened.
- To protect two doors or windows close to each other, use the Door/Window Sensor with an additional set of magnetic switch contacts as show in the diagrams above. (Magnetic switches are available at www.x10.com).
- Set the DELAY slide switch to MIN (to the right) to always trigger the alarm instantly (for windows), or to MAX (to the left) to trigger the alarm after a preset entry delay when the system is armed in DELAY mode (for doors).

The numbers 1 – 32 in the display refer to up to 32 “zones.” These represent the Door/Window Sensors (and/or Motion Detectors) you install. The numbers show open zones, problem zones and bypassed zones by being displayed as steady on (door or window open), slow flash (there's a problem with that zone) or fast flash (that zone has been bypassed). Attempting to arm with an open or problem zone makes the Console beep continuously and the Console will display in words on the display what the cause is, but only for one zone at a time. Bypassing that zone (by pressing the Clear button) moves on to the next problem zone, if there is one.

Battery Replacement

If a zone has not reported in during the last four hours, the display will show PROBLEM. This is most likely caused by dead batteries.

As long as the batteries have not completely failed they can be replaced with fresh batteries without the need to reinstall the sensor. After removing the old batteries fresh batteries must be fitted within 30 seconds to ensure that the security code is retained.

Testing the Door/Window Sensor

Once the batteries have been replaced, the Door/Window Sensor should be tested as follows:

- Make sure the system is NOT armed.
- Open the door or window with the sensor attached. The Console chimes to acknowledge and the zone # is displayed on the display.

If the batteries had failed, the security code will have been lost. You will need to reinstall the Motion Detector following the directions in this instruction sheet.

FCC Statement

THIS DEVICE COMPLIES WITH PART 15 OF THE FCC RULES. OPERATION IS SUBJECT TO THE FOLLOWING TWO CONDITIONS: (1) THIS DEVICE MAY NOT CAUSE HARMFUL INTERFERENCE, AND (2) THIS DEVICE MUST ACCEPT ANY INTERFERENCE RECEIVED, INCLUDING INTERFERENCE THAT MAY CAUSE UNDESIRE OPERATION.

NOTE: NO CHANGES OR MODIFICATIONS MAY BE MADE TO THE UNITS. ANY CHANGES MADE TO THE UNITS WILL VOID THE USER'S AUTHORITY TO OPERATE THE EQUIPMENT.

Please visit: <http://www.x10.com/support> for additional help and warranty conditions.

Also see www.x10.com for more accessories that work with your Security System, including Lamp Modules and Wall Switch Modules to flash lights when the alarm trips, and remote controls that let you remotely control lights (and appliances) connected to X10 Modules.

X10 Wireless Technology, Inc. Kent WA 98032



Door/Window Sensor Model DS12A



The X10 Supervised Security System includes a Security Console with an automatic dialer that calls friends or relatives in the event of a break in. Accessories include battery powered Radio Frequency (RF) Door/Window Sensors, battery powered RF Motion Detectors, and RF Keyfob Remote Controls for arming and disarming the system. All sensors and remotes incorporate random digital security coding.

The system can be configured with any combination of the following items:

- Up to 16* Wireless Keyfob Security Remotes with arm/disarm and panic functions, and buttons to control security lights in and around the home.
- Up to 30* magnetic switch operated Wireless Door/Window Sensors.
- Up to 30* Wireless PIR Motion Detectors.
- Optional X10 Home Automation modules such as plug-in lamp and appliance modules and wired-in replacement wall switches can be added to the system.

The Owner's Manual for the Security System describes the full installation process for the Security System, and should be referred to as a supplement to this instruction sheet.

***Note: Door/Window Sensors and Motion Detectors may be added in any combination up to a total of 30, e.g. 15 Door/Window Sensors and 15 Motion Detectors, or any combination up to a total of 30. There are also 2 hard wired inputs, which are zones 31 and 32.**