

Trouble shooting

The desk should be reset if the desk is not functioning properly

If the error message persists after reset procedure, please contact your seller

Error code

Code	Occasion	Solution
E05	Anti collision	Reset
E08	Desk tilted/Control box not stable	Reposition the control box

Specifications

Motor	Single Motor
Height	750 - 1250mm
Stage	2
Load Capacity	Up to 80kg
Max Speed	25mm/s

I-standing desk

Assembly Instruction & User Manual

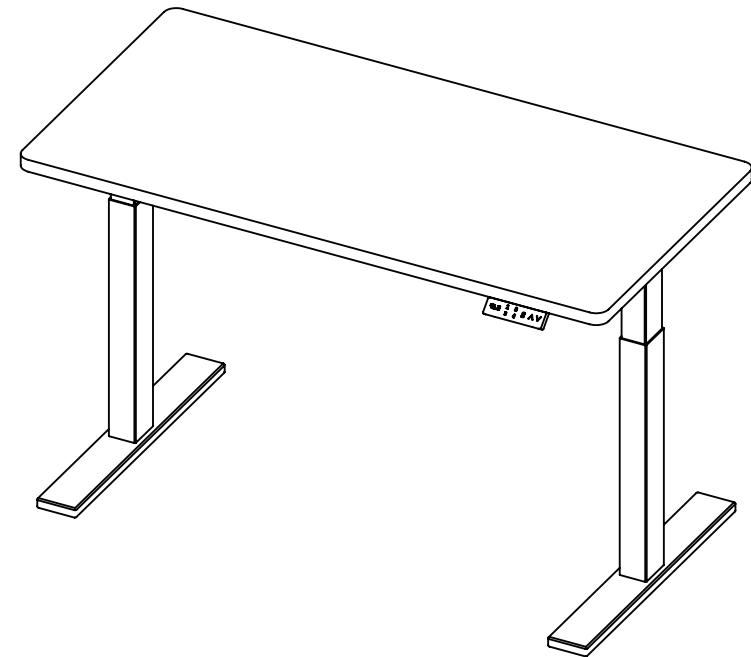

Sold & Serviced by



If you have any question , please do not hesitate to contact us

(+852) 2555-5555



ADDRESS : ROOM 2803, Sino Plaza, 255 Gloucester Road, Causeway Bay, Hong Kong

I-standing desk

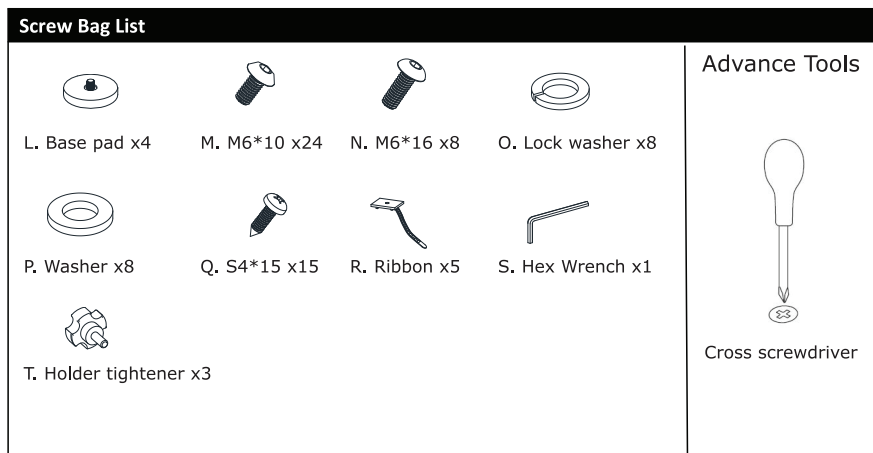
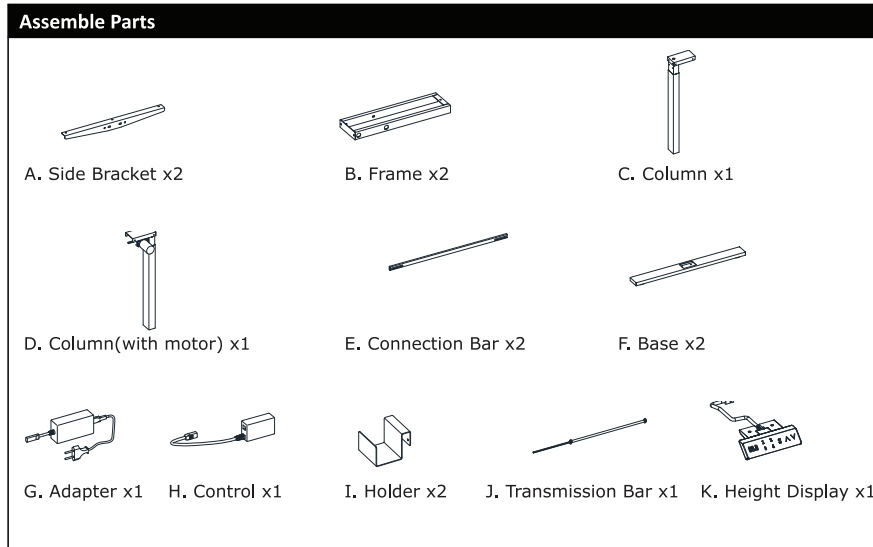

Control panel instruction

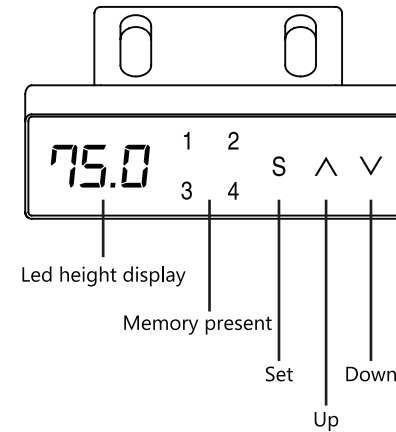

Reset

In first time or not functioning, please do reset operation

Hold down button ∇ , system will enter initialization mode show *RSF*

Keep pressing until led display shows the height number

Height memory present

Press \wedge / ∇ to find desired height, press **S**, followed by number 1-4

Lock and unlock

LOCK : Hold **S** + \wedge for 5 second, indicator shows *LOC*, the system will be locked

UNLOCK : Hold **S** + ∇ for 5 second, indicator shows *LOC* change to height number

Remark

Indicator show *HOT* after system is overheat or continuously work over 2 minutes

11

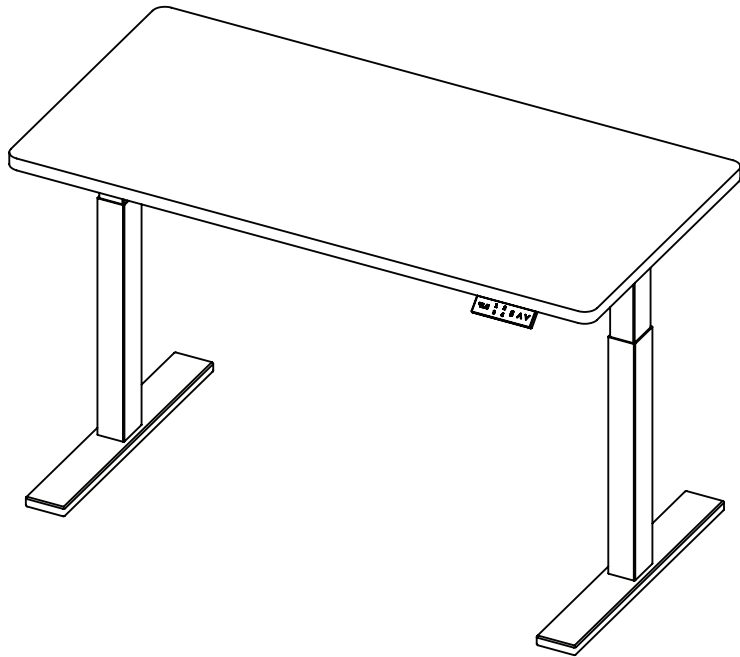

1 X2

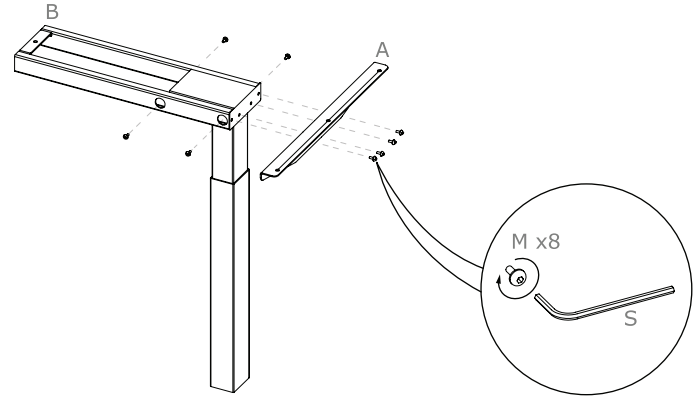

2

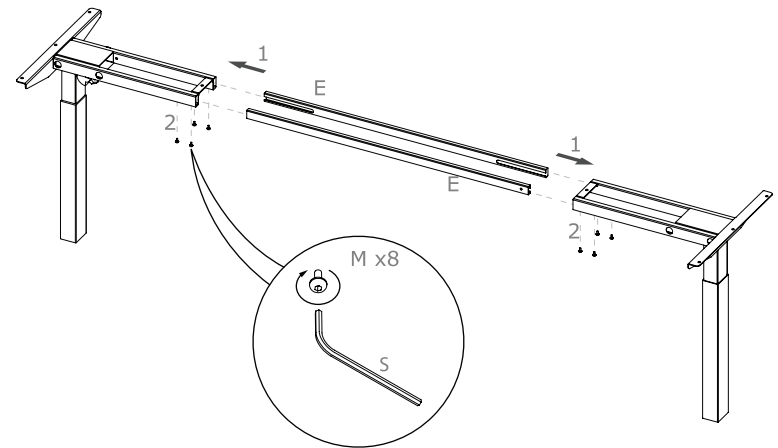

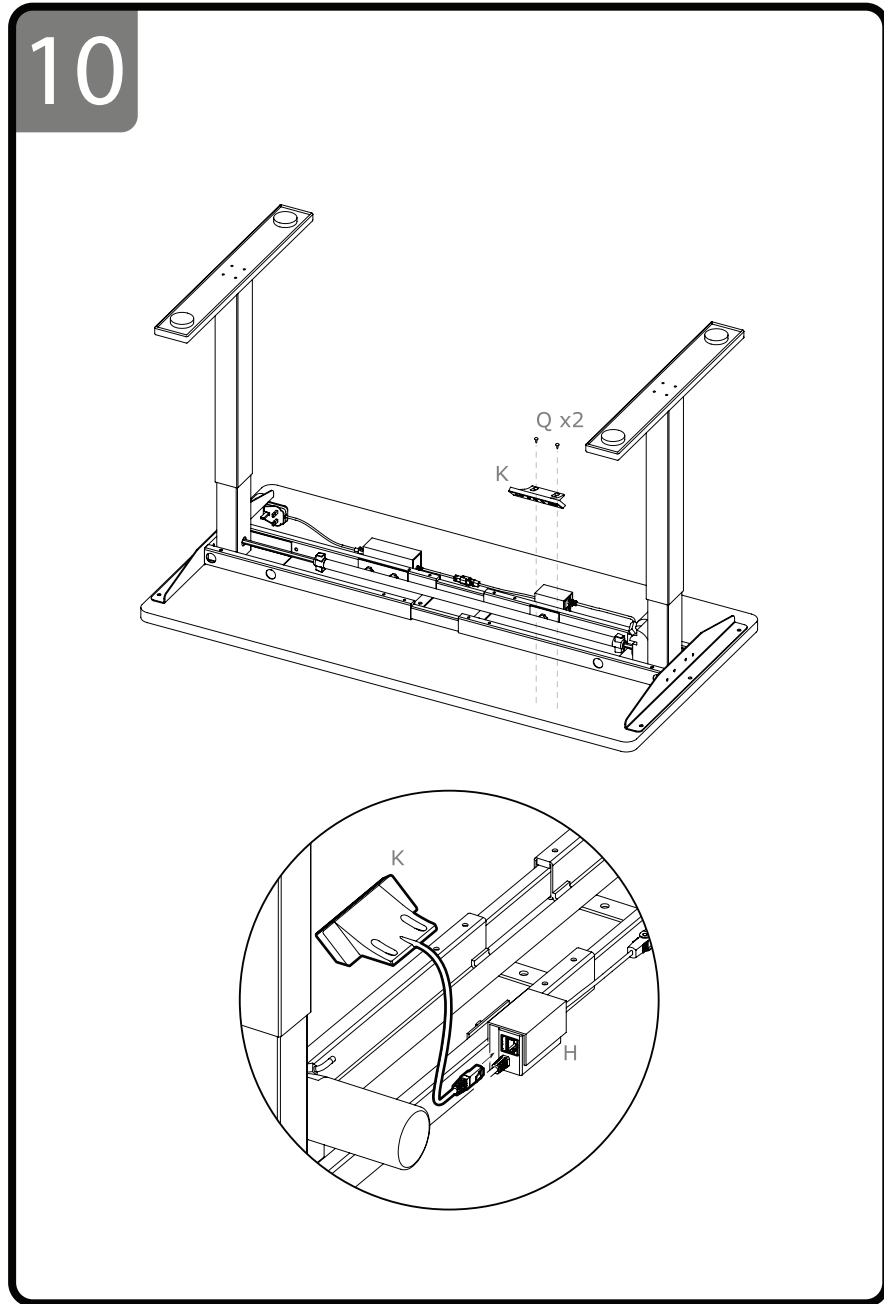
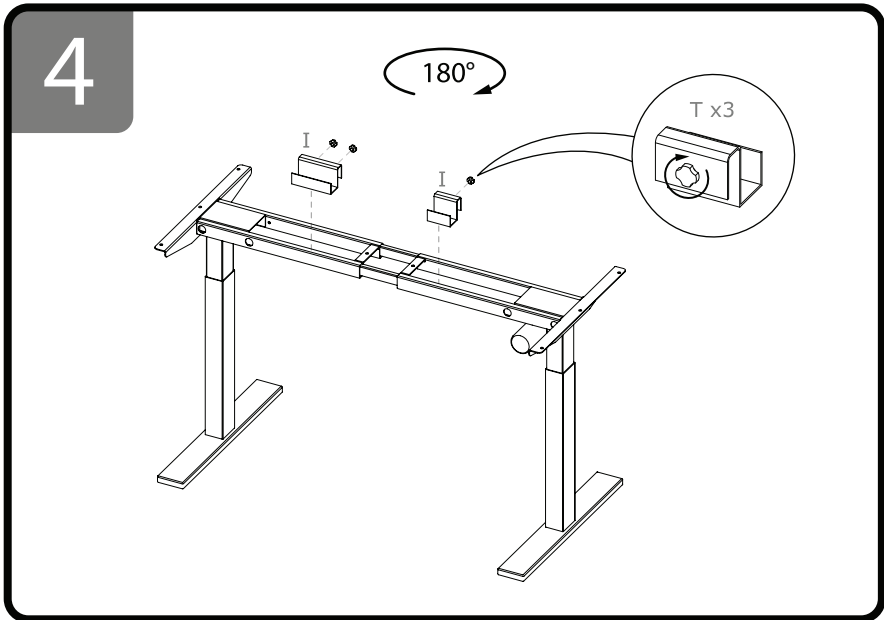
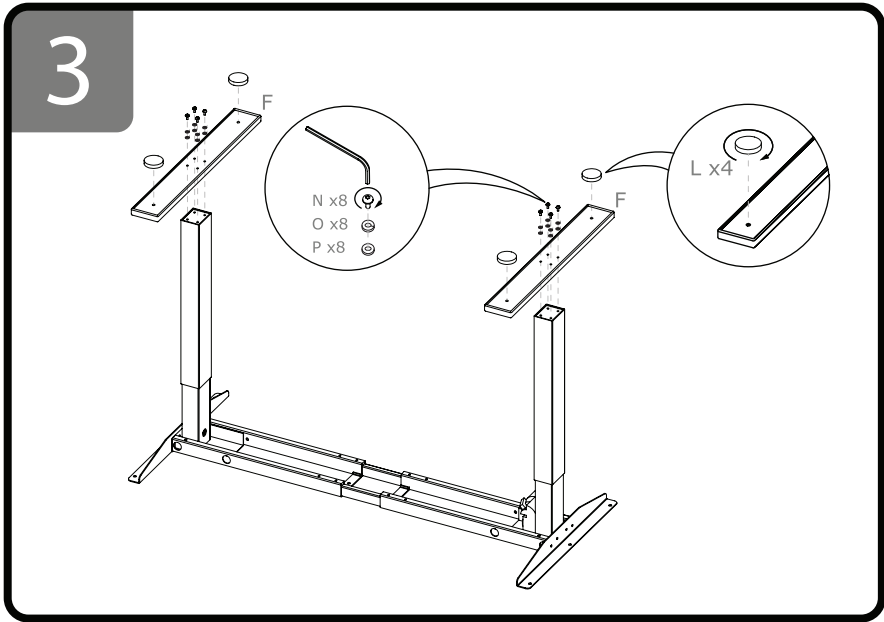

9

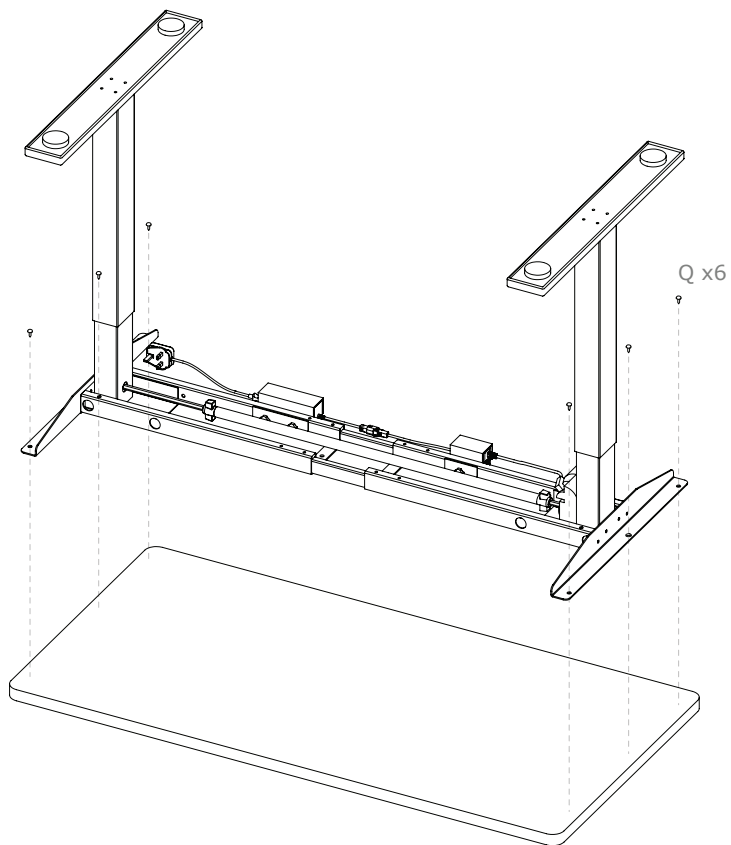

5

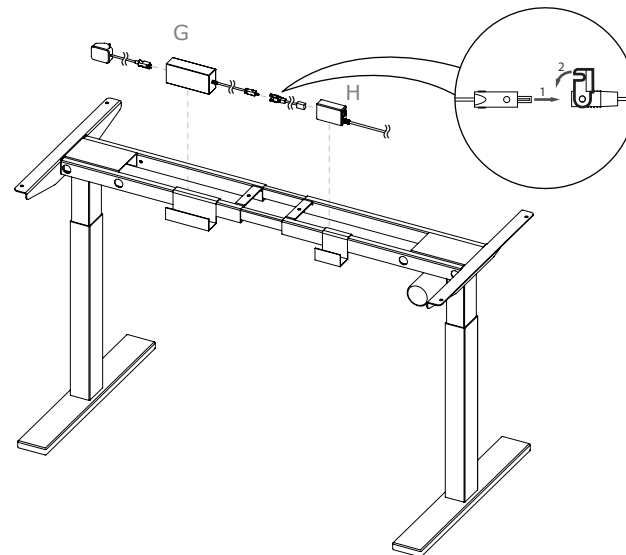

6

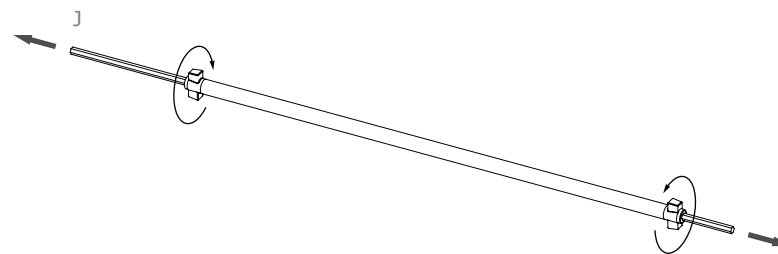

7

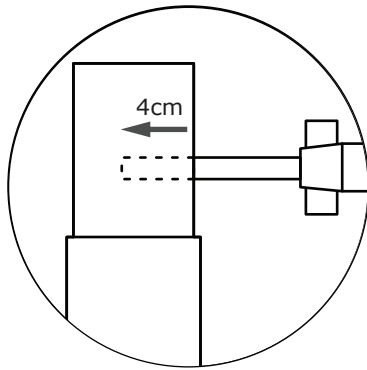
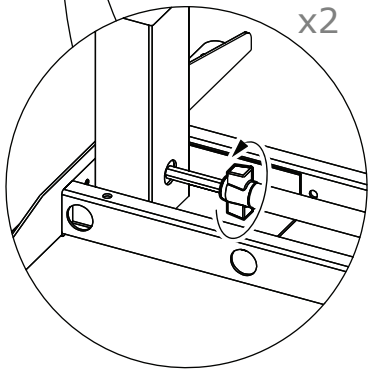
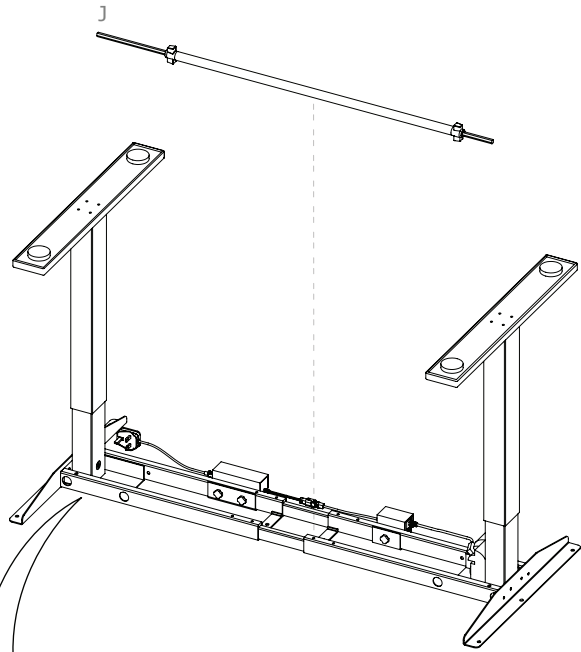

8

