

PRODOTTI / RICAMBI
PRODUCTS / SPARE PARTS
PRODUITS / PIÈCES DÉTACHÉES
PRODUKTE / ERSATZTEILE
PRODUCTOS / REPUESTOS

Appia
MADE IN ITALY

Esplosi: mod. “ 2-3 GR ”

01-03-2011

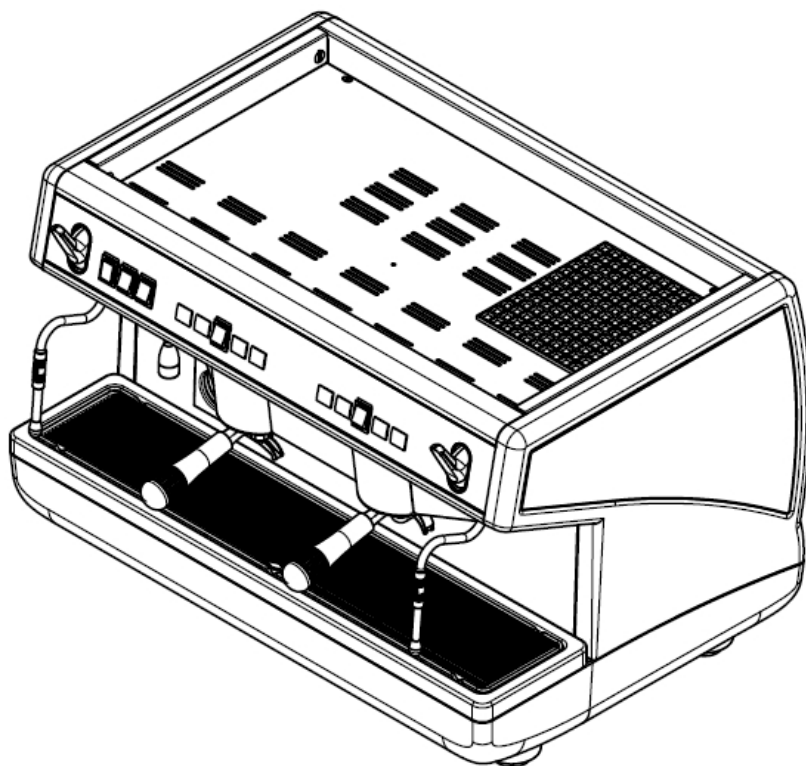

 nuova
SIMONELLI®

INDICE

- » **TAV 01 - COMPONENTI GRUPPO CARENA**
CABINET PARTS
- » **TAV 02 - COMPONENTI GRUPPO INVOLUCRO COMANDI**
CONTROL PANEL PARTS
- » **TAV 04 - COMPONENTI GRUPPO EROGAZIONE**
POURING UNIT GROUP PARTS
- » **TAV 05 - COMPONENTI IDRAULICI 2 GRUPPI**
HYDRAULIC PARTS 2 GROUPS
- » **TAV 05 - COMPONENTI IDRAULICI 3 GRUPPI**
BIS HYDRAULIC PARTS 3 GROUPS
- » **TAV 06 - COMPONENTI RUBINETTI VAPORE E ACQUA CALDA**
STEAM & HOT WATER VALVES PARTS
- » **TAV 08 - COMPONENTI GRUPPO IDRAULICO**
HYDRAULIC GROUP PARTS
- » **TAV 09 - COMPONENTI CALDAIA**
BOILER PARTS
- » **TAV 10 - COMPONENTI TELAIO**
FRAME PARTS
- » **TAV 11 - COMPONENTI ELETTRICI ED ELETTRONICI**
ELECTRONIC & ELECTRIC PARTS

» LEGENDA :

I CODICI SCRITTI IN GRASSETTO SI RIFERISCONO AI COMPONENTI IMPIEGATI ATTUALMENTE.

I CODICI IMPIEGATI PRIMA SONO SCRITTI IN CORSIVO CON INDICATA A FIANCO LA DATA DI FINE VALIDITA'.

ESEMPIO:

07300127 (ϕ 2.5) - 18/09/2007
07300226 (ϕ 2)

COMPONENTI GRUPPO CARENA

CABINET PARTS

A
P
P
I
A

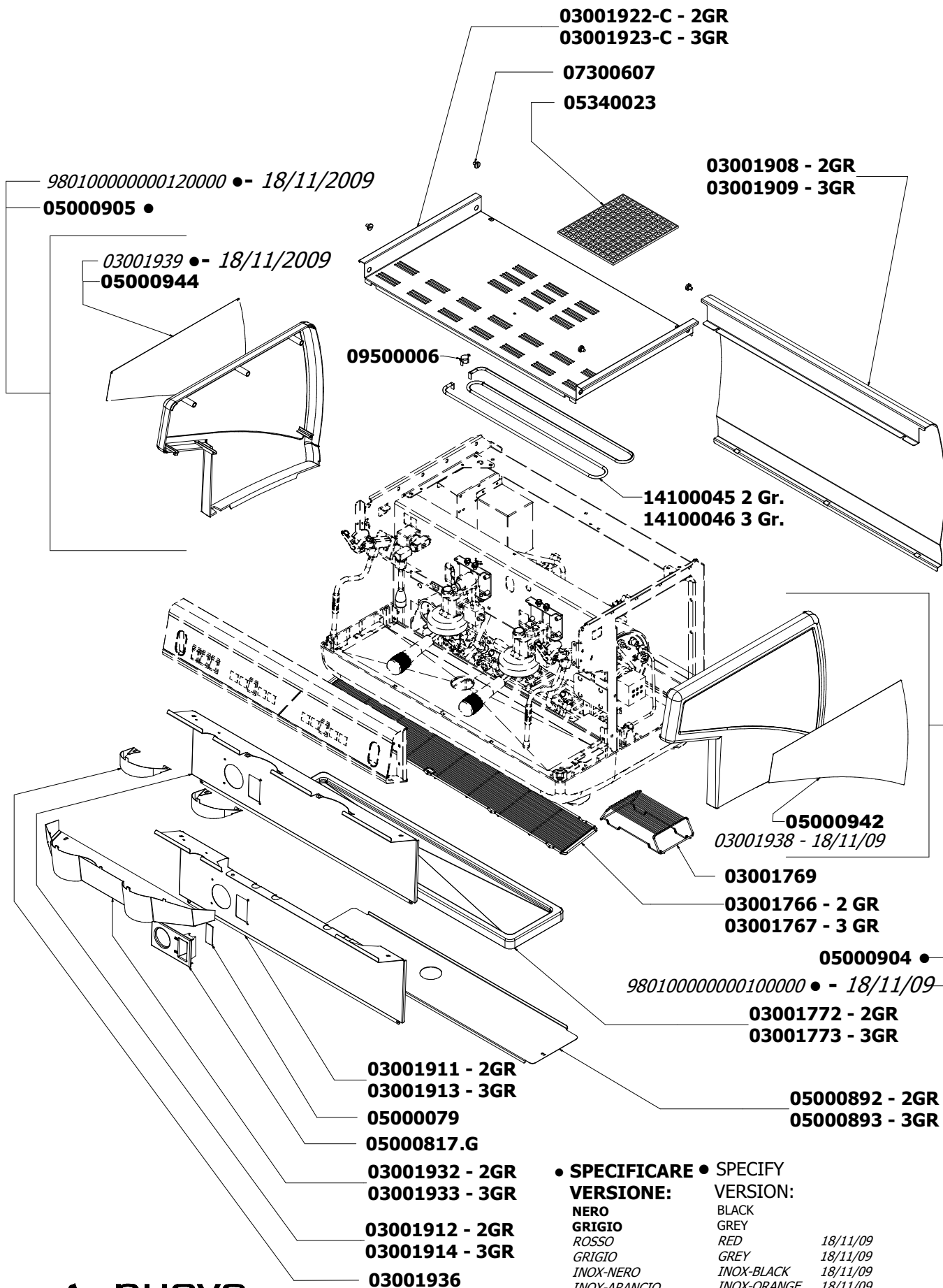

• **SPECIFICARE** • **SPECIFY**
VERSIONE: **VERSION:**
NERO BLACK
GRIGIO GREY
ROSSO RED 18/11/09
GRIGIO GREY 18/11/09
INOX-NERO INOX-BLACK 18/11/09
INOX-ARANCIO INOX-ORANGE 18/11/09
INOX-ROSSO INOX-RED 18/11/09
INOX-GRIGIO INOX-GREY 18/11/09

COMPONENTI GRUPPO INVOLUCRO COMANDI CONTROL PANEL PARTS

A
P
P
I
A

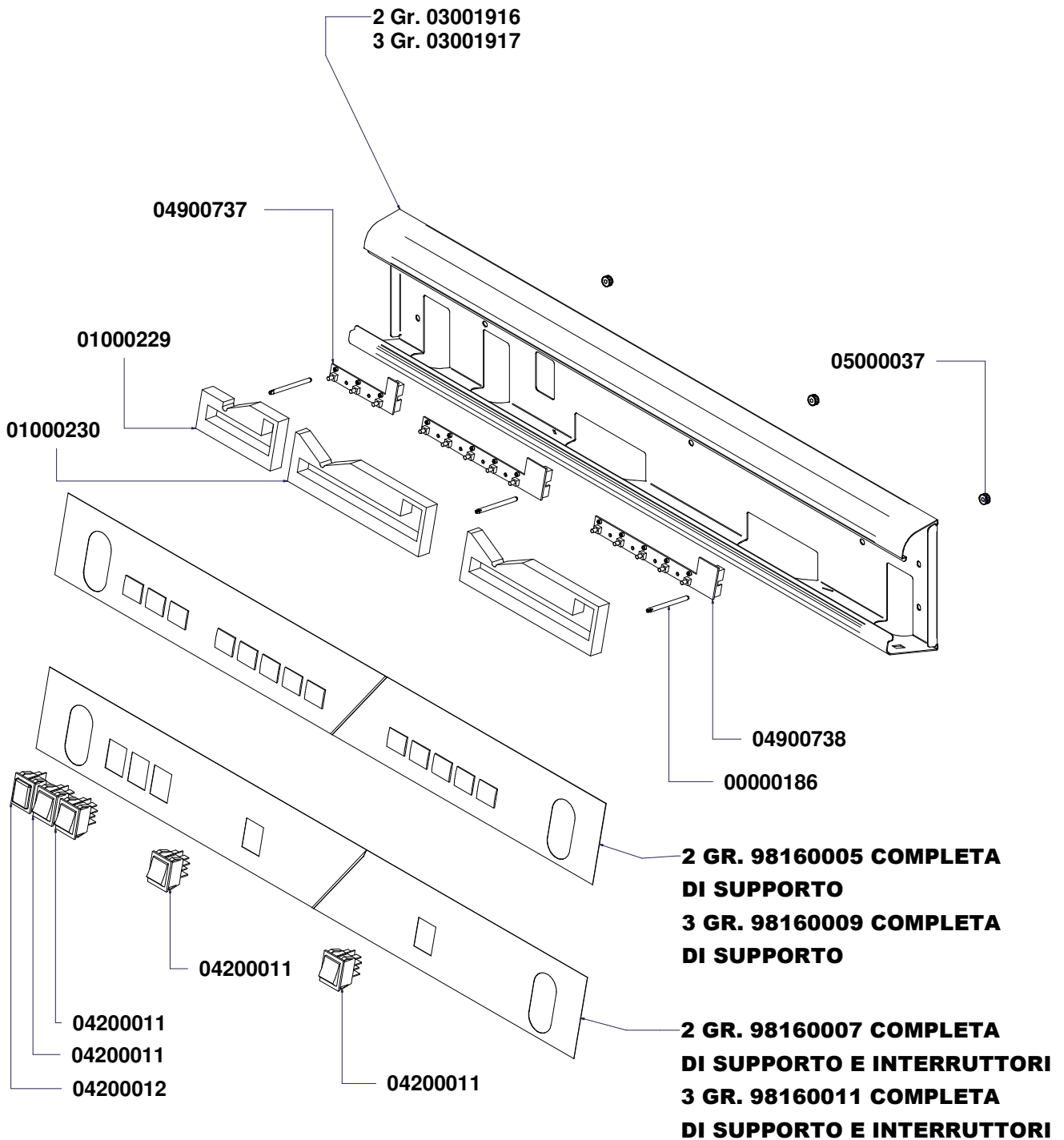

COMPONENTI GRUPPO EROGAZIONE

POURING UNIT GROUP PARTS

A
P
P
I
A

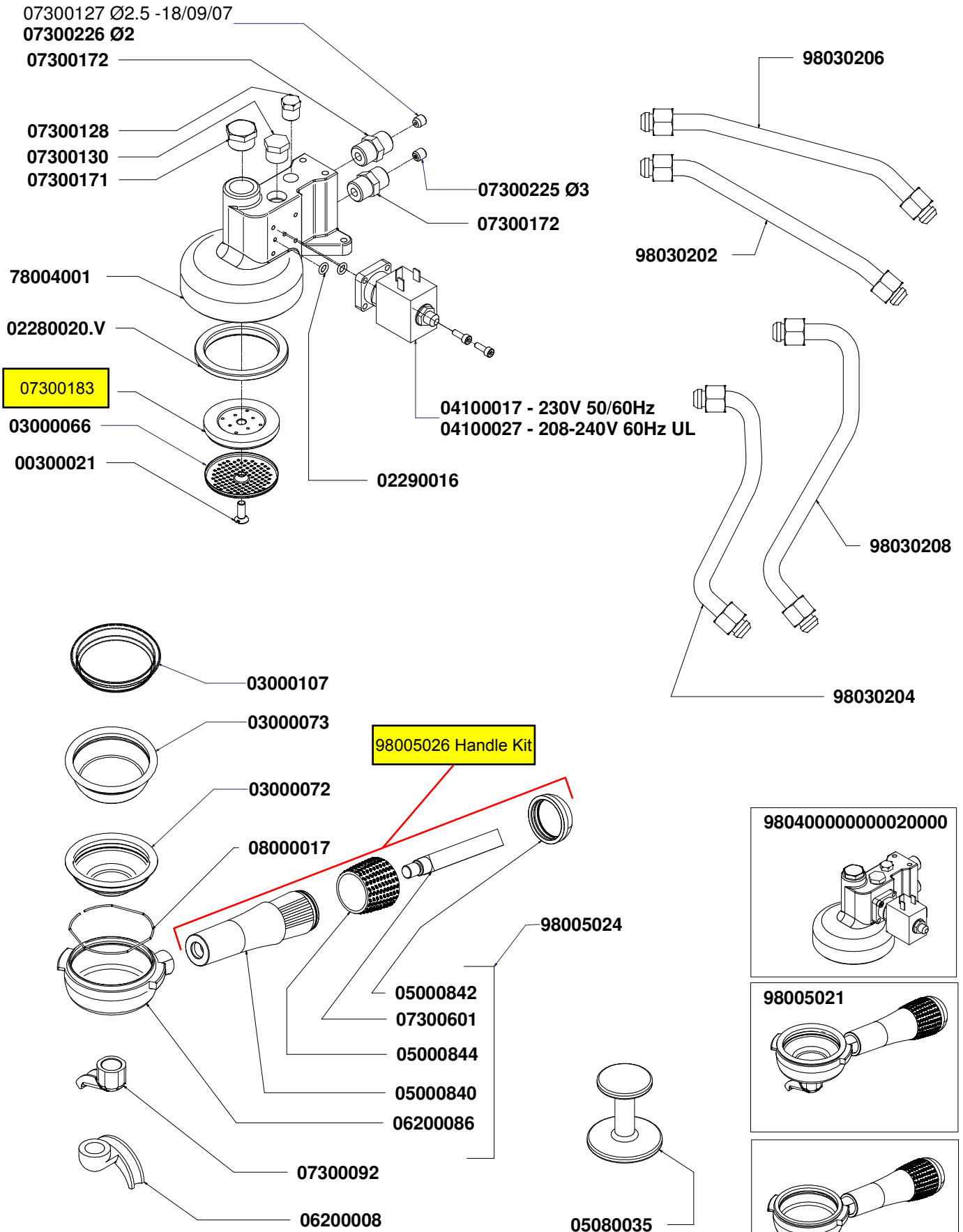

COMPONENTI IDRAULICI 2 GRUPPI

HYDRAULIC PARTS 2 GROUPS

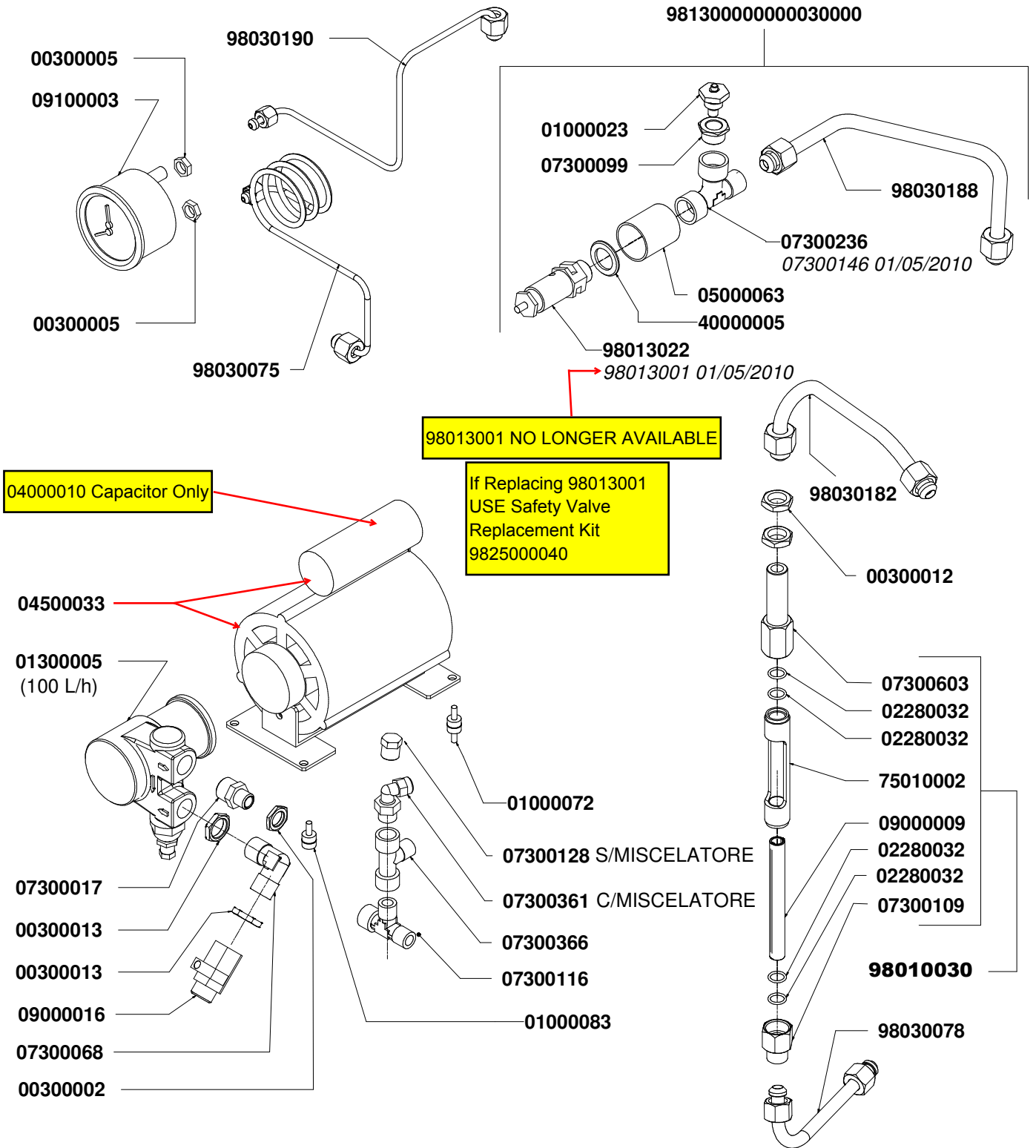

98013001 NO LONGER AVAILABLE

**If Replacing 98013001
USE Safety Valve
Replacement Kit
9825000040**

04000010 Capacitor Only

COMPONENTI IDRAULICI		
CODICE	DESCRIZIONE	DESCRIPTION
01000113	TUBO INGRESSO L=1500	FILLING TUBE L=1500
01000030	TUBO INGRESSO L=500	FILLING TUBE L=500
01000087	TUBO SCARICO	DRAINING TUBE
00000133	FASCETTA INOX	STAINLESS GIRDLE

COMPONENTI IDRAULICI 3 GRUPPI

HYDRAULIC PARTS 3 GROUPS

A
P
P
I
A

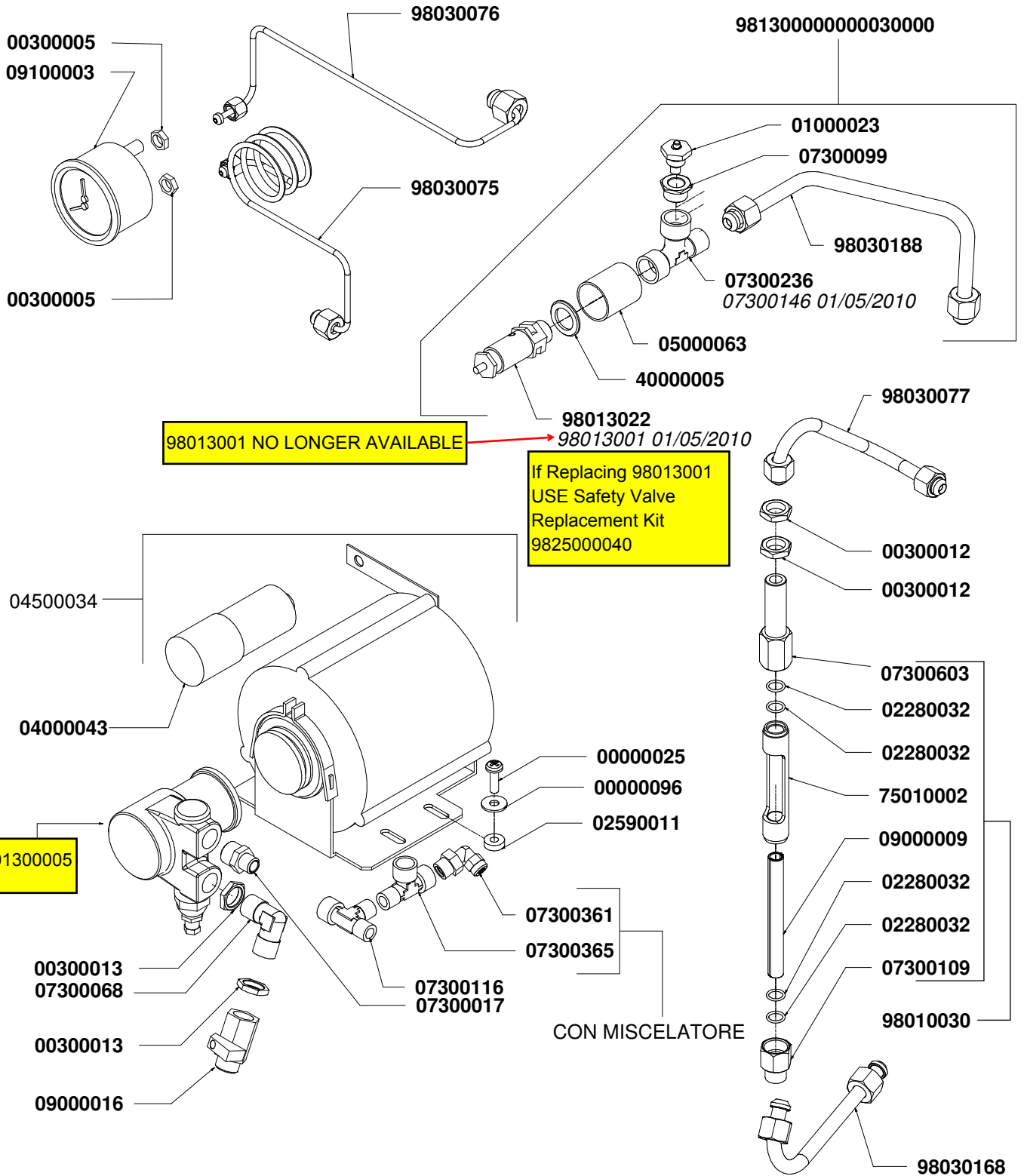

COMPONENTI IDRAULICI		
CODICE	DESCRIZIONE	DESCRIPTION
01000113	TUBO INGRESSO L=1500	FILLING TUBE L=1500
01000030	TUBO INGRESSO L=500	FILLING TUBE L=500
01000087	TUBO SCARICO	DRAINING TUBE
00000133	FASCETTA INOX	STAINLESS STEEL GIRDLE

COMPONENTI RUBINETTI VAPORE E ACQUA CALDA STEAM & HOT WATER VALVES PARTS

A
P
P
I
A

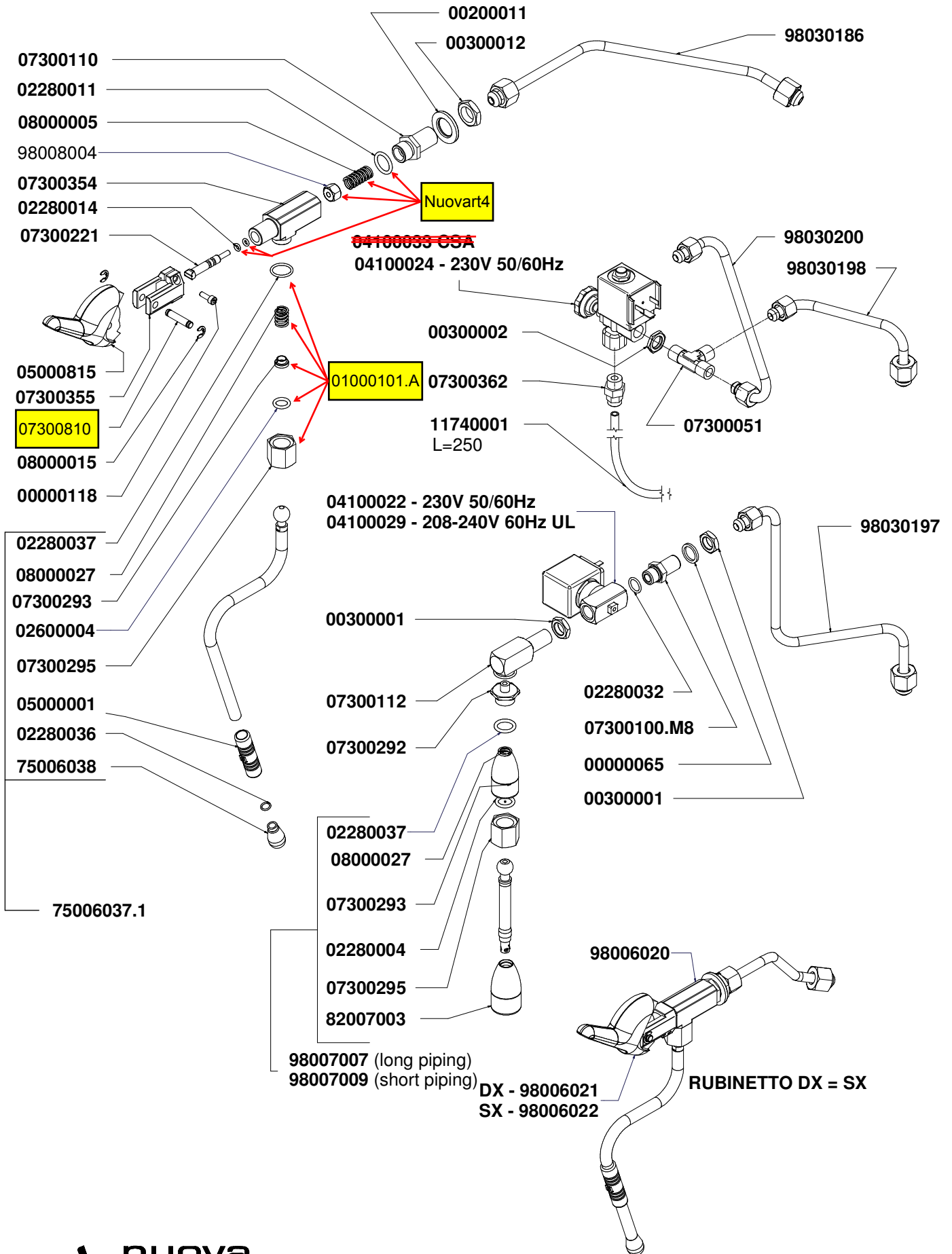

COMPONENTI GRUPPO IDRAULICO

HYDRAULIC GROUP PARTS

A
P
P
I
A

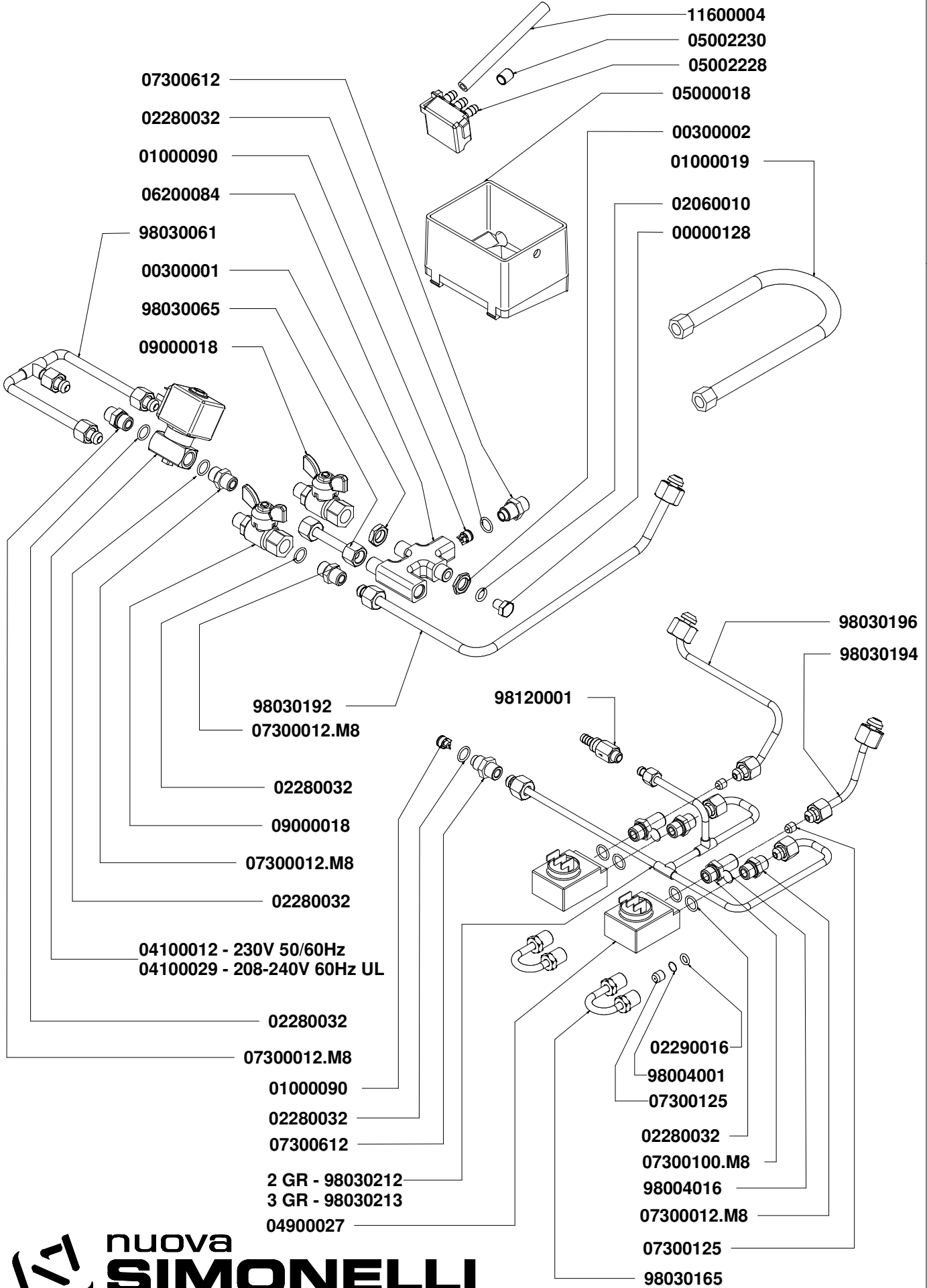

COMPONENTI CALDAIA BOILER PARTS

A
P
P
I
A

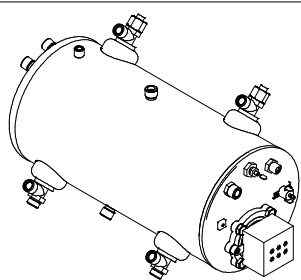

2 GR. - 98030000000020001 Complete

3 GR. - 98030000000030003 Complete

2GR - 98030142
3GR - 98030143

07300097

07300067

09500004

00000048

07300012.M8

09000005

07300017

98030055

02290016

98030184

09200006

00000050

05000047

00000094

14100011 - 2GR 230V 50/60Hz

14100032 - 3GR 230V 50/60Hz

02060015

COMPONENTI TELAIO FRAME PARTS

A
P
P
I
A

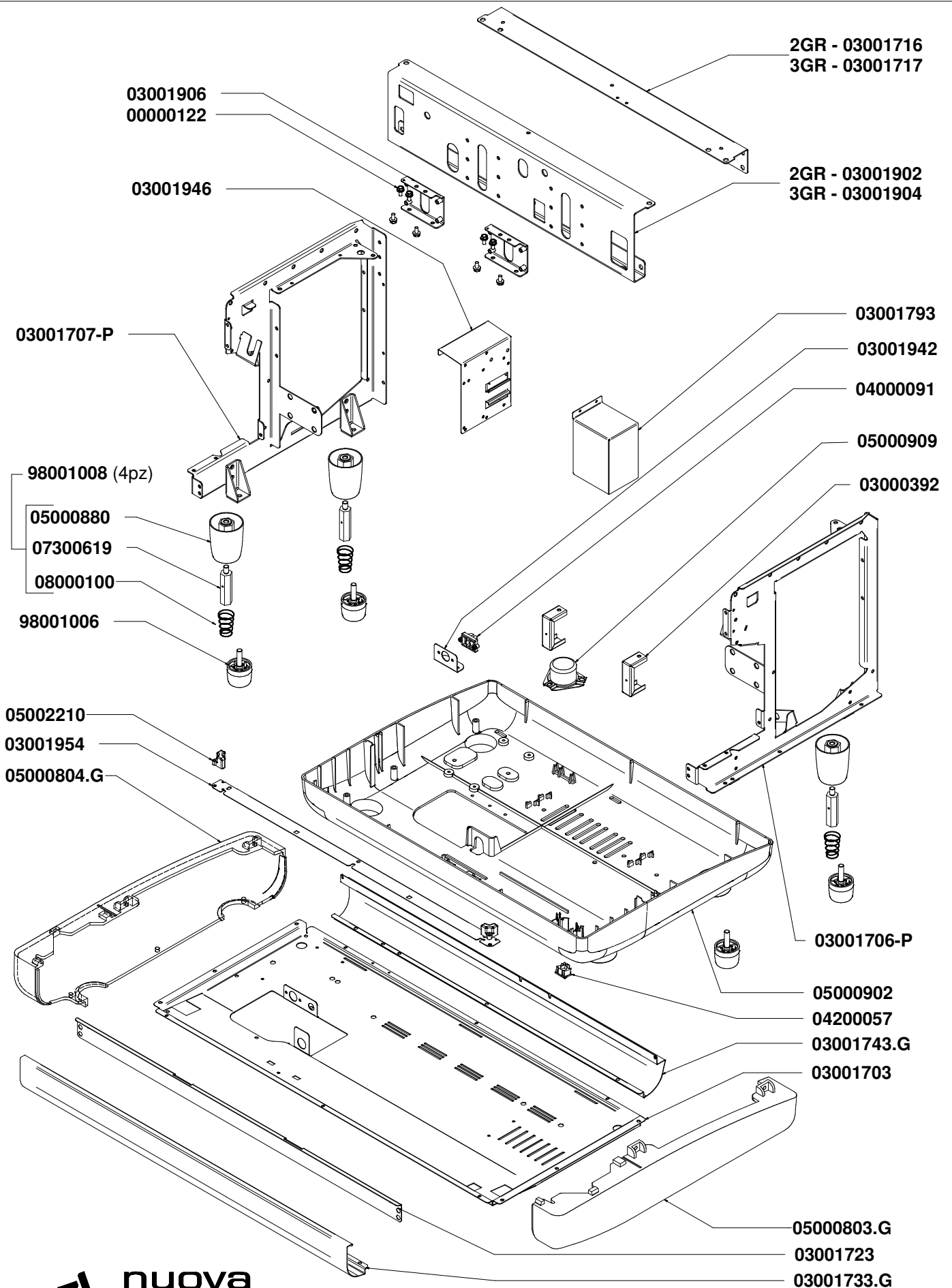

COMPONENTI ELETTRICI ED ELETTRONICI ELECTRONIC & ELECTRIC PARTS

A
P
P
I
A

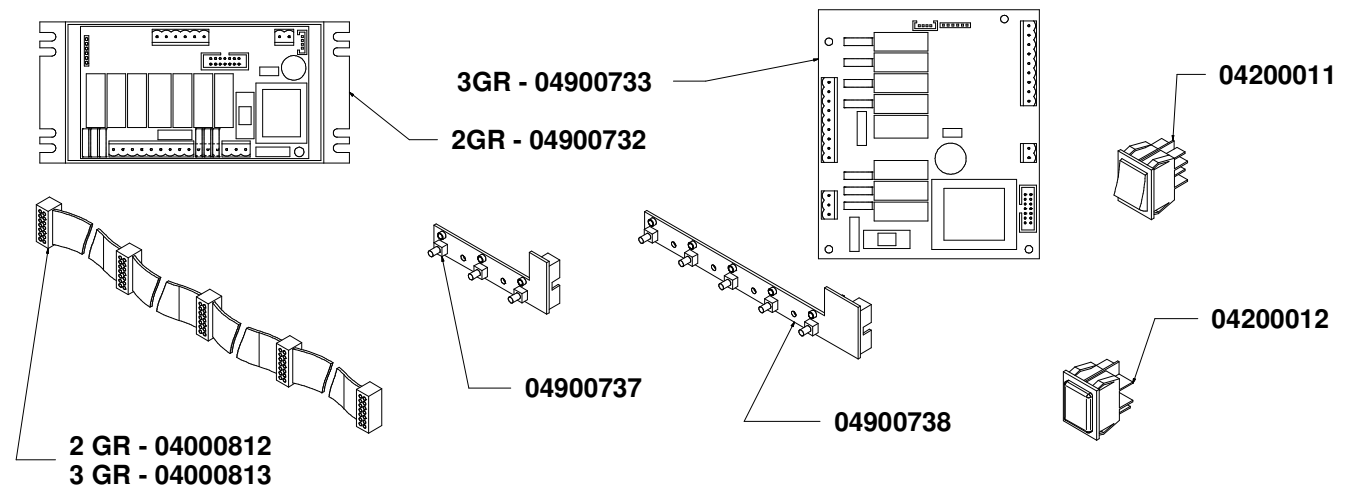

2 GR. 98160005 COMPLETA DI SUPPORTO
3 GR. 98160009 COMPLETA DI SUPPORTO

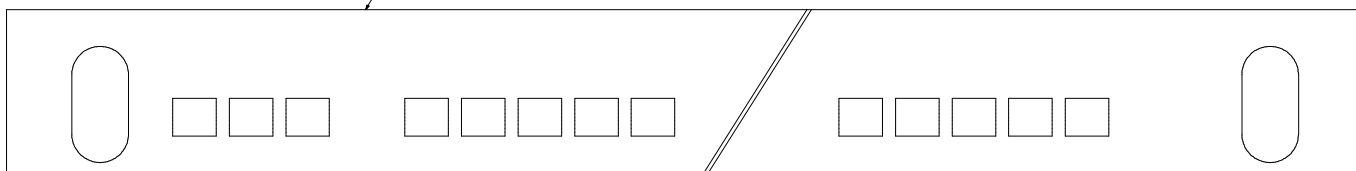

2 GR. 98160007 COMPLETA DI SUPPORTO E INTERRUTTORI
3 GR. 98160011 COMPLETA DI SUPPORTO E INTERRUTTORI

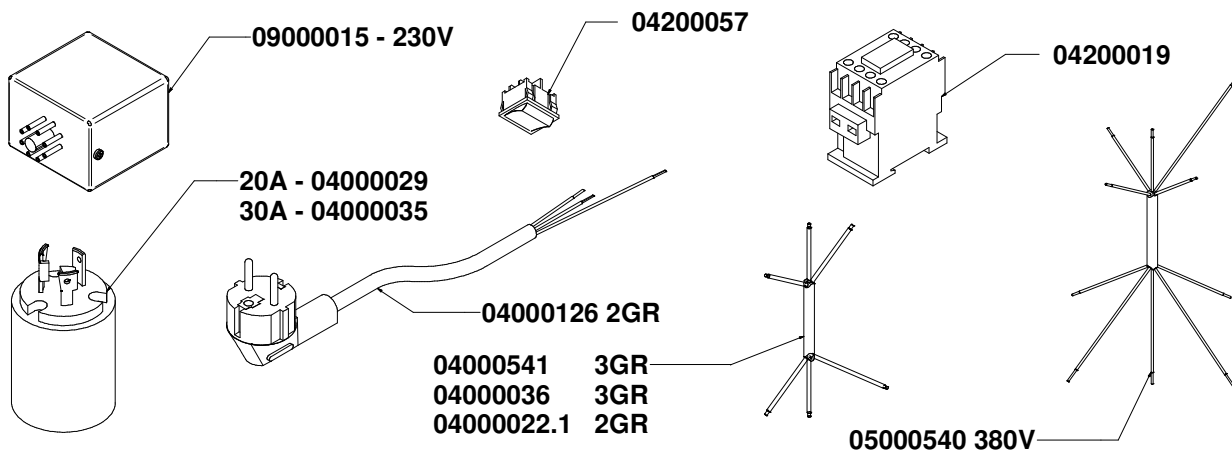
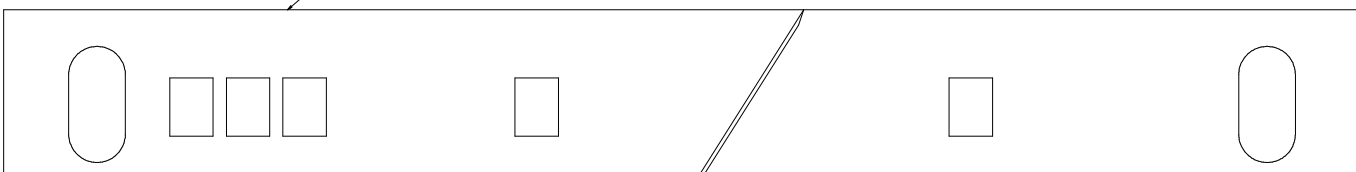

COMPONENTI ELETTRICI		
COD.	DESCRIZIONE	DESCRIPTION
04000805	IMPIANTO ELETTRICO 2GR V.	2GR VOL WIRING
04000807	IMPIANTO ELETTRICO 2GR S.	2GR SEM WIRING
04000807.P	IMP. ELET. PULSANTIERA 2GR S.	2GR SEM PUSH-BUTTON WIRING
04000808	IMPIANTO ELETTRICO 3GR V.	3GR VOL WIRING
04000809	IMPIANTO ELETTRICO 3GR S.	3GR SEM WIRING
04000809.P	IMP. ELET. PULSANTIERA 3GR S.	3GR SEM PUSH-BUTTON WIRING
04000806	IMP.ELETTRICO SCALDATAZZE	CUP WARMER WIRING

