

# POWER SMART<sup>®</sup>

## INSTRUCTION MANUAL

### DRYWALL SANDER

Model # PS4001

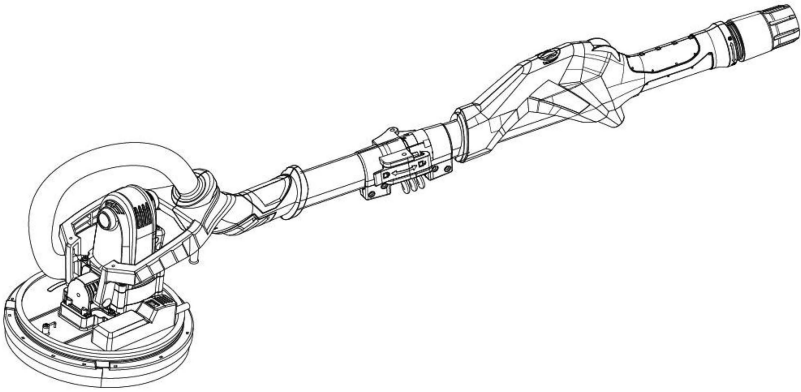

Have product questions or need technical support? Please scan the QR code to enter our official website and contact us!

Website: [www.powersmartusa.com](http://www.powersmartusa.com)

Toll free: 1-800-791-9458 M-F 9-5 EST

Email: [support@amerisuninc.com](mailto:support@amerisuninc.com)





## **CONTENTS**

Technical data .....	3
Introduction .....	4
Safety information .....	4
General safety rules.....	5
Special safety rules for drywall sander.....	8
Symbols .....	11
Knowing your drywall sander.....	13
Assembly instruction.....	14
Operating instruction.....	16
Maintenance.....	19
Trouble shooting.....	20
Exploded view.....	21
Parts list.....	22
Warranty statement.....	24

## **TECHNICAL DATA**

Drywall Sander	Model # PS4001
Motor:	120 V, 60 Hz,8.5A
No load speed:	600-2600 rpm
Rotation speed:	600-2300 rpm
Round sanding pad :	8.5 inches
Sandpaper Diameter:	9 inches
Hort-length (without extension tube):	43.3 inches
Long-length (with extension tube):	65 inches
Package dimensions (L x W x H):	26.7x11.9x11.4 inches
Weight:	13.2 lbs

## **INTRODUCTION**

Thank You for Purchasing a PowerSmart® Product. This manual provides information regarding the safe operation and maintenance of this product. Every effort has been made to ensure the accuracy of the information in this manual. PowerSmart® reserves the right to change this product and specifications at any time without prior notice.

Please keep this manual available to all users during the entire life of the power tool.



This manual contains special messages to bring attention to potential safety concerns, power tool damage as well as helpful operating and servicing information. Please read all the information carefully to avoid injury and machine damage.

### **QUESTIONS? PROBLEMS?**

Please contact our Customer Service Dept. with any questions and/or comments, either by Email: support@amerisuninc.com, or Toll Free at (800)791-9458. We are available Mon-Fri 9am-5pm EST to help solve any issues that you might encounter.

## **SAFETY INFORMATION**

Before operating this power tool, read and observe all warnings, cautions, and instructions on the power tool and in this Owner's Manual.

NOTE: The following safety information is not meant to cover all possible conditions and situations that may occur. Read the entire Owner's Manual for safety and operating instructions. Failure to follow instructions and safety information could result in serious injury or death.

This safety alert symbol is used to identify safety information about hazards that can result in personal injury.



A signal word (DANGER, WARNING, or CAUTION) is used with the alert symbol to indicate the likelihood and the potential severity of injury. In addition, a hazard symbol may be used to represent the type of hazard.

**DANGER** Indicates a hazard, which, if not avoided, will result in death or serious injury.

**WARNING** Indicates a hazard, which, if not avoided, could result in death or serious injury.

**CAUTION** Indicates a hazard, which, if not avoided, might result in minor or moderate injury.

**CAUTION** Without the alert symbol, indicates a situation that could result in damage.

## GENERAL SAFETY RULES

Safety is a combination of common sense, staying alert, and knowing how your power tool works. **SAVE THESE SAFETY INSTRUCTIONS.**



**WARNING:** Do not operate this unit until you read this instruction manual for safety, operation and maintenance instructions. Failure to follow all instructions listed below may result in electric shock, fire, and/or serious personal injury.

### **WORK AREA SAFETY**

- Keep your work area clean and well lit. Cluttered benches and dark areas invite accidents.
- Do not operate power tools in explosive atmospheres, such as in the presence of flammable liquids, gases, or dust. Power tools create sparks which may ignite the dust or fumes.
- Keep bystanders, children, and visitors away while operating a power tool. Distractions can cause you to lose control.

### **ELECTRICAL SAFETY**

#### **Grounding instructions**

IN THE EVENT OF A MALFUNCTION OR BREAKDOWN, grounding provides the path of least resistance for electric current and reduces the risk of electric shock. This tool is equipped with an electric cord that has an equipment grounding conductor and a grounding plug. The plug **MUST** be plugged into a matching outlet that is properly installed and grounded in accordance with **ALL** local codes and ordinances.

**DO NOT MODIFY THE PLUG PROVIDED.** If it will not fit the outlet, have the proper outlet installed by a licensed electrician.

**IMPROPER CONNECTION** of the equipment grounding conductor can result in electric shock. The conductor with the green insulation (with or without yellow stripes) is the equipment grounding conductor. If repair or replacement of the electric cord or plug is necessary, **DO NOT** connect the equipment grounding conductor to a live terminal.

**CHECK** with licensed electrician or service personnel if you do not completely understand the grounding instructions, or if you are not sure if the tool is properly grounded.

**USE ONLY THREE-WIRE EXTENSION CORDS** that have 3-pronged plugs and outlets that accept the tool's plug as shown in Fig. A. Repair or replace a damaged or worn cord immediately.

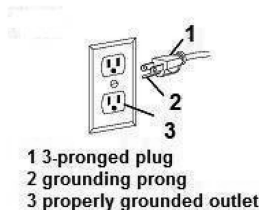

**CAUTION:** In all cases, make certain the outlet in question is properly grounded. If you are not sure if it is, have a licensed electrician check the outlet.



**WARNING:** Do not expose to rain or use in damp locations.

### Guidelines for using extension cords

Make sure your extension cord is in good condition. When using an extension cord, be sure to use one heavy enough to carry the current your product will draw. An undersized cord will cause a drop in line voltage resulting in loss of power and overheating. The table below shows the correct size to be used according to cord length and nameplate ampere rating. If in doubt, use the next heavier gauge. The smaller the gauge number, the heavier the cord.

**Minimum Gauge for Extension Cords (AWG)**  
(When using 120 V only)

Ampere Rating		Total Length of Cord in feet			
More Than	Not More Than	25	50	100	150
0	6	18	16	16	14
6	10	18	16	14	12
10	12	16	16	14	12
12	16	14	12	Not Recommended	

Make sure your extension cord is properly wired and in good condition. Always replace a damaged extension cord or have it repaired by a qualified person before using it.

Protect your extension cords from sharp objects, excessive heat and damp or wet areas.

Use a separate electrical circuit for your tools. This circuit must not be less than a #12 wire and should be protected with a 15 A time-delayed fuse. Before connecting the motor to the power line, make sure the switch is in the OFF position and the electric current is rated the same as the current stamped on the motor nameplate. Running at a lower voltage will damage the motor.



**WARNING:** This tool must be grounded while in use to protect the operator from electric shock.

### PERSONAL SAFETY

- Stay alert, watch what you are doing and use common sense when operating the tool. Do not use the tool while you are tired or under the influence of drugs, alcohol or medication. A moment of inattention while operating tools may result in serious personal injury.
- Dress properly. Do not wear loose clothing or jewelry. Contain long hair. Keep your hair, clothing, and gloves away from moving parts. Loose clothes, jewelry, or long hair can be caught in moving parts.
- Avoid accidental starting. Be sure switch is off before connecting to power source, pick up or carrying the tool. Carrying power tools with your finger on the switch or energizing power tools that have the switch on invites accidents.

- Do not overreach. Keep proper footing and balance at all times. Proper footing and balance enable better control of the power tool in unexpected situations.

## **POWER TOOL USE AND CARE**

- Do not force tool. Use the correct tool for your application. The correct tool will do the job better and safer at the rate for which it is designed.
- Do not use the tool if switch does not turn it on or off. Any tool that cannot be controlled with the switch is dangerous and must be repaired.
- Disconnect the plug from the power source before making any adjustments, changing accessories, or storing the tool. Such preventive safety measures reduce the risk of starting the tool accidentally.
- Inspect guards before using a tool. Keep guards in place. Check moving parts for binding or any other condition that may affect the normal operation or safety features of the tool. If damaged, have tool serviced before using the tool. Many accidents are caused by poorly maintained tools.
- Do not alter or misuse tool. Any alteration or modification is a misuse and may result in serious personal injury.
- Maintain power tools. Check for misalignment or binding of moving parts, breakage of parts and any other condition that may affect the power tool's operation. If damaged, have the power tool repaired before use. Many accidents are caused by poorly maintained power tools.
- The use of any other accessories not specified in this manual may create a hazard. Accessories that may be suitable for one type of tool, may become hazardous when used on an inappropriate tool.
- Store idle power tools out of reach of children and other untrained persons. Power tools are dangerous in the hands of untrained users.
- Use the power tool, accessories and tool bits etc., in accordance with these instructions, taking into account the working conditions and the work to be performed. Use of the power tool for operations different from those intended could result in a hazardous situation.
- Save these instructions. Refer to them frequently and use them to instruct others who may use this tool. If you lend this tool to someone else, also lend them these instructions.

## **SERVICE**

- Tool service must be performed only by qualified repair personnel. Service or maintenance performed by unqualified personnel could result in a risk of injury.
- When servicing a tool, use only identical replacement parts. Follow instructions in the maintenance section of this manual. Use of unauthorized parts or failure to follow maintenance instructions may create a risk of electric shock or injury.

## **GENERAL**

- This tool should not be used by people under the age of 16 years.
- This tool is not intended for use by persons (including children) with reduced physical, sensory or mental capabilities, or lack of experience and knowledge, unless they have been given supervision or instruction concerning use of the tool by a person responsible for their safety.
- Ensure that children do not play with the tool.
- This tool is not suitable for wet sanding.

## **SPECIFIC SAFETY RULES FOR DRYWALL SANDER**

- This power tool is intended to function as a polisher. Read all safety warnings, instructions, illustrations and specifications provided with this power tool. Failure to follow all instructions listed below may result in electric shock, fire and/or serious injury.
- This power tool is not recommended for grinding, sanding, wire brushing or cutting off operations. Operations for which the power tool was not designed may create a hazard and cause personal injury.
- Do not use accessories which are not specifically designed and recommended by the tool manufacturer. Just because the accessory can be attached to your power tool, it does not assure safe operation.
- The rated speed of the accessory must be at least equal to the maximum speed marked on the power tool. Accessories running faster than their rated speed can fly apart.
- The outside diameter and the thickness of your accessory must be within the capacity rating of your power tool. Incorrectly sized accessories cannot be adequately guarded or controlled.
- The arbour size of wheels, flanges, backing pads or any other accessory must properly fit the spindle of the power tool. Accessories with arbour holes that do not match the mounting hardware of the power tool will run out of balance, vibrate excessively and may cause loss of control.
- Do not use a damaged accessory. Before each use inspect the accessory such as abrasive wheels for chips and cracks, backing pads for cracks, tear or excess wear, wire brushes for loose or cracked wires. If the power tool or accessory is dropped, inspect for damage or install an undamaged accessory. After inspecting and installing an accessory, position yourself and bystanders away from the plane of the rotating accessory and run the power tool at maximum no load speed for one minute. Damaged accessories will normally break apart during this test time.
- Wear personal protective equipment. Depending on application, use face shield, safety goggles or safety glasses. As appropriate, wear dust mask, hearing protectors, non-skid safety shoes, gloves and shop apron capable of stopping small abrasive or work piece fragments. The eye protection must be capable of stopping flying debris generated by various operations. The dust mask or respirator must be capable of filtering particles generated by your operation. Prolonged exposure to high intensity noise may cause hearing loss.
- Only use safety equipment that has been approved by an appropriate standards agency. Unapproved safety equipment may not provide adequate protection. Eye protection must be ANSI-approved and breathing protection must be NIOSH-approved for the specific hazards in the work area.
- Keep bystanders a safe distance away from work area. Anyone entering the work area must wear personal protective equipment. Fragments of the work piece or of a broken accessory may fly away and cause injury beyond the immediate area of operation.
- Hold power tool by insulated gripping surfaces only, when performing an operation where the cutting accessory may contact hidden wiring or its own cord. A cutting accessory contacting a "live" wire may make exposed metal parts of the power tool "live" and could give the operator an electric shock.
- Position the cord clear of the spinning accessory. If you lose control, the cord may be cut or snagged and your hand or arm may be pulled into the spinning accessory.
- Never lay the power tool down until the accessory has come to a complete stop. The spinning accessory may grab the surface and pull the power tool out of your control.
- Do not run the power tool while carrying it at your side. Accidental contact with the spinning accessory could snag your clothing, pulling the accessory into your body.
- Regularly clean the power tool's air vents. The motor's fan will draw the dust inside the housing and excessive accumulation of powdered metal may cause electrical hazards.
- Do not operate the power tool near flammable materials. Sparks could ignite these materials.
- Do not operate with any guard disabled, damaged, or removed. Moving guards must move freely and close instantly.



- Maintain labels and nameplates on the tool. These carry important safety information.

## KICKBACK AND RELATED WARNINGS

- Kickback is a sudden reaction to a pinched or snagged rotating wheel, backing pad, brush or any other accessory. Pinching or snagging causes rapid stalling of the rotating accessory which in turn causes the uncontrolled power tool to be forced in the direction opposite of the accessory's rotation at the point of the binding.
- For example, if an abrasive wheel is snagged or pinched by the workpiece, the edge of the wheel that is entering into the pinch point can dig into the surface of the material causing the wheel to climb out or kick out. The wheel may either jump toward or away from the operator, depending on the direction of the wheel's movement at the point of pinching. Abrasive wheels may also break under these conditions.

Kickback is the result of power tool misuse and/or incorrect operating procedures or conditions and can be avoided by taking proper precautions as given below:

- Maintain a firm grip on the power tool and position your body and arm to allow you to resist kickback forces. Always use auxiliary handle, if provided, for maximum control over kickback or torque reaction during start-up. The operator can control torque reactions or kickback forces, if proper precautions are taken.
- Never place your hand near the rotating accessory. The accessory may kickback over your hand.
- Do not position your body in the area where power tool will move if kickback occurs. Kickback will propel the tool in the direction opposite to the wheel's movement at the point of snagging.
- Use special care when working corners, sharp edges etc. Avoid bouncing and nagging the accessory. Corners, sharp edges or bouncing have a tendency to snag the rotating accessory and cause loss of control or kickback.



**WARNING:** Some dust created by power sanding, sawing, grinding, drilling, and other construction activities contains chemicals known to the state of California to cause cancer, birth defects or other reproductive harm. Some examples of these chemicals are:

- lead from lead-based paints,
  - crystalline silica from bricks and cement and other masonry products, and
  - arsenic and chromium from chemically-treated lumber.
- Your risk from these exposures varies, depending on how often you do this type of work. To reduce your exposure to these chemicals: work in a well ventilated area, and work with approved safety equipment, such as those dust masks that are specially designed to filter out microscopic particles.
- Avoid prolonged contact with dust from power sanding, sawing, grinding, drilling, and other construction activities. Wear protective clothing and wash exposed areas with soap and water. Allowing dust to get into your mouth, eyes, or lay on the skin may promote absorption of harmful chemicals.



**WARNING:** Use of this tool can generate and/or disperse dust, which may cause serious and permanent respiratory or other injury. Always use NIOSH/OSHA approved respiratory protection appropriate for the dust exposure. Direct particles away from face and body.



**WARNING:** Do not operate this tool for long periods of time. Vibration caused by the operating action of this tool may cause permanent injury to fingers, hands, and arms. Use gloves to provide extra cushion, take frequent rest periods, and limit daily time of use.











## VIBRATION SAFETY





This tool vibrates during use. Repeated or long-term exposure to vibration may cause temporary or permanent physical injury, particularly to the hands, arms and shoulders. To reduce the risk of vibration-related injury:

- Anyone using vibrating tools regularly or for an extended period should first be examined by a doctor and then have regular medical check-ups to ensure medical problems are not being caused or worsened from use. Pregnant women or people who have impaired blood circulation to the hand, past hand injuries, nervous system disorders, diabetes, or Raynaud's Disease should not use this tool. If you feel any medical or physical symptoms related to vibration (such as tingling, numbness, and white or blue fingers), seek medical advice as soon as possible.
- Do not smoke during use. Nicotine reduces the blood supply to the hands and fingers, increasing the risk of vibration-related injury.
- Use tools with the lowest vibration when there is a choice between different processes.
- Include vibration-free periods each day of work.
- Grip workpiece as lightly as possible (while still keeping safe control of it). Let the tool do the work.
- To reduce vibration, maintain the tool as explained in this manual. If any abnormal vibration occurs, stop use immediately.

## SYMBOLS

Some of the following symbols may be used on this product. Please study them and learn their meaning. Proper interpretation of these symbols will allow you to operate the product better and safer.

SYMBOL	NAME	DESIGNATION/EXPLANATION
V	Volts	Alternating voltage
Hz	Hertz	Frequency (cycles per second)
W	Watts	Power
RPM	Per minute	Revolutions per minute
KG	Kilogram	Weight
dB(A)	Decibel(A-rated)	Decibel(A-rated)
mm	Millimetre	Size
M/S <sup>2</sup>	Meters per seconds squared	Speed
	Lock	To tighten or secure
	Unlock	To loosen
	Read the user's manual	To reduce the risk of injury, user must read and understand user's manual before using this product.
	Beware of the fragments of the work piece	Keep bystanders a safe distance away from work area. Fragments of the work piece or of a broken accessory may fly away.
	Eye protection	Wear eye protection when operating this equipment.
	Hearing protection	Use proper hearing protection when operating this equipment.
	Respiratory protection	Use proper respiratory protection when operating this equipment.
	Protective gloves	Wear protective gloves when operating this equipment.
	Protective, slip-resistant footwear	Wear protective, slip-resistant footwear when operating this equipment.
	Switch the product off	Switch the product off and disconnect it from power supply before assembly, cleaning, adjustments, maintenance, storage and transportation.

	WEEE Symbols	Waste electrical products should not be disposed of with household waste. Please recycle where facilities exist. Check with your Local Authority or local store for recycling advice.
	Wet conditions alert	Do not expose to rain or use in damp locations.
	Electric shock alert	Beware of electric shock hazard.
	Protection class II	This products is of protection class II. That means it is equipped with enhanced or double insulation.
	Safety Alert	Precautions that involve your safety.

# **KNOWING YOUR DRYWALL SANDER**

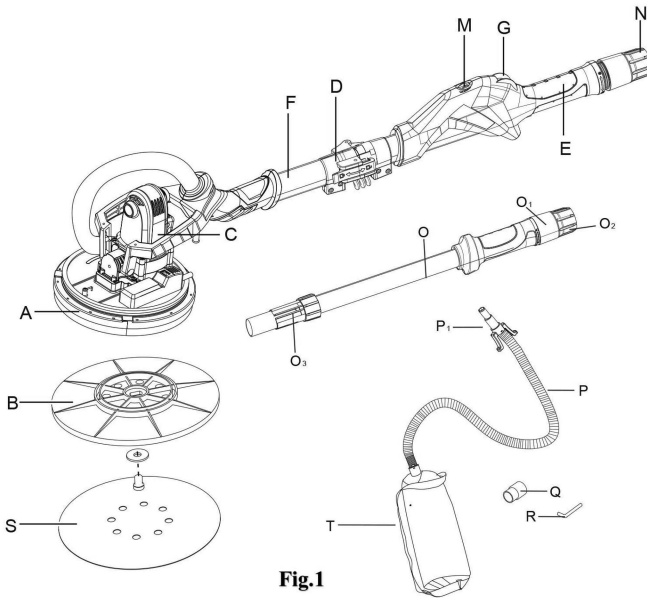

**Fig.1**

A	Round sanding head	O	Extension shaft
B	Round sanding pad (hook & loop system)	O1	Rear handle
C	Motor Housing( self-suction)	O2	Dust extraction outlet (with adjusting sleeve)
D	Folding lock	O3	Sleeve
E	Main handle	P	Vacuum hose
F	Shaft	P1	Support adaptor
G	On/ Off switch	Q	Vacuum adaptor(pre-assembled)(1.38")
M	Electronic speed control wheel	P	Hex wench S5
N	Dust extration outlet(with locking sleeve)	S	Round sanding disc
		T	Dust bag

## **Unpacking**

Unpack the power tool and all its parts, and compare against the list below. Do not discard the carton or any packaging materials. Please call (800) 791-9458 or E-mail us at support@amerisuninc.com if any parts are damaged or missing.

Including: Drywall sander/5pcs Sanding paper (60#,120#,150#,180#,240#)/2pcs Vacuum adaptors (1.38", 1.85") /Connector (1.50") /Dust bag/Hex wrench S5/Vacuum hose /User manual

## ASSEMBLY INSTRUCTION



### **WARNING:**

Do not use this product if any parts on the packing list are already assembled to your product when you unpack it. Parts on this list are not assembled to the product by the manufacturer and require customer installation. Use of a product that may have been improperly assembled could result in serious personal injury.



### **WARNING:**

If any parts are damaged or missing do not operate this product until the parts are replaced. Use of this product with damaged or missing parts could result in serious personal injury.



### **WARNING:**

Do not attempt to modify this product or create accessories not recommended for use with this product. Any such alteration or modification is misuse and could result in a hazardous condition leading to possible serious personal injury.



### **WARNING:**

Do not connect to power supply until assembly is complete. Failure to comply could result in accidental starting and possible serious personal injury.

## ASSEMBLY

### Shaft (Fig.2)

- Fold the front and back part together as shown in Fig.2-a.
- Push the folding lock to the right position and keep the tip adjacent to the handle as shown in Fig.2-b.
- Press the folding lock towards the handle until the end as shown in Fig.2-c. Unfold the handle by pushing the folding lock to the inside.

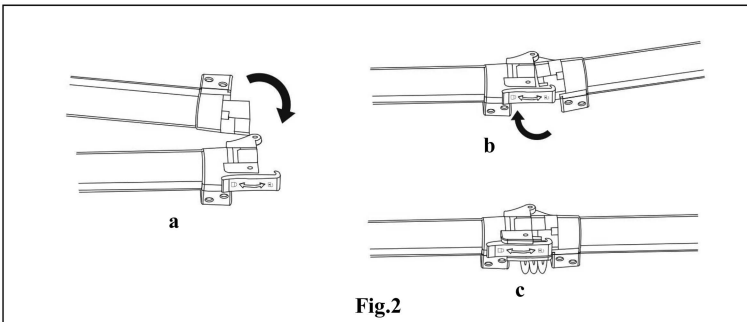

### Replace sanding pad (Fig.3)

- Insert the hex wrench (R) into the hexagonal screw bolt on the sanding block.
- Hold the sanding pad (B) firmly, and then turn the wrench counter clockwise to dismount the pad.
- Install new sanding pad by tightening the bolt.

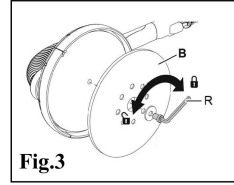

### Attaching and changing sanding disc (Fig.4)

- Place the sanding disc (S) in the center of the sanding pad (B) and press on. The holes in the sanding disc must be in alignment with the extraction holes in the sanding pad.
- For round sanding pad only: conduct a test run to check that the sanding disc is clamped in the centre.

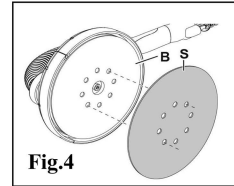

### WARNING:

Only install the specified sanding pad on the machine. In order to ensure optimal performance, the machine should be run at slightly lower speed for several minutes to make the grinding pad fit the sealing surface perfectly. During this process, the white foam particles will come out from the sanding head. However, this won't damage the machine.

### Extension shaft(optional) (Fig.5)

- Use the extension shaft (O) according to the intended operation for higher work surface.
- Loosen the sleeve on the dust extraction outlet (N) of the upper shaft (F) do not remove the sleeve from the outlet.
- Align the rear handle (O1) with the main handle (E) and insert the sleeve (O3) on the extension shaft (O) into the outlet (N) with a twist motion all the way to the stop.
- Adjust the length of the extension shaft (O) if necessary pay attention to the marking "max 1.65m" on the extension shaft.tighten the sleeve (N) after assembling/adjusting the extension shaft.

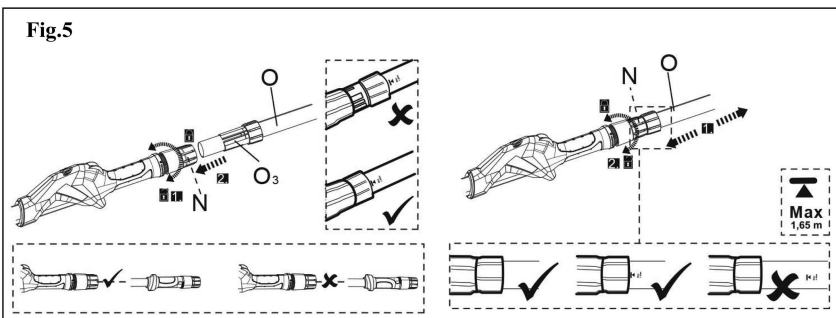

## Dust suction (Fig.6)

- Remove the vacuum hose (P) with dust bag from the product, if necessary.
- Hold the dust bag over a suitable rubbish bag.
- Pull the clasp off the dust bag and empty it into the rubbish bag.
- Slide the clasp onto the rails on the dust bag and re-attach the vacuum hose and dust bag to the product.

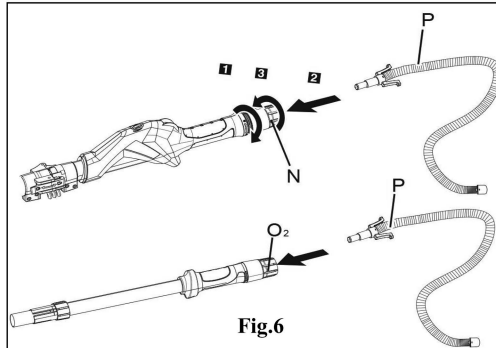

**NOTE:** A dust collection device is recommended to cut down on mess and the potentially harmful particulates in the air produced from sanding.

## OPERATING INSTRUCTION



**WARNING:** This tool is for indoor use only. DO NOT expose to rain or use in damp locations.

### Before use

- Before using the tool for the first time, it is recommended to receive practical information.
- Always check that the supply voltage is the same as the voltage indicated on the nameplate of the tool.
- Use suitable detectors to find hidden utility lines or call the local utility company for assistance (contact with electric lines can lead to fire or electrical shock; damaging a gas line can result in an explosion; penetrating a water pipe will cause property damage or an electrical shock).
- Do not work materials containing asbestos (asbestos is considered carcinogenic).
- Dust from material such as paint containing lead, some wood species, minerals and metal may be harmful (contact with or inhalation of the dust may cause allergic reactions and/or respiratory diseases to the operator or bystanders); wear a dust mask and work with a dust extraction device when connectable.
- Certain kinds of dust are classified as carcinogenic (such as oak and beech dust) especially in conjunction with additives for wood conditioning; wear a dust mask and work with a dust extraction device when connectable.
- Follow the dust-related national requirements for the materials you want to work with.
- Do not clamp the tool in a vice.



- Use completely unrolled and safe extension cords with a capacity of 16 Amps (U.K. 13 Amps) .

### Workpiece and work area set up

- Designate a work area that is clean and well-lit. The work area must not allow access by children or pets to prevent distraction and injury.
- Route the power cord along a safe route to reach the work area without creating a tripping hazard or exposing the cord to possible damage. The power cord must reach the work area with enough extra length to allow free movement while working.
- There must not be objects, such as utility lines, nearby that will present a hazard while working.

### After use

After switching off the tool, never stop the rotation of the accessory by a lateral force applied against it.

### USE

#### Switching the machine on and off (Fig.7/8)

- Turn on/off the drywall sander by switch (G) Electronic speed control as shown in Fig.7.
- Adjust the speed by turning the speed (M), user can choose different speed for different sanding surface as shown in Fig.8.
- Constant speed control Keep the machine running at the same speed as selected.
- Do not overload by excessive pressure.

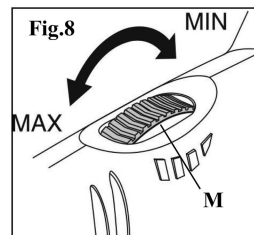
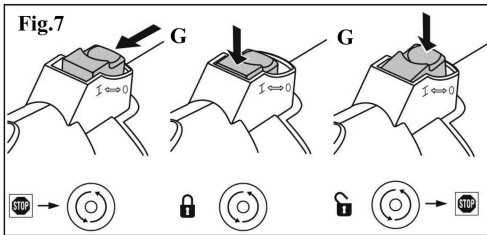

#### Tool standard/airflow control (Fig.9)

- Tool handle prevents the hose from damage when putting the tool aside during work breaks.
- Control the airflow by sliding suction power adjustment ring over the opening in tool connector.
- The vacuuming power is at its lowest level when the opening is fully visible.

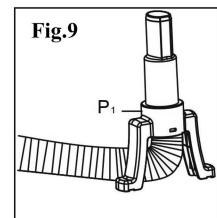

## SANDING OPERATIONS

Once the machine and vacuum cleaner are set up and all safety measures and equipment are in place, begin by turning on the vacuum cleaner and then the machine. (If you are using a vacuum cleaner with integrated switching, then simply turn the machine on.)



**WARNING:**

Ensure that the sanding disc you are using is suited to the task. Overly coarse grit paper may remove material too quickly to control. While overly fine grit paper may clog too often and not shape down the surface



**WARNING:**

Take care to avoid sharp projections and nails, etc. This will wipe out the sandpaper and probably damage the sponge pad as well.

### Round sanding head (Fig.10/11)

- Begin sanding and carefully contact the work surface as lightly as possible-just enough to keep the sanding head flat against the surface.
- The pivot point in the sanding head allow the sanding disc to follow the contours of the work surface.

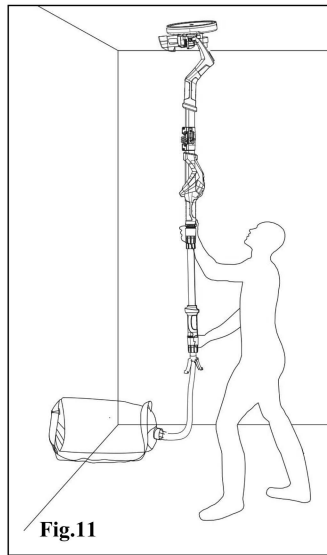
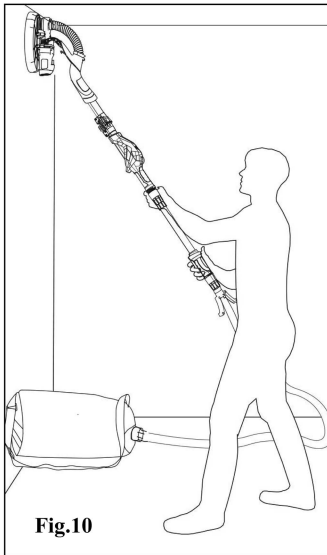

## Sanding ceiling (Fig.12)

- Put the rubber band into the pothook to fix the head, keep the sanding pad and handle vertical, keep the sanding pad and ceiling in same level, then we can use to sand the ceiling.
- The best technique is to use overlapping sweeps and keep the head in constant motion. Never stop too long in any one place or there will be swirl marks. With experience it will be very easy to create excellent results.

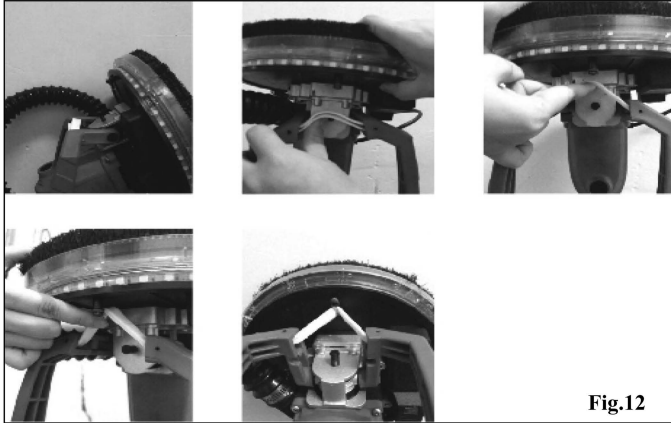

## MAINTENANCE



**WARNING:** Always turn the switch OFF, and unplug the power cord from the outlet before maintaining the drywall sander.



**WARNING:** When servicing, use only identical replacement parts. Use of any other parts could create a hazard or cause product damage.

- Store the tool in its protective case in a dry and locked up place, out of reach of children.
- Always keep tool and cord clean (especially ventilation slots).
- Periodically, wear ANSI-approved safety goggles and NIOSH-approved breathing protection.
- Store in a clean and dry location.
- Disconnect the plug before cleaning.
- Do not dispose of electric tools, accessories and packaging together with household waste material (only for EU countries)

## **TROUBLE SHOOTING**



**WARNING:** Read instruction manual first! Remove plug from the power source before trouble shooting.

<b>Problem</b>	<b>Possible Cause</b>	<b>Possible Solution</b>
Motor is not working	1) Wires in the main plug or in the socket are loose. 2) The switch is faulty.	1) Have the socket and plug checked by an authorized technician. 2) Have the switch replaced by an authorized technician.
Unusual noises occur during operation. Motor is not working properly.	1) Switch contact has failed. 2) Components have jammed. 3) Too high of load has been applied.	1) Have the switch replaced by an authorized technician. 2) Have the tool checked and repaired. 3) Use less pressure during sanding operations.
Motor gets hot.	1) Foreign substances have gotten inside the motor. 2) Too high of load has been applied.	1) Have the foreign substances removed. 2) Use less pressure during sanding operations.



**WARNING:** Follow all safety precautions whenever diagnosing or servicing the tool. Disconnect power supply before service.

# EXPLODED VIEW

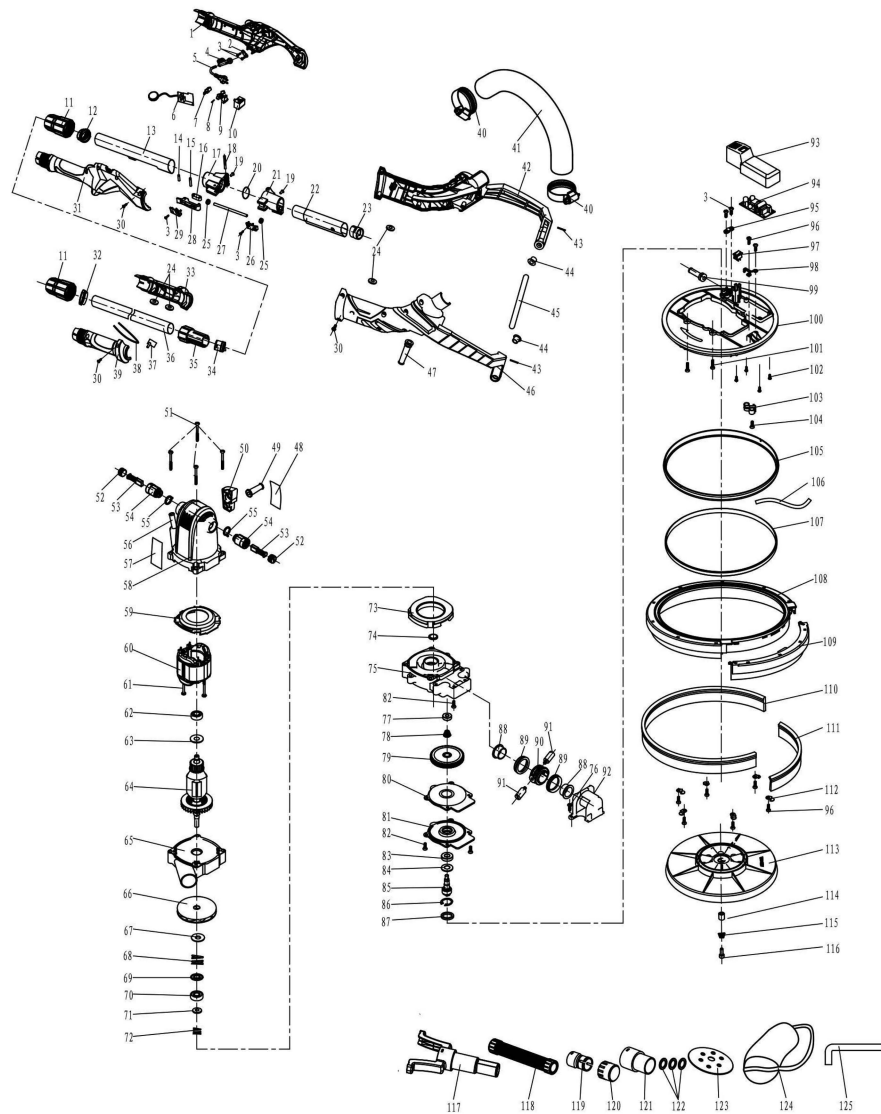

## PARTS LIST

Item	Stock#	Description	Qty.
1	PS4001-001	Left main handle	1
2	PS4001-002	Cable plate	1
3	PS4001-003	Screw ST4×14-F	8
4	PS4001-004	Cable sleeve	1
5	PS4001-005	Cable	1
6	PS4001-006	Soft start	1
7	PS4001-007	Switch button	1
8	PS4001-008	Round pin	1
9	PS4001-009	Switch pushing lever	1
10	PS4001-010	Switch	1
11	PS4001-011	Back screw nut	2
12	PS4001-012	Sealing sleeve	1
13	PS4001-013	Aluminium pipe	1
14	PS4001-014	Round pin	1
15	PS4001-015	Round pin	1
16	PS4001-016	Brace	1
17	PS4001-017	Back rubber sleeve	1
18	PS4001-018	Round pin	1
19	PS4001-019	Pivot	2
20	PS4001-020	O ring	1
21	PS4001-021	Front rubber sleeve	1
22	PS4001-022	Aluminium pipe	1
23	PS4001-023	Left handle stand	1
24	PS4001-024	Seal mat	4
25	PS4001-025	Double sheath	2
26	PS4001-026	Front rubber sleeve plate	1
27	PS4001-027	Headless line	1
28	PS4001-028	Lock wrench	1
29	PS4001-029	Rear rubber sleeve plate	1
30	PS4001-030	Screw ST4×16-F	26

Item	Stock#	Description	Qty.
31	PS4001-031	Right main handle	1
32	PS4001-032	Seal sleeve	1
33	PS4001-033	Left sub-handle	1
34	PS4001-034	Seal sleeve	1
35	PS4001-035	Sleeve	1
36	PS4001-036	Aluminium pipe	1
37	PS4001-037	Handle cover	1
38	PS4001-038	Seal tape	1
39	PS4001-039	Right sub-handle	1
40	PS4001-040	Tightening ring	2
41	PS4001-041	Soft tube	1
42	PS4001-042	left supporter	1
43	PS4001-043	Spring pin	2
44	PS4001-044	Small rubber cover	2
45	PS4001-045	Rubber band	1
46	PS4001-046	Right Supporter	1
47	PS4001-047	Sleeve	1
48	PS4001-048	Brand label	1
49	PS4001-049	Sleeve	1
50	PS4001-050	Housing pressing block	1
51	PS4001-051	Screw M5×45	4
52	PS4001-052	Brush cap	2
53	PS4001-053	Carbon brush	2
54	PS4001-054	Brush holder	2
55	PS4001-055	Tension spring	2
56	PS4001-056	Sleeve	1
57	PS4001-057	Specificate label	1
58	PS4001-058	Housing	1
59	PS4001-059	Anti-wind ring	1
60	PS4001-060	Stator	1

Item	Stock#	Description	Qty.
61	PS4001-061	ScrewST4×48	2
62	PS4001-062	Bearing 627RS	1
63	PS4001-063	Dust-proof cushion	1
64	PS4001-064	Rotor	1
65	PS4001-065	Fan cover	1
66	PS4001-066	Vacuuming leaf	1
67	PS4001-067	Spring pin	1
68	PS4001-068	Spring	1
69	PS4001-069	Dust-proof plate	1
70	PS4001-070	Bearing 608RS	1
71	PS4001-071	Wool mat	1
72	PS4001-072	Spring	1
73	PS4001-073	Windshield	1
74	PS4001-074	O ring	1
75	PS4001-075	Gear box	1
76	PS4001-076	Screw M4×12	2
77	PS4001-077	bearing 606Z2	1
78	PS4001-078	Spring	1
79	PS4001-079	Big gear	1
80	PS4001-080	Paper mat	1
81	PS4001-081	Big bearing cover	1
82	PS4001-082	Screw M4×14	8
83	PS4001-083	bearing 6900RS	1
84	PS4001-084	Output shaft paper pad	1
85	PS4001-085	Output shaft	1
86	PS4001-086	Circlip	1
87	PS4001-087	Oil seal	1
88	PS4001-088	Horn damping	2
89	PS4001-089	Big rubber sleeve	2
90	PS4001-090	Flexible sleeve	1
91	PS4001-091	Screw pin	2
92	PS4001-092	Small bearing cover	1
93	PS4001-093	Switch cover	1

Item	Stock#	Description	Qty.
94	PS4001-094	Circuit board	1
95	PS4001-095	Cable plate	1
96	PS4001-096	Screw ST4×10-F	8
97	PS4001-097	Samll switch	1
98	PS4001-098	Position hook	1
99	PS4001-099	Sleeve	1
100	PS4001-100	Sanding pad cover	1
101	PS4001-101	Screw M5×20	4
102	PS4001-102	Screw ST3×16	4
103	PS4001-103	Cover line	1
104	PS4001-104	Screw ST3×10	2
105	PS4001-105	Circular chimney	1
106	PS4001-106	Headless line	1
107	PS4001-107	Led light strip	1
108	PS4001-108	disc wheel	1
109	PS4001-109	Side round	1
110	PS4001-110	Long brush	1
111	PS4001-111	Short brush	1
112	PS4001-112	Metal plate	6
113	PS4001-113	Sanding pad	1
114	PS4001-114	M6 Stop button	1
115	PS4001-115	Spring	1
116	PS4001-116	Screw M6×14	1
117	PS4001-117	Protect connector	1
118	PS4001-118	Dust tube	1
119	PS4001-119	Tube connector	1
120	PS4001-120	Middle connector	1
121	PS4001-121	Connector	1
122	PS4001-122	Sealing mat	3
123	PS4001-123	Sanding paper	1
124	PS4001-124	Dust bag	1
125	PS4001-125	Wrench S5	1

## **TWO (2) YEARS LIMITED WARRANTY**

PowerSmart® is committed to building tools that are dependable for years. Our warranties are consistent with our commitment and dedication to quality.

### **TWO (2) YEARS LIMITED WARRANTY OF POWERSMART PRODUCTS FOR HOME USE.**

PowerSmart ("Seller") warrants to the original purchaser only, that all PowerSmart consumer power tools will be free from defects in material or workmanship for a period of two (2) years from date of purchase. Ninety (90) days for all PowerSmart Products, if the tool is used for professional or commercial use.

SELLER'S SOLE OBLIGATION AND YOUR EXCLUSIVE REMEDY under this Two (2) Years Limited Warranty and, to the extent permitted by law, any warranty or condition implied by law, shall be the repair or replacement of parts, without charge, which are defective in material or workmanship and which have not been misused, carelessly handled, or misrepaired by persons other than Seller or Authorized Service Center. To make a claim under this Limited Warranty, you must return the entire power tool product; transportation prepaid, to PowerSmart Include a legible copy of the original receipt, which lists the date of purchase (month and year) and the name of the company purchased from.

THIS LIMITED WARRANTY DOES NOT APPLY TO ANY ACCESSORY ITEMS INCLUDED WITH THE TOOL SUCH AS CIRCULAR SAW BLADES OTHER RELATED ITEMS OR TO ANY REPLACEMENT PARTS LISTED UNDER MAINTENANCE.

ANY IMPLIED WARRANTIES SHALL BE LIMITED IN DURATION TO TWO (2) YEARS FROM DATE OF PURCHASE. SOME STATES IN THE U.S. AND SOME CANADIAN PROVINCES DO NOT ALLOW LIMITATIONS ON HOW LONG AN IMPLIED WARRANTY LASTS, SO THE ABOVE LIMITATION MAY NOT APPLY TO YOU.

IN NO EVENT SHALL SELLER BE LIABLE FOR ANY INCIDENTAL OR CONSEQUENTIAL DAMAGES (INCLUDING BUT NOT LIMITED TO LIABILITY FOR LOSS OF PROFITS) ARISING FROM THE SALE OR USE OF THIS PRODUCT. SOME STATES IN THE U.S. AND SOME CANADIAN PROVINCES DO NOT ALLOW THE EXCLUSION OR LIMITATION OF INCIDENTAL OR CONSEQUENTIAL DAMAGES, SO THE ABOVE LIMITATION OR EXCLUSION MAY NOT APPLY TO YOU.

THIS LIMITED WARRANTY GIVES YOU SPECIFIC LEGAL RIGHTS, AND YOU MAY ALSO HAVE OTHER RIGHTS WHICH VARY FROM STATE TO STATE IN THE U.S., PROVINCE TO PROVINCE IN CANADA AND FROM COUNTRY TO COUNTRY.

For questions / comments, technical assistance or repair parts –  
Please call toll free at: 1-800-791-9458 (M-F 9am – 5pm EST)  
Email: [support@amerisuninc.com](mailto:support@amerisuninc.com)

**SAVE YOUR RECEIPTS. THIS WARRANTY IS VOID WITHOUT THEM.**