



Hippolib
V2

Customized saddle module

Horse riding made accessible
for everybody.

NEW
Adjustable backrest

V-TRAK



DISCOVER OUR NEW WEBSITE:

www.mouvly.com

AND JOIN US ON OUR PAGE





www.mouvly.com

168 ZA des Aubrières
49412 SAUMUR Cedex (FRANCE)

System designed to facilitate access to learning horse riding. It is designed such that it can also be used for people with disabilities.

Modules

The Hippolib consists of two main assemblies, a **front part** (ventral support and handle: if necessary, the system can be removed) and a **rear part** (backrest: the height and depth of which can be adjusted).

The assembly is held by a clamping system that passes underneath the saddle to lock the two parts in position.

Child backrest



Adult backrest



The rear part is available in two different shapes:

- V-TRAK adjustable backrest (that provides personalized support)
- Pelvic brace (for pathologies that require only minor support)

Pelvic brace



The Hippolib is supplied with a shock absorber pad and a saddle blanket.



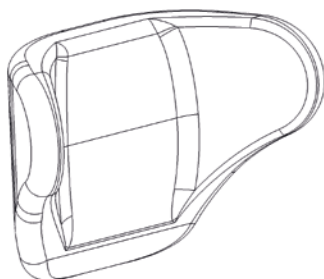

Large V-TRAK backrest (D)

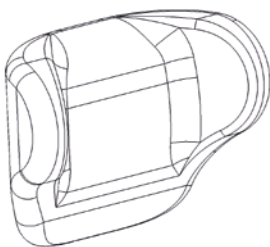

Small V-TRAK backrest (D)

NEW
ADJUSTABLE BACKREST

V-TRAK



The V-TRAK backrest can be adapted to suit different morphologies and will ensure that the rider is optimally positioned and firmly held.

Equipped with ergonomic padding and adjustable back tension for unrivalled comfort.

It is combined with an adjustable multi-position arm so that depth, height and angle will be quickly and efficiently corrected with ease.



Tension adjustment



Width adjustment

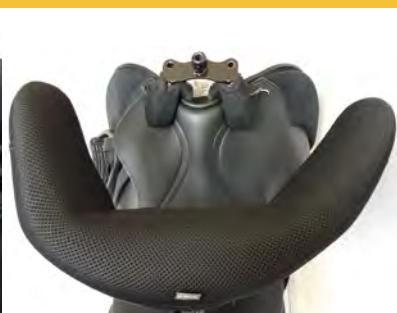

Min/max asymmetrical adjustment amplitude

Options

Hippodrive

Teaching reins:
Used to quickly adjust hand positions on the reins.



Hippogel

Gel cushion:
relieves friction on the saddle to prevent the risk of pressure sores.



Design and development

The Hippolib is an educational saddle module that facilitates access to horse riding for people with disabilities. Through its mechanism and adjustments, this worldwide innovation can be adapted to suit a range of morphologies and handicaps, for both children and adults. Can be adapted to fit an English saddle.

This saddle module is the result of various studies and research and development in partnership with:



CENTRE DE
RESSOURCES
D'EXPERTISE ET
DE PERFORMANCE
SPORTIVE



Your service provider

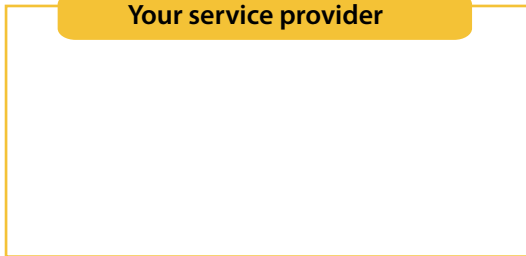

We are grateful to the "Centre Equestre du Petit Souper" riding school in Saint-Hilaire Saint-Florent (49) for providing us with their infrastructures and a horse for our photoshoot.

Flyer_Hippolib_ANG_29-09-2017_Photos: P. Body_Photos are not contractually binding. Printed on FSC-certified paper.



Groupe G2M

