

RELAXONCHAIR

VITA-3D

USER MANUAL

Please read SAFETY INSTRUCTIONS carefully before using the chair.

RELAXONCHAIR®
BEST NEW ZERO GRAVITY SHIATSU FULL MASSAGE CHAIR
relaxonchair.com

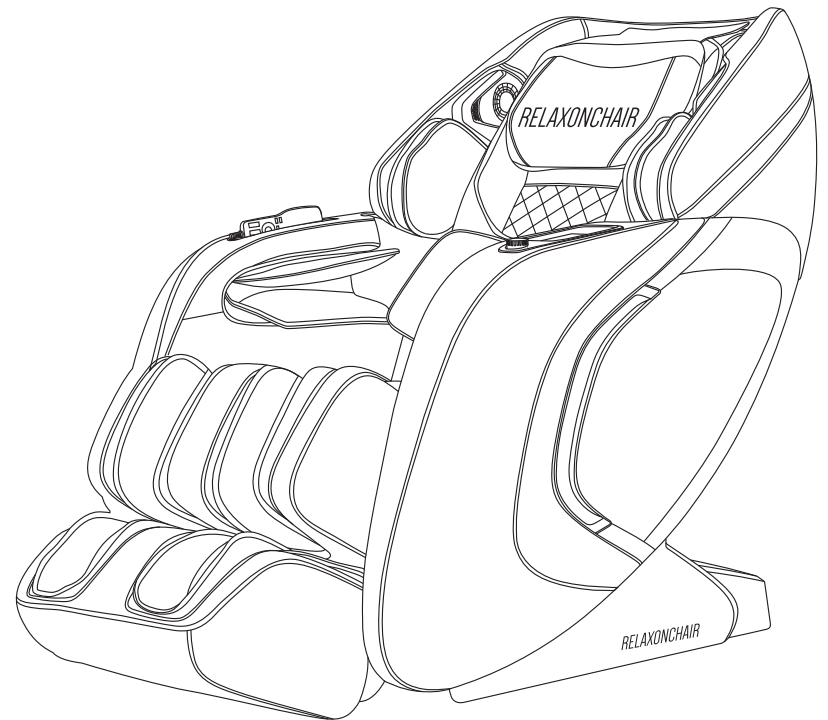

relaxonchair.com

RELAXONCHAIR

VITA-3D Massage Chair

Congratulations and thank you for trusting RELAXONCHAIR. You are about to discover the many joys of owning a premium RELAXONCHAIR™ Vita-3D Massage Chair. Massage, combined with healthy eating, exercise, and a good sleep regiment is a great way to take care of your body & mind, leading to a happy, productive lifestyle.

For many years, RELAXONCHAIR has been the trusted source for quality massage products that improve your life. The RELAXONCHAIR™ Vita-3D Massage Chair represents our heritage of delivering amazing, quality products since the beginning. It is covered by our exclusive 3 year limited warranty. Take comfort in knowing our quality engineering team goes the extra mile every day to make sure our customers rarely need it.

We believe you are going to love this chair. If so, we would appreciate telling others how it has changed your life. If we have somehow let you down, please tell us directly. Continuous feedback from our customers, either loving the products or helping us to improve them. Is critical to RELAXONCHAIR's success.

To communicate directly with us, please contact the RELAXONCHAIR Customer Care Center at (866) 647-3496. Representatives are available to assist you Monday through Friday from 9:00 A.M. to 5:00 P.M. PST, You could also email us anytime at help@relaxonchair.com

Sincerely yours,

RELAXONCHAIR Product Development Team

Before you start using your RELAXONCHAIR™ Vita-3D Massage Chair, please read this operation manual thoroughly to learn about how to correctly use the product with emphasis on safety. This manual should be kept on hand for future reference.

Note: We reserve the right for the design to be changed. It is subject to change without notice. The pictures used in this manual are just for reference, and we ask you to please look at the actual product.

Table of Contents

PREPARATION

| | |
|---------------------------|---|
| Safety Instructions | 1 |
| Product Components | 7 |

INSTALLATION

| | |
|--------------------|---|
| Installation | 8 |
|--------------------|---|

MESSAGE OPERATION

| | |
|----------------------------------|----|
| Adjustments Before Massage | 11 |
| Manual Control | 12 |
| Armrest Shortcuts | 32 |
| Voice Control | 34 |
| Other Operations | 35 |

OTHERS

| | |
|-------------------------|----|
| Malfunction Guide | 36 |
| Specification | 38 |

When using the RELAXONCHAIR™ Vita-3D Massage Chair, basic precautions should always be followed, including the following: Read all instructions before using the RELAXONCHAIR™ Vita-3D.

DANGER - To reduce the risk of electric shock:

- Always unplug this Massage Chair from the electrical outlet immediately after using and before cleaning.
- Never use pins of other metallic fasteners with this appliance.
- Carefully examine the covering before each use. Do not turn on or use it if the covering shows any signs of deterioration.
- Keep dry - Do not operate in wet or moist conditions.

⚠ WARNING - To reduce the risk of burns, fire, electric shock or injury to persons:

1. RELAXONCHAIR™ Vita-3D Massage Chair should never be left unattended when plugged in. Unplug from the outlet when it is not in use.
2. Please keep a close eye when this massage chair is used by or near children or the unable. Please keep things free surrounding the massage chair, specifically the backrest and footrest.
3. Please use this massage chair only for its intended use as described in this manual. Do not use attachments not recommended by the manufacturer.
4. Never operate this massage chair if it has a damaged cable or plug. If it is not working properly, please contact RELAXONCHAIR Customer Service at (866) 647-3496.
5. Do not use the cable as a handle or means of moving the massage chair.
6. Keep the cord away from heated surfaces.
7. Never operate the massage chair with any of its air openings blocked. Keep the air openings free of debris.
8. Do not use outdoors. The massage chair is intended for indoor use only.
9. Do not operate where aerosol products are being used.

2 SAFETY INSTRUCTIONS

10. To disconnect the chair, turn all control to the off position, to remove the plug from the outlet.
11. Do not stand on or in the Vita-3D Massage Chair. Use only while being seated properly.
12. This product is not intended for use by children, or persons with reduced physical, sensor, or mental capabilities, or lack of experience and knowledge unless they have been given supervision or instruction concerning the use of the product by a person responsible for their safety.
13. Please use the heat function carefully. Do not overuse if you have sensitive skin or if you have poor blood circulation. The repeated use of heat by children or disabled persons may be dangerous. Please frequently check and make sure that the skin in contact with heated areas is fine in order to reduce the risk of burns and blistering.
14. Do not crush the massage chair.
15. Keep children and pets away from the motorized portions of the massage chair.
16. NEVER REMOVE THE COVER.
17. Connect this appliance to a properly grounded outlet. Please see grounding instructions.

*** This RELAXONCHAIR™ Vita-3D Massage Chair is intended for household use only.**

1. USAGE ENVIRONMENT

- Do not use the massage chair in an excessively humid or dusty environment as this may result in malfunction or electric shock.
- Do not use the massage chair in a room with a temperature of 104°F or higher.
- Do not expose the massage chair to direct sunlight or heat.
- Place and use the massage chair on an even, non-slip floor.
- The massage chair is designed for home use, and not for commercial purposes.

SAFETY INSTRUCTIONS 3

⚠ CAUTION

If you use the massage chair in a cold room, do not increase the room temperature abruptly. It is recommended that you increase the temperature gradually to a normal level.

If the massage chair is stored in a cold place and is being brought into a warm environment, it is recommended to wait one hour before use. This is because its performance may not be at an optimum level.

Using the Massage chair under different conditions may result in malfunction.

2. SAFETY PRECAUTIONS

1. To ensure safe and correct use of the massage chair, do not operate it without reading this manual.
2. Do not use the massage chair when the upholstery or seat is removed. This may cause injury or malfunction.
3. Do not use the massage chair with other therapeutic equipment or electric blanket etc. as this may result in ineffectiveness or injury.
4. Do not use the massage chair within an hour before or after eating as this may have adverse effects on the user.
5. Do not allow children or pets to play around the massage chair, such as behind or in front of the massage chair. This may result in injury.
6. Do not rest or place heavy objects on the armrests, footrest or backrest as this may result in malfunction or injury.
7. Do not use the massage chair when your body is wet.
8. Do not operate with wet hands.
9. It is not recommended to use the massage for more than 30 minutes at a time.
10. Over-massaging an area on our body may result in excessive stress on your muscles, and may have adverse effects.
11. Do not insert your hand or foot along the paths of the massage rollers during use as this may lead to injury.
12. Stop operation immediately if you experience any discomfort.

4 SAFETY INSTRUCTIONS

13. This product is not intended for self-treatment of conditions that should be managed by a qualified healthcare provider.
14. Individuals on medication, or with medical conditions, should consult their doctor before use.
15. Remove all accessories such as scarfs, necklaces, or watches before using the massage chair.
16. Please do not use the product if you are feeling unwell.

3. PEOPLE WITH MEDICAL CONDITIONS

Consult your doctor before use if you:

- Are under medical rest as ordered by a doctor.
- Have spinal disorders, an abnormal spinal cords or have suffered a spinal injury.
- Have back problems.
- Have diabetes, osteoporosis or sensory impairment.
- Have joint dysfunction.
- Have a pacemaker or other electronic medical devices.
- May be pregnant.
- Have phlebitis or thrombosis.
- Have an increased risk for blood clots.
- Had recent surgery.
- Have surgical pins, screws, or anything mechanical implanted in your body.

⚠ CAUTION

- The massage chair is not intended for use by children of persons with reduced physical, sensory, or mental capabilities, or lack of knowledge and experience, unless they have been given supervision or instruction concerning the use of the massage chair by a person responsible for their safety.
- Children should be supervised to ensure that they do not play with the massage chair.
- Avoid using the massage chair under the influence of alcohol.

SAFETY INSTRUCTIONS 5

- Do not apply massage rollers directly on the head, elbow, knee, torso or abdomen.
- If your legs or feet slip off the leg rest during a massage, do not force them back in as this may result in injury.
- Remove the power plug from the electrical outlet immediately should liquid be accidentally spilled onto the massage chair. Do not use wet hands to connect or disconnect the power plug from the electrical outlet.
- Do not tamper with the power cord or use the massage chair with a damaged cord as this may result in malfunction and/or electric shock.

4. INSTANCES WHEN THE MASSAGE CHAIR SHOULD NOT BE USED

In the following events. Please switch off the main power switch immediately, and disconnect the power cord from the electrical outlet.

- If water is accidentally spilled onto the massage chair. This may result in electric shock or malfunction.
- If the fabric of the backrest is torn and the internal components are exposed.
- If pain or discomfort is felt during massage, stop operation immediately, and consult with your doctor.
- If you detect any malfunction or any other abnormal condition during operation.
- If there is a power outage, injury may occur when power is restored unexpectedly.
- If there is lightning.

5. ASSEMBLY AND REPAIR OF THE MASSAGE CHAIR

Do not attempt to disassemble the RELAXONCHAIR™ Vita-3D Massage Chair yourself unless instructed to do so by RELAXONCHAIR's technical support team. Touching the internal components may result in malfunction or electric shock.

The Massage Chair must be serviced or repaired by an authorized service center.

6 SAFETY INSTRUCTIONS

6. THINGS TO NOTE ABOUT THE POWER PLUG AND CORD

- Check that the Alternating Current (AC) voltage corresponds with the specification indicated for the massage chair.
- Do not connect or disconnect the power plug from the electrical outlet with wet hands. This may result in malfunction or electric shock.
- When disconnecting the power plug, pull it by holding the plug, not the cord.
- Although operation will be stopped automatically by the Auto Function, always remember to switch off the main power switch after use.
- Do not place the power cord under the chair or any heavy objects.
- Do not wind the power cord around the chair as this may damage the cord and result in a fire or electric shock.
- Do not operate the massage chair with a damaged cord or extension cord.
- Do not use the massage chair if the electrical outlet is loose.
- If the power cord is damaged, it should be replaced by a qualified technician.

7. GROUNDING INSTRUCTION

- This product must be grounded. If it should malfunction or break down, grounding provides a path of least resistance for the electric current to reduce the risk of electric shock. This product is equipped with a cord or an equipment-grounding conductor and a grounding plug. The plug must be plugged into an appropriate outlet that is properly installed and grounded in accordance with all local codes and ordinances.
- Danger - Improper connection of the equipment-grounding conductor can result in a risk of electric shock. Check with a qualified technician if you are in doubt as to whether the product is properly grounded. Do not modify the plug provided with the product. This is for use on a 120V circuit, and has a grounding plug that looks like the plug illustrated below. Make sure the product is connected to an outlet with the same configuration as the plug. No adapter should be used with the product.

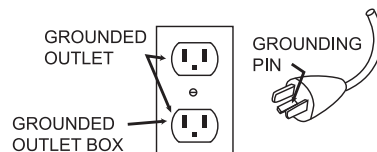

6

PRODUCT COMPONENTS

7

OVERVIEW

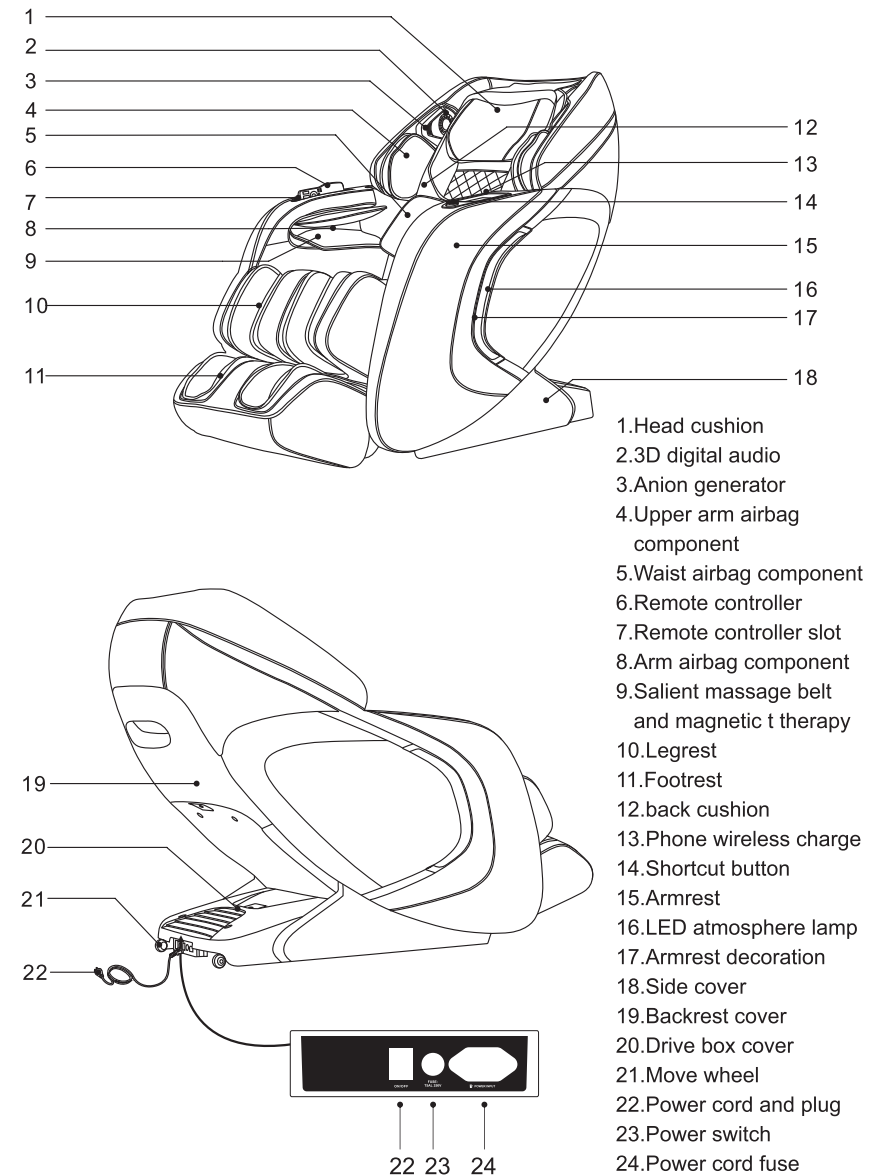

7

8 INSTALLATION

STEP 1: UNBOXING THE CHAIR

1. Lift and remove main outer carton.
2. Remove cardboard and foam on both sides of the massage chair.
3. Remove accessory box (includes: instructions, power cord etc.).
4. Please check to make sure that everything is included in the box.

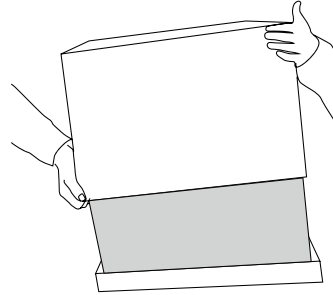

STEP 2: INSTALLING THE SIDE PANEL

1. Remove the side panels from the carton, and take them out to begin assembly.
2. Locate the connector plug and air pipe (two wires, two air pipes) corresponding to the armrests from the rail bracket. Pass them from the rear end of the rail bracket.

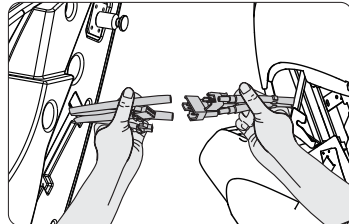
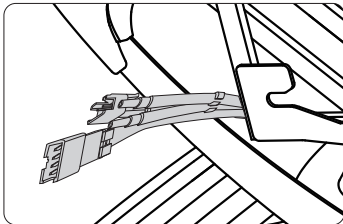

3. Pass the connector from the bottom of the steel rail bracket, and correspond to the armrest connector and insert it to the position firmly. Similarly, insert the air pipe connector to the position firmly.

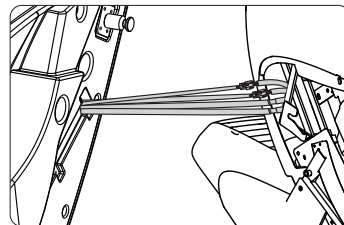

9 INSTALLATION

4. After connecting with the corresponding connection wires, gently insert them into the bottom of the steel rail bracket from the rear side of the middle of the steel pipe of the steel rail bracket by hand, and take care to avoid the air pipe bending

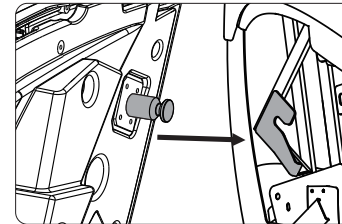
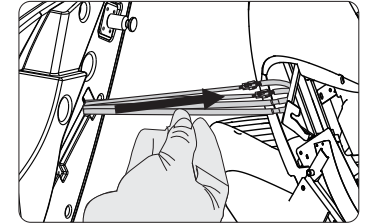

5. Holding the front and rear ends of the armrest with both hands, insert the positioning shaft at the rear end of the armrest into the positioning shaft card at the lower end of the rail frame first and then gently push the armrest up, and check whether or not the armrest positioning shaft is inserted firmly

6. Pick up the armrest with both hands and then insert the front hook of the armrest into the front square opening of the massage chair frame

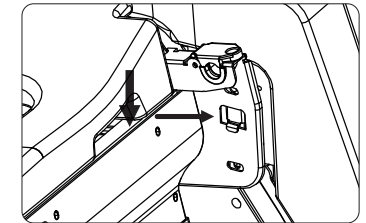

Note: Hooking the two together may be difficult, as the hook secures the armrest tightly to the body to keep it flush. You may need another person in order to install the armrest.

7. Screw in and secure the front of the armrest to the chair.

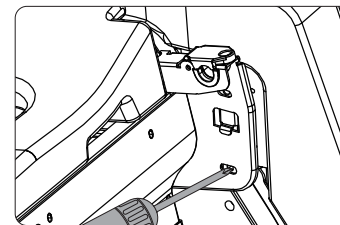

8. Unzip the shoulder cover, and screw the shoulder and armrest together.

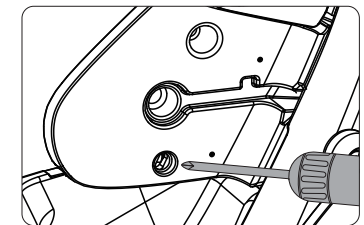

9. Repeat the above steps for the other armrest.

10 INSTALLATION

STEP 3: INSTALLING THE FOOTREST

1. Locate the plug and air hose connections.
2. Connect the plug and air hose of the footrest to the main body.
3. Lift the latches on the main body.
4. Insert the footrest onto the latches, then screw in to secure the footrest.

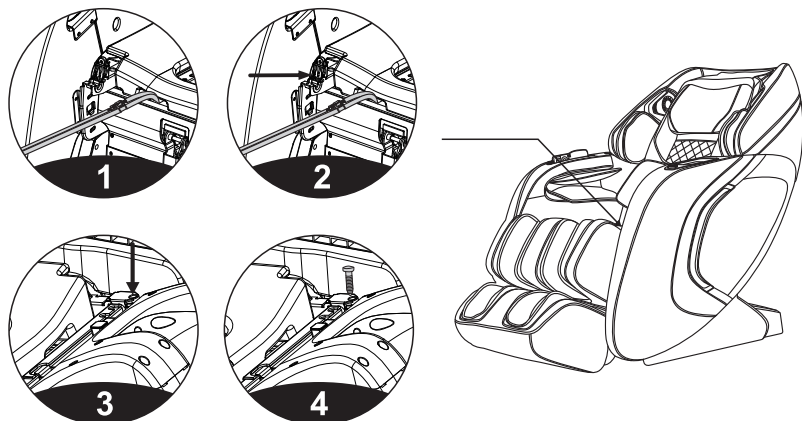

ADJUSTMENTS BEFORE MASSAGE 11

1. FLOOR PROTECTION

- The prolonged heavy pressure on the massage chair may cause scratches on the floor. Thus, put a carpet or cushion on the floor where the massage chair is placed to avoid this damage.

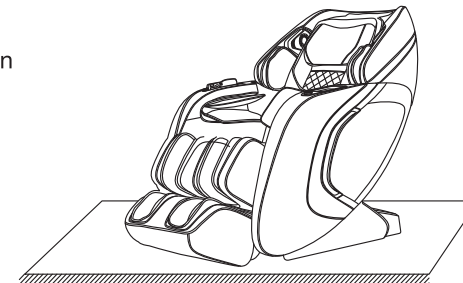

2. MOVING THE MASSAGE CHAIR

- Remove all cords and wires from obstruction in order to avoid damage and injuries.
- Tilt the massage chair backwards, and put pressure downward to recline the chair to easily move the massage chair around.
Note: You may want to have the assistance of another person, and also wear shoes to protect your feet.
- Move the chair to an area that is open and level, as a clean surrounding environment and surface will help keep the chair running smoothly.

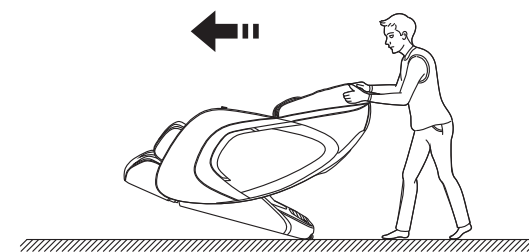

3. TURN ON THE POWER

1 Plugging-in diagram

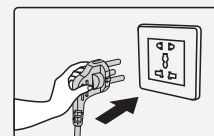

2 Product connection diagram

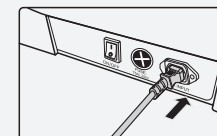

3 Power switch diagram of the product

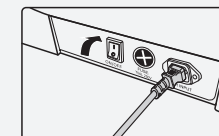

12 MANUAL CONTROL

REMOTE CONTROLLER

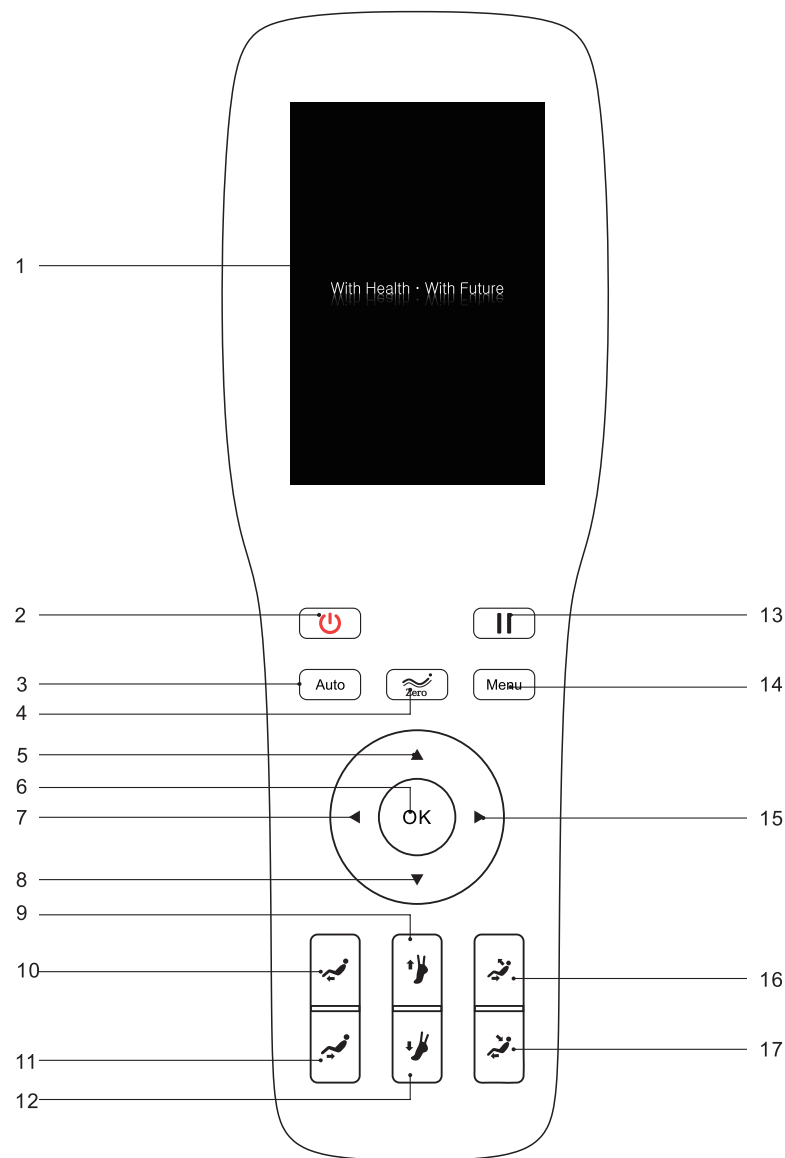

MANUAL CONTROL 13

REMOTE CONTROLLER

- 1. Display:** Color LCD showing the massage functions in the running state.
- 2. Switch:** Turn ON/OFF the massage.
- 3. AUTO Key:** Enter the automatic function mode selection interface.
- 4. Zero-Gravity Key:** Adjust the angle of the massage chair for zero gravity. There are 3 different levels of Zero-Gravity, based on the total number of presses.
- 5. Up Key:** Select an object upward in the menu, or adjust the massage position upward.
- 6. OK:** Confirm the selected massage function for massage.
- 7. Left Key:** Return to the previous menu, or select an object leftward.
- 8. Down Key:** Select an object downward in the menu, or adjust the massage position downward.
- 9. Footrest Shortening Key:** Shorten and adjust the footrest according to the user's height.
- 10. Footrest Up Key:** Adjust the footrest upward according to your massage needs.
- 11. Footrest Down Key:** Adjust the footrest downward according to your massage needs.
- 12. Footrest Elongation Key:** Elongate and adjust the footrest according to the user's height.
- 13. Pause Key:** Pause all the massage functions currently in operation. Press this button again to continue operation.
- 14. Menu Key:** Enter the main menu selection interface.
- 15. Right Key:** Enter the submenu, or select an object rightwards.
- 16. Sitting Key:** Simultaneously adjust the backrest and footrest to the sitting position.
- 17. Lying Key:** Simultaneously adjust the backrest and footrest to the lying down position.

14 MANUAL CONTROL

MESSAGE FUNCTION CONTROL OPERATION

1. Standby

- After the massage chair is powered on and turned off, the remote controller is blank in the standby state (i.e. the LED lamp is off) and cannot perform any operation (except the key switch). You can use the armrest shortcut keys to adjust the angle of the backrest and leg rest. You can also use the voice control button for wakeup.



2. Start Massage (Power Switch)

- Press the switch to start massage. Enter the start-up screen. The backrest will maintain the default position, and the leg rest will be slightly raised. Just wait for any one of automatic function programs in the automatic function selection interface to start massage. If no "AUTO" function is selected within 5 minutes, the massage chair will automatically shut down.

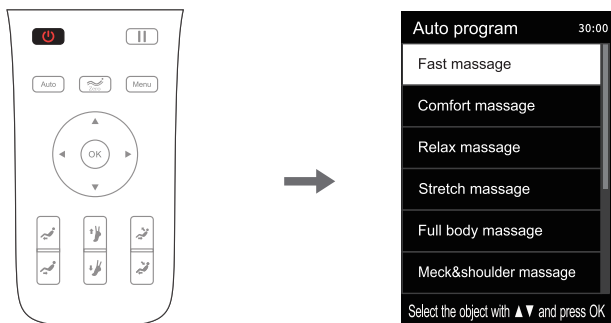

MANUAL CONTROL 15

1) Lying Angle Adjustment

- After selecting any automatic function, the positions of the backrest and the legrest will be adjusted to the preset angles.
- After the angle is adjusted, the massage chair will automatically perform the shoulder position and body shape detection. Wait for completion of such detection (alternatively, press "OK" to skip the step).

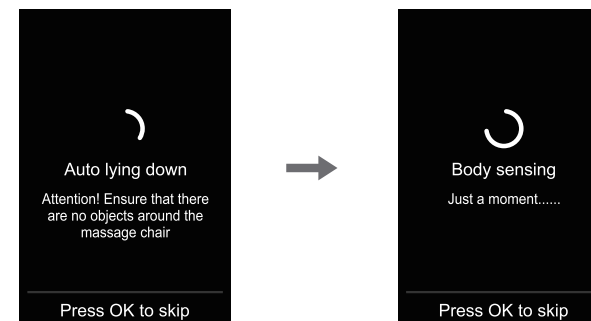

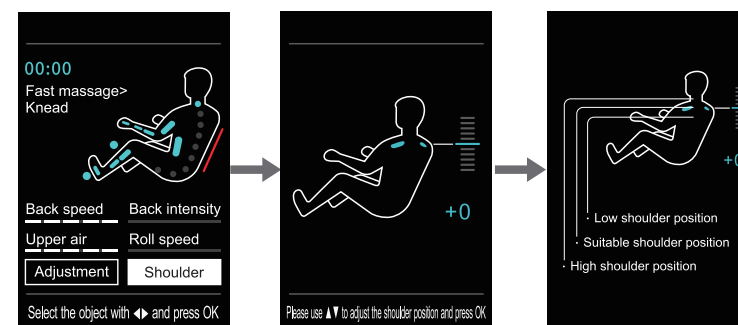

2) Shoulder Position Adjustment

- After detecting the shoulder position, the buzzer will beep. If there is any difference from the actual shoulder position, adjust it to the appropriate position by pressing the "UP" or "DOWN" key. The shoulder position has 11 adjustable levels. If there is no shoulder position adjustment within 10 seconds, the massage function will start automatically. Press "OK" directly to start massage immediately. If no shoulder position can be detected, massage will be started according to the shoulder height by default. Note: During massage, under the information interface, you can press "Right Button" to select the "Shoulder Adjustment" menu, and press "OK" to enter the shoulder adjustment interface. You can also use "Up Key" or "Down Key" to adjust the shoulder position.



16 MANUAL CONTROL

| Button | Description |
|---|---|
|  | Move the massage balls upward to a suitable shoulder position |
|  | Move the massage balls downward to a suitable shoulder position |

- If you need to adjust the shoulder position after the massage program is started, you can directly select "Shoulder Position Adjustment" to enter the shoulder position adjustment interface; you can press "Up Key" or "Down Key" to adjust the shoulder position height; you can press "Left Button" to return to the previous menu, or wait for 10 seconds to automatically return to the information interface

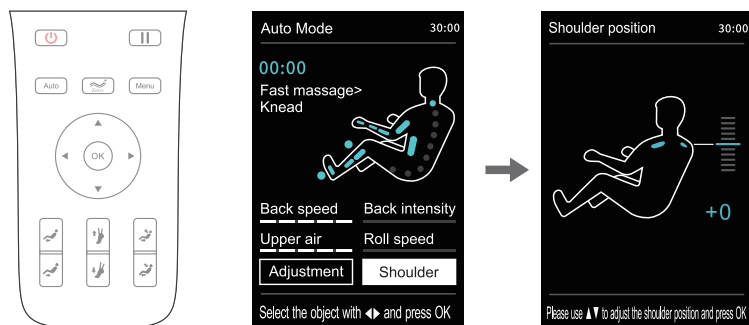

3) Massage Position Adjustment

- After entering the massage program, if you need to adjust the massage position, you can press the "Menu" button on the remote controller to select "Manual Function" to enter; you can select any one of the manual functions, and then press "Left Button" to return to the information interface (i.e. The information interface will switch to the manual function interface)
- In the manual function interface, if the massage range shows a fixed point or local area, you can directly press "Up Key" or "Down Key" to adjust the manipulator upward and downward
- In the manual function interface, if the massage range displays neither fixed point nor local area, you need to select "Massage Adjustment" to enter, and then select "Massage Range", and a fixed point or local area, and press "Left Button" to return to the information interface. Next, you need to press "Up Key" or "Down Key" to adjust the manipulator upward and downward

MANUAL CONTROL 17

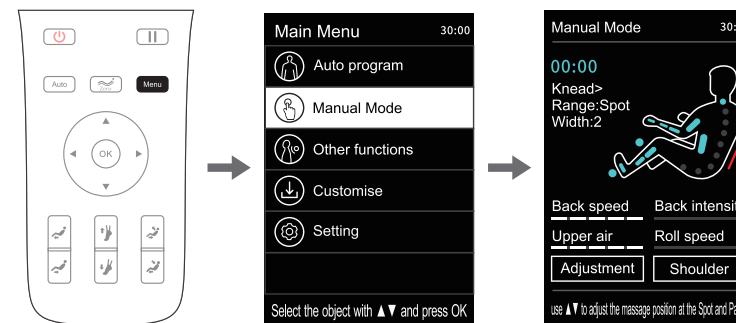

Note: you can't adjust the massage position when it is in auto program.

3. Pause Button

- While the massage function is in service, press "Pause" button to temporarily stop all the massage functions; press "Pause" button again to continue the massage function before pause. If the pause time exceeds 20 minutes, all the massage

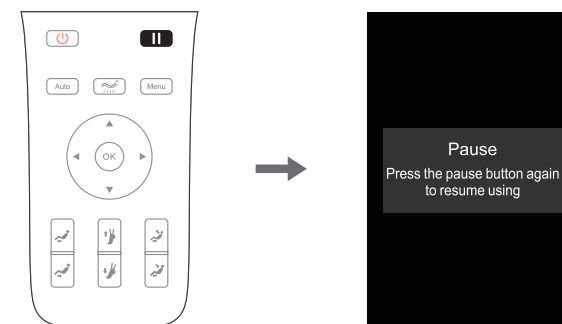

4. Menu Button

- Press "Menu Button" to enter the massage function selection interface of the main menu, including automatic, manual, and other functions, intelligent storage, angle adjustment, settings and other function interfaces.
- Enter the menu interface. Press "Up Key" or "Down Key" to select the function. Confirm via "OK" to enter the next level of selection; press "Left Button" to return to the previous menu interface.

18 MANUAL CONTROL

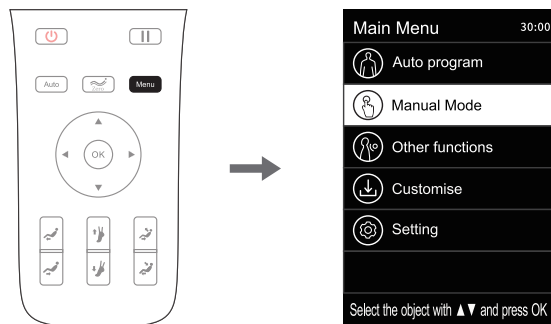

1) Automatic Function (Main Menu - Automatic Function)

- Press "Menu Button" to enter the main menu interface. Press "Up Key" or "DownKey" to select the automatic functions. Press "OK" (or press "AUTO Key" directly in the information interface) to enter the selection of automatic functions.
- 21 special automatic massage functions are available: fast massage, comfortable massage, relaxing massage, stretching massage, full body massage, neck & shoulder massage, back & waist massage, and full airbag massage, Stress relieving, Energy, Good-night sleep, Joint care, Spine massage, Office regimen, Sport recovery, Neck & shoulder care, Brain refresh, Spine care, Waist care, Legs care and Rejuvenation.
- Enter the automatic function interface. Press "Up Key" or "Down Key" to select any automatic function massage program. It will automatically return to the information interface, which will be displayed as the automatic function information interface

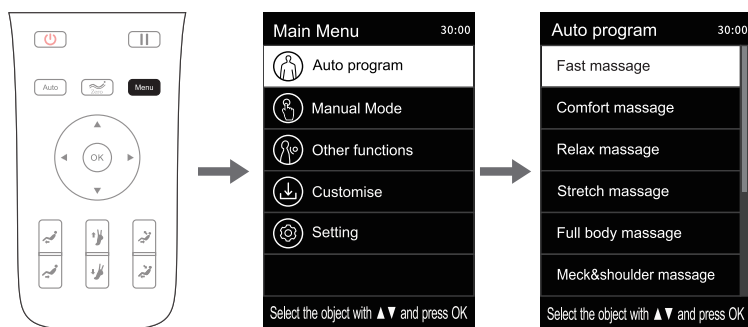

MANUAL CONTROL 19

| Function | Description |
|------------------------|---|
| Fast massage | Experience all the massage effects quickly. |
| Comfortable massage | The most comfortable massage experience. |
| Relaxing massage | Gentle and comfortable deep massage to relieve your body fatigue and relax the body. |
| Stretching massage | Stretch your legs and waist through the leg rest and the backrest to effectively remove fatigue,relieve joint pain and restore vitality. |
| Full body massage | Deep massage to rejuvenate your body. |
| Neck& shoulder massage | With the unique massage technique for the neck and shoulder, the effective massage for the cervical spine and scapula can be performed to relieve the neck and shoulder pain and reduce fatigue on the neck and shoulder. |
| Back&waist massage | Focus on the back and waist massage to relieve the pain on the back and waist. |
| Full airbag massage | Focus on the full-body airbag massage to achieve full relaxation and deep massage of the body and fully relieve the fatigue and pain from your body. |
| Stress Relieving | Restore the full body from fatigue and pain; achieve relaxation, improve micro-circulation, and quickly relieve fatigue for the back and limbs. |
| Energy | After a night of rest, the body can have a rest; the whole body muscles are massaged to quickly wake up the body functions and start a new day of vitality. |
| Good-night Sleep | Through the massage for the twelve major acupoints for healthcare, it helps the body to adjust balance, quickly improve your sleep and your sleep quality. |
| Joint Care | Care for the health of all your limbs and joints by pushing, pulling, stretching, and other massage modes. |
| Neck & shoulder care | With the unique massage technique for the neck and shoulder, the effective massage for the cervical spine and scapula can be performed to relieve the neck and shoulder pain and improve the blood supply to the brain. |

20 MANUAL CONTROL

| | |
|----------------|--|
| Spine Massage | Improve humpback and chest down; massage for each vertebra; care for the spine health; and improve the protrusion of intervertebral disc. |
| Office Regimen | For sitting in the office for a long period of time, this function can increase physical exercise by massage and improve the body functions. |
| Sport Recovery | Make you quickly recover from physical fatigue after exercise. |
| Brain Refresh | Relieve the neck and shoulder pain; promote the blood supply to the brain by massaging the YUZHEN and DAZHU points. |
| Spine Care | Care for the health of spine and perform improvements for the lack of exercise. |
| Waist Care | Focus on improving the health of the lumbar spine and alleviating the stiffness of the waist muscles. |
| Legs Care | Quickly relieve the pain of the lower extremities and the muscle fatigue. |
| Rejuvenation | Improve the quality of nap and work efficiency. |

Note: The automatic functions in service already selected will be displayed in the massage function status bar.

2) Manual Function (Main Menu - Manual Function)

- Press "Menu Button" to enter the main menu interface. Press "Up Key" or "Down Key" to select the manual function, and press "OK" to enter the manual function interface.
- 11 manual massage techniques/functions: OFF, kneading, Tapping I, Tapping II, simultaneous kneading and tapping, Shiatsu I, Shiatsu II, shoulder lifting, 3D I, 3D II, 3D III, 3D IV, etc.
- After entering the manual function interface, press "Up Key" or "Down Key" to select the required manual massage technique. Press "OK" to confirm (There are seven modes of kneading, press the "confirm key" to switch cyclically). After selecting the technique, you will not automatically return to the information interface. Press "Left Button" to return to the previous interface. After returning to the information interface, you will find that you have entered the information interface of the manual function.

MANUAL CONTROL 21

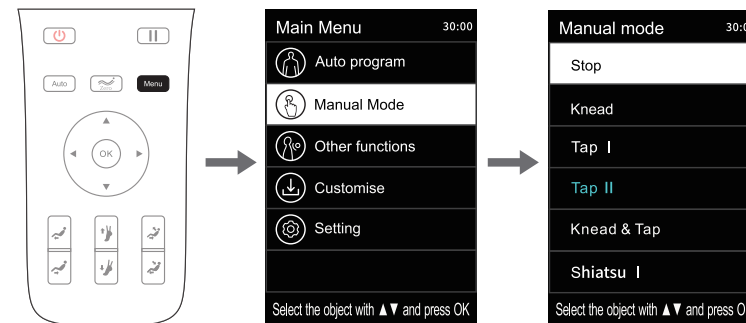

| Function | Description | |
|---|---------------------|---|
| Kneading (Seven modes of kneading can be switched cyclically) | Speed, Width | <ul style="list-style-type: none"> • 5 speed levels adjustable • 5 width levels adjustable • 5 speed levels adjustable |
| Tapping (Tapping I, Tapping II) | Speed, Width, Speed | |
| Simultaneous kneading and tapping | Speed, Width | |
| Shiatsu (Shiatsu I, Shiatsu II) | Speed, Width, Speed | |
| Shoulder lifting | Speed, Width | |
| 3D (3D I, 3D II, 3D III, 3D IV) | Speed, Width, Speed | |

Note: In 3D massage technique mode, the width of 3DI and 3DII cannot be adjusted; the width of 3DIII and 3DIV can be adjusted.

3) Other Functions (Main Menu - Other Functions)

- Press "Menu Button" to enter the main menu interface. Press "Up Key" or "Down Key" to select other function icons. Press "OK" to enter another function interfaces.
- Other functions include: airbag massage for the upper body, airbag massage for the lower body, back heating, leg kneading, negative ions and other massage functions.
- After entering another function interface, press "Up Key" or "Down Key" to select the massage function. After selecting any one of the functions, use "Right Button" to enable or disable the function. Then press "OK" to confirm. Press "Left Button" to return to the previous menu interface.

22 MANUAL CONTROL

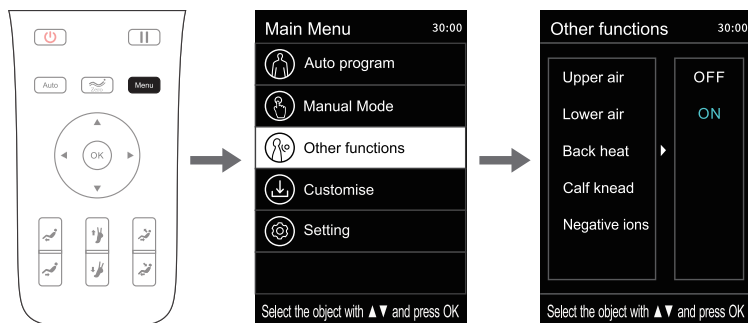

3a) Other Functions - Airbag Massage for the Upper Body

- Airbag massage for the upper body: including airbag massage for the upper arms pressure, airbag massage for the arms, airbag massage for the waist, and other airbag massage functions.
- Enter another function interface. Press “Up Key” or “Down Key” to select the airbag massage function for the upper body. Use “Right Button” to enable or disable the airbag massage function for the upper body. Then press “OK” to confirm. Press “Left Button” to return to the previous menu interface.

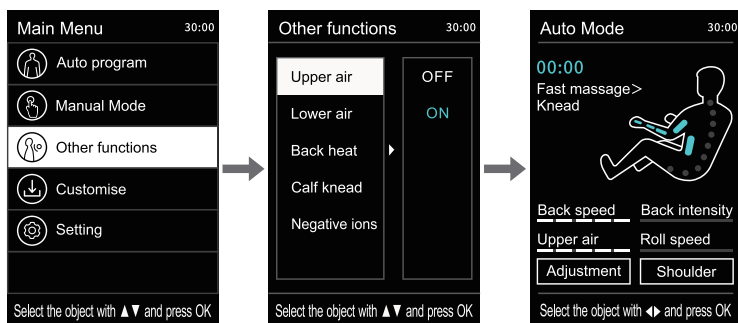

MANUAL CONTROL 23

3b) Other Functions - Airbag Massage for the Lower Body

- Airbag massage for the lower body: including airbag massage functions for the legs, feet, etc.
- Enter another function interface. Press “Up Key” or “Down Key” to select the airbag massage function for the lower body. Use “Right Button” to enable or disable the airbag massage function for the lower body. Then press “OK” to confirm. Press “Left Button” to return to the previous menu interface.

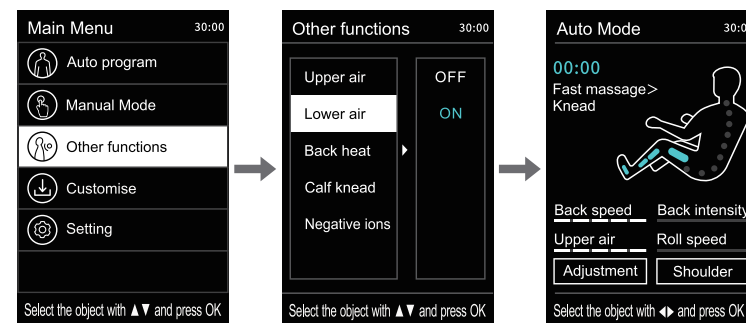

3c) Other Functions - Back Heating

- Back heating: enable or disable the back heating function; the back will become warmer after such heating for 3min.
- Enter another function interface. Press “Up Key” or “Down Key” to select the back heating function. Use “Right Button” to enable or disable such function. Then press “OK” to confirm. Press “Left Button” to return to the previous menu interface.

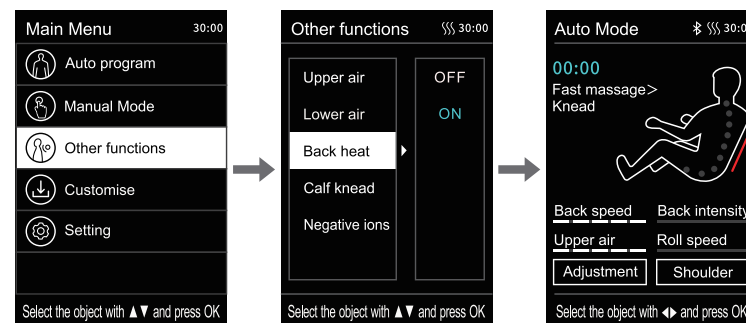

24 MANUAL CONTROL

3d) Other Functions - Leg Kneading

- Leg kneading: enable or disable the leg kneading function.
- Enter another function interface. Press "Up Key" or "Down Key" to select the leg kneading function. Use "Right Button" to enable or disable such function. Then press "OK" to confirm. Press "Left Button" to return to the previous menu interface.

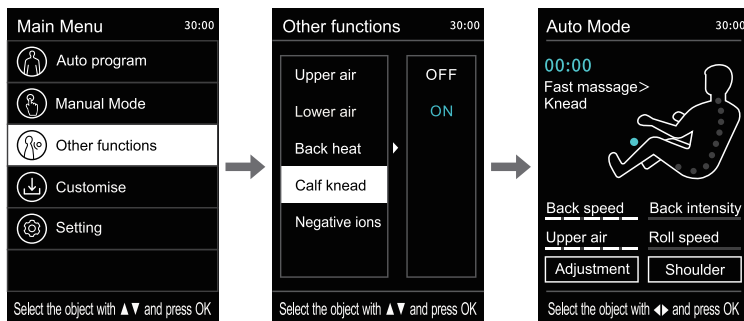

3e) Other Functions - Negative Ions

- Negative ions: enable or disable the negative ions function.
- Enter another function interface. Press "Up Key" or "Down Key" to select the negative ions function. Use "Right Button" to enable or disable such function. Then press "OK" to confirm. Press "Left Button" to return to the previous menu interface.

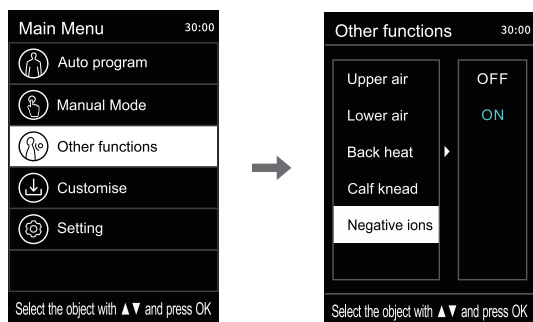

MANUAL CONTROL 25

4) Intelligent Storage (Main Menu - Intelligent Storage)

- Press the "Menu Button" to enter the menu interface. Press "Up Key" or "Down Key" to select the intelligent storage icon. Press "OK" to enter the intelligent storage interface, including: intelligent storage call, intelligent storage saving, cancellation and other storage functions.
- Intelligent storage call includes: M1, M2, M3, M4, and M5.
- Intelligent storage saving include: M1, M2, M3, M4, and M5.
- Call: Call the stored massage mode, massage technique, airbag mode and intensity under the current running status, the positions and angles of the leg rest and the backrest, and other massage functions.
- Storage: Store the massage mode, massage technique, airbag mode and intensity under the current running status, the positions and angles of the leg rest and the backrest, and other massage functions.
- Cancellation is the exit option.

Note: When saving the massage method, you can comment on the saved massage function and method (e.g. father, mother, son, daughter, or none).

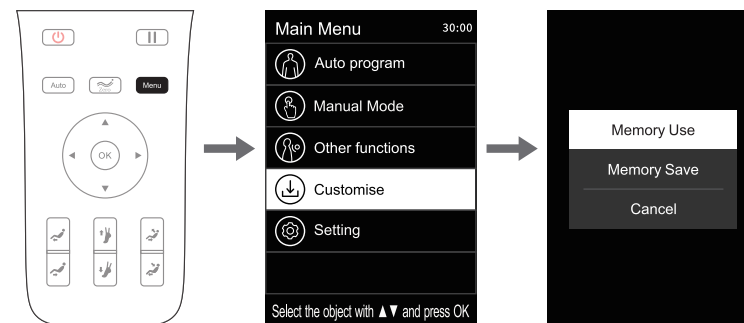

4a) Intelligent Storage - Save or Cancel

- After entering the intelligent storage (saving) interface, press "Up Key" or "Down Key" to select the massage function to be stored. Press "OK" to save or cancel.
- Enter the intelligent storage (saving) interface. Press "Up Key" or "Down Key" to select any one of the M1-M5 saving procedures. Select "OK" to confirm, and comment on the saved massage function; press "Left Button" to return to the previous menu interface.

26 MANUAL CONTROL

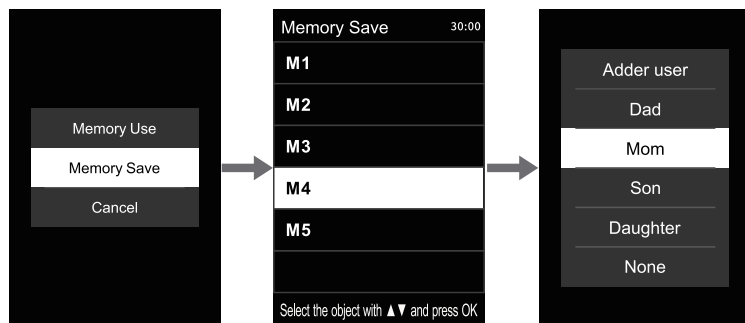

Note: You can comment on the saved message functions and techniques (e.g. father, mother, daughter, son, or none).

4b) Intelligent Storage - Call or Cancel

- After entering the intelligent storage (call) interface, press "Up Key" or "Down Key" to select the message function to be called. Press "OK" to enter the call or cancellation interface.
- Enter the intelligent storage (call) interface. Press "Up Key" or "Down Key" to select any one of the M1-M5 call procedures required to call the saved message program; press "Left Button" to return to the previous menu interface.

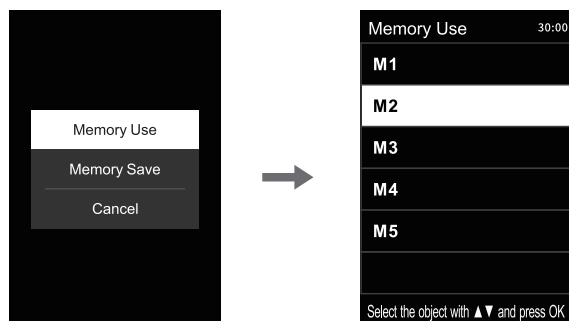

MANUAL CONTROL 27

5) Settings (Main Menu-Settings)

- Press "Menu Button" to enter the main menu interface. Press "Up Key" or "Down Key" to select the settings icon. Press "OK" to enter the settings interface.
- Settings include: language settings, Bluetooth settings, intelligent voice control, Equipment ID and other settings functions.
- After entering the settings interface, press the "Up Key" or "Down Key" to select the desired settings function. Select any one of the settings functions, and then press "Right Button" to set the selected settings function. Press the "OK" to confirm; press "Left Button" to return to the previous menu interface.

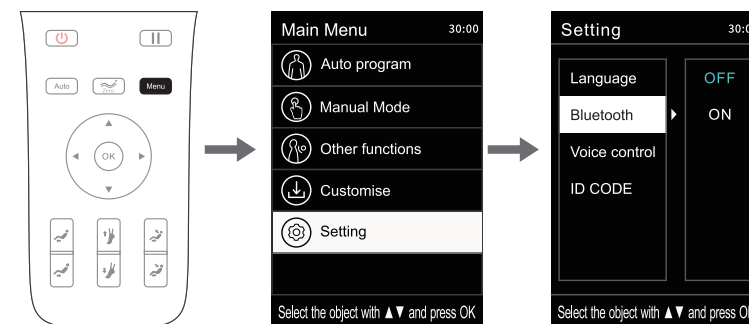

5a) Settings - Language Settings

- Voice settings: including Chinese and English (the function has memory, that is, after such selection, power-off and restart, it will be the last selected state).
- Enter the settings interface. Press "Up Key" or "Down Key" to select the language settings. Press "Right Button" to enter the language settings. Press "OK" to select the required Simplified Chinese or English; press "Left Button" to return to the previous menu interface.

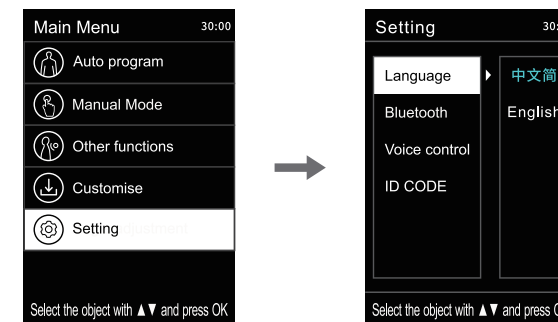

28 MANUAL CONTROL

5b) Settings - Bluetooth Settings

- Bluetooth settings (OFF by default): After the Bluetooth function of the massage chair is enabled, the Bluetooth-enabled audio source device (e.g. mobile phone, MID tablet) can be connected with the Bluetooth module of the massage chair, and the music played by the audio source device can be wirelessly transmitted to the audio system of the massage chair via Bluetooth for music playback.
- Enter the settings interface. Press "Up Key" or "Down Key" to select the Bluetooth settings. Press "Right Button" to enter the Bluetooth ON/OFF interface. Press "OK" to select the required ON or OFF; press "Left Button" to return to the previous menu interface.

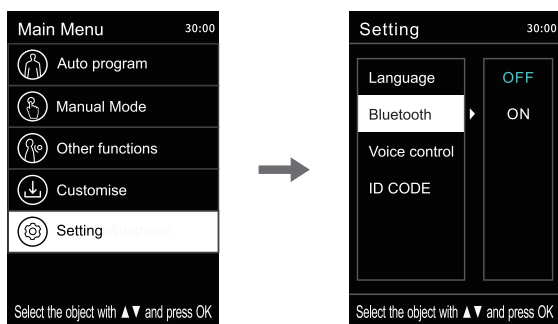

5c) Settings - Intelligent Voice Control

- Intelligent voice control: enable or disable the intelligent voice control function (the function has a memory, that is, after such selection, power-off and restart, it will be the last selected state); Note: When the intelligent voice control is disabled, voice wakeup cannot be performed.
- Enter the settings interface. Press "Up Key" or "Down Key" to select the intelligent voice control function. Press "Right Button" to enter the intelligent voice control function settings. Press "OK" to select the required ON or OFF; press "Left Button" to return to the previous menu interface.

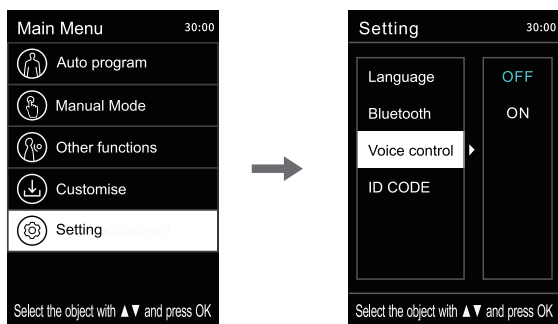

28

MANUAL CONTROL 29

5d) Settings - Equipment ID

- Equipment ID: Display the current device ID number.
- Enter the settings interface. Press "Up Key" or "Down Key" to select the equipment ID and check the equipment number of the current device.

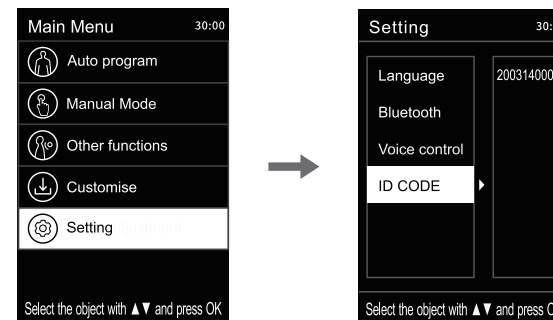

6) Message Adjustment

- In the state of the information interface, press "Left Button" or "Right Button" to select the message adjustment button, and press "OK" to enter the message adjustment interface.
- Message adjustment includes: 7 message adjustment functions can be selected, including back massage speed, back massage intensity, massage range, massage width, airbag intensity, roller speed, and massage time.
- After entering the message adjustment interface, press "Up Key" or "Down Key" to select the desired message adjustment function. After selecting any one of the desired message adjustment functions, use "Right Button" to enter the message level selection interface. Then press "OK" to confirm the selected level. Press "Left Button" to return to the previous menu interface.

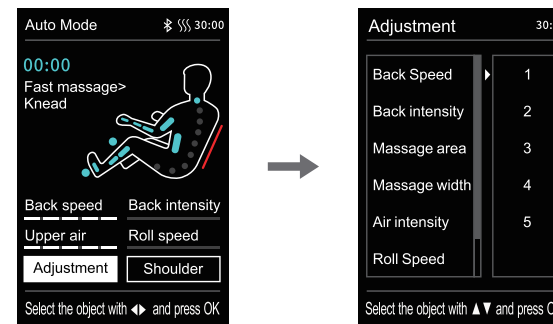

29

30 MANUAL CONTROL

| Function | Description |
|------------------------|---|
| Back massage speed | 5 speed levels adjustable |
| Back massage intensity | 5 intensity levels adjustable |
| Massage range | There are 5 modes for your choice: fixed point, local area, full back, upper back, and lower back |
| Massage width | 5 width levels adjustable |
| Airbag intensity | 5 intensity levels adjustable |
| Roller speed | Choose from 4 modes including OFF and Level 1-3 |
| Massage time | Choose from 4 modes: +10min, +5min, -5min, -10min |

Note:

- According to the remaining massage time, when the displayed time is not enough for the addition and subtraction of a certain time, the operation will not be displayed (the upper limit of the time display is 40 minutes). For example: If the display time of the remote controller is 39 minutes, the massage time adjustment range will be: - 5min, -10min (+10min or +5min cannot be displayed).
- The adjustment of airbag intensity can only be used when the airbag function or the automatic function is enabled (for more information about how to enable the airbag function, refer to Page 18 of the Operation Instructions).

5. Zero-Gravity Key







- Press "Zero-gravity Key" to adjust the position of zero gravity. You can choose different angle positions for zero gravity according to your own needs (i.e. 1st pressing is Level 1; 2nd pressing is Level 2; 3rd pressing is Level 3; and 4th pressing makes the massage chair restore to the original state).



MANUAL CONTROL 31

| Button | Description |
|---|---|
|  | Zero-gravity Key: Once it is pressed, the positions of the leg rest and the backrest can be automatically adjusted to the positions for zero gravity. There are three zero-gravity modes and the lying OFF mode, which can be switched. |

6. Lying Angle Adjustment Button

| Button | Description |
|---|--|
|  | Calf frame ascending key: Press and hold this key to slowly ascend the lower leg frame, and stop ascending when released; After the calf frame ascends, the calf frame will automatically detect the foot length. |
|  | Calf frame descending key: Press and hold this key to slowly descend the leg frame, and stop descending when released; After the calf frame descends, the calf frame will automatically detect the foot length. |
|  | Foot rest shortening key: Press and hold this key to manually adjust the foot rest to shorten slowly, and then stop when released. |
|  | Foot rest elongation key: Press and hold this key to manually adjust the foot rest to slowly elongate, and then stop when released. |
|  | Linkage sit-up key: Press and hold this key to slowly raise the backrest frame while the calf frame slowly descends; Release this key to stop the backrest frame from rising and the calf frame from descending; After the linkage sit-up action is completed, the calf frame will automatically detect the foot length. |
|  | Linkage lying key: Press and hold this key to slowly lower the backrest frame while slowly rising the calf frame; Release this key to stop the backrest frame from falling and the calf frame from rising; After the linkage sit-up action is completed, the calf frame will automatically detect the foot length. |





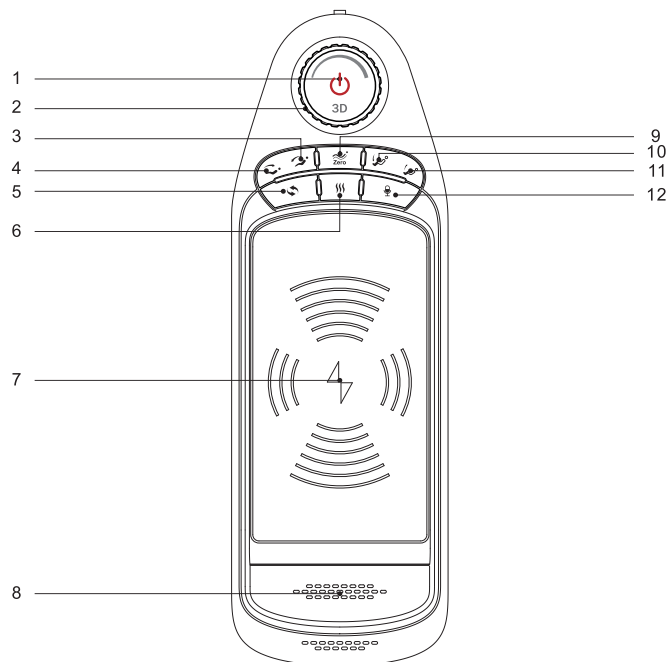

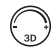

32 ARMREST SHORTCUTS

INTRODUCTION TO ARMREST SHORTCUT KEYS



1. **Power button:** press for two seconds to turn ON/OFF the massage chair.
2. **3D Intensity Knob:** Adjust the intensity of the 3D massage.
3. **Sitting Key:** Adjust the position to the sitting key.
4. **Lying Down Key:** Adjust the position to the lying down key.
5. **Automatic Key:** Switches between automatic programs.
6. **Heating Key:** Turn ON/OFF the heating.
7. **Wireless Charging:** Enables wireless charging.
8. **Voice Control Microphone:** Built-in voice control microphone.
9. **Zero-Gravity Key:** Adjust the massage chair zero-gravity position.
10. **Footrest Down Key:** Adjust the footrest angle downward.
11. **Footrest Up Key:** Adjust the footrest angle upward.
12. **Voice Control Key:** Press and hold the button for 3 seconds to turn ON/OFF the voice control function.

ARMREST SHORTCUTS 33

| Button | Description |
|---|--|
|  | Power button: short press this key to pause the operation, long press 2 seconds to start the key. If you pause for more than 20 minutes during the massage, all massage functions will be automatically turned off. |
|  | 3D intensity knob key: adjust the 3D massage hands massage intensity (counterclockwise for weakening, clockwise for strengthening) intensity range from 1 to 5. |
|  | Linkage sitting button: press this button to slowly rise the backrest, while the calfrest slowly fall, release to stop the backrest frame rising and calfrest falling. |
|  | Linkage lying down button: press this button to slowly descend the backrest, while the calfrest slowly rise, release it to stop the backrest and calfrest falling and rising. |
|  | Automatic mode key: every time press, automatic massage function switch. |
|  | heating treatment key: press this button to turn on or off the back heating function. |
|  | Zero gravity key: every time you press the key, automatically adjust the position of the calf and backrest frame to the zero gravity position, a total of three zero gravity lying mode, cycle switch. |
|  | Legrest up button: press this button to lift the crus slowly, release it and stop rising. |
|  | Legrest down button: press this button to slowly descend the crus, release to stop falling. |
|  | Voice and voice control wake-up button: Short press this button to wake up the voice control function, long press it for 3 seconds to turn on or off the function; If no valid voice entry is recognized within 6 seconds, the voice function will be automatically turned off (this button is only effective when the voice control switch is turned on). |

34 VOICE CONTROL

VOICE CONTROL MODE

- When the massage chair is turned on or in standby mode, the sound "Hi Alice" or "Hey Alice" will be produced to enable the voice control function. Alternatively, you can press the voice control button on the armrest to enable the voice control function.
- Long press 3 seconds to turn on or off the voice control function.
- After such function is enabled successfully, the massage chair will reply "I am here." At this moment, once a corresponding voice control entry to be implemented is given within six seconds, the corresponding voice control function can be performed after a reply is received from the massage chair; if no correct voice control entry is given within six seconds, the voice control function automatically will be off automatically and needs to be enabled again.

| Entry: "Hi Alice" or "Hey Alice". Answer: I am here. | | |
|--|---------------------------|---------------------------------------|
| No. | Voice control entry | Answer entry |
| 1 | Massage on | Answer: Ok, massage on |
| 2 | Massage close | Answer: Ok, massage close |
| 3 | Comfort Massage | Answer: Ok, comfort massage |
| 4 | Relax massage | Answer: Ok, relax massage |
| 5 | Full body massage | Answer: Ok, full body massage |
| 6 | Neck and shoulder massage | Answer: Ok, neck and shoulder massage |
| 7 | Back and waist massage | Answer: Ok, back and waist massage |
| 8 | Stretch massage | Answer: Ok, stretch massage |
| 9 | Open the air pressure | Answer: Ok, open the air pressure |
| 10 | Close the air pressure | Answer: Ok, close the air pressure |
| 11 | Up the seat position | Answer: Ok, up the seat position |
| 12 | Down the seat position | Answer: Ok, down the seat position |
| 13 | Change the other mode | Answer: Ok, change the other mode |
| 14 | Go little down | Answer: Ok, go little down |
| 15 | Go little up | Answer: Ok, go little up |

Note:

- When waking up the voice control function, please use English, the speech rate is moderate, Voice commands should be follow up the Voice entry.
- commands 14 and 15 can only be used after command 13.

OTHER OPERATIONS 35

BLUETOOTH SPEAKER PLAY

1. Enter the smart device main menu. Open "Settings" and select the "Bluetooth" option. Open "Bluetooth", and Bluetooth will automatically "Search for a New Bluetooth Device".
2. The smart device will search for the corresponding Bluetooth model (e.g. IMCMXXXX). Click the "Match" button. If you are asked whether to match with the device, you just select "Match" to complete matching.
3. Turn on "Music Player" in the smart device and select the song to play.

TURN OFF THE POWER AND STOP MASSAGE

- If the power button is pressed during massage, it will stop all the massage functions immediately, and the backrest, the legrest and massage chair manipulators will go back to the default positions. When the preset massage time is up, all the massage functions will be OFF. The backrest and the legrest will not go back to the default positions.

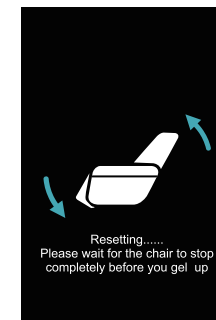
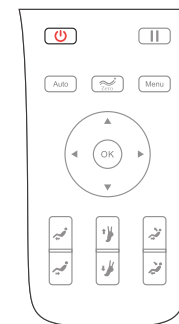

- Shut off the power supply of this product, as shown in the attached figure (Power Shut-off Diagram of the Product).

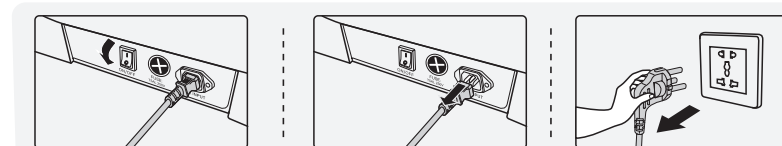

- ① Power Shut-off Diagram of the Product
- ② Disconnection Diagram
- ③ Unplugging Diagram



TROUBLESHOOTING

You may experience the following noises or feelings while a massage is in operation. Due to the mechanical design, they will not have any effect on the operation of the unit. However, other noises should be noted, and our support team should be contacted in those cases.

- A “clatter” noise occurs when the knead balls go up and down.
- A “creak” noise of the gear and the motor occurs while in massage.
- A friction noise occurs when the knead balls rub the cover cloth.
- A rattling noise occurs while in the “Tap” or “Dual” massage movements.
- In the “Knead”, “Tap”, or “Dual” massage movements, massaging speed may vary with the knead balls’ strength changed.
- A roaring noise of the motor occurs when the load is given to the chair.
- A “cuckoo” noise occurs while in the auto mode course, the knead balls are automatically adjusted to the back-and-forth position to have the chair fitting in with the user’s body shape.
- The compressor’s noise and the air exhausting noise occur while in air-massage.
- A noise occurs when the airbag is inflated.
- A noise occurs while the shoulders are being massaged.
- A grinding noise occurs when the backrest is reclined.
- There is a humming sound from the pump.

WARNING

Absolutely do not modify, disassemble or repair by yourself. Negligence may cause fire or mechanical trouble of the chair, which may result in hazard on the body.

| Problems | Check Point | Troubleshooting |
|--|---|--|
| The unit does not start up. | Check whether the switch has been turned on. | Turn on the switch. |
| | Check whether the  button on the remote controller has been pressed. | Press the  button on the remote controller. |
| | No massage function has been selected. | Select a massage function. |
| | Check whether there is poor connection between the power plug and the receptacle. | Ensure good connection between the power plug and the receptacle. |
| Different height of the left and right knead balls. | A mechanism is used to allow two knead balls tapping alternatively. | This is normal and does not come from the trouble of the chair. |
| Sudden noise rises during operation. | Check whether the unit has been in operation for too long. | Turn off the power and stop the operation. Restart the unit after 30-min break. |
| Sudden cease of operation. | The rated operating time has elapsed. | Turn off the power and stop the operation. Restart the unit after 30-min break. |
| The reclined backrest fails to return its stored position when  is pressed. | Excessive use of the unit. | Turn off the power and stop the operation. Restart the unit after 30-min break. |
| | The rated operating time has elapsed. | |
| The power indicator fails to light up after the power switch is turned on. | Check whether there is poor connection between the power plug and the receptacle. | Ensure good connection between the power plug and the receptacle. |
| | Whether the circuit breaker is tripped off. | Restore the circuit breaker. If the problem re-occurs after the circuit breaker is restored, please contact us. |

CAUTION

After checking, if the problem is caused by none of the above, switch off the power, unplug the power cord, and contact your dealer or our service center for repairs.

Prior to operating the unit when it has not been used for a long period of time, read this manual carefully and make sure that the unit is still in good condition to avoid accident or injury.

38 PRODUCT SPECIFICATION

Model: Vita-3D

Rated Voltage: 120V~ 60Hz

Rated Power: 150W

Rated Time: 20min

Material description: PVC, PA, Steel Parts, electric and electron components

| MATERIAL | PU | LEATHER | CLOTH | WOOD |
|----------|----|---------|-------|------|
| | | | | |