



PT-8100 USER GUIDE



Tracking Portal: <https://lvgps.net>

POWER ON THE PT-8100

- Firmly Press & Hold The Power Button located on the top left corner of the PT-8100 above the LED lights. Press the Power Button for at least 3 seconds.

CHARGE TIMES

- Internal Battery: 3.5 Hours
- Extended Battery: 12 Hours



LED LIGHT STATUS

GPS (**BLUE**) > Flashing > Trying To Get Fix > Solid > GPS Fixed

POWER (**RED**) > Flashing > Charging > Solid > Fully Charged

CEL (**GREEN**) > Fast Flashing > Trying To Connect To Network
> Slow Flashing > Establishing Network Connection
> Solid > Connected To Network

CHARGING THE PT-8100

The Standalone PT-8100 Includes: USB Charging Cable, 120 VAC Charger.



To Charge The PT-8100 Insert The USB Cable Into The USB port on the PT-8100. Charging Time Is Approximately 6 Hours. Once Fully Charged Expect 8-10 Motion Hours Of Live 10-Second GPS Tracking. When the device is not moving, it enters standby mode to save battery power, it updates positions every 8 hours when not moving.



EXTENDED BATTERY CHARGING/USE

The Extended Battery Kit Includes; Pelican Case with Magnetic Mount, 17.6 Ah battery, as well as battery to device adapter, and External battery charger cable.

Device Will Automatically Turn On When Connected to the External Battery. Device will also Automatically Turn Off When Disconnected to the External Battery.

CHARGE THE EXTERNAL BATTERY



To Charge The External Battery, Connect Wall Charger to Battery. Plug The AC-DC Power Adapter in the DC Connector Of The External Battery. The LED



indicator on the adapter will be red during charging, and green when the battery is fully charged. Approximate time to Full Charge is 16 hours.

Once fully charged you can expect approximately 140 motion hours of tracking. When not moving, the PT-8100 goes into standby mode, and updates its position every 8 hours.

CONNECT PT-8100 TO EXTERNAL BATTERY

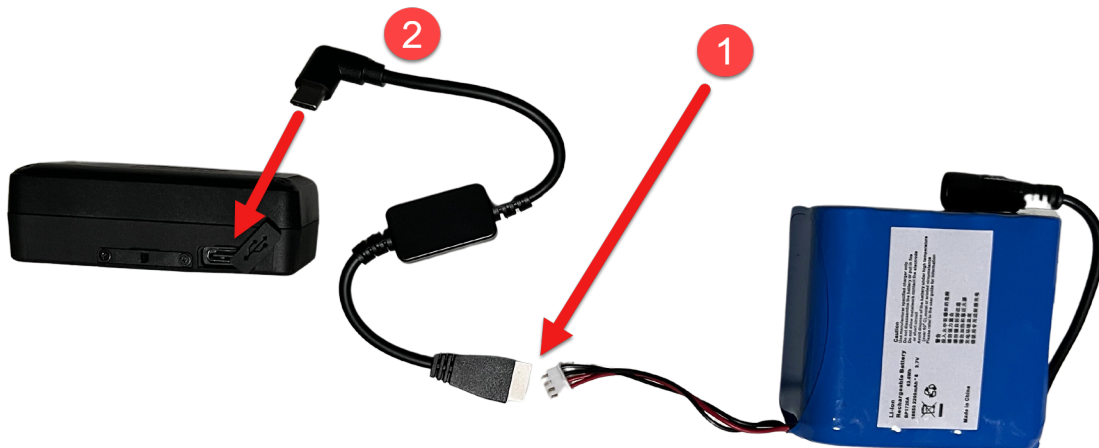

1. Connect Male Molex Connector From External Battery, To Female Connector (Adapter Cable: GL200PM).
2. Connect USB from Adapter Cable To PT-8100 USB Port.



INSERT INTO PELICAN CASE



1. Insert External Battery Into Right Side Of Pelican Case. Ensure that the external charging cable is tucked into the side of the case.
2. Insert PT-8100 Into Left Side Of Case. **Please Note The Orientation Of The USB Connector Cable - it faces into the case.**
3. Tuck The Adapter Cables into the space between the PT-8100 and the External Battery.
4. Close and Secure the Pelican Case.