



Scan & Like

Customer Service  
Technical Info.  
Parts & Accessories  
Promotions  
[www.facebook.com /AntraHelmets](http://www.facebook.com/AntraHelmets)

# **AH7-X30P SERIES**

Auto-Darkening Welding Helmet

User Manual

# Antra AH7-X30P Series Auto-Darkening Welding Helmet 2017

## WARNING

Read and understand this entire instruction manual before attempting to assemble, install, operate or maintain this tool. Failure to comply with the instructions may result in serious personal injury and/or property damage!

The following signal words are used to emphasize safety warnings that must be followed when using this tool:

### DANGER

Indicates an imminently hazardous situation that, if not avoided, WILL result in death or serious injury.

### WARNING

Indicates a potentially hazardous situation that, if not avoided, COULD result in death or serious injury.

### CAUTION

Indicates a potentially hazardous situation that, if not avoided, MAY result in minor or moderate injury.

### NOTICE

Indicates important information, which if not followed, MAY cause damage to equipment.

## IMPORTANT SAFETY INSTRUCTIONS FUMES AND GASES can be hazardous !



Welding produces fumes and gases that are hazardous to your health.

- Keep your head out of the fumes. Do not breathe the fumes.
- If inside, ventilate the area and/or use exhaust at the arc to remove welding fumes and gases.
- If ventilation is poor, use an approved air-supplied respirator.
- Read the manufacturer's instructions for metals, consumables, coatings, cleaners, and degreasers.
- Work in a confined space only if it is well ventilated, or while wearing an air-supplied respirator. Always have a trained watchperson nearby. Welding fumes and gases can displace air and lower the oxygen level causing injury or death. Be sure the breathing air is safe.
- Do not weld in locations near degreasing cleaning, or spraying operations. The heat and rays of the arc can react with vapors to form highly toxic and irritating gases.
- Do not weld on coated metals, such as galvanized, lead, or cadmium plated steel, unless the coating is removed from the weld area, the area is well ventilated, and if necessary, while wearing an air-supplied respirator. The coatings and any metals containing these elements can give off toxic fumes if welded.



### ARC RAYS can burn eyes !

Never look at arc welding without proper eye protection. Arc rays from the welding process produce intense visible and invisible (ultraviolet and infrared) rays that can burn eyes and skin. Hot sparks fly off from the weld and can burn eyes and skin.

Wear a welding helmet fitted with a proper shade of filter to protect your face and eyes when welding or watching.

- Wear approved safety glasses with side shields under your helmet.
- Use protective screens or barriers to protect others from flash and glare, warn others in the area not to watch the arc.
- Wear protective clothing made from durable, flame resistant materials, leather welding gloves and full foot protection.



### WELDING can cause fire or explosion !

Welding on closed containers, such as tanks, drums, or pipes, can cause them to explode. Sparks can fly off from the welding arc. The flying sparks, hot work piece, and hot equipment can cause fires and burns. Accidental contact of electrode to metal objects can cause sparks, explosion, overheating, or fire. Check and be sure the area is safe before doing any welding.

- Always keep a fire extinguisher readily available and watch for fire.
- Protect yourself and others from flying sparks and hot metal.
- Do not weld where flying sparks can strike flammable material.
- Remove all flammable materials from the welding area. If this is not possible, tightly cover them with approved covers
- Be alert that welding sparks and hot materials from welding can easily go through small cracks and openings to adjacent areas.
- Be aware that welding on a ceiling, floor, bulkhead, or partition can cause fire on the hidden side.
- Do not weld on closed containers such as tanks, drums, or pipes; unless they are properly prepared according to AWS F4.1 standards.
- Connect work cable to the work as close to the welding area as practical to prevent welding current from traveling long, possibly unknown paths and causing electric shock and fire hazards.
- Never use arc welder to thaw frozen pipes.
- Remove electrode from holder when not in use.
- Wear oil-free protective garments such as leather gloves, heavy shirt, cuff-less trousers, high shoes, and a cap.
- Remove any combustibles, such as butane lighters or matches, from your person before doing any welding.

## California Proposition 65 Warnings !

- Welding or cutting equipment produces fumes or gases which contain chemicals known to the State of California to cause birth defects and, in some cases, cancer. (California Health & Safety Code Section 25249.5 et seq.)
- This product contains chemicals, including lead, known to the State of California to cause cancer, birth defects, and reproductive harm. Wash hands after handling.

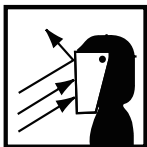

### FLYING METAL can injure eyes !

- Welding, chipping, wire brushing, and grinding cause sparks and flying metal. As welds cool, they can throw off slag.
- Wear ANSI approved safety glasses with side shields under your welding helmet.



### HOT PARTS can cause severe burns !

- Never touch hot parts bare handed.
- Allow adequate cooling period before touching work piece.



### NOISE can damage hearing !

- Noise from some processes or equipment can damage hearing.
- Wear approved ear protection if noise level is high.

## GENERAL INFORMATION

AH7-X30P Series Auto-Darkening Welding Helmet does not protect against severe impact hazards, such as fractured grinding wheels or abrasive discs, explosive devices or corrosive liquids. Machine guards or eye splash protection must be used when these hazards are present.

The auto-darkening welding filters are designed for Arc welding or cutting applications. The unit is suitable for all Arc welding processes such as MIG, MAG, TIG, SMAW, Plasma Arc, and Carbon Arc.

This auto-darkening welding helmet is not recommended for "overhead" welding applications, laser welding or laser cutting applications.

In the event of electronic failure, the welder remains protected against UV and IR radiation according to shade 16.

The auto-darkening welding filter should always be used with original inner and outer cover lenses.

The manufacturer is not responsible for any failure due to modifications to the welding filter or the use of the filter from any other manufacturer's helmet.

## TECHNICAL SPECIFICATIONS

Model	AH7-X30P
ADF Model	X30P
Viewing Area	98 x 89mm / 3.86" x 3.50"
Cartridge Size	133mm x 114mm x 9mm/5.24" x 4.5" x 0.35"
UV/IR Protection	Permanent Shade DIN 16
Light State	Shade DIN 4
Dark State	DIGITAL 5-8/9-13
Sensors	4
Grinding	Yes
Sensitivity Control	DIGITAL(1-5)
Delay Control	DIGITAL(1-5)/0.1-0.7S
TIG Rating	>2Amp
Battery Type	2 x CR 2032 ( Lithium 3 Volt )
Solar Cell	Yes
Operation Temperature	-5°C to +55°C (23° F to 131° F)
Storage Temperature	-20°C to +70°C (-4° F to 158° F)
Standards Compliance	ANSI Z87.1-2010 & CSA Z94.3-2007& CE EN379:2009-07

## MARKING EXPLAINED

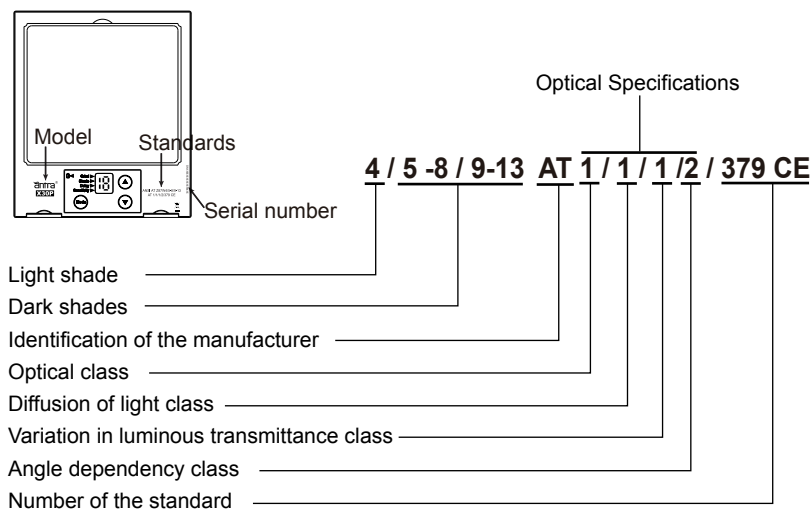

### NOTICE

This is a sample of EN379 marking only. For the product you are using, please refer to the marking information on the filter.

## ⚠ WARNING

- When stored in extremely cold temperature, the helmet should be warmed up to ambient temperature before welding.
- Inspect all parts for signs of wear or damage. Any scratched or cracked parts should be replaced prior to use.
- **SKIN CONTACT ALLERGIC ALERT!** Extra protections must be taken if individuals are allergic to plastic or other materials that his/her skin may be in contact with when using this product.

## PARTS LIST

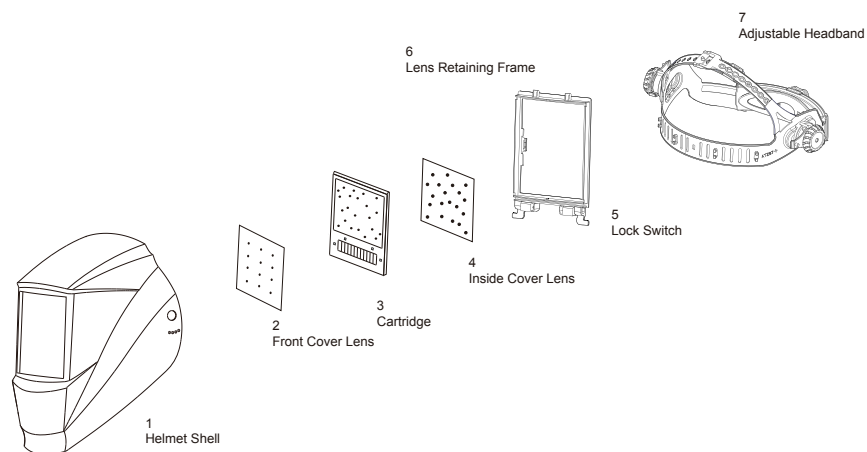

- NEVER place the helmet on a hot surface.
- NEVER open or tamper with the filter cartridge.

## 1. OPERATION

### ADJUST THE WELDING HELMET ACCORDING TO YOUR INDIVIDUAL REQUIREMENTS.

The headband should be adjusted both in circumference and height.

The angle between face and helmet should also be adjusted and recommended to be 10°-12°(Fig.1).

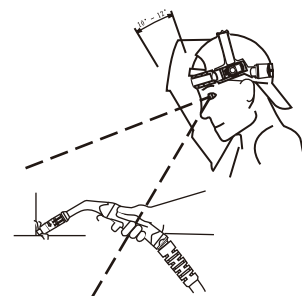

(Fig.1)

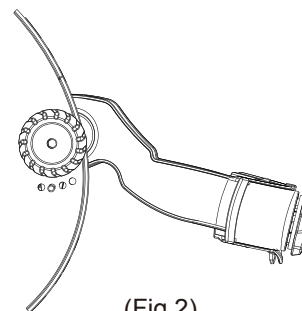

(Fig.2)

Adjust helmet's headband stop to get desired viewing angle(Fig.2).

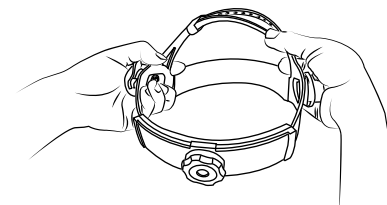

(Fig.3)

### ADJUST HEADBAND PER PERSONAL PREFERENCE.

Use the ratcheting knob on the headband to adjust width.

Loosen or tighten the top strap to adjust headband height, Make sure that the helmet fits firmly on your head(Fig.3).

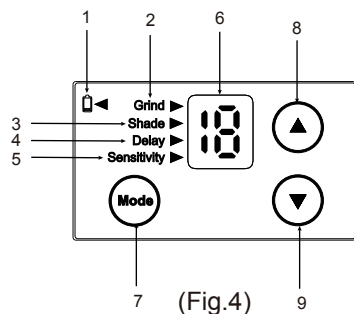
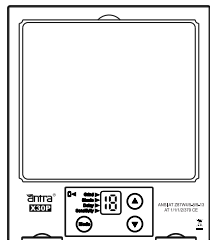

(Fig.4)

## ON/OFF

The solar unit automatically switches ON when exposed to light.  
Press any button to check if the lens is working properly and to begin Mode and Info adjustments.

## 2.PARAMETER ADJUSTMENT

### 1.SHADE CONTROL

Press the Mode button(7), until the triangle mode indicator is on Shade, the LED screen(6) now shows the current shade number. Press UP arrow (8) and DOWN arrow to set the desired shade number(Fig. 4).

To toggle between the two shade ranges 5-8 and 9-13, press and hold the UP button (8) for 3 seconds.

Once the range is switched, use the UP and Down arrow to set the desired shade.

### 2. DELAY CONTROL

Press the Mode button(7), until the triangle mode indicator is on Delay, the LED screen(6) now shows the current delay setting. Press UP arrow (8) and DOWN arrow to set the desired delay setting. Delay time can be adjusted from 1(0.1Seconds)-7(0.7 Seconds) (Fig.4).

## RECOMMENDED SETTINGS

### RECOMMENDED SETTINGS

WELDING PROCESS	CURRENT AMPERES																		
	0.5	1	2.5	5	10	15	20	30	40	60	80	100	125	150	175	200	225	250	300
Covered Electrode										Shade 9	Shade 10				Shade 11			Shade 12	
MIG Plate Welding										Shade 10					Shade 11			Shade 12	
MIG Sheet Metal										Shade 10					Shade 11			Shade 12	
TIG										Shade 8	Shade 9		Shade 10		Shade 11			Shade 12	
MAG											Shade 8	Shade 9	Shade 10		Shade 11			Shade 12	
Arc Gouging													Shade 10	Shade 11	Shade 12	Shade 13	Shade 14	Shade 15	
Plasma Cutting										Shade 5	6	7	8	9	10	Shade 11	Shade 12	Shade 13	Shade 14
Plasma Welding	4	5	6	7	8	9	Shade 10	Shade 11	Shade 12							Shade 13		Shade 14	Shade 15

REFERENCE ANSI Z49.1-2005

## 3.SENSITIVITY CONTROL

Press the Mode button(7), until the triangle mode indicator is on Sensitivity, the LED screen(6) now shows the current sensitivity setting. Press UP arrow (8) and DOWN arrow to set the desired sensitivity setting. Sensitivity can be adjusted from 1 to 5. Higher number means higher sensitivity.

## 4.GRIND

Press the Mode button(7), until the triangle mode indicator is on Grind, the helmet is on grinding mode.



Grinding mode will not response to any welding arc, and ALWAYS switch OFF grinding mode after using.

## 5.LOW POWER INDICATOR

If the indicator(1) blinks once in each 2 seconds, the batteries are low and replacement is required immediately. (Fig.4).

## 3.MAINTNANCE

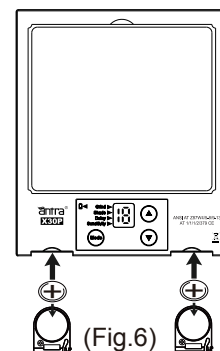

(Fig.6)

## REPLACEMENT OF BATTERIES

- 1) Detach the auto darkening filter from the helmet shield (Refer to REPLACEMENT OF WELDING FILTER)
- 2) Carefully open the battery compartments.
- 3) Put the new batteries into the compartments. (Fig.6)
- 4)Snap the compartments back into the filter.
- 5)Install the filter back onto the helmet shield.



Always change both of the batteries when renewing them.



NEVER put used batteries into house hold waste because they are very toxic to the environment.

Please always have used batteries recycled properly, and stay GREEN when welding.

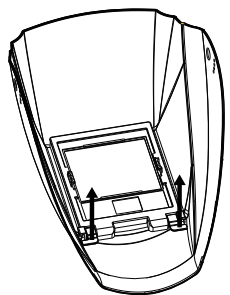

(Fig.7)

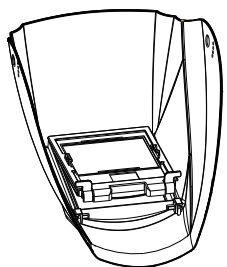

(Fig.8)

### REPLACEMENT OF EXTERIOR COVER LENS

Pull up the two lock lug on the bottom of the filter (Fig.7), the filter cartridge will pop loose from the shield.

Detach the cartridge from the shield and put it aside. Remove the old lens cover. Remove the protect film on the new lens cover(Fig.8). Put the new lens cover back onto the shield.

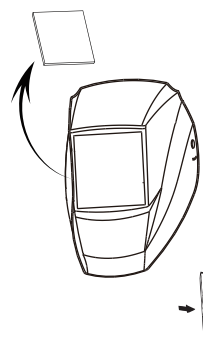

(Fig.9)

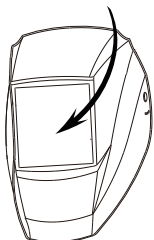

(Fig.10)

Feed the top edge of the cartridge back to the helmet shield (Fig.9 ). Push the bottom edge of the cartridge firmly and pull the lock lugs downwards to completely lock the cartridge (Fig.10).

### **⚠ WARNING**

Ensure the front cover lens is mounted before using and the protective film on the lens cover is removed.

Ensure that the lens is clean and there is no dirt or spatter covering the 4 sensors at the front of the filter cartridge.

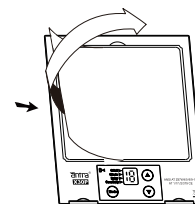

(Fig.11).

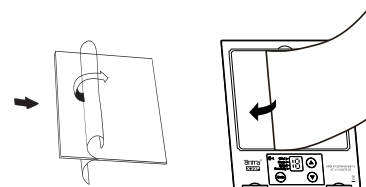

(Fig.12).

### REPLACEMENT OF INNER COVER LENS

Detach the auto darkening filter from the helmet shield (Refer to REPLACEMENT OF WELDING FILTER).

Lift up one edge of the inner cover lens and pull the cover lens away from the filter(Fig.11).

Remove protective film on the new inner lens cover, feed one side of the lens cover (Fig.12) onto lens retaining slots on the filter, then push it slightly all the way until the whole lens cover is snapped on properly.

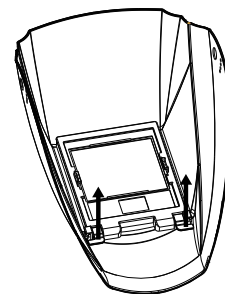

(Fig.13)

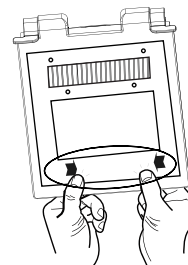

(Fig.14)

### REPLACEMENT OF WELDING FILTER

Pull up the two lock lug on the bottom of the filter (Fig.13), the filter cartridge will pop loose from the shield.

Detach the cartridge from the shield.

Hold the cartridge with both hands, with solar cell side up, lift top edge of the cartridge using thumbs to loose the filter from the cartridge. Try to pop up the filter from underneath using other fingers while thumb is pushing the cartridge edge upwards (Fig.14). Take the old filter out from the cartridge.

Feed the bottom of the new filter on the the bottom side of the cartridge.

Push gently on the top side of the filter, it will snap into the cartridge.

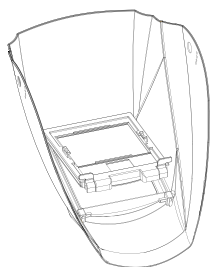

(Fig.15)

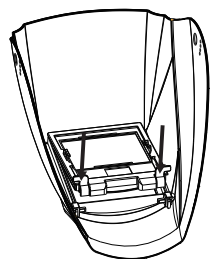

(Fig.16)

Feed the top edge of the cartridge back to the helmet shield (Fig.15). Push the bottom edge of the cartridge firmly and pull the lock lugs downwards to completely lock the cartridge (Fig.16).

## 4.INSPECTION

1. Carefully inspect your Auto-Darkening Welding Filter regularly.
2. Cracked, pitted or scratched filter glass or cover lenses reduced vision will seriously impair protection.
3. Worn parts should be replaced immediately to avoid injury to the eyes.

### CLEANING AND DISINFECTION

Clean the helmet with mild soap and lukewarm water.  
Clean the welding filter with a clean lint-free tissue or cloth.  
DO NOT immerse in water.  
DO NOT use solvents.

## TROUBLE SHOOTING

### AUTO DARKENING FILTER DOES NOT DARKEN OR FLICKER

- Check the lens cover for dirt and spatter that may be blocking the arc sensors.
- The sensors are dirty, wipe them clean with a soft lint-free cloth.
- Check the sensitivity setting recommendations and increase the sensitivity if possible.
- Increasing lens delay 0.1-0.3 second may also reduce flickering.
- Check batteries and verify that they are in good condition and installed properly.
- Battery terminals and the contact surface of the filter are dirty or oxidized(clean both) .
- Shade adjustment knob is on "GRIND" position, set helmet on "WELD" and/or proper shade from "5-13".

### THE LENS STAYS DARK AFTER THE WELD ARC IS EXTINGUISHED, OR THE AUTO-LENS STAYS DARK WHEN NO ARC IS PRESENT.

- Fine-tune the sensitivity setting in small increments. In extreme light conditions, it may be necessary to reduce the surrounding light levels.

### SLOW SWITCHING

- The operating temperature is too low, don't use at temperatures of below -5 °C (+23°F) .

### POOR VISION

- The cover lens and the filter cartridge is dirty or damaged, clean the dirty components and replace the damaged ones.
- Ensure ambient light is not too low.
- Ensure the shade number is correct and adjust accordingly.

### IRREGULAR DARKENING

- Headband has been set unevenly so the distance between the eyes and the lens is different from the left to the right side.

### **⚠ WARNING**

If the described malfunctions cannot be solved, stop using the helmet immediately and contact the nearest distributor.

## **WARRANTY**

We warrants to the purchaser that the product will be free from defects in material and workmanship for the period of one year from the date of purchase. Our sole obligation under this warranty is limited to replacement or repairs.

This warranty does not cover product malfunctions or damages, which result from the product being tampered, misused or abused. We are not responsible for any indirect damages or injury, which arises out of the use of the product.

We recommend a use for a period of 3 years, but no longer than 5 years. The duration of use depends on various factors such as use, cleaning, storage and maintenance. Frequently inspections and replacement if it is damaged are recommended.

Distributed by  
AntecTrade & IT Consulting Inc.  
106 Ferrier St.  
Markham, ON L3R 2Z5  
Canada

Ver1.0-01/2017