



Scan & Like

Customer Service
Technical Info.
Parts & Accessories
Promotions
[www.facebook.com /AntraHelmets](http://www.facebook.com/AntraHelmets)

AH6-330 SERIES

Auto-Darkening Welding Helmet





User Manual

Antra AH6-330 Series Auto-Darkening Welding Helmet 2017

⚠ WARNING

Read and understand this entire instruction manual before attempting to assemble, install, operate or maintain this tool. Failure to comply with the instructions may result in serious personal injury and/or property damage!

The following signal words are used to emphasize safety warnings that must be followed when using this tool:

 DANGER	Indicates an imminently hazardous situation that, if not avoided, WILL result in death or serious injury.
 WARNING	Indicates a potentially hazardous situation that, if not avoided, COULD result in death or serious injury.
 CAUTION	Indicates a potentially hazardous situation that, if not avoided, MAY result in minor or moderate injury.
 NOTICE	Indicates important information, which if not followed, MAY cause damage to equipment.

⚠ IMPORTANT SAFETY INSTRUCTIONS FUMES AND GASES can be hazardous !



Welding produces fumes and gases that are hazardous to your health.

- Keep your head out of the fumes. Do not breathe the fumes.
- If inside, ventilate the area and/or use exhaust at the arc to remove welding fumes and gases.
- If ventilation is poor, use an approved air-supplied respirator.
- Read the manufacturer's instructions for metals, consumables, coatings, cleaners, and degreasers.
- Work in a confined space only if it is well ventilated, or while wearing an air-supplied respirator. Always have a trained watchperson nearby. Welding fumes and gases can displace air and lower the oxygen level causing injury or death. Be sure the breathing air is safe.
- Do not weld in locations near degreasing cleaning, or spraying operations. The heat and rays of the arc can react with vapors to form highly toxic and irritating gases.
- Do not weld on coated metals, such as galvanized, lead, or cadmium plated steel, unless the coating is removed from the weld area, the area is well ventilated, and if necessary, while wearing an air-supplied respirator. The coatings and any metals containing these elements can give off toxic fumes if welded.



ARC RAYS can burn eyes !

Never look at arc welding without proper eye protection. Arc rays from the welding process produce intense visible and invisible (ultraviolet and infrared) rays that can burn eyes and skin. Hot sparks fly off from the weld and can burn eyes and skin.

Wear a welding helmet fitted with a proper shade of filter to protect your face and eyes when welding or watching.

- Wear approved safety glasses with side shields under your helmet.
- Use protective screens or barriers to protect others from flash and glare, warn others in the area not to watch the arc.
- Wear protective clothing made from durable, flame resistant materials, leather welding gloves and full foot protection.



WELDING can cause fire or explosion !

Welding on closed containers, such as tanks, drums, or pipes, can cause them to explode. Sparks can fly off from the welding arc. The flying sparks, hot work piece, and hot equipment can cause fires and burns. Accidental contact of electrode to metal objects can cause sparks, explosion, overheating, or fire. Check and be sure the area is safe before doing any welding.

- Always keep a fire extinguisher readily available and watch for fire.
- Protect yourself and others from flying sparks and hot metal.
- Do not weld where flying sparks can strike flammable material.
- Remove all flammable materials from the welding area. If this is not possible, tightly cover them with approved covers
- Be alert that welding sparks and hot materials from welding can easily go through small cracks and openings to adjacent areas.
- Be aware that welding on a ceiling, floor, bulkhead, or partition can cause fire on the hidden side.
- Do not weld on closed containers such as tanks, drums, or pipes; unless they are properly prepared according to AWS F4.1 standards.
- Connect work cable to the work as close to the welding area as practical to prevent welding current from traveling long, possibly unknown paths and causing electric shock and fire hazards.
- Never use arc welder to thaw frozen pipes.
- Remove electrode from holder when not in use.
- Wear oil-free protective garments such as leather gloves, heavy shirt, cuff-less trousers, high shoes, and a cap.
- Remove any combustibles, such as butane lighters or matches, from your person before doing any welding.

⚠ California Proposition 65 Warnings !

- Welding or cutting equipment produces fumes or gases which contain chemicals known to the State of California to cause birth defects and, in some cases, cancer. (California Health & Safety Code Section 25249.5 et seq.)
- This product contains chemicals, including lead, known to the State of California to cause cancer, birth defects, and reproductive harm. Wash hands after handling.

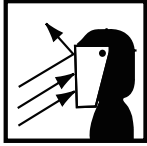

FLYING METAL can injure eyes !

- Welding, chipping, wire brushing, and grinding cause sparks and flying metal. As welds cool, they can throw off slag.
- Wear ANSI approved safety glasses with side shields under your welding helmet.



HOT PARTS can cause severe burns !

- Never touch hot parts bare handed.
- Allow adequate cooling period before touching work piece.



NOISE can damage hearing !

- Noise from some processes or equipment can damage hearing.
- Wear approved ear protection if noise level is high.

GENERAL INFORMATION

AH6-330-0000 Auto-Darkening Welding Helmet does not protect against severe impact hazards, such as fractured grinding wheels or abrasive discs, explosive devices or corrosive liquids. Machine guards or eye splash protection must be used when these hazards are present.

The auto-darkening welding filters are designed for Arc welding or cutting applications. The unit is suitable for all Arc welding processes such as MIG, MAG, TIG, SMAW, Plasma Arc, and Carbon Arc.

This auto-darkening welding helmet is not recommended for "overhead" welding applications, laser welding or laser cutting applications.

In the event of electronic failure, the welder remains protected against UV and IR radiation according to shade 16.

The auto-darkening welding filter should always be used with original inner and outer cover lenses.

The manufacturer is not responsible for any failure due to modifications to the welding filter or the use of the filter from any other manufacturer's helmet.

TECHNICAL SPECIFICATIONS

ADF Model	X30
Viewing Area	98 x 53mm / 3.86" x 2.09
Cartridge Size	110mm x 90mm x 9mm/4.33" x 3.54" x 0.35"
UV/IR Protection	Permanent Shade DIN 13
Light State	Shade DIN 4
Dark State	DIGITAL 5-8/9-13
Sensors	4
Grinding	Yes
Sensitivity Control	DIGITAL(1-4)
Delay Control	DIGITAL(1-5)/0.1-0.7S
TIG Rating	>2Amp
Battery Type	2 x CR 2032 (Lithium 3 Volt)
Solar Cell	Yes
Operation Temperature	-5°C to +55°C (23° F to 131° F)
Storage Temperature	-20°C to +70°C (-4° F to 158° F)
Standards Compliance	ANSI Z87.1-2010 & CSA Z94.3-2007& CE EN379:2009-07

MARKING EXPLAINED

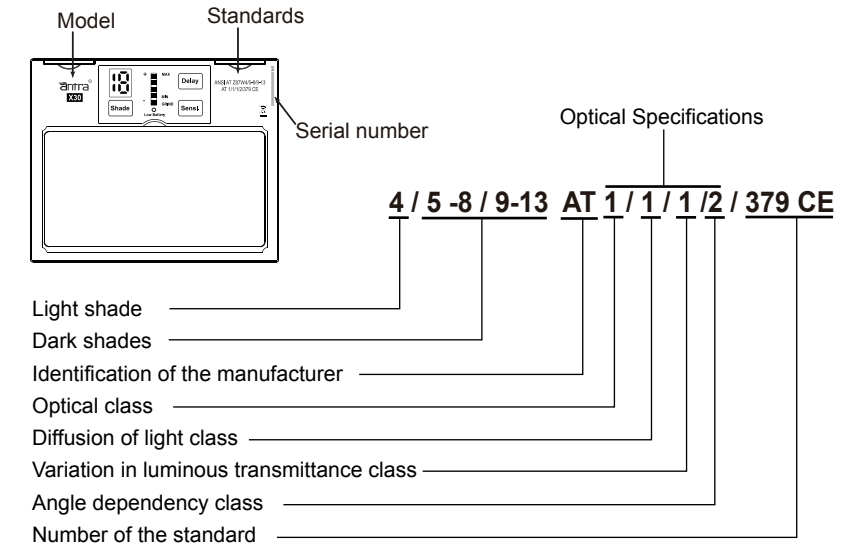

NOTICE

This is a sample of EN379 marking only. For the product you are using, please refer to the marking information on the filter.

⚠ WARNING

- When stored in extremely cold temperature, the helmet should be warmed up to ambient temperature before welding.
- Inspect all parts for signs of wear or damage. Any scratched or cracked parts should be replaced prior to use.
- **SKIN CONTACT ALLERGIC ALERT!** Extra protections must be taken if individuals are allergic to plastic or other materials that his/her skin may be in contact with when using this product.

PARTS LIST

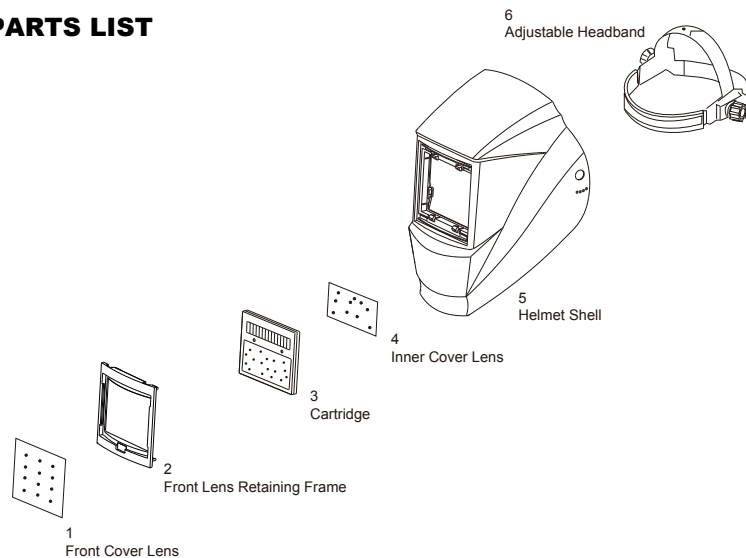

- NEVER place the helmet on a hot surface.
- NEVER open or tamper with the filter cartridge.

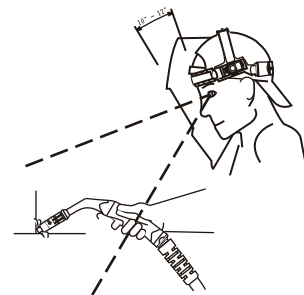

(Fig.1)

1. OPERATION

ADJUST THE WELDING HELMET ACCORDING TO YOUR INDIVIDUAL REQUIREMENTS.

The headband should be adjusted both in circumference and height.

The angle between face and helmet should also be adjusted and recommended to be 10°-12°(Fig.1).

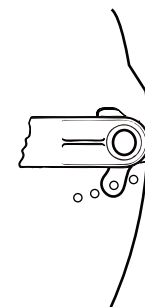

(Fig.2)

Adjust helmet's headband stop to get desired viewing angle(Fig.2).

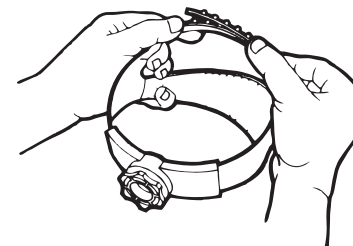

(Fig.3)

ADJUST HEADBAND PER PERSONAL PREFERENCE.

Use the ratcheting knob on the headband to adjust width.

Loosen or tighten the top strap to adjust headband height, Make sure that the helmet fits firmly on your head(Fig.3).

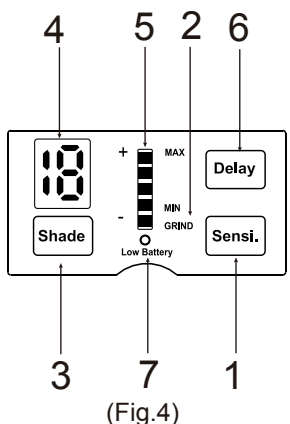
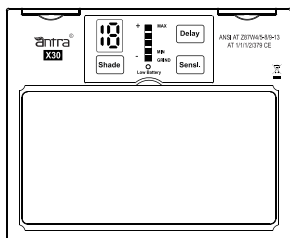

(Fig.4)

ON/OFF

The solar unit automatically switches ON when exposed to light.
Press any button to check if the lens is working properly and to begin Mode and Info adjustments.

2.PARAMETER ADJUSTMENT

- 1.Press Sens(1), The filter is on GRIND(2) when the first red indicator lamp(5) lightening.
- 2.Adjust the shade(3) setting 4(4),filter is under GRIND mode. Adjust the shade setting 5-8 or 9-13, filter is under WELD mode.
- Long press Shade(3), two ranges can be exchanged.
3. Press Sens(1),the filter's sensitivity is from Low to High when the red indicator lamp lightening gradually from second to fifth.
- 4.Press Delay(6), the filter's delay is from Fast to Slow when the red indicator lamp lightening gradually from first to fifth.

The first is 100ms, second is 250ms, third is 400ms, forth is 550ms, fifth is 700ms.

RECOMMENDED SETTINGS

WELDING PROCESS	CURRENT AMPERES																			
	0,5	1	2,5	5	10	15	20	30	40	60	80	100	125	150	175	200	225	250	275	300
Covered Electrode	Shade 9				Shade 10				Shade 11				Shade 12				Shade 13			
MIG Plate Welding	Shade 9				Shade 10				Shade 11				Shade 12				Shade 13			
MIG Sheet Metal	Shade 9				Shade 10				Shade 11				Shade 12				Shade 13			
TIG	Shade 8				Shade 9				Shade 10				Shade 11				Shade 12			
MAG	Shade 8				Shade 9				Shade 10				Shade 11				Shade 12			
Arc Gouging	Shade 8				Shade 9				Shade 10				Shade 11				Shade 12			
Plasma Cutting	Shade 5				Shade 6				Shade 7				Shade 8				Shade 9			
Plasma Welding	Shade 5				Shade 6				Shade 7				Shade 8				Shade 9			

REFERENCE ANSI Z49.1-2005

In order to save battery power, indicator lamp and digital screen will be closed after 2 seconds. It doesn't affect filter's work.

Please replace battery when Low Battery indictaor light blinks(7).

3.MAINTNANCE

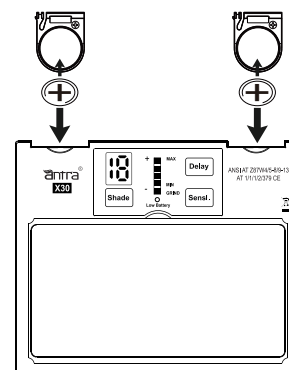

(Fig.5)

REPLACEMENT OF BATTERIES

- 1) Detach the auto darkening filter from the helmet shield (Refer to REPLACEMENT OF WELDING FILTER)
- 2) Carefully open the battery compartments.
- 3) Put the new batteries into the compartments.
- 4)Snap the compartments back into the filter.
- 5)Install the filter back onto the helmet shield.



NOTICE Always change both of the batteries when renewing them.



NEVER put used batteries into house hold waste because they are very toxic to the environment.

Please always have used batteries recycled properly, and stay GREEN when welding.

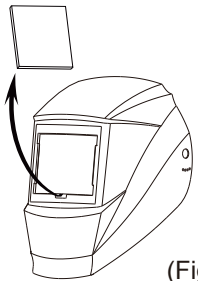

(Fig.6)

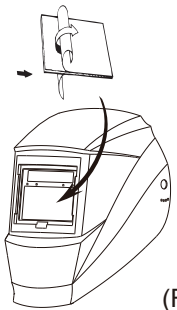

(Fig.7)

Take out the old cover lens (Fig.6).

Make sure that the protective film is removed from the new cover lens.

Place the new cover lens in the recess at the front of the helmet (Fig.7).

⚠ WARNING

Ensure the front cover lens is mounted before using and the protective film on the lens cover is removed.

Ensure that the lens is clean and there is no dirt or spatter covering the 4 sensors at the front of the filter cartridge.

REPLACEMENT OF INNER COVER LENS

Detach the auto darkening filter from the helmet shield (Refer to REPLACEMENT OF WELDING FILTER).

Lift up one edge of the inner cover lens and pull the cover lens away from the filter(Fig.8).

Remove protective film on the new inner lens cover, feed one side of the lens cover (Fig.9) onto lens retaining slots on the filter, then push it slightly all the way until the whole lens cover is snapped on properly.

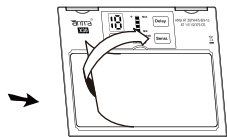

(Fig.8)

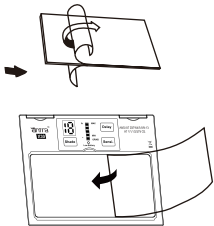

(Fig.9)

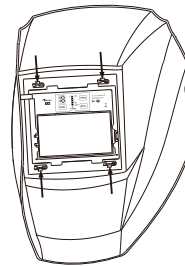

(Fig.10)

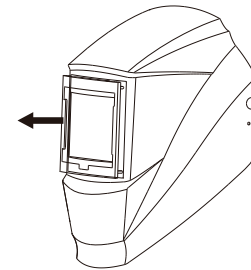

(Fig.11)

REPLACEMENT OF WELDING FILTER

1. Front cover lens retainer removal

There are 4 lugs on the front cover lens retainers, locked into the 4 slots on the shield. Use a tool like ball pen will make it much easier to loose these lugs.

1) Put the helmet on one hand, holding the lens cover retainer, with the interior side of helmet facing up. Use the ball pen to push the lug inwards to the center of the filter, the lug will sag a bit into the slot(Unlocked from the slot on the shield),

2) then press the lug downwards (completely unlocked from the shield)(Fig.10) .

3) Repeat 1)-2) for all 4 lugs.

2. Front cover lens retainer removal

Now the front cover lens retainer can be removed(Fig.11).

3. Filter removal

There are 4 lugs on the shield holding the filter firmly. To remove the filter, lift TOP lugs using thumb of one hand and at the mean time push the TOP part of filter with the other hand, the Filter will be lifted out of the lugs. Once it is completely popped up, take the filter out of the shield carefully.

4. Filter installation

- 1) Position the filter, make sure the solar panel is outside and up position.
- 2) Slide the bottom of the filter first into the shield, with all bottom edge sitting correctly into bottom lugs.
- 3) Lift the TOP lugs from inside while pushing the UP edge of the filter into the TOP lugs, once both of the TOP lugs are on the UP edge of the filter, push the filter slightly and the lugs will lock the filter in position.

5. Front cover installation

Position the lens retainer correctly, push and lock the lens retainer in the shield properly.

4.INSPECTION

1. Carefully inspect your Auto-Darkening Welding Filter regularly.
2. Cracked, pitted or scratched filter glass or cover lenses reduced vision will seriously impair protection.
3. Worn parts should be replaced immediately to avoid injury to the eyes.

CLEANING AND DISINFECTION

Clean the helmet with mild soap and lukewarm water.
Clean the welding filter with a clean lint-free tissue or cloth.
DO NOT immerse in water.
DO NOT use solvents.

TROUBLE SHOOTING

AUTO DARKENING FILTER DOES NOT DARKEN OR FLICKER

- Check the lens cover for dirt and spatter that may be blocking the arc sensors.
- The sensors are dirty, wipe them clean with a soft lint-free cloth.
- Check the sensitivity setting recommendations and increase the sensitivity if possible.
- Increasing lens delay 0.1-0.3 second may also reduce flickering.
- Check batteries and verify that they are in good condition and installed properly.
- Battery terminals and the contact surface of the filter are dirty or oxidized(clean both) .
- Shade adjustment knob is on "GRIND" position, set helmet on "WELD" and/or proper shade from "5-13".

THE LENS STAYS DARK AFTER THE WELD ARC IS EXTINGUISHED, OR THE AUTO-LENS STAYS DARK WHEN NO ARC IS PRESENT.

- Fine-tune the sensitivity setting in small increments. In extreme light conditions, it may be necessary to reduce the surrounding light levels.

SLOW SWITCHING

- The operating temperature is too low, don't use at temperatures of below -5 °C (+23°F) .

POOR VISION

- The cover lens and the filter cartridge is dirty or damaged, clean the dirty components and replace the damaged ones.
- Ensure ambient light is not too low.
- Ensure the shade number is correct and adjust accordingly.

IRREGULAR DARKENING

- Headband has been set unevenly so the distance between the eyes and the lens is different from the left to the right side.



If the described malfunctions cannot be solved, stop using the helmet immediately and contact the nearest distributor.

WARRANTY

We warrants to the purchaser that the product will be free from defects in material and workmanship for the period of one year from the date of purchase. Our sole obligation under this warranty is limited to replacement or repairs.

This warranty does not cover product malfunctions or damages, which result from the product being tampered, misused or abused. We are not responsible for any indirect damages or injury, which arises out of the use of the product.

We recommend a use for a period of 3 years, but no longer than 5 years. The duration of use depends on various factors such as use, cleaning, storage and maintenance. Frequently inspections and replacement if it is damaged are recommended.

Distributed by
AntecTrade & IT Consulting Inc.
106 Ferrier St.
Markham, ON L3R 2Z5
Canada

Ver1.0-03/2017