

Global Vacuum PRODUCTS

P: 516-759-6400 • F: 516-759-6464 • globalvacuum.com

A Kelly Vacuum Technologies Company

Roots 1203 / 1803 spare parts

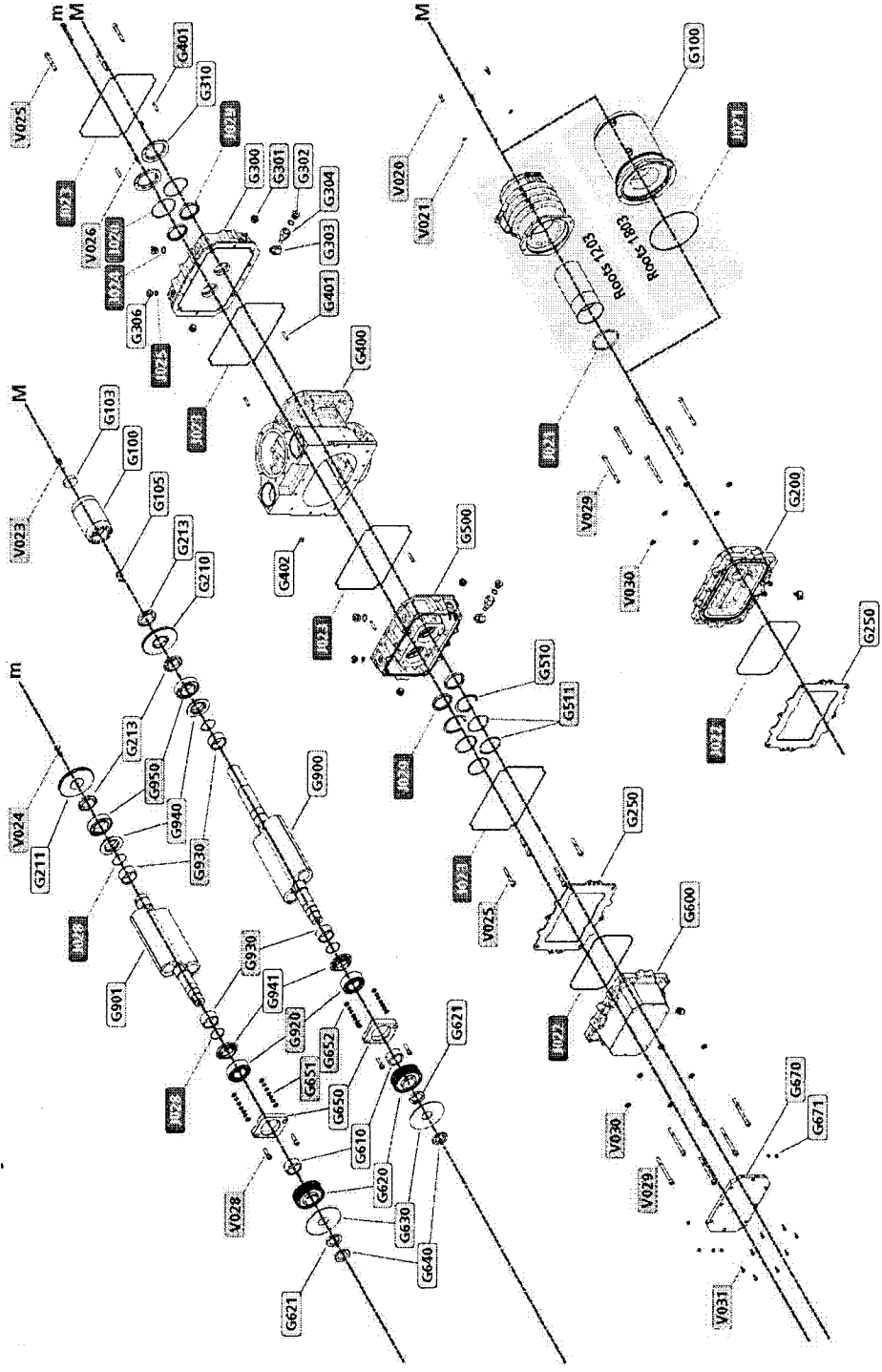

Rep.	Description	Qty*	P/N
V020	Screw Chc M 8 x 20	4/4	075514
V021	Ondurflex washer D6	4/4	073455
G100	Roots 1203 motor	1/1	110023
G101	Roots 1803 motor	1/1	112393
J021	O-ring c5.33 x d91.44 Roots 1203	1/1	Seals kit
V023	O-ring c3 x d165 Roots 1803	1/1	Seals kit
G103	Screw H M12 x 40	1/1	075438
G105	Motor rotor washer	1/1	104395
V029	Parallel key	1/1	104802
V030	Screw FHC M12 x 35.10.9	12/12	111375
V031	Ondurflex washer	12/12	073476
J022	O-ring c3 x d255	1/1	A005971
G200	Lubrication disk (driving)	2/2	Seals kit
G210	Lubrication disk (driven)	1/1	A329919
G211	Nut KM 10	3/3	A329920
G213	Sealing plate	2/2	104795
G250	Motor flange	1/1	A111532
V025	O-ring c3 x d305	4/4	Seals kit
J023	Screw Chc M10 x 70	8/8	104797
V026	Screw Chc M4 x 12	4/4	075519
G310	Oil regulator	2/2	A329912
J029	Lip seal (7/6 x 61 x 8)	4/4	Seals kit
G301	Oil sight glass	4/4	Maint. kit
G302	Plug	4/4	076791
J024	O-ring c2.7 x d18.4	4/4	Seals kit
G303	Adaptor	1/2	100045
G304	Drain pipe	1/2	100046
G306	Blank of flange M12	2/2	106409
J025	O-ring c2.7 x d13.6	2/2	Seals kit
G400	Stator Roots 1203/1803	1/1	A005968
G401	Centering pin	6/6	Maint. kit
G402	1/4 BSPT plug	1/1	102554
G500	Gearside flange	1/1	A111531
G510	Circlip	2/2	Maint. kit
G511	Spring washer	4/4	Maint. kit
G600	Gearbox casing	1/1	A005973
G610	Gearside spacer	2/2	104399
G620	Set of gears	1/1	106350
G621	Spacer	2/2	104398
G630	Lubrication disk	2/2	104396
G640	Nut KM 8	2/2	104794

Rep.	Description	Qty*	P/N
G650	Bearing flange	2/2	106392
G651	Shim sp.0.3 mm	20/20	Maint. kit
G652	Strip-off shim	1/1	Maint. kit
V028	Screw Chc M10 x 35	4/4	104711
G670	Cooling plate	1/1	A279892

Rep.	Description	Qty*	P/N
G671	1/8 BSP plug	7/7	109760
G900	Driving shaft	1/1	A005899
G901	Driven shaft	1/1	A005898
G920	Angular ball bearing	2/2	Maint. kit
J020	O-ring c3 x d68	2/2	Seals kit

Rep.	Description	Qty*	P/N
G930	Friction ring	4/4	Maint. kit
J028	O-ring c2 x d50	4/4	Seals kit
G940	Deflector (motor side)	2/2	106391
G941	Deflector (gears side)	2/2	106390
G950	Bearings (motor side)	2/2	Maint. kit

* Quantity / total quantity

Global Vacuum PRODUCTS

P: 516-759-6400 • F: 516-759-6464 • globalvacuum.com

A Kelly Vacuum Technologies Company

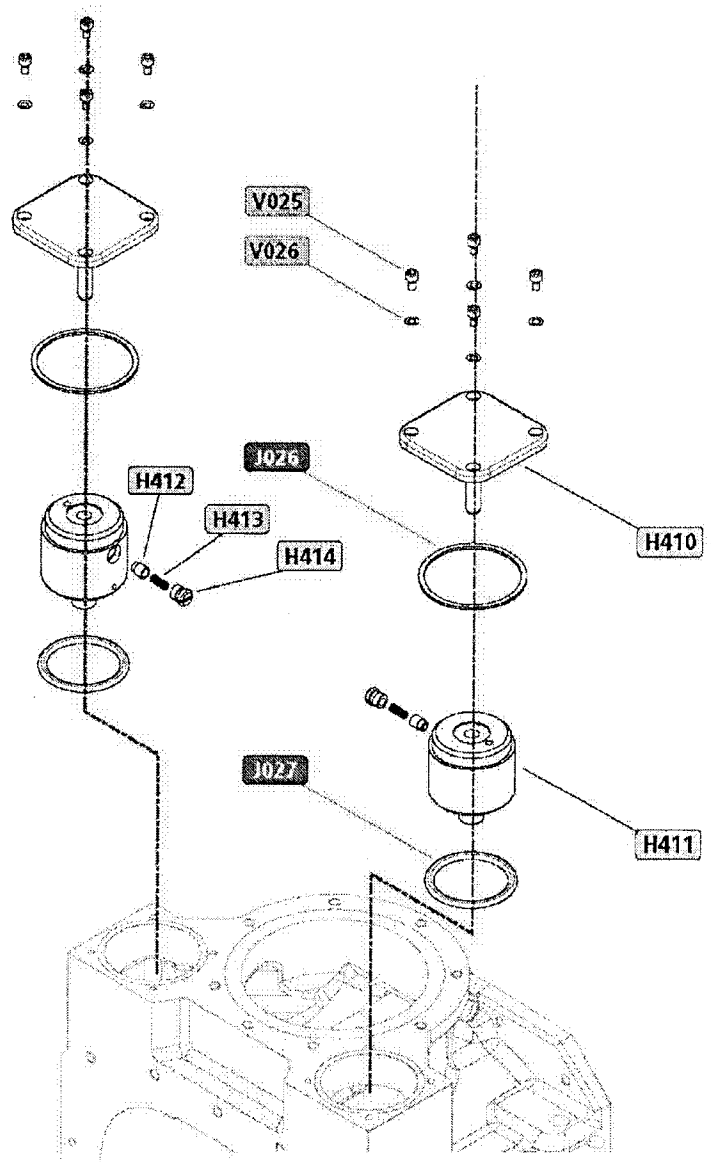

Rep.	Description	Qty*	P/N
V025	Screw CHc M6 - 10	8/8	050393
V026	Onduflex washer M6	8/8	073454
H410	Cover	2/2	060115
J026	O-ring c3 x d80	2/2	Seals kit
H411	By-pass stop valve	2/2	060114
J027	O-ring c5,33 x d56.52	2/2	Seals kit
H412	Block	2/2	060116
H413	Spring	2/2	Maint. kit
H414	Setting screw	2/2	Maint. kit

* Quantity / Total quantity