

\* ORIENTATE OPEN SIDE OF OIL BAFFLE OPPOSITE TO EXHAUST PORT

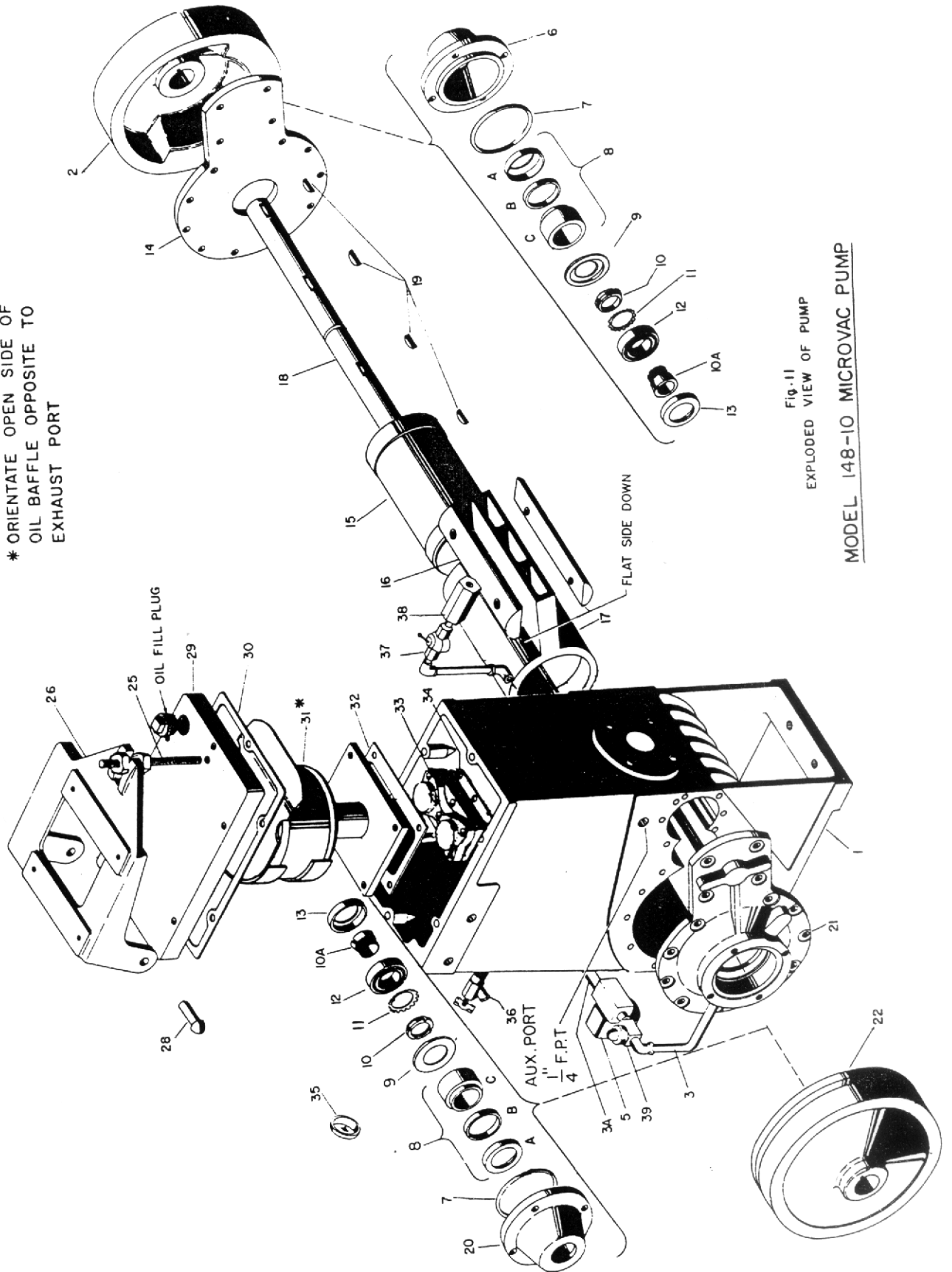
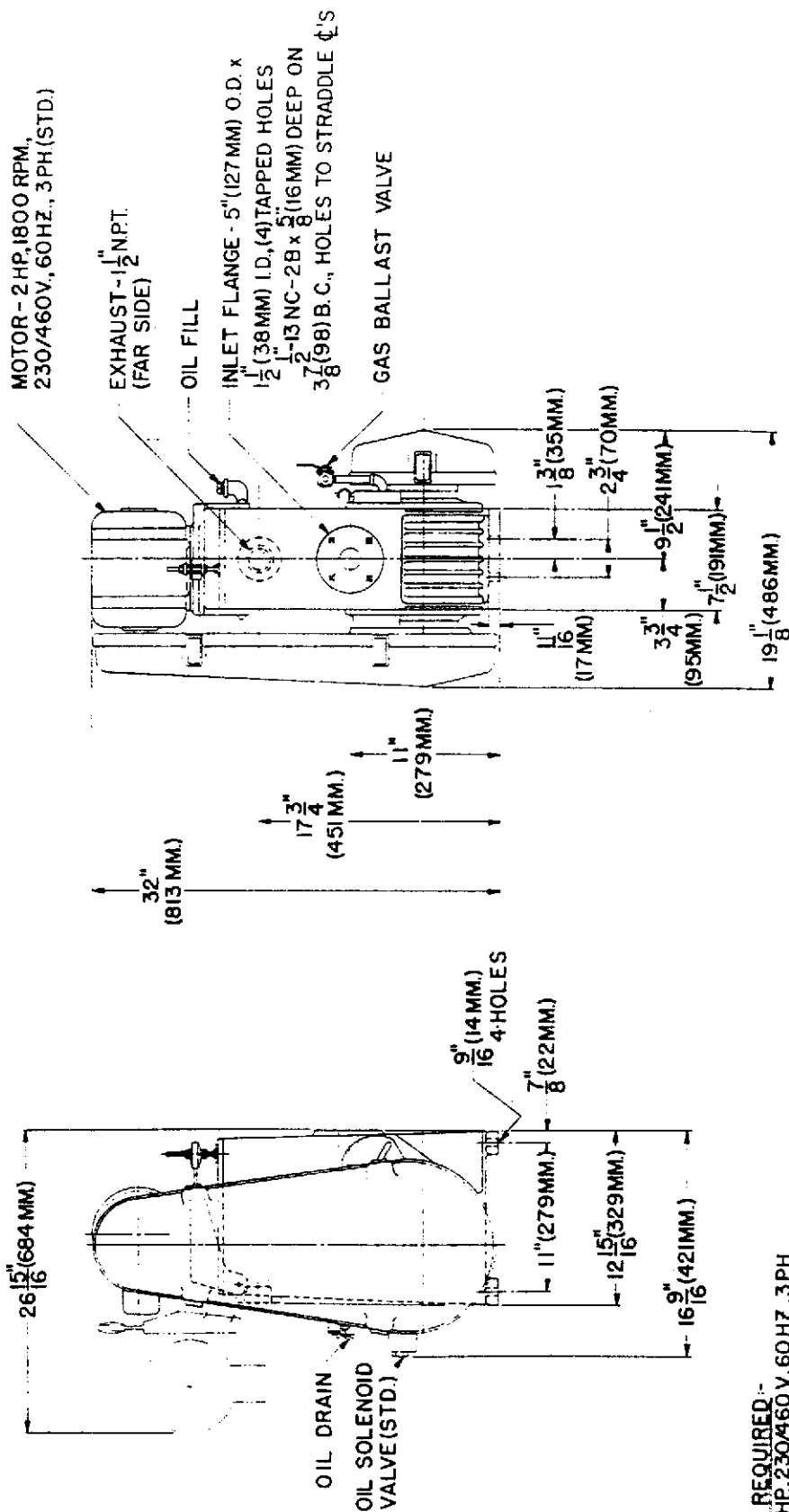

Fig. 11  
EXPLODED VIEW OF PUMP  
MODEL 148-10 MICROVAC PUMP



**SERVICES REQUIRED -**  
**POWER - 2 HP, 230/460 V, 60 HZ, 3 PH.**  
**AIR COOLED.**

**STOKES MODEL 148-H MICROVAC PUMP**

( 900-148-10)  
Fig.-12

RECOMMENDED REPLACEMENT PARTS KIT

For Model 148-H-10

The following replacement parts kit is recommended for your maintenance inventory to minimize downtime, assure availability of critical parts when maintenance is scheduled and assure you of proper "new equipment" replacement parts when and if emergencies occur.

<u>Quantity</u>	<u>Part Numbers</u>	<u>Description</u>
1	085-30-950	Solenoid Coil
2	085-10-102	"O" Ring for End Caps
2	085-18-194	Shaft Seal
1	257-663-1	Reservoir Cover Gasket
1	257-654-1	Oil Baffle Gasket
2	274-172-1	Valve Spring
2	276-781-2	Valve Clapper
1	243-926-2	Valve Plate Gasket
1	085-24-134	Check Valve Spring
1	085-24-131	Check Valve "O" Ring (Dynamic)
1	085-24-132	Check Valve "O" Ring (Static)
1	085-15-088	"v" Belts
1	085-24-133	Teflon Check Valve Back-Up Ring
2	085-34-729	Pkg. Ring - Oil Flow Indicator

When completing the kit after parts have been used, the following breakdown is offered for your ordering information:

Kit containing all "O" rings, gaskets, valve clapper and springs noted above including Oil Flow Indicator Seals Check Valve Parts.

- 2 Rotary Oil Seals . . . . .
- 1 Solenoid Coil . . . . .
- 1 "v" Belt . . . . .
- 1 Spring and Gasket Kit for Check Valve . . . . .

Instruction Manuals can be ordered with Part Number 085-36-600.

MODEL 900-148-10 MICROVAC PUMP

LOT SCC-79919

TO

SYM	QTY	PART NO	DESCRIPTION
1	1	F-254-593-14	Pump Housing
2	1+	C-254-686-14	Flywheel W/Taper Lock Bushing (A-430-111-1)
3	1	A-406-196-4	Oil Line
3A	1	A-406-196-5	Oil Line
5	1**	085-030-713	Solenoid Valve, 240/480V
5A	1**	085-030-950	Solenoid Valve Coil, 240/480V.
5B	1**	085-030-958	Solenoid Valve Coil, 550V.
6	1	C-254-687-6	End Cap, Dead End
7	2*	085-010-102	"O" Ring, 3 3/8" ID X .139 Thk.
8	2**	085-018-194	Rotary Oil Seal (Viton)
9	2	A-262-172-1	Shaft Seal Ring
10	2+	085-016-212	Bearing Adapter
11	2**	085-005-030	Bearing Adapter Lockwasher
12	2**	085-016-211	Spherical Roller Bearing
13	2	A-265-924-1	Shaft Shoulder Ring
14	1+	D-254-624-7	Side Cover, Dead End
15	1+	C-254-612-5	Eccentric
16	2+	B-254-688-7	Hinge Bar
17	1+	C-254-609-1	Piston & Slide
18	1+	C-254-617-5	Shaft
19	4**	A-264-521-1	Woodruff Key
20	1+	C-254-687-6	End Cap, Drive End
21	1+	D-254-624-8	Side Cover, Drive End
22	1+	C-254-686-13	Pulley W/Taper Lock Bushing A-430-161-1
	6	A-408-300-4	Stand Off
	1	D-411-096-3	Belt Guard Bracket
25	1	A-254-759-3	Motor Stud 3/8"- 16" X 5 3/8" Lg.
26	1	C-286-115-4	Motor Platform
28	2	A-275-235-6	Motor Bracket Pin
29	1	B-415-363-5	Reservoir Cover
30	1**	C-257-663-2	Reservoir Cover Gasket
31	1+	C-254-638-3	Oil Baffle
32	1**	B-257-654-1	Oil Baffle Gasket
33	1	B-263-840-6	Valve Assembly Consists Of:
33A	1	B-403-626-3	Valve Cap
33B	2**	A-274-172-1	Valve Spring
33C	2**	A-276-781-2	Valve Clapper
33D	1+	B-403-636-2	Valve Seat
34	1**	A-243-926-2	Valve Plate Gasket
35	1+	085-036-101	Oil Level Indicator
36	1+	085-033-233	Brass Cock, 1/2" MPT

\*RECOMMENDED SPARE PART  
+PARTS NORMALLY STOCKED

