

VICTROLA™

Jackson 7-in-1 Turntable

Model: VTA-80



Instruction Manual

PLEASE READ THIS INSTRUCTION MANUAL CAREFULLY BEFORE USE
AND KEEP IT FOR FUTURE REFERENCE.

IMPORTANT SAFETY INSTRUCTIONS



The lightning flash with arrowhead within an equilateral triangle is intended to alert the user to the presence of uninsulated "dangerous voltage" within the product's enclosure that may be of sufficient magnitude to constitute a risk of electric shock.

CAUTION

**RISK OF ELECTRIC SHOCK
DO NOT OPEN**

WARNING: TO REDUCE THE RISK OF ELECTRIC SHOCK, DO NOT REMOVE COVER (OR BACK). NO USER-SERVICEABLE PARTS INSIDE. REFER SERVICING TO QUALIFIED SERVICE PROFESSIONAL.



The exclamation point within an equilateral triangle is intended to alert the user to the presence of important operating and maintenance (servicing) instructions in the literature accompanying the appliance.

TO PREVENT FIRE OR SHOCK HAZARD, DO NOT USE THIS PLUG WITH AN EXTENSION CORD, RECEPTACLE OR OTHER OUTLET UNLESS THE BLADES CAN BE FULLY INSERTED. TO PREVENT FIRE OR SHOCK HAZARD, DO NOT EXPOSE THIS APPLIANCE TO RAIN OR MOISTURE.

1. Read these instructions.
2. Keep these instructions.
3. Heed all warnings.
4. Follow all instructions.
5. Do not use this apparatus near water.
6. Clean only with dry cloth.
7. Do not block any ventilation openings. Install in accordance with the manufacturer's instructions.
8. Do not install near any heat sources such as radiators, heat registers, stoves, or other apparatus (including amplifiers) that produce heat.
9. Do not defeat the safety purpose of the polarized or grounding type plug. A polarized plug has two blades with one wider than the other. A grounding type plug has two blades and a third grounding prong. The wide blade or the third prong is provided for your safety. If the provided plug does not fit into your outlet, consult an electrician for replacement of the obsolete outlet.
10. Protect the power cord from being walked on or pinched particularly at plugs, convenience receptacles, and point where they exit from the apparatus.
11. Only use attachments/accessories specified by the manufacturer.
12. Unplug this apparatus during lightning storms or when unused for long periods of time.
13. Refer all servicing to qualified service personnel. Servicing is required when the apparatus has been damaged in any way, such as power-supply cord or plug is damaged, liquid has been spilled or objects have fallen into the apparatus which has been exposed to rain or moisture, does not operate normally, or has been dropped.
14. This appliance shall not be exposed to dripping or splashing water and no object filled with liquids such as vases shall be placed on the apparatus.
15. Do not overload wall outlet. Use only power source as indicated.
16. Use replacement parts as specified by the manufacturer.
17. The product may be mounted to a wall only if recommended by the manufacturer.
18. Upon completion of any service or repairs to this product, ask the service technician to perform safety checks.

- Avoid installing this unit in places exposed to direct sunlight or close to heat radiating appliances such as electric heaters, on top of other stereo equipment that radiates too much heat, places lacking ventilation or dusty areas, places subject to constant vibration and/or humid or moist areas.
- Do not attempt to clean this unit with chemical solvents as this might damage the finish. Use a clean dry cloth.
- Operate controls and switches as described in the manual. Before turning on the power, make certain that power cord is properly installed.
- Store your CD in a cool area to avoid damage from heat.
- When moving the set, be sure to first disconnect the power cord.

CLASS 1 LASER PRODUCT APPAREIL À LASER DE CLASSE 1 PRODUCTO LASER DE CLASE 1	CAUTION INVISIBLE LASER RADIATION WHEN OPEN AND INTERLOCKS DEFEATED. AVOID EXPOSURE TO BEAM	
---------------------------------------------------------------------------------------	------------------------------------------------------------------------------------------------------	-----------------------------------------------------------------------------------

FCC INFORMATION:

This equipment has been tested and found to comply with the limits for a Class B digital device, pursuant to Part 15 of the FCC Rules. These limits are designed to provide reasonable protection against harmful interference in a residential installation. This equipment generates, uses and can radiate radio frequency energy and, if not installed and used in accordance with the instructions, may cause harmful interference to radio communications. However, there is no guarantee that interference will not occur in a particular installation. If this equipment does cause harmful interference to radio or television reception, which can be determined by turning the equipment off and on, the user is encouraged to try to correct the interference by one or more of the following measures:

- Re-orient or relocate the receiving antenna.
- Increase the separation between the equipment and receiver.
- Connect the equipment into an outlet on a circuit different from that to which the receiver is connected.
- Consult the dealer or an experienced radio/TV technician for help.

This device complies with Part 15 of the FCC Rules. Operation is subject to the following two conditions: (1) This device may not cause harmful interference, and (2) This device must accept any interference received, including interference that may cause undesired operation.

IMPORTANT

Since digital circuitry may cause interference to other radio or television tuners nearby, switch this unit off when not in use or move it away from the affected radio/television tuner.

NOTE: This digital apparatus does not exceed the Class B limits for radio noise emissions from digital apparatus as set out in the Radio Interference Regulations of Industry Canada. These limits are designed to provide reasonable protection against harmful interference in a residential installation.

CALIFORNIA PROP 65 STATEMENT



WARNING: This product can expose you to chemicals including lead, which is known to the State of California to cause cancer and birth defects or other reproductive harm. For more information go to www.P65Warnings.ca.gov.

GENERAL OVERVIEW

ASSEMBLY

If you want to place the unit on a shelf, you can leave the short rubber feet (pre-installed) on the unit.
OR

To install the included legs on the unit:

1. Remove the short rubber feet.
2. Take all 4 legs out of the packaging.
3. Loosen the screws under the unit.
4. Insert the wooden leg into the hole and fix it with the screws firmly.
5. Repeat the above for all 4 legs.

POWER SUPPLY

This product is designed to operate on 120V~60Hz AC only. Attempting to operate from any other power source may cause damage to the system, and such damage is not covered by your warranty.
NOTE: If this plug will not fit into your outlet you probably have an outdated non-polarized AC outlet. You should have your outlet changed by a qualified licensed electrician.

REMOTE CONTROL BATTERY INSTALLATION

1. Remote Control requires 1 CR-2025 (3V) Lithium Battery.
2. See the diagram (to the right) for how to open the Remote Control Battery cover.
3. Make sure to insert the battery properly.

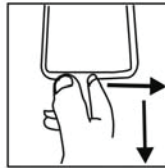

Battery Precautions:

- Be sure to insert the batteries with correct positive "+" and negative "-" orientation. ALWAYS use batteries of the same type. Never mix different types of batteries together.
- When using rechargeable batteries, refer to the precautions on their labels.
- When the remote control unit is not to be used for extended periods of time (more than a month), remove the batteries to prevent them from leaking.
- Do not heat or disassemble batteries, and NEVER dispose of old batteries by throwing them in a fire.
- Do not dispose device into standard garbage disposal sites. Dispose of device at available Battery Recycling Sites after fully discharging battery. Not doing so may violate disposal laws and regulations.
- Please refer to local regulations for proper battery disposal.

BASIC OPERATIONS

See the next page for location of controls on the unit.

Power ON/OFF:

1. Connect the power cord located on the back of unit into a wall outlet.
2. Press POWER/MODE to power on the unit.
3. Press and hold POWER/MODE to turn off the unit.

Adjusting Volume

1. On the unit – Turn the VOLUME KNOB to the left to lower the volume. Turn the VOLUME KNOB to the right to raise the volume.
2. On the Remote Control – Press the VOLUME UP or VOLUME DOWN buttons.
3. Press MUTE to mute the sound, and press again to un-mute.

EQ Settings

During playback, press the EQ SETTINGS button to switch between POP/CLASSIC/ROCK/JAZZ/FLAT.

OPERATIONS AND CONTROLS

FRONT VIEW

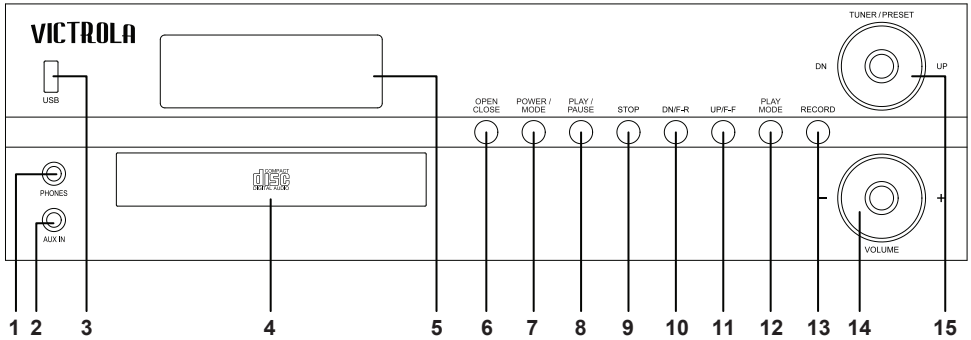

- | | | | |
|---|-----------------------------|----|--------------------------------------|
| 1 | HEADPHONE JACK | 10 | DN/F-R BUTTON
(BACK/REWIND) |
| 2 | AUX-IN JACK | 11 | UP/F-F BUTTON
(NEXT/FAST FORWARD) |
| 3 | USB PORT | 12 | PLAY MODE BUTTON
(PLAYBACK MODES) |
| 4 | CD DOOR | 13 | RECORD BUTTON |
| 5 | LCD DISPLAY | 14 | VOLUME KNOB |
| 6 | OPEN/CLOSE BUTTON (CD DOOR) | 15 | TUNER/PRESET KNOB |
| 7 | POWER/MODE BUTTON | | |
| 8 | PLAY/PAUSE BUTTON | | |
| 9 | STOP BUTTON | | |

REAR VIEW

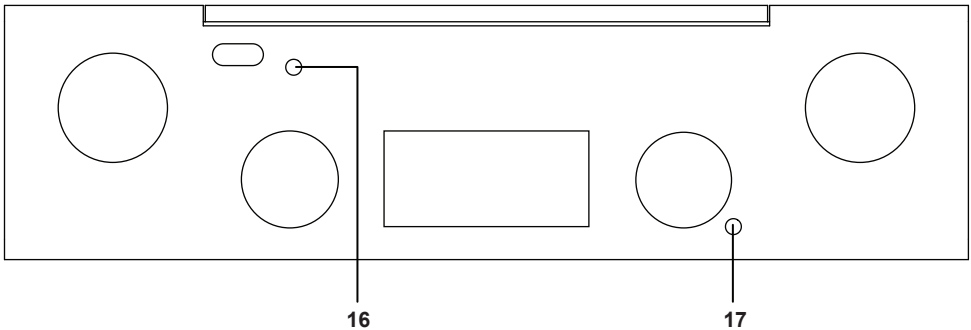

- | | | | |
|----|----------------|----|------------|
| 16 | ANTENNA SOCKET | 17 | POWER CORD |
|----|----------------|----|------------|

REMOTE CONTROL

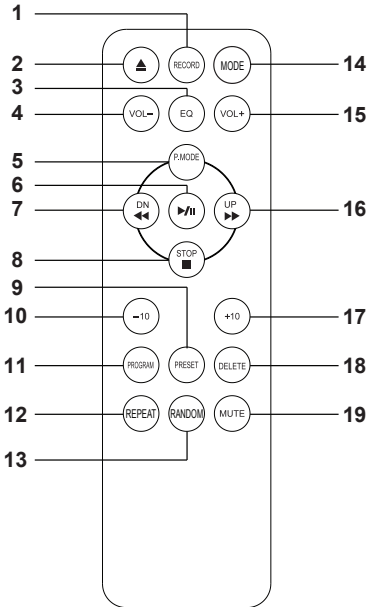

- 1 RECORD
- 2 OPEN/CLOSE (CD DOOR)
- 3 EQ SETTINGS
- 4 VOLUME DOWN
- 5 PLAY MODE (PLAYBACK MODES)
- 6 PLAY/PAUSE
- 7 DN/F-R BUTTON (BACK/REWIND)
- 8 STOP
- 9 PRESET
- 10 -10 TRACKS
- 11 PROGRAM
- 12 REPEAT PLAYBACK
- 13 RANDOM PLAYBACK (SHUFFLE)
- 14 MODE
- 15 VOLUME UP
- 16 UP/F-F BUTTON (NEXT/FAST FORWARD)
- 17 +10 TRACKS
- 18 DELETE (USB)
- 19 MUTE

TURNTABLE LAYOUT

OVERHEAD TURNTABLE VIEW

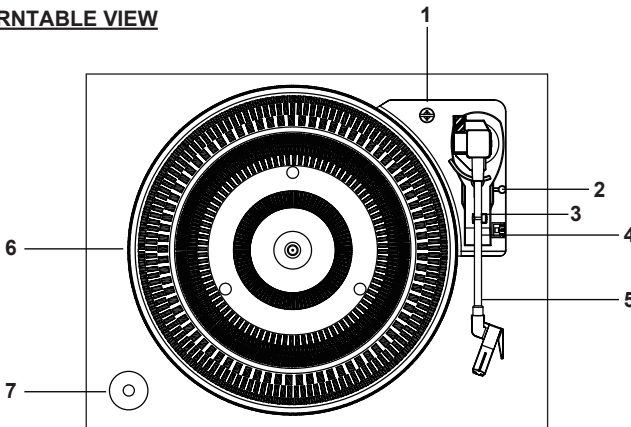

- 1 TRANSIT SCREW
- 2 LIFT LEVER
- 3 TONE ARM CLIP/REST
- 4 SPEED SELECTION SWITCH
- 5 TONE ARM
- 6 TURNTABLE PLATTER
- 7 45 RPM ADAPTOR

TURNTABLE OPERATION

Before use, be sure to remove the white stylus guard off of the needle. Always make sure that the tone arm is unlocked and free to move across the record while operating. Lock the tone arm in place again when it is not in use. **IMPORTANT: To prevent damages during transportation, a transit screw is located at the upper right side of the turntable platter. Before use, turn the transit screw in a clockwise direction with a screwdriver. Remember to re-tighten the transit screw if moving the unit.*

1. Press the POWER/MODE button to select "PHON" (Phono) mode.
2. Place a record on the TURNTABLE PLATTER and select the desired speed (33 1/3 / 45 / 78) by sliding the SPEED SELECTION SWITCH to the speed according to the type of record.
NOTE: When playing a 45 RPM record, use the included 45 RPM adaptor.
3. Open the TONE ARM CLIP to release the TONE ARM. Push the LIFT LEVER backwards to raise the arm. Gently move the tone arm to the desired position over the record. The turntable will begin to spin only when the tone arm is moved toward the record. To begin playing, push the lift lever forward to lower the arm slowly onto the desired position of the record.
4. Once the record is finished, the TONE ARM will automatically return to the TONE ARM REST and the record will automatically stop turning.

NOTE: If the AUTO RETURN / AUTO STOP function is not working properly, see the following: Peel off service sticker on the back of the unit, make sure to store it in a safe place in order to re-apply when finished.

- If the TONE ARM is not reaching the end of the record properly, causing the auto-return to malfunction and auto-returns before the TONE ARM reaches the end of the record – Use a screwdriver to turn the screw clockwise in 45 degree increments until the issue is resolved.
- At the end of the record, if the TONE ARM does not auto-return and the record is still spinning – Use a screwdriver to turn the screw counter clockwise in 45 degree increments until the issue is resolved.

HOW TO REPLACE THE TURNTABLE NEEDLE (Replacement Needle # ITNP-C1)

Removing the Stylus from the Cartridge

1. Set a screwdriver at the tip of the stylus and push down to the direction "A".
WARNING: When applying force to stylus, too much may damage or break the stylus.
2. Pull the stylus out toward the direction "B".

Installing the Stylus

1. Hold the tip of the stylus and insert the other edge by pressing toward direction "C".
2. Push the stylus up toward direction "D" until it locks at the tip.

Caution:

- Do not remove or bend the stylus needle.
- Do not touch the needle to avoid injury to your hand.
- Turn off the unit's power before you replace the stylus.
- Keep out of reach of children

Please note: The stylus should last about 50 hours under normal use. It is recommended that the stylus be replaced as soon as you notice a change in sound quality.

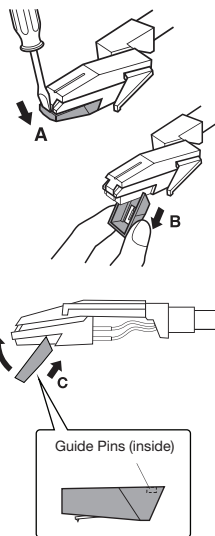

FM RADIO OPERATION

NOTE: Insert the FM ANTENNA into the FM ANTENNA SOCKET (on the back of the unit) and fully extend for best reception.

Press the POWER/MODE button to select "FM" mode.

TUNING

- Use the TUNER/PRESET KNOB (on the unit) OR the UP/F-F or DN/F-R buttons (on the unit or remote) to manually adjust the Radio to the desired station.
- Press the PLAY/PAUSE button (on the unit or remote) OR press and hold the UP/F-F or DN/F-R buttons (on the unit or remote) to automatically scan the FM stations in reception. When complete, "Stereo" will show on the LCD DISPLAY.

PRESET STATIONS

1. Select the desired station then press and hold the PRESET button (on the remote).
2. "MEMORY P01" will show on the LCD DISPLAY, then press the TUNER/PRESET KNOB to store the station.
3. Repeat steps 1 and 2 above until the preset stations are full (total of 10 stations).
4. To play the preset stations, press the UP/F-F or DN/F-R buttons (on the unit or remote) or the PRESET button (on the remote).

CD OPERATION

1. Press the POWER/MODE button to select "CD" mode.
2. Open the CD DOOR by pressing the OPEN/CLOSE button (on the unit or remote).
3. Place a CD with the printed side facing up. Then close the CD DOOR by pressing the OPEN/CLOSE button (on the unit or remote) again.
4. After a few seconds, playback will begin automatically.

CONTROLS

- During playback, use the PLAY/PAUSE button (on the unit or remote) to play or pause playback.
- Press the UP/F-F button (on the unit or remote) once to skip a track.
- Press the DN/F-R button (on the unit or remote) once to restart a track from the beginning.
- Double press the DN/F-R (on the unit or remote).
- Press and hold the UP/F-F or DN/F-R buttons (on the unit or remote) to fast forward or rewind.
- Press the -10 or 10+ buttons (on the remote) to go back 10 tracks or skip 10 tracks.

PROGRAMMED PLAYBACK

NOTE: Up to 20 tracks on a CD and 99 tracks on an MP3 can be programmed.

Make sure the CD is stopped before setting the programming.

1. While in CD Mode, make sure to stop playback.
2. Press the TUNER/PRESET KNOB (on the unit) or press PROGRAM (on the remote). "MEMORY P01" will show on the LCD DISPLAY.
3. Select the desired track by using the UP/F-F and DN/F-R buttons (on the unit or remote). Then press the TUNER/PRESET KNOB (on the unit) or PROGRAM (on the remote) to store the selected track. Repeat this step until the memory is full (20 total tracks on a CD and 99 total tracks on an MP3).
4. After all desired track have been programmed, press the PLAY/PAUSE button (on the unit or remote) to play the CD in the programmed order.
5. To cancel programmed playback press the STOP button.

BLUETOOTH OPERATION

1. Press the POWER/MODE button to switch to "BLUE" (Bluetooth) mode.
2. The LCD DISPLAY will flash "BLUE" indicating the unit is in pairing mode.
3. Make sure your external device has the Bluetooth turned on. Then open the Bluetooth settings menu on your device and select "**VTA-80**".
4. The "BLUE" on the LCD DISPLAY will stop flashing and an audible tone will sound indicating the connection was successful.
5. Use playback buttons on the unit/remote as usual or control playback directly from your external device.
6. To disconnect the external device, press and hold the STOP button.

AUX-IN OPERATION

1. Press the POWER/MODE button to switch to "AUX" (AUX-IN) mode.
2. Connect one end of a 3.5mm cable (not included) into the AUX-IN JACK on the front of the unit and the other end into the 3.5mm AUX-IN jack on your external device.
3. Use your external device to control playback.

HEADPHONE OPERATION

Plug the headphones (not included) into the Headphone Jack on the front of the unit to listen. The built-in speaker will stop playing once the headphones are plugged in.

USB OPERATION

1. Press the POWER/MODE button to select "USB" mode.
2. Insert the USB memory stick (not included) into the USB PORT.
3. After a few seconds, the LCD DISPLAY will show the total number of tracks on the USB memory stick and then playback will begin automatically from the first track.
4. Repeat the same playback operations as CD OPERATION.

NOTES:

- This function can detect and read ONLY MP3 and WMA file formats through the USB PORT.
- Some MP3 players may not be able to play via the USB PORT due to variances in the MP3 encoding formats, this is not a malfunction of the unit.
- Connecting the USB memory stick upside down or backwards could cause damage to the unit. Make sure the direction is correct when inserting the USB memory stick to the USB PORT.

USB RECORDING OPERATION

RECORDING FROM CD

1. Insert the USB memory stick into the USB PORT.
2. While playing a CD, press the RECORD button one time.
3. REC-ONE (Manually record)
"REC-ONE" will appear on the LCD DISPLAY.
REC-ALL (Record entire CD)
Press the UP/F-F button once, "REC-ALL" will appear on the LCD DISPLAY.
4. Press the RECORD button again to confirm, "REC" will flash on the LCD DISPLAY and the recording will begin after about 5 seconds.
5. Press the STOP button to stop recording.

RECORDING FROM CD-MP3

1. Insert the USB memory stick into the USB PORT.
2. While playing a CD-MP3, press the RECORD button one time.
3. REC-ONE (Manually record)
"REC-ONE" will appear on the LCD DISPLAY.
REC-FOLD (Record entire folder)
Press the UP/F-F button once, "REC-FOLD" will appear on the LCD DISPLAY.
REC-ALL (Record entire MP3)
Press the UP/F-F button twice, "REC-ALL" will appear on the LCD DISPLAY.
4. Press the RECORD button again to confirm, "REC" will flash on the LCD DISPLAY and the recording will begin after about 5 seconds.
5. Press the STOP button to stop recording.

RECORDING FROM PHONO/BLUETOOTH/AUX-IN

1. Insert the USB memory stick into the USB PORT.
2. While playing in PHONO/BLUETOOTH/AUX-IN mode, press the RECORD button one time. "USB" will appear on the LCD DISPLAY.
3. Wait about 5 seconds and "USB" and "REC" will flash on the LCD DISPLAY, and the recording will begin.
4. Press the STOP button to stop recording, and "END" will appear on the LCD DISPLAY.

DELETE USB

• DELETE CURRENT TRACK

During USB mode, press the DELETE (on the remote) button once.

"DEL-ONE" will show on the display. Then press the DELETE button again to confirm.

• DELETE CURRENT FOLDER

During USB mode, press the DELETE (on the remote) button once. Then press the UP/F-F button once. "DEL-FOLD" will show on the display. Then press the DELETE button again to confirm.

• DELETE ALL

During USB mode, press the DELETE (on the remote) button once. Then press the UP/F-F button twice. "DEL-ALL" will show on the display. Then press the DELETE button again to confirm.

SPECIFICATIONS

GENERAL

Power Requirements:.....	20W*2ch
Power Consumption:.....	65W
Dimensions:.....	28.35" (720mm) x 14.25" (362mm) x 31.1" (790mm)

AMPLIFIER

Output Power:.....	20W*2ch
Frequency Response:.....	20Hz-20khz

SPEAKER SYSTEM

Type:.....	5.9 inch
Impedence:.....	4Ω
Input Power:.....	30W

FM RADIO

Range:.....	88MHz-108MHz
-------------	--------------

CD PLAYER

Frequency Response:.....	100Hz-10kHz
Signal-to-Noise Ratio:.....	60dB

RECORD PLAYER

Motor:.....	9V-12V
Drive System:.....	DC
Speeds:.....	33, 45, 78 RPM
Signal-to-Noise Ratio:.....	35dB
Cartridge Type:.....	Ceramic
Replacement Needle:.....	ITNP-C1

BLUETOOTH

Bluetooth Version:.....	3.0
Bluetooth Frequency Range:.....	2.4GHz-2.48GHz
Operating Distance:.....	10m (33ft)

USB

Type:.....	USB-A
Recording:.....	MP3
Full-Speed:.....	3.0

Included:.....	Instruction Manual, 4 Legs, Remote Control, 45 RPM Adaptor, FM Antenna
----------------	------------------------------------------------------------------------------

Design and specification are subject to change without notice.

Bluetooth is a registered trademark of Bluetooth SIG, Inc.
Other trademarks and trade names are those of their respective owners.

Made in China.

WARRANTY

Victrola is a registered trademark of Innovative Technology Electronics LLC.

Innovative Technology Electronics LLC.

Limited Warranty: 90 Days Labor, One Year Parts

Innovative Technology Electronics LLC. (IT) warrants the product to be free from "Defects" in materials under normal use for a period of "One Year" from the date of the original purchase. The Warranty is "Not" transferable. IT agrees, within the initial "90 Day" period, to repair or replace the product if it is determined to be defective at "No Charge". It is further agreed that IT will cover the cost to repair or replace damaged "Parts" only for a total period of "One Year" from the date of the original purchase. The warranty does not cover cosmetic damage, antennas, AC cords, cabinets, headbands, ear-pads, or damage due to line power surges, connection to improper voltage supply or settings, misuse, mishandling, accident, acts of God or attempted repair by an unauthorized service agent.

To obtain service, the purchaser MUST present an original sales receipt / proof of purchase. Please contact us at www.victrola.com to request an RMA (Return Material Authorization) number to return products for service or replacement. Returns without an RMA number on the package will be refused and returned to sender. Upon receipt of the returning item and our full inspection (IT) may issue a replacement to customer for the same item or of one that has equivalent value and features. To return an item, supply full name, return address, phone number, item purchased, receipt of purchase and reason for return to obtain RMA number.

All returns must be in the original packaging or reasonable substitute to prevent damage. Customer "Must" include full name, shipping address and telephone number inside of package. No return will be shipped back to a PO Box or APO address.

Please include your check or money order in the amount of:

- **USD \$5.00 for items \$10.00 to \$39.99. (Price Paid Per Unit)**
- **USD \$10.00 for items \$40.00 to \$99.99. (Price Paid Per Unit)**
- **USD \$16.00 for items \$100.00 and up. (Price Paid Per Unit)**
- **Shipping fees are non-refundable.**

to be payable to Innovative Technology Electronics LLC. (for handling and return shipping charges) (IT) will not be responsible for delays or unprocessed claims resulting from a purchaser's failure to provide any / all of the necessary information. Send all inquiries or RMA request via our website **www.victrola.com/pages/technical-support**.

Innovative Technology Electronics LLC.

1 Channel Drive

Port Washington, NY 11050

Toll free: 1-877-483-2497

Website for support: www.victrola.com/pages/technical-support

There are no express warranties except as listed above.

REPAIR OR REPLACEMENT AS PROVIDED UNDER THIS WARRANTY IS THE EXCLUSIVE REMEDY OF THE CUSTOMER, (IT) SHALL NOT BE LIABLE FOR ANY INCIDENTAL OR CONSEQUENTIAL DAMAGES FOR BREACH OF ANY EXPRESS OR IMPLIED WARRANTY ON THIS PRODUCT EXCEPT TO THE EXTENT PROHIBITED BY APPLICABLE LAW. ANY IMPLIED WARRANTY OF MERCHANTABILITY OR FITNESS FOR A PARTICULAR PURPOSE ON THIS PRODUCT IS LIMITED IN DURATION TO THE DURATION OF THIS WARRANTY.

Some states do not allow the exclusion or limitation of incidental or consequential damages, or limitations on how long an implied warranty lasts, so the above exclusions or limitations may not apply to you. This warranty gives you specific legal rights and you may also have other rights, which vary from state to state.