



# GameSir T2a Wireless Controller

USER MANUAL

### Package Content:

- Controller x 1
- USB Cable x 1
- User Manual x 1

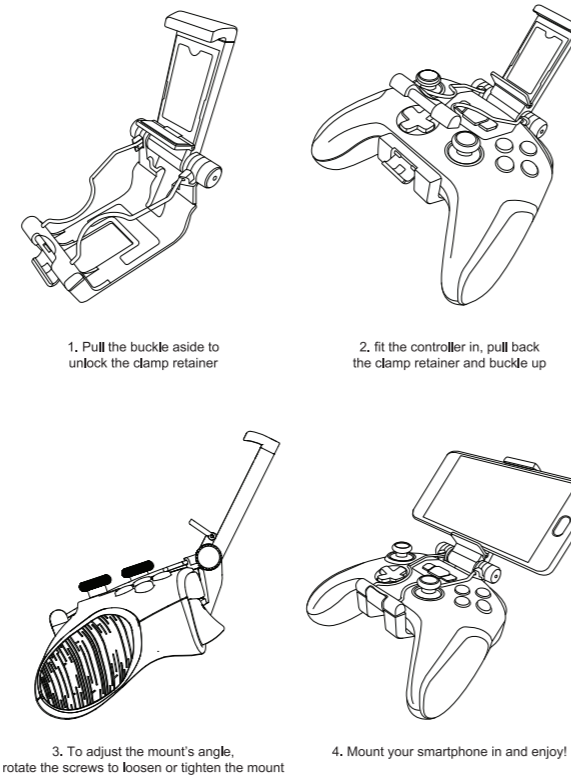
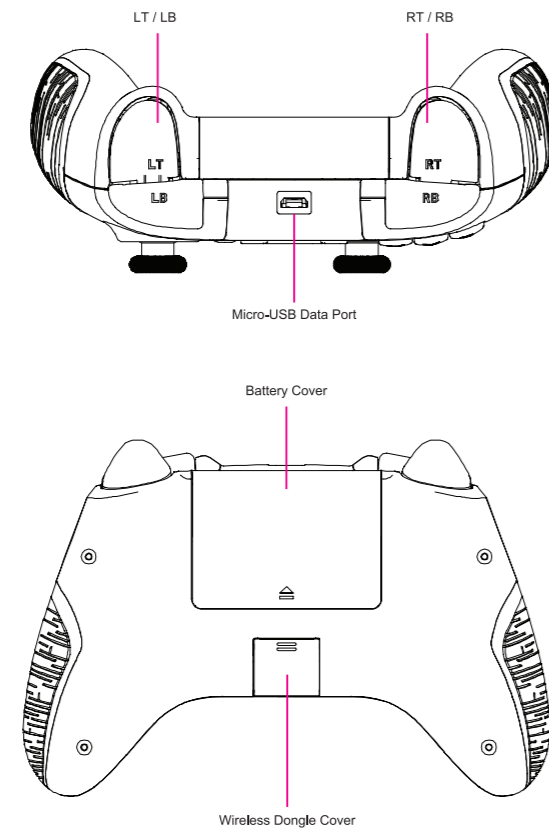
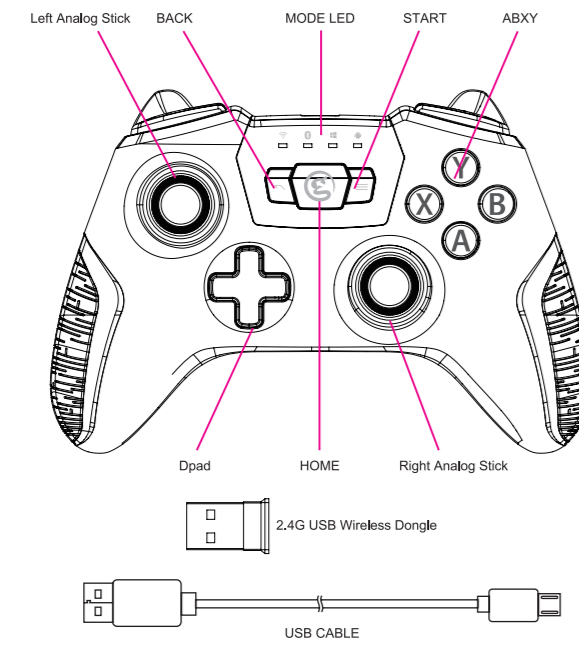

### Product Feature:

- Bluetooth & 2.4G wireless connection for PC or Android™ device
- Wired & wireless dual mode with super low latency
- Support with Xinput, Dinput modes
- Compatible with PC Windows™ 7 / Vista / 8 / 10
- Compatible with Android™ 4.0 +
- Compatible with Steam™ OS
- Compatible with Xbox One™ streaming to Windows™ 10
- Smart Firmware upgrade
- Vibration feedback & enhanced trigger button for precise control
- Accurate analog sticks, large responsive D-pad
- Comfort grip for longer play time
- Includes 1m(3.28ft) long USB data Cable

### 2.4 G Wireless Instruction:

1. Remove the battery cover at the back of the controller, follow the battery contact indication to install rechargeable batteries
2. Store battery cover for future use with AA batteries if required

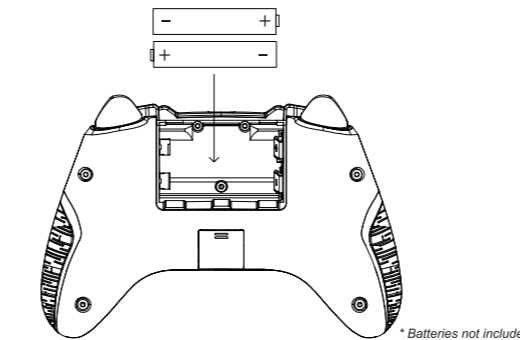

3. Take out the USB Wireless Dongle under the Dongle dock at the back of the controller
4. Insert the USB wireless dongle into the USB port of the device you would like to use (PC, Phone, Tablet, Smart box, Smart TV)

\* If the device does not include the standard USB port, please insert the USB dongle into the OTG cable, then insert the Micro-USB head of the OTG cable into the device Micro-USB port



5. Press the HOME button, the controller will start search (the wireless LED will start to flash for up to 6 seconds then auto connect to the 2.4g wireless dongle, the LED will remain on when successfully connected to the USB dongle

6. The controller will enter sleep mode when not in use after 5 mins. Single Press HOME button to restart.

### Bluetooth Pairing Instruction:

1. Remove the battery cover at the back of the controller, follow the battery contact indication to install rechargeable batteries
2. Store battery cover for future use with AA batteries if required
3. Remove USB Wireless Dongle from the PC or Android Device
4. Make sure your device has Bluetooth connection switched ON. Press & hold the HOME button for 3 seconds, the controller will begin search (the Bluetooth LED will start flashing rapidly whilst in the Bluetooth pairing mode). Once lights are stationary follow instructions from your PC/Android device. side, The LED lights will remain on when connected to PC/Android devices. You may need to allow pairing on your device check settings.

### Bluetooth Connection Instruction:

1. Make sure your USB Wireless Dongle is not plugged in to your PC or Android Device
2. Single press the HOME button, the controller will start search 2.4G dongle for 6 seconds. After that it will start to connect to previous paired device, the Bluetooth LED will start to flash intermittently, the LED will become stationary when connected to PC/Android device

\*BLUETOOTH connection only supports DINPUT mode, it does not support XINPUT mode.

### Wired Instruction:

1. Connect the Micro-USB head of 3 meter USB cable into the Micro-USB port at the top part of controller
2. Insert the USB head of USB cable into the USB port of device which you would like to use (PC, Phone, Tablet, Smart box, Smart TV)

\* If device does not include the standard USB port, please insert the USB head of USB cable into the OTG cable, then insert the Micro-USB head of the OTG cable into the device Micro-USB port

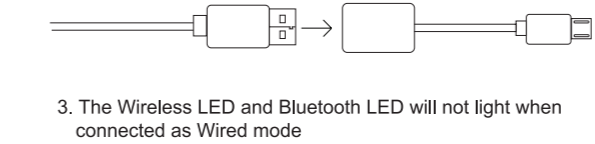

### LED Indication:

Controller includes FOUR LED icons

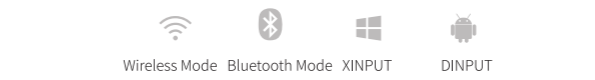

Wireless Mode	The controller is in 2.4G Wireless connection Mode
Bluetooth Mode	The controller is in Bluetooth Wireless connection Mode
XINPUT	Controller work as Xinput, support PC 360 Games, Steam™ OS, Xbox One™ Streaming to Windows™ 10 and part Android Games
DINPUT	Controller work as Dinput, support Most Android Games and some part PC Games

### Device Mode Selection:

Controller Support with Xinput, Dinput Modes, use HOME button to switch between two modes

1. XINPUT: support PC 360 Games, Steam™ OS, Xbox One™ Streaming to Windows™ 10 and several Android Games

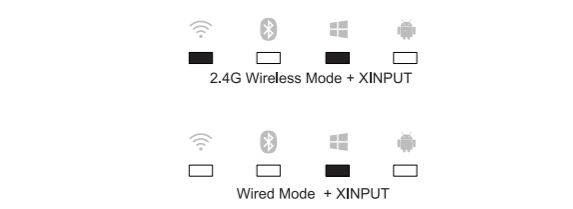

2. Press & hold the HOME button for 2 sec, the controller will switch to DINPUT mode from XINPUT mode: support Most Android Games and several PC Games

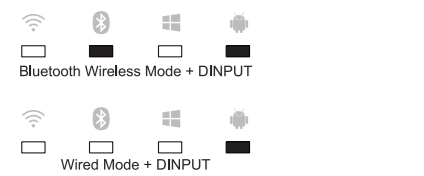

\* BLUETOOTH connection only support DINPUT mode, does not support with XINPUT mode.

3. Press & hold the HOME button for 2 sec, the controller will switch to XINPUT mode from DINPUT mode

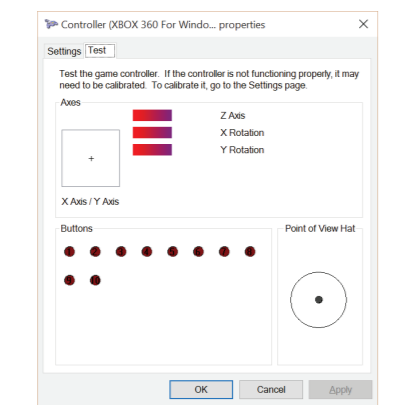
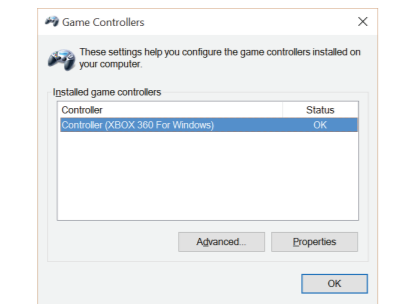

4. Start Games (please switch to DINPUT mode if the game does not support XINPUT mode)

### PC (Windows™ XP) Instruction:

1. Download and install the controller driver  
Download URL:  
<https://www.microsoft.com/hardware/en-us/d/xbox-360-controller-for-windows>
2. WIRED: Insert the USB head of USB cable into the USB port of PC; default mode is XINPUT, the LED will remain ON when successfully connected
3. 2.4G WIRELESS: Insert the USB dongle into the USB port of PC, default mode is XINPUT, the LED will remain ON when successfully connected
4. Enter the "Game Controllers" of Control Panel to test each button
5. Start Games (please switch to DINPUT mode if the game does not support the XINPUT mode)

### Xbox One™ Streaming Games to Windows™ 10:

1. Upgrade the Xbox One™ to the latest firmware: entering Settings > Preferences, and enable the "Allow game streaming to other devices"

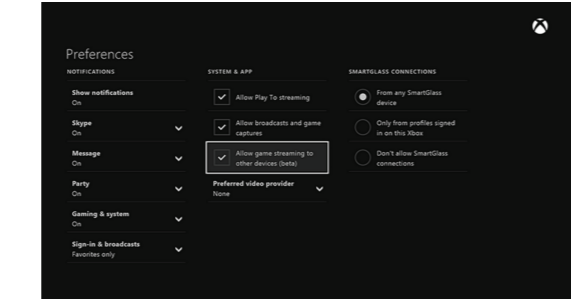

2. Upgrade Windows™ 10 to the latest version
3. Start the XBOX APP in Windows 10, login using same account details as your Xbox One console
4. Click the "Connected" from the left menu

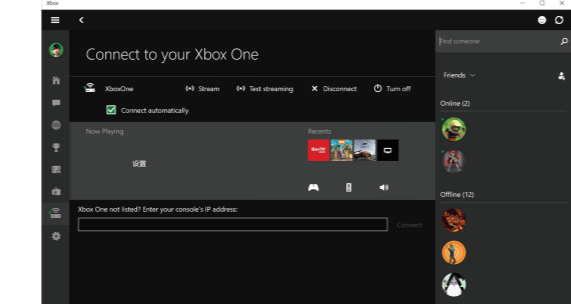

5. WIRED: Insert the USB head of USB cable into the USB port of PC, switch XINPUT mode, the LED will remain ON when successfully connected



6. 2.4G WIRELESS: Insert the USB dongle into the USB port of PC, switch XINPUT mode, the LED will remain ON when successfully connected



7. Enter to the "Game Controllers" of Control Panel to test each button

8. Click Test streaming to test the network speed

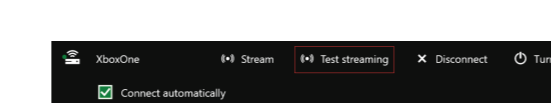

9. Click Stream to start steaming Xbox One™ games

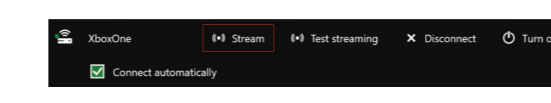

### Android™ 4.0+ Instruction:

1. WIRED: Insert the USB head of USB cable into the USB port of Android device (Phone, Tablet, Smart box, Smart TV), switch to the DINPUT (Android game) mode, the LED remains ON when successfully connected
2. 2.4G WIRELESS: Insert the USB dongle into the USB port of Android device (Phone, Tablet, Smart box, Smart TV), switch the DINPUT (Android game) mode, the LED remains ON when successfully connected
3. BLUETOOTH WIRELESS: Remove the USB dongle from Android device (Phone, Tablet, Smart box, Smart TV), refer the connection instruction, the only default mode is DINPUT, the Bluetooth LED remains ON when successfully connected

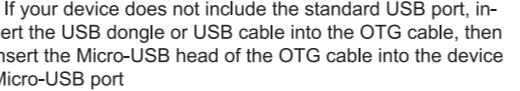

\* If your device does not include the standard USB port, insert the USB dongle or USB cable into the OTG cable, then insert the Micro-USB head of the OTG cable into the device Micro-USB port

4. Start Games (please switch to XINPUT mode if the game is not supported by the DINPUT mode)

### Low Battery:

When the battery is low in Wireless mode, the XINPUT and DINPUT LED will start flashing, please replace with two AA batteries or rechargeable battery

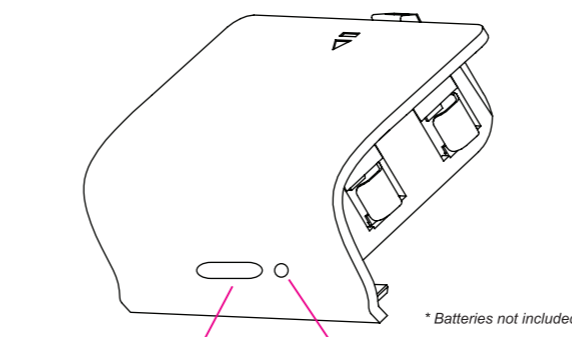

### Wireless signal:

If you have no wireless connection, the LED lights for XINPUT and DINPUT will start flashing together, please check:

1. If USB dongle has been removed from the console
2. If the controller is out of the wireless range
3. If any other wireless source too close to the controller

\* Some Android Boxes can influence the optimization of the Wifi / Bluetooth signal, this may interfere with the controller. Please use the USB extension cable to connect the USB dongle or use the USB cable and use in Wired mode.



Windows™, Xbox 360™ and Xbox One™ are registered trademark or trademarks of Microsoft Inc. Android™ is a registered trademark or trademarks of Google Inc. Steam™ is a registered trademark or trademarks of Valve Inc. All Rights reserved; All other trademarks are property of their respective owners. Photos and illustrations not binding. Contents, designs and specifications are subject to change without notice and may vary from one country to another. This product is not distributed under official license from or approved, sponsored or endorsed by Microsoft Inc, Google Inc, or Valve Inc. This product is not manufactured for Microsoft Inc, Google Inc, or Valve Inc.



We hope this manual answered any questions you may have had. If you have any further questions, please contact us:  
GameSir Facebook: <https://www.facebook.com/mygamesir>  
Twitter: <https://twitter.com/mygamesir>  
Customer Service: [cs@gamesir.hk](mailto:cs@gamesir.hk)