

HID-Basic Semi-Parallel ballasts for MHN/CDM lamps

BMH 70L 302I TS

The HID Basic Semi-Parallel ballast is an impregnated (HID standard) electromagnetic copper/iron ballast for use with an external ignitor for metal-halide and CDM lamps.

Product data

General Information	
Application Code	L302 ITS
Operating and Electrical	
Input Voltage	230 V
Input Frequency	50 Hz
Power Factor 100% Load (Min)	0.85
Mains Voltage Performance (AC)	-8%~+6%
Mains Voltage Safety (AC)	-10%~+10%
Input Current with PF Correction	0.45 A
Input Current without PF Correction	0.98 A
Power Factor without PF Compensation (Nom)	0.35
Power Losses (Nom)	12.8 W
Wiring	
Connector Type	Screw
System characteristics	
Rated Ballast-Lamp Power	70 W

Temperature	
T-Winding (Max)	130 °C
Delta-T Normal Conditions	70 °C
Approval and Application	
Approval Marks	CE marking CCC certificate
Product Data	
Full product code	871016303140830
Order product name	BMH 70L 302I TS
EAN/UPC - Product	8710163148434
Order code	913710103250
Numerator - Quantity Per Pack	1
Numerator - Packs per outer box	6
Material Nr. (12NC)	913710103250
Net Weight (Piece)	1.100 kg

HID-Basic Semi-Parallel ballasts for MHN/CDM lamps

Dimensional drawing

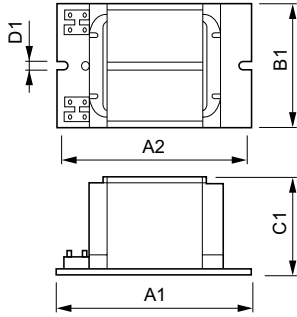

Product	D1	C1	A1	A2	B1
BMH 70L 302I TS	6.2 mm	51.5 mm	117.0 mm	102.0 mm	57.1 mm

BMH 70 L302 ITS

