

XH-MB(L) Medium-intensity Type B Aviation Obstruction Light(Solar Powered)

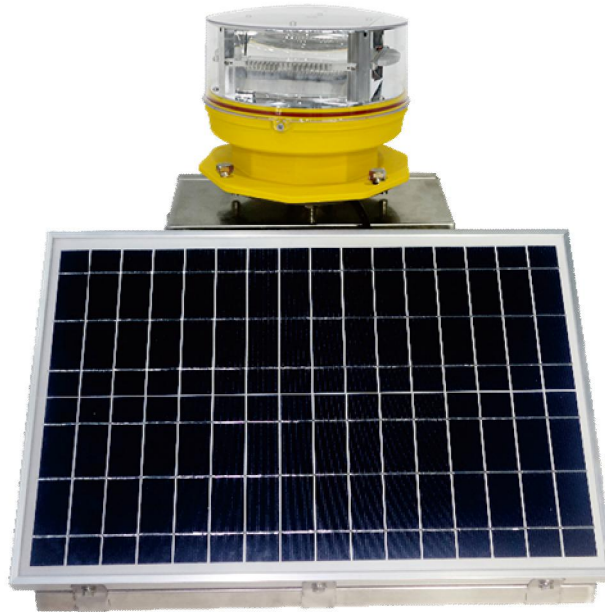

Application

XH-MB(L) Medium-intensity Type B Aviation Obstruction Light(Solar Powered) can be provided with power supply without power transmission cables by solar power, so it is suitable for those locations, Electric Tower, High-rise Building, High Chimney, marking towers (Telecom, GSM, Microwave & TV), High Pole, Tower Crane, Wind Turbine, etc especially which are hard to lay the cable or lack of power supply as well as those facilities which have high requirements on lightning protection.

Advantage

1. International advanced solar panel reaching at least 10 years service life.
2. Comprehensive protection in voltage short, over-voltage, floating Charge and temperature.
3. Low power consumption profession flash switch.
4. International-advanced cold LED with low power consumption, high brightness and service life of light source reaching 100000hours.
5. Strong impact lamp shape with PC material.
6. Strong corrosion resistance and UV protection.
7. 7 days autonomy in raining day(Option 15days).
8. Having lightning-protection function.
9. Side open of battery box can be open for maintenance convenience very easily.
10. Built-in photocell: photocell can let light work at night or low visibility daytime.

Main Parameter

Name	Main Parameter
Mode	XH-MB(L)
Standard	ICAO (Aerodromes Annex 14) Medium-intensity Type B, FAA L-864
Battery	1.Capacity: -12V,33Ah(Lead Acid Battery) -Kind:Lead Acid Battery
Solar Panel(Solar Module)	1.Capacity:16.5V,28W

 <p>Lamp on Top of Solar Light</p>	2.Type:Mono Crystalline
	1.Operating voltage:DC12V
	2.Light intensity: 2,000cd
	3.Flashing rate:20-60times/minute
	4.Light Source:LED.
	5.LED Quantity:36Pcs big power LED.
	6.Emitting Color:Red
	7.Cover:PC Base:Aluminum Alloy
Battery Case	Material:SS 304stainless Steel
Overall Size(mm)	525 by 482 by 455
Installation Size(mm)	200 by 322 by 13
Total Weight	18.5Kg(±1Kg)
Autonomy in raining day	7days(Option 15days based on customer request)
Ambient Temperature	-40℃~+70℃
Wind load	80m/s
Protection Standard	IP65

Dimension Drawing

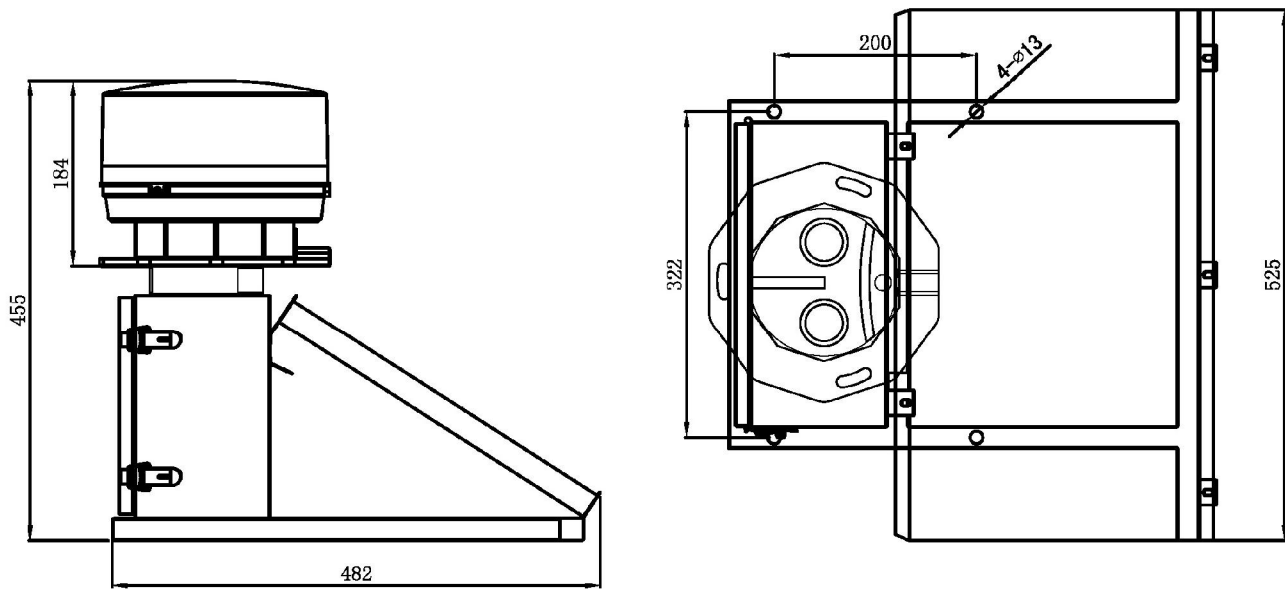

Unit:mm