

## Standard Ballasts for HS and HI Lamps 35 to 70 W

Shape: 53x66 mm

For high pressure sodium lamps (HS),  
metal halide lamps (HI) and  
ceramic discharge lamps (C-HI)  
Vacuum-impregnated with polyester resin  
Screw terminals: 0.5–2.5 mm<sup>2</sup>  
Protection class I  
tw 130  
Ballasts for pulse ignition system on request

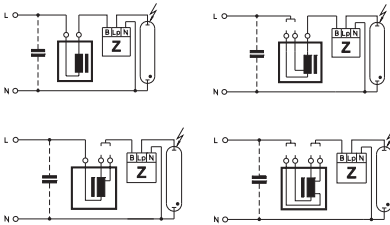
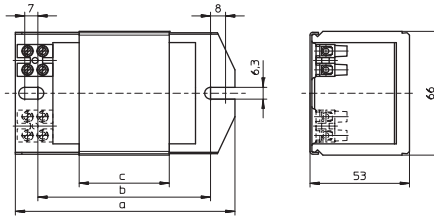
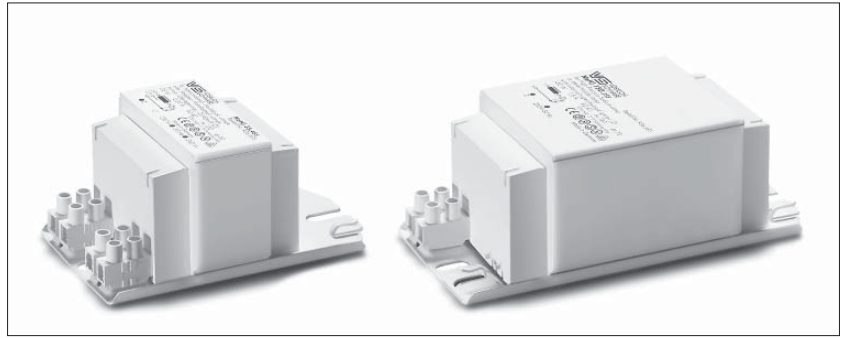

Lamp			Ballast										Capacitor	
Output W	Type	Current A	Type	Ref. No.	Voltage AC V, Hz	a mm	b mm	c mm	Weight kg	Δt K	Power factor λ	Energy efficiency	C <sub>p</sub> μF	I <sub>N</sub> A
35	HS, HI	0.53	NaHJ 35.485*	<b>526517</b>	220/230, 50	108	86	36	1.07	60	0.40	EEI=A3	6	0.22/0.21
			NaHJ 35.485*	<b>161367</b>	230/240, 50	108	86	36	1.07	60	0.40	EEI=A3	6	0.22/0.21
			NaHJ 35.638	<b>161371</b>	220, 60	108	86	36	1.07	50	0.41	EEI=A3	5	0.23
50	HS, HI	0.76	NaH 50.486*	<b>161379</b>	230/240, 50	108	86	36	1.07	65	0.37	EEI=A3	8	0.30/0.29
			NaH 50.654	<b>161399</b>	220, 60	108	86	36	1.07	60	0.36	EEI=A3	8	0.31
50	HS, HI	0.76	NaHJ 70/50.157*	<b>160613</b>	230, 50	108	86	42	1.23	55	0.37	EEI=A3	8	0.30
70	HS, HI	0.98									70	0.37	EEI=A3	12
70	HS, HI	0.98	NaHJ 70.300	<b>174961</b>	220, 50	108	86	36	1.07	75	0.40	EEI=A3	12	0.40
			NaHJ 70.128*	<b>533568</b>	230, 50	108	86	36	1.07	70	0.36	EEI=A3	12	0.38
			NaHJ 70.128*	<b>539434</b>	230/240, 50	108	86	36	1.07	70/75	0.36	EEI=A3	12	0.38/0.37
			NaHJ 70.158	<b>161662</b>	240, 50	108	86	42	1.23	70	0.36	EEI=A3	12	0.37
			NaHJ 70.128	<b>538407</b>	240, 50	108	86	36	1.07	75	0.37	EEI=A3	12	0.37
			NaHJ 70.653	<b>161392</b>	220, 60	108	86	36	1.07	60	0.42	EEI=A3	10	0.40

\* Ballasts without CE marking for replacements or markets outside of the EU