XH-LB(L) Low-intensity Type B Aviation Obstruction Light



Application

Obstruction light used in Tower Crane, Wind Turbine, High Mast, Metallurgies, Towers(Telecom, GSM, Electric), Smokestacks, High-rise Buildings and any other potentially hazardous obstructions within 45 meters to air traffic with a steady burning red safety light.

10.Advantages

- 1.PC material with good impact protection strength, thermal stability, high transmittance.
- 2.Bird spike against bird drop.
- 3.International-advanced cold LED with low power consumption, high brightness and service life of light source reaching 100,000hours.
- 4.LED based on obstruction light last 15 times longer than traditional light source, incandescent light.
- 5.About 96% less power than 116W incandescent light.
- 6.Major maintenance cost saving, Surge protection device inside light.



7.Strong corrosion resistance, Shock and Vibrations protection and UV protection.

8.Dawn to Dusk operating: Built-in photocell can let light work automatically at night, closed during the day.

Main Parameter

1.Mode: XH-LB(L)

2.Standard: ICAO (Aerodromes Annex 14) Low-intensity Type B and FAA L-810

3.Light intensity: $\geq 32\text{cd}$

4.Flash rate: Steady-burning mode

5.Light source: LED

6.Service life of LED: $\geq 100,000\text{hours}$

7.Operating voltage: AC220V to AC240V

8.Power consumption: $\leq 3.5\text{W}$

9.Overall size(mm): 130 by 130 by 211

10.Installation size: 78 by 78 by 9

11.Vertical degree: $\geq 10^\circ$

12.Horizontal degree: 360°

13.Material:

-Housing: PC

-Base: die casting aluminum

14.Weight:1Kg

15.Emitting color: Aviation red

16.Ambient temperature: $-10^\circ\text{C}\sim+50^\circ\text{C}$

17.Wind load: 80m/s

18.Protection standard: IP65

Dimension Drawing

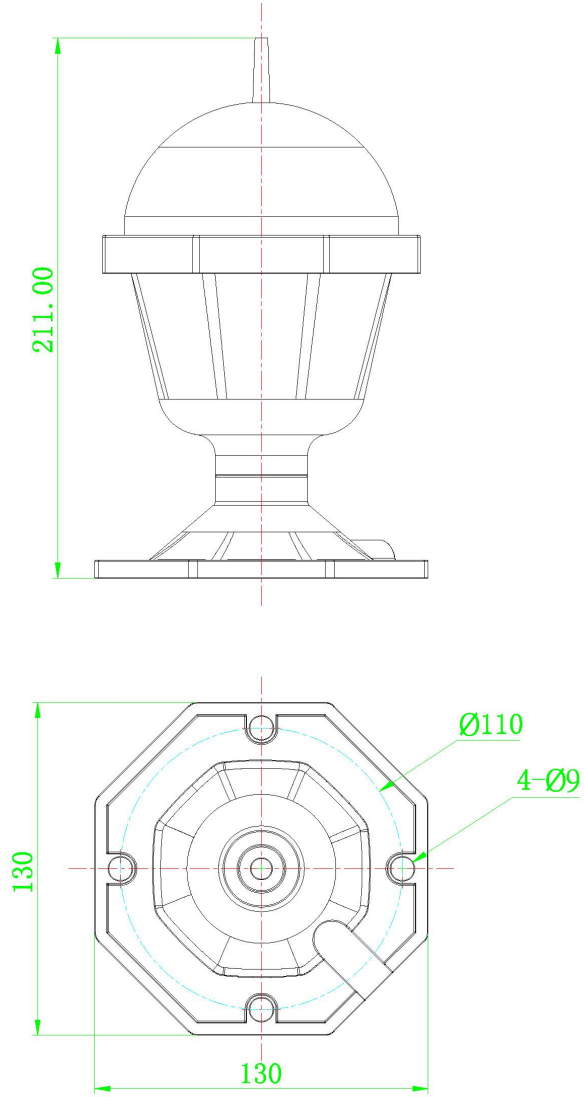

Installation Drawing

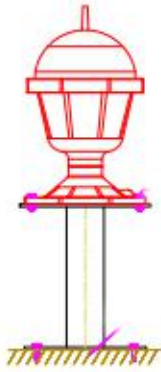

Vertical Installation way

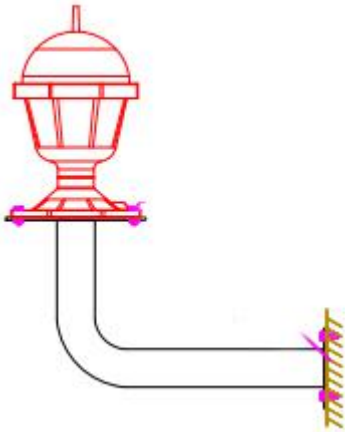

Side Installation Way