

Core & Coil (71A) MH 175W - 450W

CORE & COIL HID 71A55N0500

The basic ballast is the open core and coil which is most often used as a component within a lighting luminaire. The core and coil also forms the nucleus of Philips Advance's five other ballast configurations.

Product data

General Information	
ANSI Code	M57-M107
Lamp Type	175/150W MH
Number Of Lamps	1 piece/unit
Circuit Type	CWA
Ballast Type	Magnetic HID
Base Model	71A55N0
Core Size	3 X 4 (2 coil)
Suitable For Outdoor Use	Yes
Ignitor Catalog Number	NA
Ignitor Temperature Rating	NA
Capacitor Value	12 MFD
Capacitor Catalog Number	MD1204100
Capacitor Requirements	425V
Capacitor Temperature Rating	90°C
Capacitor Diameter/Oval Dimensions	1.75 in
Capacitor Height	2.9 in
Automatic Restart	No

Operating and Electrical	
Input Voltage	120/220-240 V
Input Frequency	50 Hz
Input Current (Open Circuit)	1.5/0.8 A
Input Current (Starting)	1.5/0.8 A
Input Current (Short Circuit)	2.5-3.7/1.3-1.9 A
Secondary Short Circuit Current	2.3-2.8 A
Constant Wattage Deviation	10%
Ballast Factor (Nom)	1
Power Factor (Nom)	0.90
Open Circuit Voltage	310 V
Input Current (Nom)	2/1.05 A A
Input Power (Nom)	210 W
Rated Lamp Power	175/150W W

Wiring	
Wire Striplength	0.5 mm
Wire Length By Color	12"
Wire Type	Stranded
Remote Wiring Configuration Allowed	Yes

Core & Coil (71A) MH 175W - 450W

Max Ballast-Lamp Distance Remote Wiring	Determined by AWG used
Recommended Fuse Value	5/3 A
Approval and Application	
Open Circuit Voltage Test (Volts)	290-355 V
Temperature Marking	C/C
UL Recognized	Yes
Hipot Test (1 Minute)	2000 V
Hipot Test (2 Seconds)	2500 V
UL Insulation Class	H(180°C)
UL Temperature Code	1029C

Product Data

Order product name	CORE & COIL HID 71A55N0500
EAN/UPC - Product	781087018521
Order code	913700500209
Numerator - Quantity Per Pack	1
Numerator - Packs per outer box	4
Material Nr. (12NC)	913700500209
Net Weight (Piece)	4.341 kg

Dimensional drawing

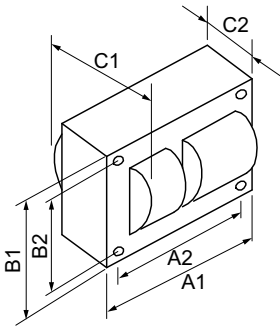

Product	C1	C2	A1	A2	B1	B2
CORE & COIL HID 71A55N0500	4 in	2.75 in	3.9 in	3.5 in	2.8 in	2.4 in

MH BAL 175W M57 120/220-240V 50HZ C&C

