

# LED CONTROLLER

ITEM NO.: Master Pro-3CH

## INSTRUCTION OF Master Pro-3CH

The controller consist of main controller and remote controller. It provides a convenient and easy way for customers, who is not very professional, to edit and realize a nice performance of the LED RGB lights. The controller is only compatible and available for the LED light fixture with R,G,B 3DMX channels, and for indoor use via connection of DMX cables (XLR-3).

### A. Specification:

Size:	L165×W105×H48mm
Weight:	0.67kgs
Working Temp:	-20℃~ 45℃
Input Volt:	120V /240V AC
Protection:	IP20

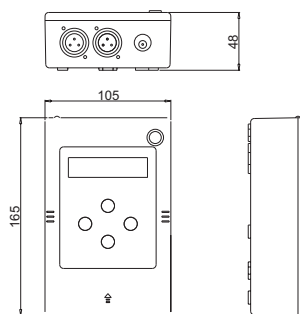

### B. Installation:

#### B-1. Onto the wall

Fix the screw(x2) into the wall firstly, and leave 4~8mm length out; hang the controller via the hole on the back onto the wall via the screw.

\*\*\* Measure the spacing between center position of two hanging holes on the back previously.

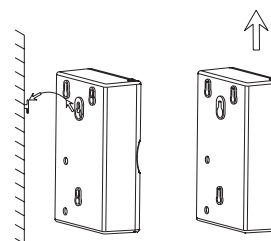

#### B-2. Built-in the wall

1. Screw out the 3 fixing screws on the back;
2. Push the cover up; And the take the cover out from the controller;
3. Fix the bottom part into the wall with 3screws.
4. Push the cover down again.
5. Pull out the antenna out

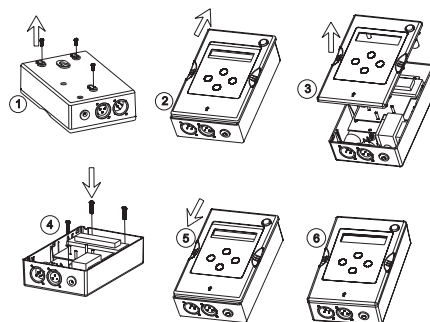

### C. Function and operation

#### C-1. Introduction

- Available for LED fixture with R,G, B 3DMX CH only (R-1st, G-2nd, B-3rd)
- 40pcs built-in programs optional with adjustable parameter
- Timing On/Off
- Max. 170pcs fixtures(with RGB-3CH) can be serial connected (signal amplifier is required)
- Remote controller available
- Record the parameter automatically

#### C-2. Setting & Operation

- There are two DMX standard outlet ports in controller, the female one can load 170pcs fixture (RGB-3CH);
- Addressing each fixture before connection, for example, setup the DMX address of the 1st fixture as N(N=3\*n, n≥1), 2nd will be (N+3), 3rd (N+6), 4th (N+9)...and so on;
- Define the Start Addr: xxx as N in the menu of System Setting in the controller to ensure that the effects are shown correctly.
- The male one is used for DMX addressing if necessary, please see the details of E Part.

# LED CONTROLLER

ITEM NO.: Master Pro-3CH

## C-3. Connection

\*\*\* All fixtures must be serially and sequentially addressed and connected!!!

\*\*\* Every 30pcs fixtures, one signal amplifier is required!!

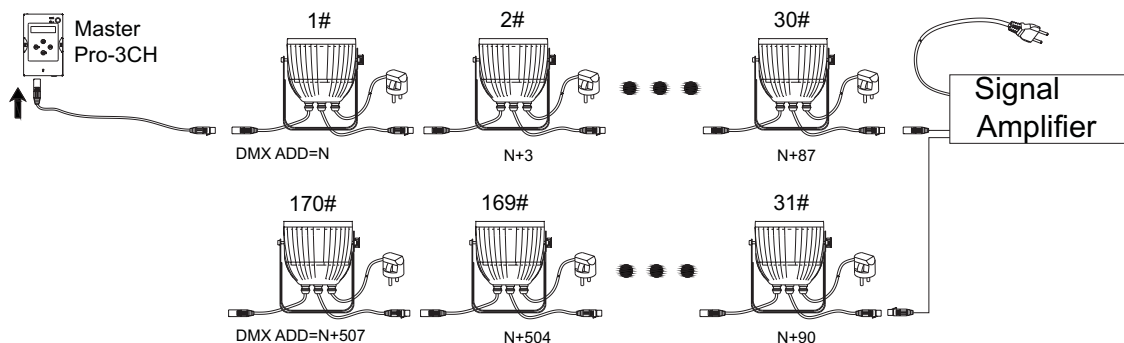

## D. Program menu

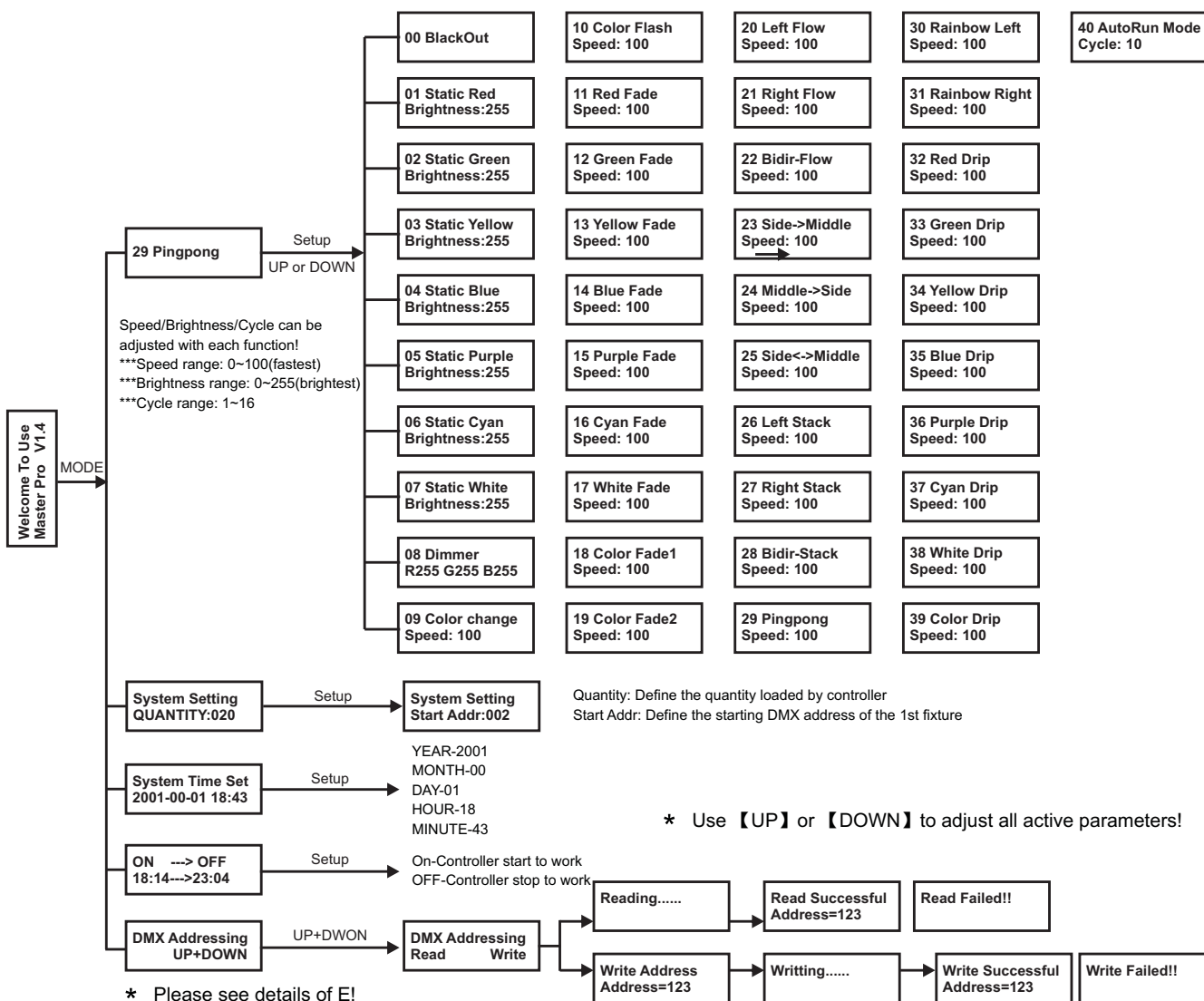

# LED CONTROLLER

ITEM NO.: Master Pro-3CH

## E. DMX Addressing

This is a new function developed specially for light fixtures, who need to be decoded from outside device before application. The function of the controller is very suitable with SA-x6 series. Some fixtures, such as LED Wall Washer, PAR CAN, who can be addressed itself via the circuit built-in is not available with this function.

- E-1 After entering into DMX addressing interface of the controller, press UP+DOWN in 5seconds, then the function will be valid.
- E-2 Each time connect one fixture only for addressing; otherwise, several connected fixtures might be addressed into the same one, and the controller shows the wrong information in LCD.
- E-3 Press MODE button to exit this function, excepting in Reading or Writing status.

## F. Remark

- F-1. When selected parameter stop flashing or exit present operation, setting will be recorded automatically; It is forbidden to cut the power off during setting.
- F-2 Use power button in the remoter to stop working and enter into OFF status with LCD sleeping, which can be waken by Mode button in the controller or Power button in remoter.
- F-3 The female DMX Socket is for regular function use;  
The male DMX Socket is addressing use.

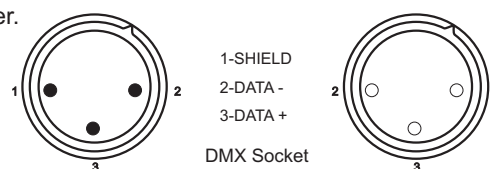

## G. CAUTION

- G-1 The controller should be installed indoor and far away from disturbance from electric or magnetic field.
- G-2 Set up the DMX address of light fixture strictly as per requirement, otherwise it will lead to failure of function performance.
- G-3 Set up the controller strictly as per requirement, otherwise it will lead to failure of function performance.

## Appendix

### Remoter Controller/RM-G

#### 1. Character

Size: 75x40x15mm  
 Frequency: 433MHz (RF)  
 Battery: 12V/23A  
 Remote distance:  
 15m indoor, 30m outdoor

#### 2. Function and Button

- ⏻ : On/Off to controller
- 🏠 : DMX addressing
- ⏏ : Equal to Up in the controller
- ⏏ : Equal to Down in the controller
- ▶ : Same as Mode in the controller
- ⚙ : Same as Setup in the controller



The remote controller and the CTR controller is a one-to-one relationship. They've been successfully paired when leaving the factory. A re-pairing is needed when the remote controller lost or damaged, please take the following steps:

1. Turn off the CTR controller.
2. Press MODE +SETUP in the same time, then turn on the CTR controller.
3. Release the buttons when LCD shows WELCOME, controller automatically clear the old pairing information .
4. Press any buttons on the new remote controller until it works. If can't work within 1 minute please repeat 1-4 steps or verify whether the new one is normal.

#### 3. Warning

- 3-1 Please read the manual carefully before operation
- 3-2 Please take the battery out if out of work for long time
- 3-3 If remote distance become shorter, please change the battery
- 3-4 Please use our original remoter
- 3-5 Remoter controller is one-to-one with the controller, once the remoter controller lost or damaged, please turn to dealer for more supports.

The above instruction are subject to update or improved without notice. Pls turn to our staff for further details !  
 Thanks for your long term support !