

## LUMINAIRE SPECIFICATION

### PROJECT :



- ◆ Explosion protection to
  - CENELEC
  - IEC
  - NEC
- ◆ Can be used in
  - Zone 1 and Zone 2
  - Zone 21 and Zone 22
  - Class I, Zone 1 and Zone 2
  - Class I, Division 1, Groups A, B, C, D
- ◆ Four enclosure types; Four current ratings (16A, 32A, 63A, 125A); 3P, 4P or 5P.
- ◆ Plug can only be pulled out when switch is off; turn on the power after inserting the plug.
- ◆ Copper-free aluminium enclosure, powder coated surface.

#### Technical data

<b>Explosion-proof plug and sockets</b>	<b>BCZ85-16/□/□</b>
<b>Explosion protection</b>	<ul style="list-style-type: none"> <li>Gas explosion protection <math>\text{Ex II 2 G Ex d IIC T6 Gb}</math></li> <li>Dust explosion protection <math>\text{Ex II 2 D Ex t IIC T80°C Db IP66}</math></li> </ul>
<b>Certificates</b>	Nemko 12 ATEX 1044; IECEx CQM 12.0015; KZ.7500525.22.01.00363 (CU-TR)
<b>Conformity to standards</b>	EN 60079-0, EN 60079-1, EN 60079-31 IEC 60079-0, IEC 60079-1, IEC 60079-31
<b>Enclosure material</b>	Copper-free aluminium, powder coated surface
<b>Enclosure colour</b>	Window grey (RAL7040)
<b>Exposed fastener</b>	Stainless steel
<b>Rated voltage</b>	Max. 690V AC
<b>Rated current</b>	16A
<b>Number of pole</b>	3P (2P+PE), 4P (3P+PE), 5P (3P+N+PE)
<b>Degree of protection</b>	IP66, IP67 (optional)
<b>Ambient temperature</b>	-60°C~+55°C
<b>Cable entry of socket</b>	2 x M25 x 1.5(3P/4P), 2 x M32 x 1.5(5P)
<b>Cable entry of plug</b>	1 x M25 x 1.5(3P/4P), 1 x M32 x 1.5(5P)
<b>Cable gland (optional)</b>	DQM-II (Ex d) or DQM-III (Ex d) is recommended.
<b>Cross section of cable</b>	2.5~4 mm <sup>2</sup>

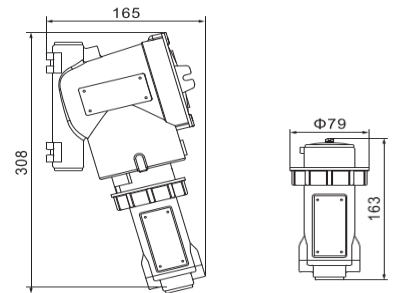

Plug and Sockets

Plug

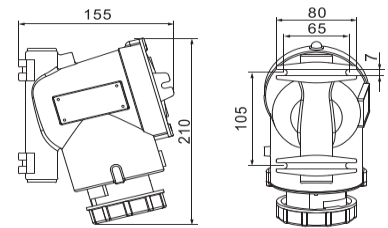

Socket

Current (A)	Voltage (V)	Number of pole	Schematic diagram	h	Colour	Ordering code	Weight (kg)
16	200~250	2P+PE		6	Blue	30148	2.60

<b>Type :</b>	16A, 2P+PE plug & socket	<b>Location :</b>	
<b>Model :</b>	LUMENEX BCZ85-16/250/3P (Z&T)	<b>Legend :</b>	<b>Quantity:</b>
<b>Lamp Source:</b>	N/A	<b>Control Gear :</b>	N/A
<b>Color Temp :</b>	N/A	<b>Lumen:</b>	N/A
<b>Description :</b>	LUMENEX BCZ85-16/250/3P, Exd explosion-proof sockets outlet suitable for zone1,2 & zone21,22. 16A, 2P+PE, 200-250V (colour code BLUE), die-cast aluminium body, IP66.	<b>IP Rating :</b>	IP66
		<b>Dimension:</b>	As shown above
		<b>Country of Origin :</b>	China
		<b>Comments:</b>	
<b>Submitted Date:</b>	<b>Revision:</b>	<b>Approved by:</b>	<b>Signature:</b>
		Architect	
		Consultant	