

LED LINEAR LIGHT

ITEM NO. : LLS-W35A Series

INSTRUCTION OF LED LINEAR LIGHT LLS-W35A

LED linear light is a high-end decoration light, it has strong points of low power consumption, long life span, high brightness, free maintenance, easy installation and instruction waterproof ect. LLS-M can project wall 3-5M high. This products suits for billboard, bridge, river, lake fence, building outline ect.

A. Specification

A-1. Structure

Size: L1005xW35.5xH57mm
 Materials of Shell: Aluminum alloy
 LED: SMD/5050
 Protection Rating: IP65
 Input Voltage: 24V DC
 Operating Temperature: -20~45°C



LLS-W35A-48

A-2. Model Configuration Table:

Model No.	LED Quantity	LED Color	Power Consumption	Beam Angle	Size	Weight	✓
LLS-W35A-24-S	24/2835	R,G,B,W,WW	10 Watt	15°/20°/25x35°	L520×W35.5×H57mm	0.95±5%kgs	
LLS-W35A-48-S	48/2835	R,G,B,W,WW	20 Watt	15°/20°/25x35°	L1000×W35.5×H57mm	1.9±5%kgs	
LLS-W35A-30-DMX	30/5050	RGB	7 Watt	20°/30x40°	L500×W35.5×H57mm	0.95±5%kgs	
LLS-W35A-60-DMX	60/5050	RGB	13 Watt	20°/30x40°	L1005×W35.5×H57mm	1.9±5%kgs	

B. Working Mode

B-1. Steady Color Mode: Directly connected to the power supply work.

B-2. DMX Mode: International standard DMX512 signal

C. DMX Addressing:

This product has 12/24 DMX channels, use "DMX-MR-502" for addressing, for details please refer to its instruction.

***Valid DMX address: 001~512

***Enter or quit DMX mode automatically once detecting valid signal!!!

D. Photometrics Parameters

D-1. Distribution curve

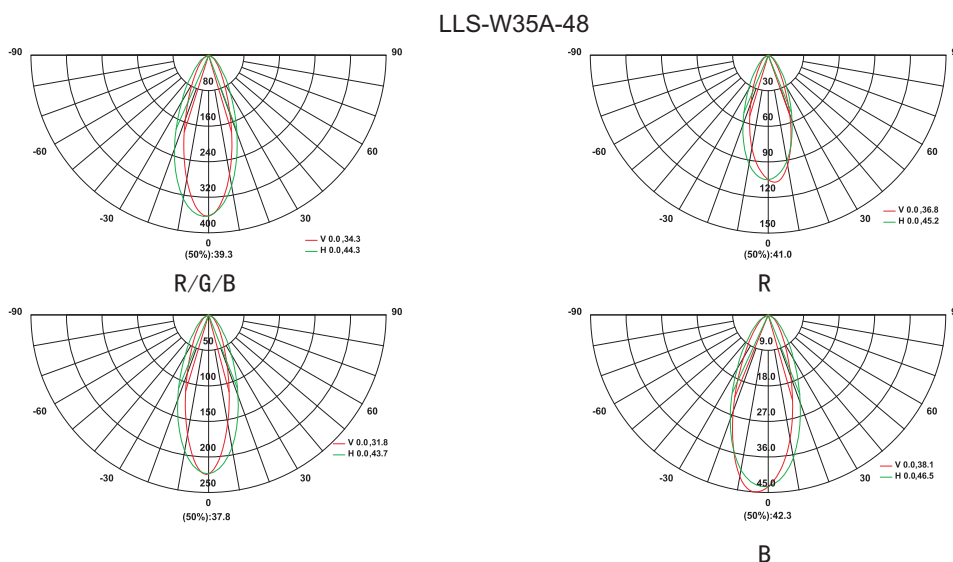

LED LINEAR LIGHT

ITEM NO. : LLS-W35A Series

D-2. Illuminance At A Distance.

LLS-W35A-48-24V

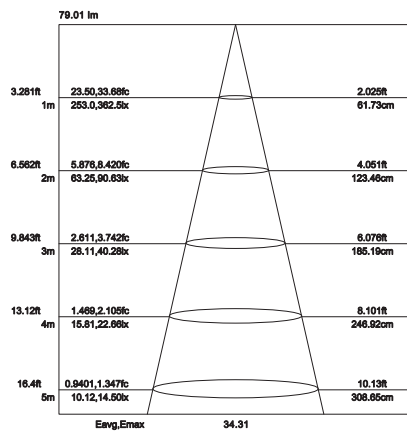

R/G/B

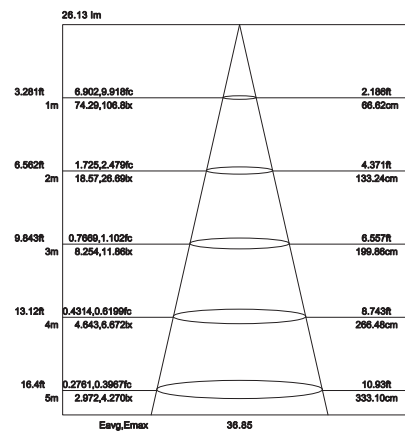

R

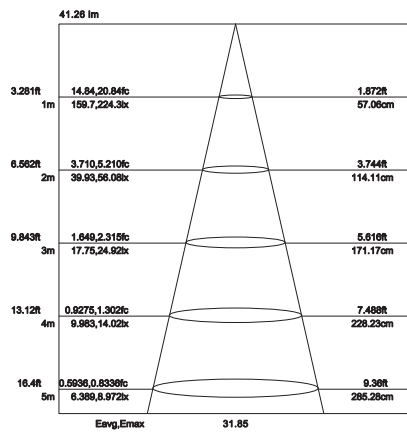

G

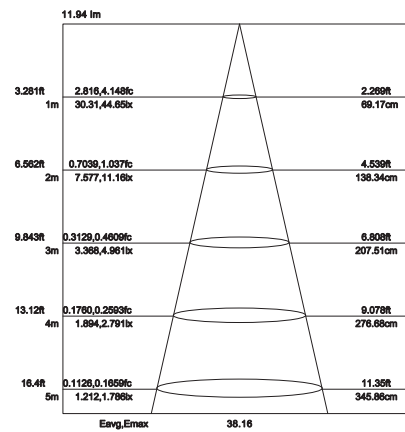

B

E. Dimension Drawing

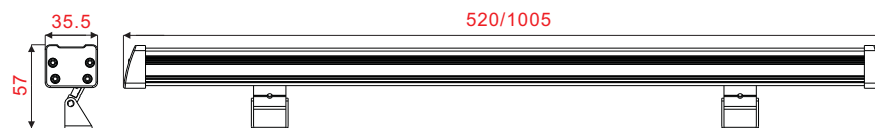

F. Installation

1. Fix the fixing clamp and light together by M3 screw, then screw tightly.
2. Then fix the expansion pipe in installation place by hammer.
3. Use spanner to twist bracket and fix screw, revolving around the lamp, align the installation hole and expansion pipe hole, then screw St4 tightly by screwdriver.
4. Finally adjust the lamp into correct angle then screw well. The distance between fixing clamp and clamp can be adjusted.

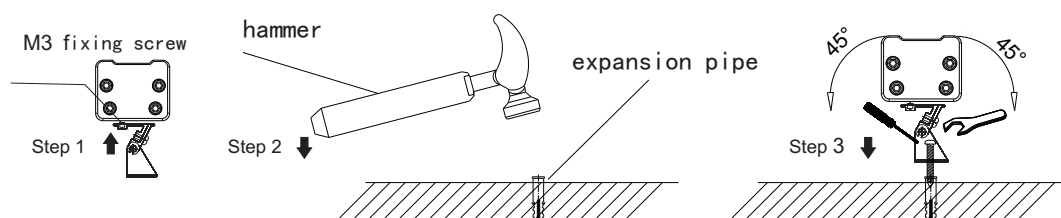

LED LINEAR LIGHT

ITEM NO. : LLS-W35A Series

G. Connection

G-1. Steady Color Mode

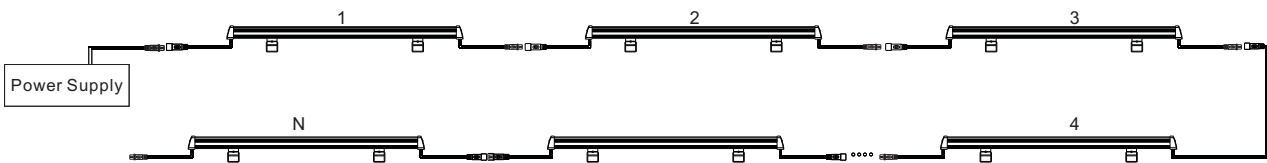

G-2. DMX Mode

1. Signal Max.connection is 17 pcs fixture every port,if over 20pcs,then signal splitter or use same DMX address for all lights.
2. Controller for option:Sunlite、DMX-MR-502 and other DMX controllers.

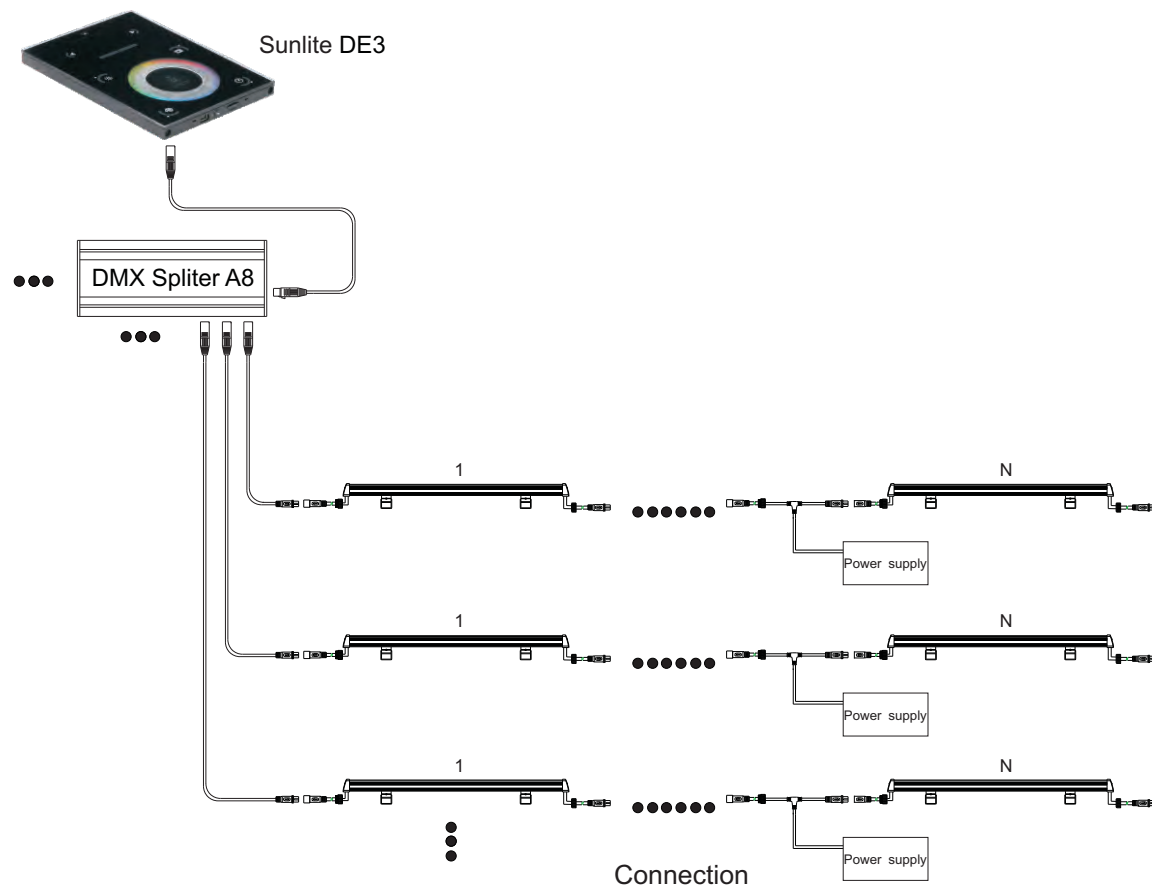

Mode No.	Input Voltage	Power connection	Signal Connection
LLS-W35A-60-DMX	24V DC	10PCS	17PCS
LLS-W35A-30-DMX	24V DC	20PCS	34PCS
LLS-W35A-48-S	24V DC	6PCS	-
LLS-W35A-24-S	24V DC	12PCS	-

Caution:

1. Do not plug them into power when the product is still in package;
2. Don't use anything to cover the fixture during application;
3. Don't use this product in close environment;
4. If this product appears to be damaged, do not attempt any repair, please contact your dealer.

Warning:

* Pls twist the connector well in order to avoid water going side and making fixture failure.