



HID-Basic ballasts for HPL and HPI(PLUS) lamps

BHLE 400L 200 TS

The HID-Basic ballast is an impregnated (HID standard) electromagnetic ballast for HID lamps, for use in combination with an external ignitor.

Product data

General information		Temperature	
Application Code	L200 TS	T-Winding (Max)	130 °C
		Delta-T Normal Conditions	70 °C to 75 °C
Operating and electrical		Approval and application	
Input Voltage	220 V	Approval Marks	CE marking
Input Frequency	50 Hz	Product data	
Power Factor 100% Load (Min)	0.85	Full product code	697480505031400
Mains Voltage Performance (AC)	-8%~+6%	Order product name	BHLE 400L 200 TS
Mains Voltage Safety (AC)	-10%~+10%	EAN/UPC - Product	6974805050314
Input Current with PF Correction	2.15 A	Order code	913713017342
Input Current without PF Correction	3.25/3.4 A	Numerator - Quantity Per Pack	1
Power Factor without PF Compensation (Nom)	0.60	Numerator - Packs per outer box	6
Power Losses (Nom)	25.5/27.5 W	Material Nr. (12NC)	913713017342
Wiring		Net Weight (Piece)	2.900 kg
Connector Type	Screw		
System characteristics			
Rated Ballast-Lamp Power	400 W		

HID-Basic ballasts for HPL and HPI(PLUS) lamps

Dimensional drawing

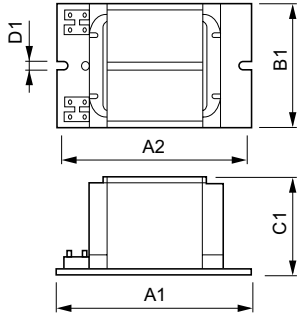

Product	D1	C1	A1	A2	B1
BHLE 400L 200 TS	6.2 mm	64.5 mm	165.0 mm	144.0 mm	75.5 mm

BHLE 400L 200 TS

