



HID-Basic ballasts for HPL and HPI(PLUS) lamps

BHLE 250L 200 TS

The HID-Basic ballast is an impregnated (HID standard) electromagnetic ballast for HID lamps, for use in combination with an external ignitor.

Product data

General information		Temperature	
Application Code	L200 TS	T-Winding (Max)	130 °C
		Delta-T Normal Conditions	70 °C to 75 °C
Operating and electrical		Approval and application	
Input Voltage	220 V	Approval Marks	CE marking
Input Frequency	50 Hz		
Power Factor 100% Load (Min)	0.85	Product data	
Mains Voltage Performance (AC)	-8%~+6%	Full product code	697480505029100
Mains Voltage Safety (AC)	-10%~+10%	Order product name	BHLE 250L 200 TS
Input Current with PF Correction	1.35 A	EAN/UPC - Product	6974805050291
Input Current without PF Correction	2.13/2.15 A	Order code	913713017242
Power Factor without PF Compensation (Nom)	0.60	Numerator - Quantity Per Pack	1
Power Losses (Nom)	20 W	Numerator - Packs per outer box	6
Wiring		Material Nr. (12NC)	913713017242
Connector Type	Screw	Net Weight (Piece)	2.019 kg
System characteristics			
Rated Ballast-Lamp Power	250 W		

HID-Basic ballasts for HPL and HPI(PLUS) lamps

Dimensional drawing

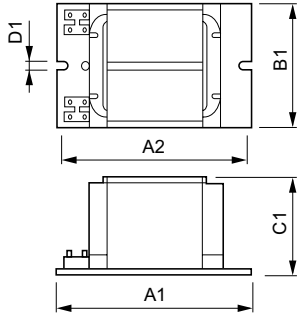

Product	D1	C1	A1	A2	B1
BHLE 250L 200 TS	6.2 mm	64.5 mm	165.0 mm	144.0 mm	75.5 mm

BHLE 250L 200 TS

