

SmartBright LED Downlight DN029B

DN029B G2 LED12/CCT PSR-E D150 CAU

SmartBright Downlight family is the perfect energy efficient LED replacement for conventional downlights. It offers three solutions:;Solution 1;The energy efficient LED replacement for conventional downlights;Essential SmartBright Downlight G3 DN029B-1– trailing and leading edge dimmable downlight is the ideal functional replacement for conventional downlights. This affordable and easy to install fitting delivers high energy savings without compromising on light quality.;Solution 2;Select the right colour temperature to suit your style;This hassle-free Essential SmartBright DN029B-2 downlight provides you with the flexibility to select the perfect colour temperature (Warm White/Cool White/Day Light) for the application. Integrated with trailing/leading edge dimming capability, this affordable and easy to install fitting delivers high energy savings without compromising on light quality.;Solution 3;Enjoy the flexibility of a dimmable fitting without paying more;Essential SmartBright DN029B-3 step dimming downlight is the perfect hassle-free replacement for conventional dimmable downlights. Adjust the light level straight from the switch and save cost with installation as a dimmer unit is not required.

Product data

General information		Power Factor (Min)		0.8	
Light source color	3000/4000/6500				
Light source replaceable	No				
Luminaire light beam spread	100°				
Connection	Plug-in connector 2-pole				
Protection class IEC	Safety class II				
Operating and electrical		Controls and dimming			
Input Voltage	220 to 240 V	Dimmable	Yes		
Input Frequency	50 or 60 Hz				
		Mechanical and housing			
		Housing Material	Metal–Plastic		
		Reflector material	Polycarbonate		
		Optic material	Polycarbonate		
		Fixation material	Stainless steel		

SmartBright LED Downlight DN029B

Optical cover/lens finish	Frosted
Overall length	114 mm
Overall width	114 mm
Overall height	61 mm
Overall diameter	190 mm
Color	White
Dimensions (Height x Width x Depth)	61 x 114 x 114 mm

Approval and application

Ingress protection code	IP40/IP54 front
Mech. impact protection code	IK03 [0.3 J]

Initial performance (IEC compliant)

Initial luminous flux (system flux)	1200 lm
Initial LED luminaire efficacy	114.00 lm/W
Init. Corr. Color Temperature	3000 4000 6500 K
Init. Color Rendering Index	80
Initial chromaticity	(3000K@, 0.4400, 0.4030; 4000K@0.37600.3656; 6500K@0.31300.3370) 6
Initial input power	10.5 W
Power consumption tolerance	+/-10%

Over time performance (IEC compliant)

Driver failure rate at 5000 h	1.2 %
Median useful life L70B50	30000 h

Application conditions

Ambient temperature range	-20 to +40 °C
---------------------------	---------------

Product data

Full product code	871951425187800
Order product name	DN029B G2 LED12/CCT PSR-E D150 CAU
EAN/UPC - Product	8719514251878
Order code	929002531619
Numerator - Quantity Per Pack	1
Numerator - Packs per outer box	6
Material Nr. (12NC)	929002531619
Net Weight (Piece)	0.420 kg



Dimensional drawing

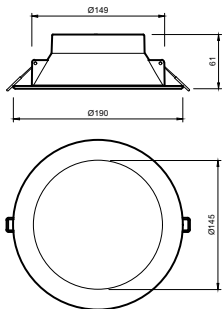

DN029B G2 LED12/CCT PSR-E D150 CAU

SmartBright LED Downlight DN029B

Photometric data

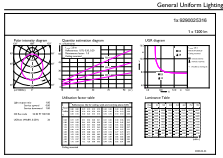

Downlight DN029B G2 LED12 PSR D150

Lifetime

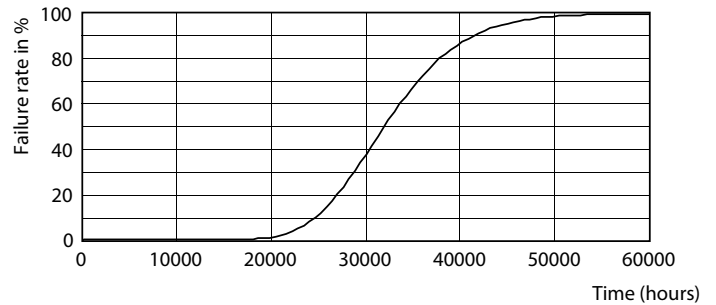
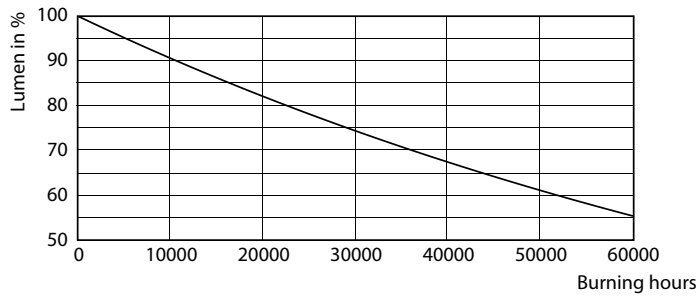

B50L70 30K LMP

B50L70 30K LED

