

## Magnetic Packages for Compact Fluorescent Lamps 7–26 W Standard Ballasts

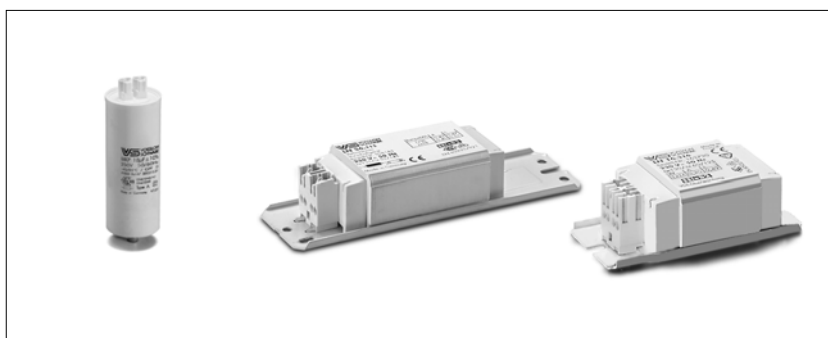

### Electromagnetic built-in ballasts for compact fluorescent lamps

Vacuum-impregnated with polyester resin

Push-in terminals for leads: 0.5–1 mm<sup>2</sup>

For the automatic luminaire wiring:

IDC terminals for leads H05V-U 0.5

tw 130, Protection class I

EN 61347 (Safety), EN 60921 (Performance)

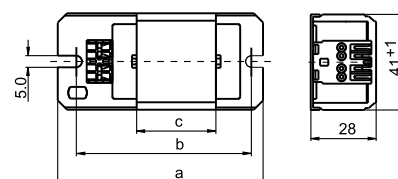

Lamp				Ballast									Capacitor	
Output W	Type	Base	Current mA	Type	Ref. No.	V, Hz	a mm	b mm	c mm	Weight kg	Δt K	EEL	C <sub>P</sub> μF	Current mA
<b>Electromagnetic ballasts</b>														
7	TC-S	G23	175	L7/9/11.881	<b>509257</b>	220, 50	85	75	27	0.29	50	–	2.0	80
9	TC-S	G23	170	L7/9/11.101	<b>509257</b>	220, 50	85	75	27	0.29	50	–	2.0	60
11	TC-S	G23	155	L7/9/11.101	<b>509257</b>	220, 50	85	75	27	0.29	50	–	2.0	80
13	TC-D/-T	G24d-1/GX24d-1	175	LN 13.879	<b>509253</b>	220, 50	85	75	27	0.29	50	–	2.0	80
18	TC-D/-T	G24d-2/GX24d-2	220	LN 181.880	<b>509261</b>	220, 50	85	75	27	0.29	55	–	2.0	110
26	TC-D/-T	G24d-3/GX24d-3	325	L 18.933	<b>534624</b>	220, 50	150	140	45	0.49	70	–	3.5	140
7	TC-S	G23	175	L7/9/11.851	<b>503875</b>	230, 50	85	75	27	0.29	65	B2	2.0	50
9	TC-S	G23	170	L7/9/11.851	<b>503875</b>	230, 50	85	75	27	0.29	65	B2	2.0	60
11	TC-S	G23	155	L7/9/11.851	<b>503875</b>	230, 50	85	75	27	0.29	65	B2	2.0	80
13	TC-D/-T	G24d-1/GX24d-1	175	L 13.849	<b>503868</b>	230, 50	85	75	27	0.29	65	B2	2.0	80
18	TC-D/-T	G24d-2/GX24d-2	220	LN 181.850	<b>503871</b>	230, 50	85	75	27	0.29	65	B2	2.0	110
26	TC-D/-T	G24d-3/GX24d-3	325	LN 26.813	<b>509502</b>	230, 50	110	100	45	0.42	55	B2	3.5	140
7	TC-S	G23	175	L7/9/11.245	<b>538588</b>	240, 50	85	75	27	0.32	60	B2	2.0	50
9	TC-S	G23	170	L7/9/11.245	<b>538588</b>	240, 50	85	75	27	0.32	60	B1	2.0	60
11	TC-S	G23	155	L7/9/11.245	<b>538588</b>	240, 50	85	75	27	0.32	60	B1	2.0	80
13	TC-D/-T	G24d-1/GX24d-1	175	LN 13.413	<b>164342</b>	240, 50	85	75	34	0.32	60	B1	2.0	80
18	TC-D/-T	G24d-2/GX24d-2	220	LN 181.418	<b>538572</b>	240, 50	85	75	27	0.32	65	B2	2.0	110
26	TC-D/-T	G24d-3/GX24d-3	325	LN 26.238	<b>545405</b>	240, 50	105	95	45	0.43	55	B2	3.5	140
7	TC-S	G23	175	L7/9/11.832	<b>538567</b>	220, 60	85	75	27	0.28	55	–	2.0	70
9	TC-S	G23	170	L7/9/11.832	<b>538567</b>	220, 60	85	75	27	0.28	55	–	2.0	70
11	TC-S	G23	155	L7/9/11.832	<b>538567</b>	220, 60	85	75	27	0.28	55	–	2.0	70
13	TC-D/-T	G24d-1/GX24d-1	175	L 13.235	<b>538576</b>	220, 60	85	75	27	0.28	50	–	2.0	110
18	TC-D/-T	G24d-2/GX24d-2	220	L 181.236	<b>538577</b>	220, 60	85	75	27	0.28	50	–	2.0	110
26	TC-D/-T	G24d-3/GX24d-3	325	L 18.121	<b>532145</b>	220, 60	110	100	45	0.41	65	–	3.0	160

### Parallel connected capacitors

for 250 V, 50/60 Hz

EN 61347 (Safety), EN 60921 (Performance)

PC

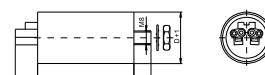

Capacity μF	Ref. No.	Temperature range °C	Ø (D) mm	Length (L) mm	Male nipple/length (mm)	Push-in twin terminals	Weight g	Unit pcs.
<b>Parallel connected capacitors</b>								
2.0	<b>500296</b>	-40 to 85	25	57	M8x10	0.5–1 mm <sup>2</sup>	22	530
3.0	<b>500300</b>	-40 to 85	25	57	M8x10	0.5–1 mm <sup>2</sup>	22	530
3.5	<b>500301</b>	-40 to 85	25	57	M8x10	0.5–1 mm <sup>2</sup>	22	530