

Lampholders for discharge lamps

25.809.3801

G12

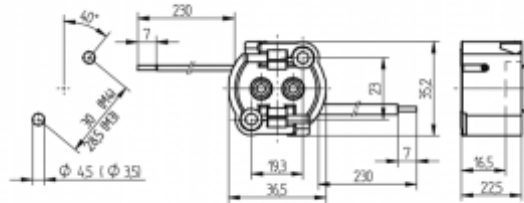

pkg.	wt.	part no.
144	43 g	25.809.3801.00

Connection: with cables attached

Wires: 1. Cu, nickel plated, 1.0 mm², with ferrule, Insulation: PTFE 250° C, ø 2 mm, Cable length: 230 mm
 2. Cu, tin plated, 1.0 mm², with ferrule, Insulation: PVC, ø 4.2 mm (ignition cable), Cable length: 230 mm

Screw fixing
 2. Cu, tin plated, 1.0 mm², with ferrule, Insulation: PVC, ø 4.2 mm (ignition cable), Cable length: 230 mm

- The requirements on light fittings of protection class II can be complied with through corresponding embodiment into metal components, without the use of additional insulating material
- Please consult us if fixing at rear with M3 rivet.

T 180	2 A 1000 V	 6 kV/pulse
-------	---------------	---