

Vossloh Schwabe ELXc 242.837 2x18W 42W TC F/ L TC dEL/ tEL TC dD T R5

ID: 049330 | EAN: 4050732049330 | MPN: 188643 | HS Tariff: 85041080



Electronic ballast for compact fluorescent lamps.

Electronic ballast
Casing: heat-resistant polyamide
DC voltage for operation: 176 - 264 V, for ignition: 198 - 264 V (ELXc 242.837: DC voltage cannot be reduced to 176 V)
Power factor: > 0.96 (K1: 0.9)
Push-in terminals with push-button: 0.5 - 1.5 mm²
RFI-suppressed

Dimmable: no
Voltage - (V): 220
Protection mark - (IPXX): 20
Factory Box - (piece): 12

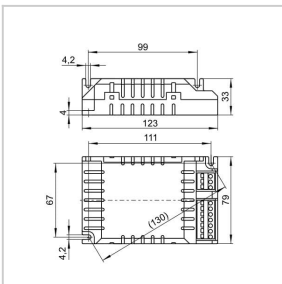

Constant power consumption
For luminaires of protection class I
Degree of protection: IP20
Fixing brackets for screws M4 for lateral or base mounting
For lighting systems with high switching frequency (> 5/day)
EOL shut down approved acc. to EN 61347 Test 2
Lamp type: TC-F/-L, TC-DEL/-TEL, TC-DD, T-R5
Output [W]: 2 × 18, 2 × 24, 2 × 36, 2 × 40 for compact fluorescent lamps TC-F/-L (2G10/2G11)
Output [W]: 2 × 22, 2 × 40 for compact fluorescent lamps T-R5 (2GX13)
Output [W]: 2 × 26, 2 × 32, 2 × 42 for compact fluorescent lamps TC-DEL/-TEL (G24q-3/GX24q-3)
Output [W]: 2 × 38 for compact fluorescent lamps TC-DD (GR10q)
Lamp number: 2
Voltage AC [V]: 220 - 240
Frequency [Hz]: 50 - 60
Ambient temperature (°C) -20...50