

AVIVO BATTERY

6-GFM-26

Specifications

Rated Voltage	12V	
Nominal Capacity	26.0Ah	(C ₁₀ , 1.80V/cell)
Dimension	Length	166±2mm (6.54 inches)
	Width	175±2mm (6.93 inches)
	Container Height	125±2mm (4.92 inches)
	Total Height	125±2mm (4.92 inches)
Approx Weight	7.5 Kg	
Terminal	T2	
Container Material	ABS	
Rated Capacity (25°C)	27.8 Ah	(20hr, 1.39A, 1.80V/cell)
	26.0 Ah	(10hr, 2.60A, 1.80V/cell)
	20.8 Ah	(5hr, 4.16A, 1.75V/cell)
	19.5 Ah	(3hr, 6.5A, 1.75V/cell)
	15.86 Ah	(1hr, 15.86A, 1.60V/cell)
Max. Discharge Current	390A (5s)	
Internal Resistance (25°C)	Approx 17.2mΩ	
Operating Temp. Range	Discharge	-15 ~ 50°C (5 ~ 122°F)
	Charge	0 ~ 40°C (32 ~ 104°F)
	Storage	-15 ~ 40°C (5 ~ 104°F)
Nominal Operating Temp. Range	25±3°C (77±5°F)	
Cycle Use	Initial Charging Current less than 7.8A. Voltage 14.4V~15.0V at 25°C(77°F)Temp. Coefficient -30mV/°C	
Standby Use	Initial Charging Current less than 7.2A. Voltage 13.5V~13.8V at 25°C(77°F)Temp. Coefficient -20mV/°C	
Effect of temp. to Capacity	40°C (104°F)	103%
	25°C (77°F)	100%
	0°C (32°F)	86%
Self Discharge	PT series battery may be stored for up to 6 months at 25°C(77°F) and then a freshening charge is required. For higher temperatures the time interval will be shorter.	



Layout

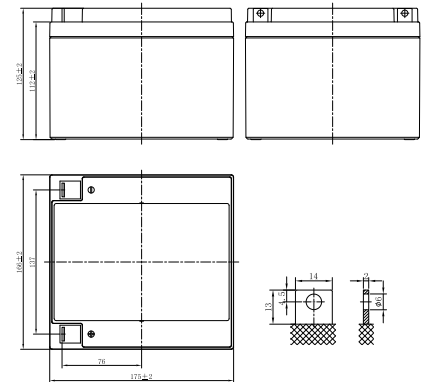

Constant Current Discharge (Amperes) at 25 °C (77°F)

15min	20min	30min	45min	1h	2h	3h	4h	5h	6h	8h	10h	20h	V/cell
28.60	24.70	19.76	15.08	12.22	7.80	5.98	4.94	3.90	3.38	2.86	2.47	1.34	1.85
36.40	29.38	23.14	16.38	13.78	8.32	6.24	5.20	4.03	3.64	2.99	2.60	1.39	1.80
39.00	31.72	24.18	17.42	14.30	8.58	6.50	5.46	4.16	3.77	3.12	2.68	1.45	1.75
41.60	33.28	25.22	18.46	14.82	8.84	6.76	5.67	4.42	3.90	3.25	2.78	1.50	1.70
44.20	35.10	26.00	19.24	15.34	9.36	7.02	5.85	4.68	4.03	3.38	2.89	1.56	1.65
46.80	36.40	27.30	20.02	15.86	9.88	7.28	6.11	4.94	4.29	3.64	2.99	1.61	1.60

Constant Power Discharge (Watts/cell) at 25 °C (77°F)

15min	20min	30min	45min	1h	2h	3h	4h	5h	6h	8h	10h	20h	V/cell
52.91	45.70	36.56	27.90	22.61	14.43	11.06	9.14	7.22	6.25	5.29	4.57	2.47	1.85
65.52	52.88	41.65	29.48	24.80	14.98	11.23	9.36	7.25	6.55	5.38	4.68	2.50	1.80
68.25	55.51	42.32	30.49	25.03	15.02	11.38	9.56	7.28	6.60	5.46	4.69	2.53	1.75
70.72	56.58	42.87	31.38	25.19	15.03	11.49	9.64	7.51	6.63	5.53	4.73	2.55	1.70
72.93	57.92	42.90	31.75	25.31	15.44	11.58	9.65	7.72	6.65	5.58	4.76	2.57	1.65
74.88	58.24	43.68	32.03	25.38	15.81	11.65	9.78	7.90	6.86	5.82	4.78	2.58	1.60

Discharge Characteristics

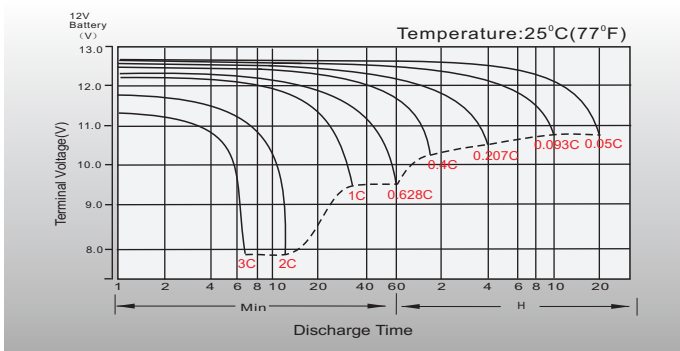

Float Charging Characteristics

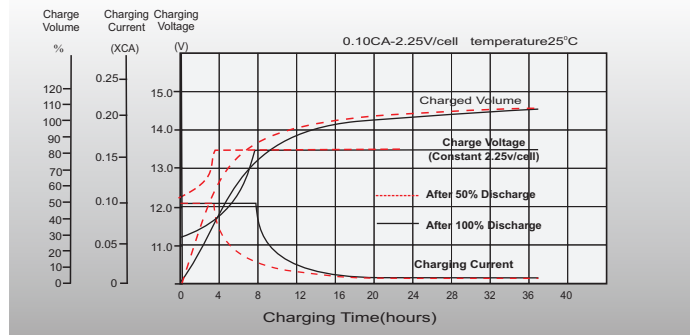

Temperature Effects in Relation to Battery Capacity

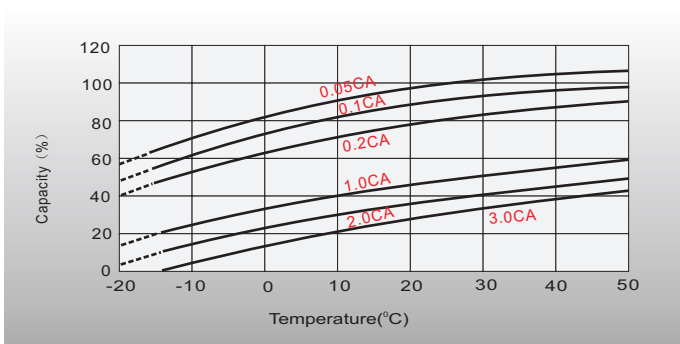

Effect of Temperature on Long Term Float Life

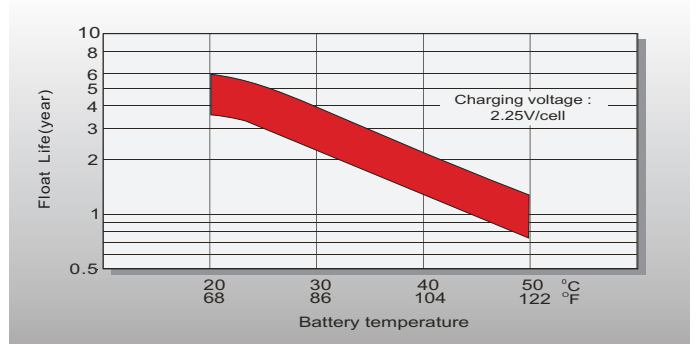

Cycle Life in Relation to Depth of Discharge

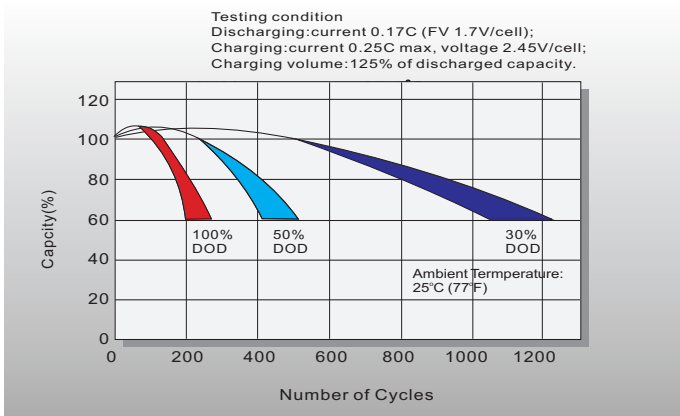

Self Discharge Characteristics

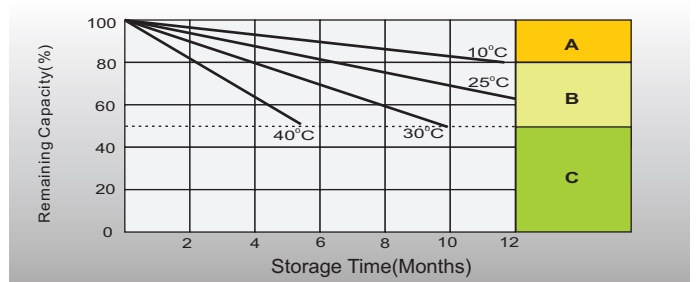

- A** No supplementary charge required
(Carry out supplementary charge before use if 100% capacity is required.)
- B** Supplementary charge required before use. Optional charging way as below:
1. Charged for above 3 days at limited current 0.25CA and constant voltage 2.25V/cell.
2. Charged for above 20 hours at limited current 0.25CA and constant voltage 2.45V/cell.
3. Charged for 8-10 hours at limited current 0.05CA.
- C** Supplementary charge may often fail to recover the capacity.
The battery should never be left standing till this is reached.