



DesignNest.com

INSTALLATION
MANUAL



CandleHolder | LUNEdot |

DesignNest BV
Keulsevaart 19 321MX Breukelen
The Netherlands
info@designnest.com
Made in China
www.DesignNest.com

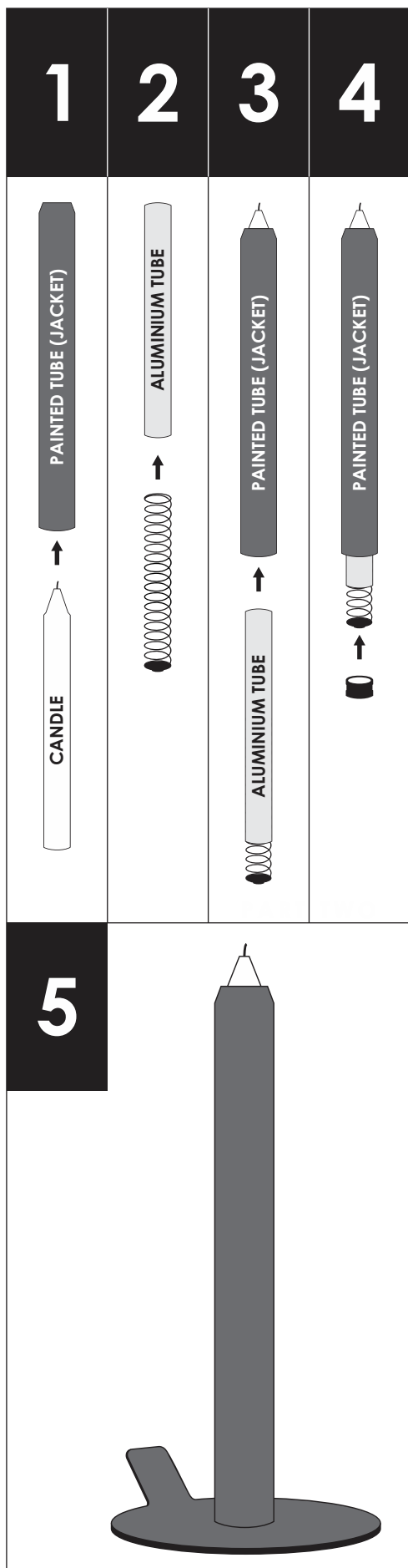

INSTALLATION INSTRUCTIONS

Please make sure these steps are taken carefully in the right order:

1. Put the candle in the coated tube; so the "old fashion candle in its new jacket." This element together hereafter called "part 1".
2. Put the spring "inside" aluminium, not painted tube; together "part 2".
3. Slowly push part 2 into part 1 and close all by screwing the (magnetic) cap.
4. ATTACH (magnetically) LUNEdot ENDLESS on its S, M or XL baseplate.
5. Enjoy LUNEdot as a strong design object in your interior.



CLEANING

Not necessary if you use LUNEdot as instructed, but if due to wrong use wax gets stuck inside:

1. Place cylinder on a sheet of baking paper.
2. Place in pre-heated oven at 75 degrees for 10 minutes.
3. Wipe tube and base plate with tissue as soon as it comes out of the oven

INCASE THERE'S STILL SOME WAX LEFT:

4. Place in the freezer for 2 hours and all left overs of wax can be scraped away.



WARNING

Please make sure you:

- Never move candles when lit
- Never pour water over a candle
- Never use sharp objects to remove wax
- Always place candles away from drafts
- Never leave a burning candle unattended
- Always place candles on a fireproof and wax resistant surface
- Always keep lit candles out of reach of children and pets
- Never burn candles on or near anything that can catch fire



BOX CONTENTS

