

# ROOF RACK MEASUREMENT FORM

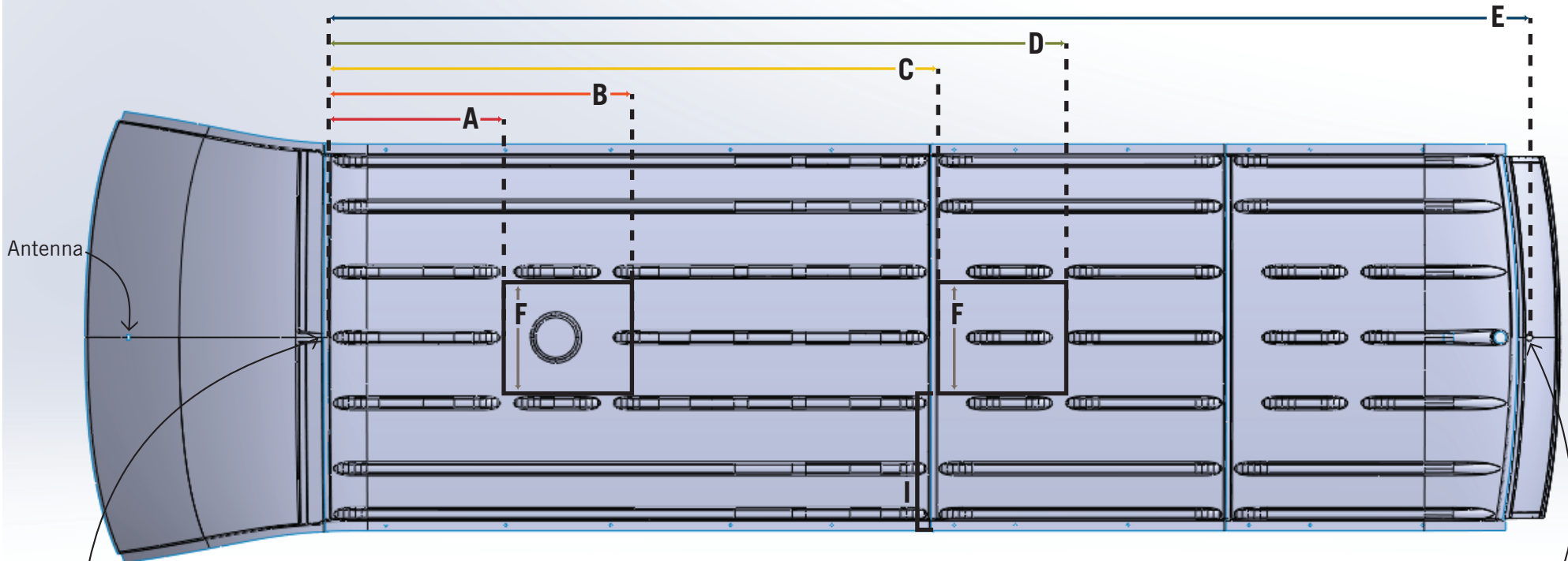

Antenna

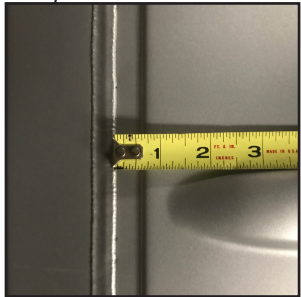

Record Measurements Here			
<b>A</b>		<b>D</b>	
<b>B</b>		<b>E</b>	<input type="checkbox"/> 126" <small>(144)</small> <input type="checkbox"/> 166.5" <small>(170)</small> <input type="checkbox"/> 182" <small>(170 ext)</small>
<b>C</b>		<b>F</b>	<input type="checkbox"/> 20" <input type="checkbox"/> 33"

**Van Length**

144  
 170  
 170 EXT

**Front Section**

Slim  
 XL

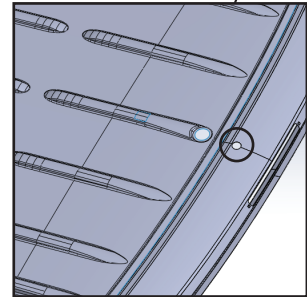

**Customer Info:**

Customer Name: \_\_\_\_\_

Shipping Address: \_\_\_\_\_

Phone Number: \_\_\_\_\_

Email Address: \_\_\_\_\_

Date: \_\_\_\_\_

**Vehicle Info:**

Year Model: \_\_\_\_\_

Fan Model: \_\_\_\_\_

A/C Model: \_\_\_\_\_

**Sales Order #:** \_\_\_\_\_

**Notes:**

- 1) This product fits high roof only.
- 2) Make sure to measure the widest/longest part of the fan and/or AC, including the cover/lid
- 3) Section E is for you to double check, as a failsafe. If you get a different measurement, call us.
- 4) Section F: Measure your widest accessory (A/C or fan). If wider than 33", contact the sales team.