

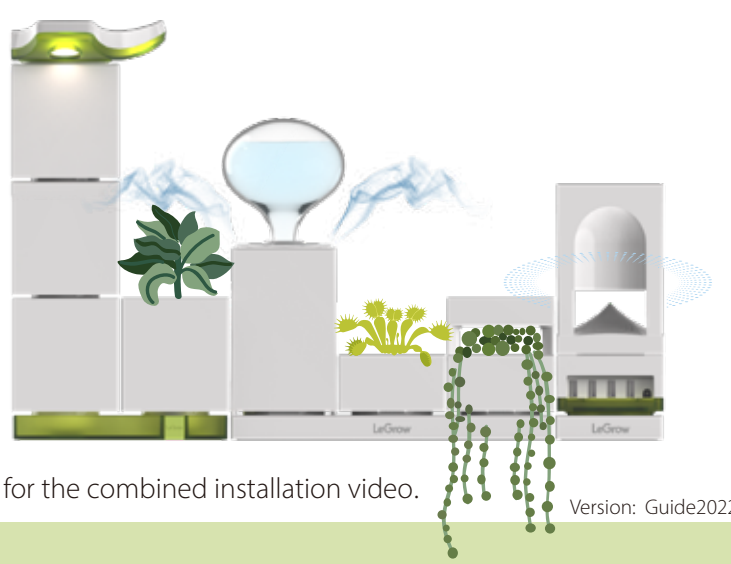

Please watch the **Youtube** channel for the combined installation video.

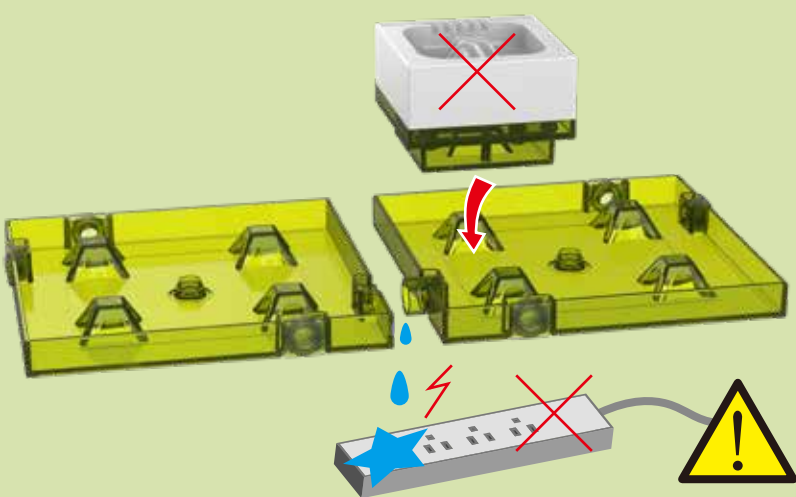

Version: Guide2022C



[EN] Warning! There is a risk of water leakage on the trays, do not place electrical appliances underneath!

[CN] 警告，请勿将电源放入水中。底盘有漏水风险，下方不要放置电器。

[FR] Avertissement! Il y a un risque de fuite d'eau sur les plateaux, ne placez pas d'appareils électriques en dessous !

[DE] Warnung! Es besteht die Gefahr von Wasseraustritt an den Wannen, keine Elektrogeräte darunter stellen!

[IT] Avvertimento! C'è il rischio di perdite d'acqua sui vassoi, non posizionare apparecchi elettrici sotto!

[JP] 警告、電源を水に入れないでください。シャーシに水漏れの恐れがあります。電気器具を下に置かないでください

[KR] 경고, 전원 공급 장치를 물에 넣지 마십시오. 케이스에 누수의 위험이 있으므로 아래에 전기 제품을 놓지 마십시오.

[VN] Cảnh báo, vui lòng không đặt nguồn điện vào nước. Rò rỉ khay, bên dưới không đặt các thiết bị điện.

[RU] Предупреждение! Существует опасность протекания воды на противни, не ставьте под них электроприборы!



POT-01

1.

2.

3.

4.

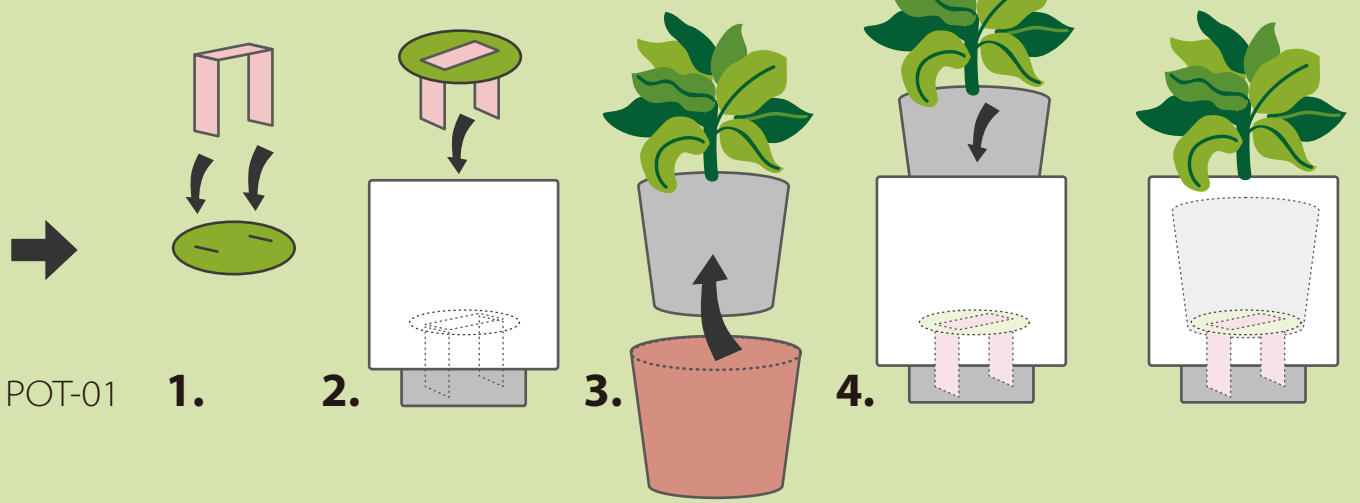

POT-01

1.

2.

3.

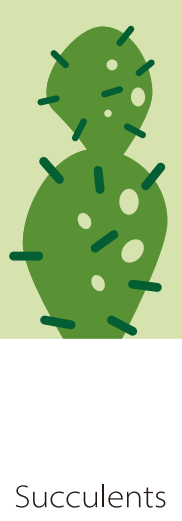
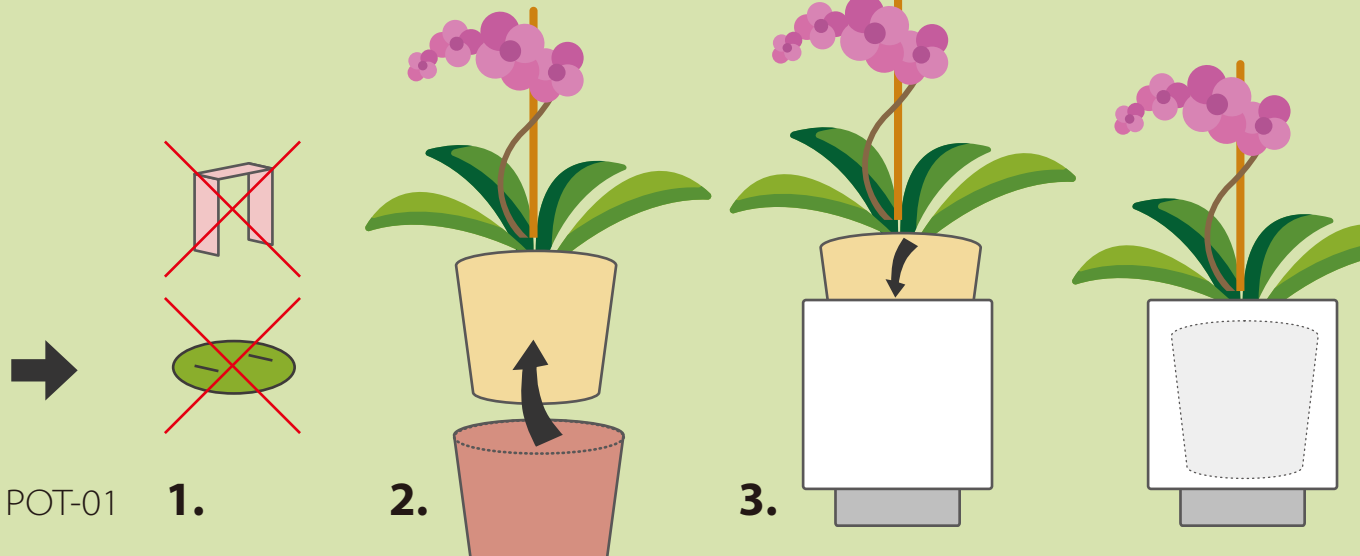

POT-01

1.

2.

3.

4.

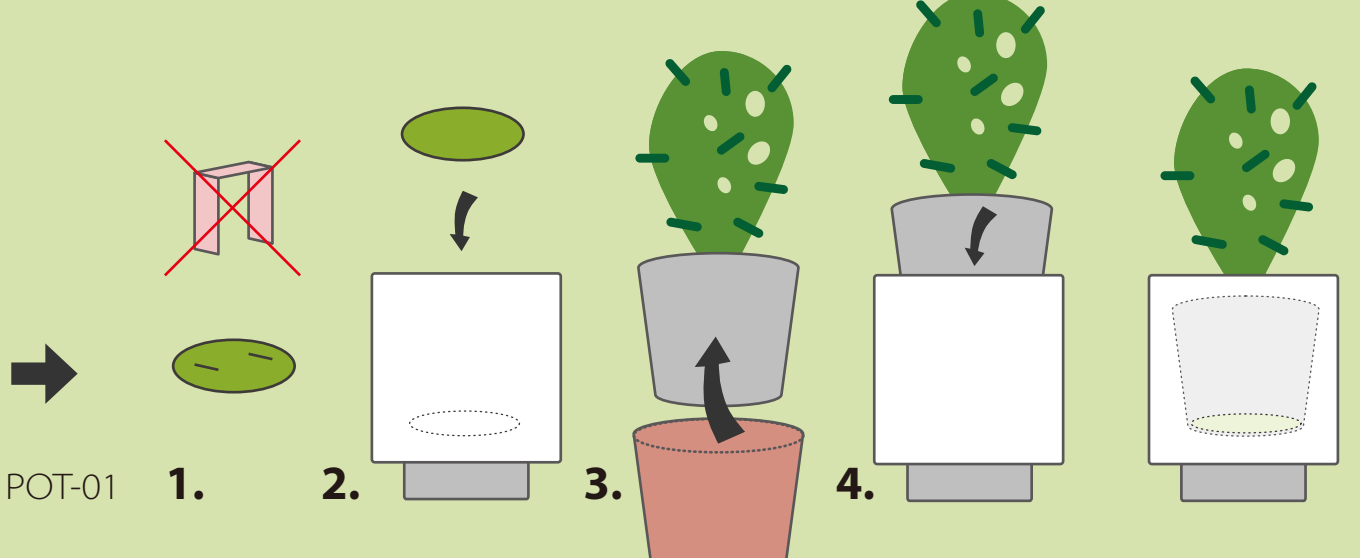

POT-01

1.

2.

3.

4.

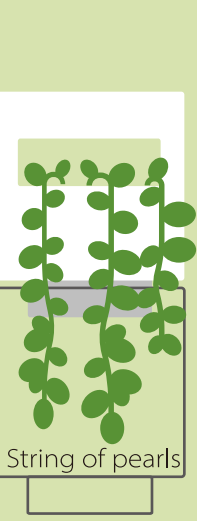
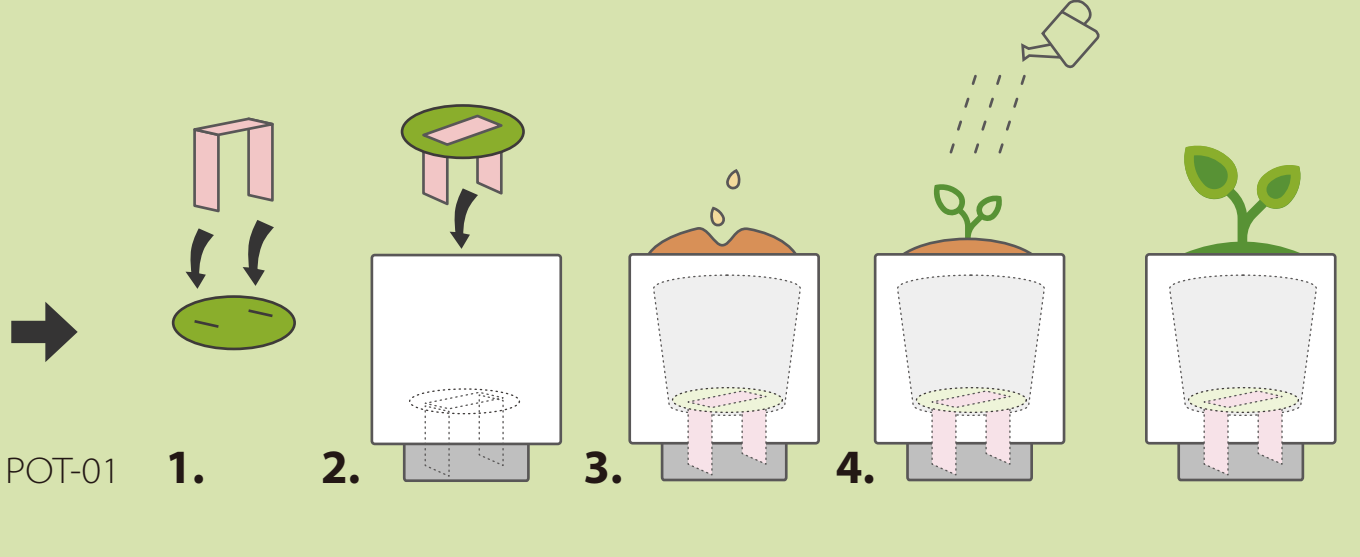

VERTICAL POT-12

1.

2.

3.

4.

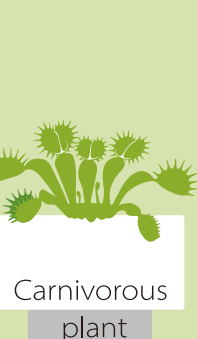
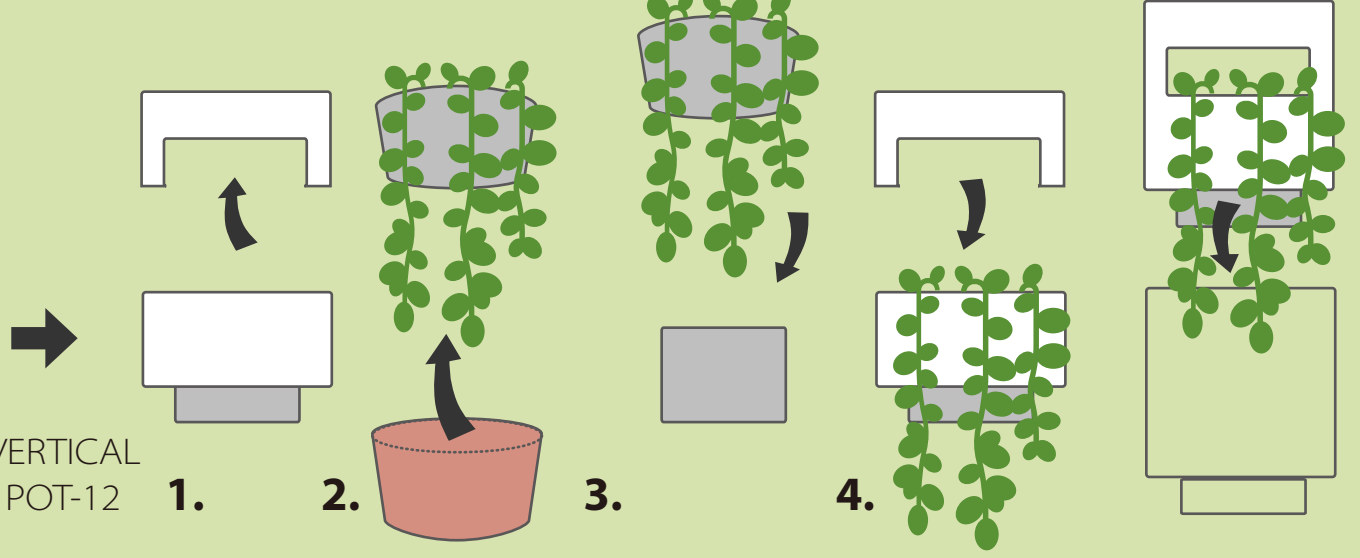

MOSS POT-11

1.

2. Fill the gaps in the 4 corners



MOSS POT-11

1.

2.

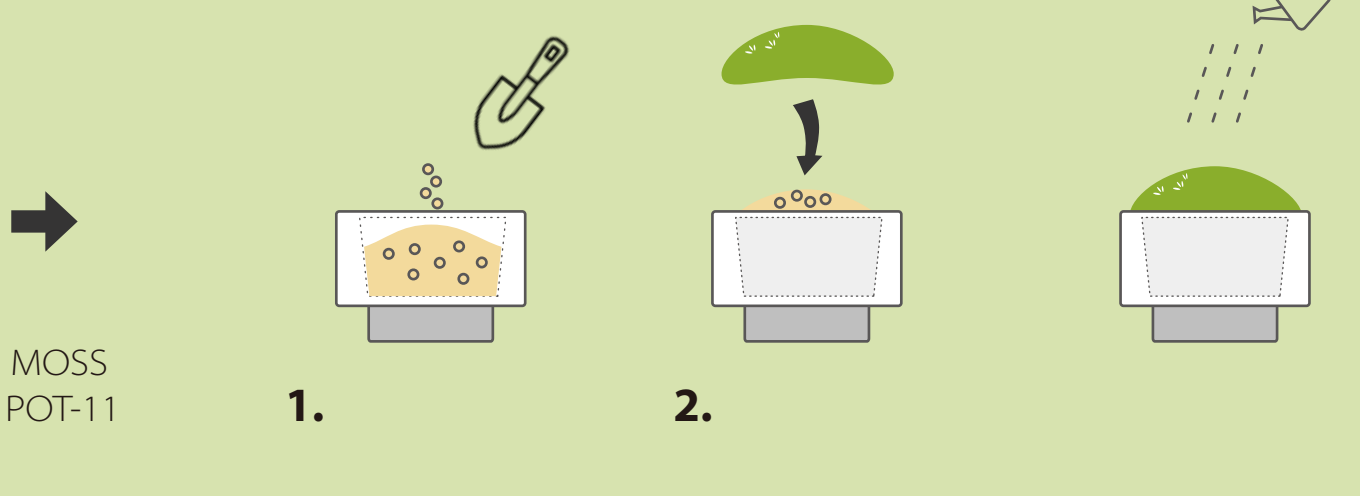

POT-01

1.

2.

3.

4.

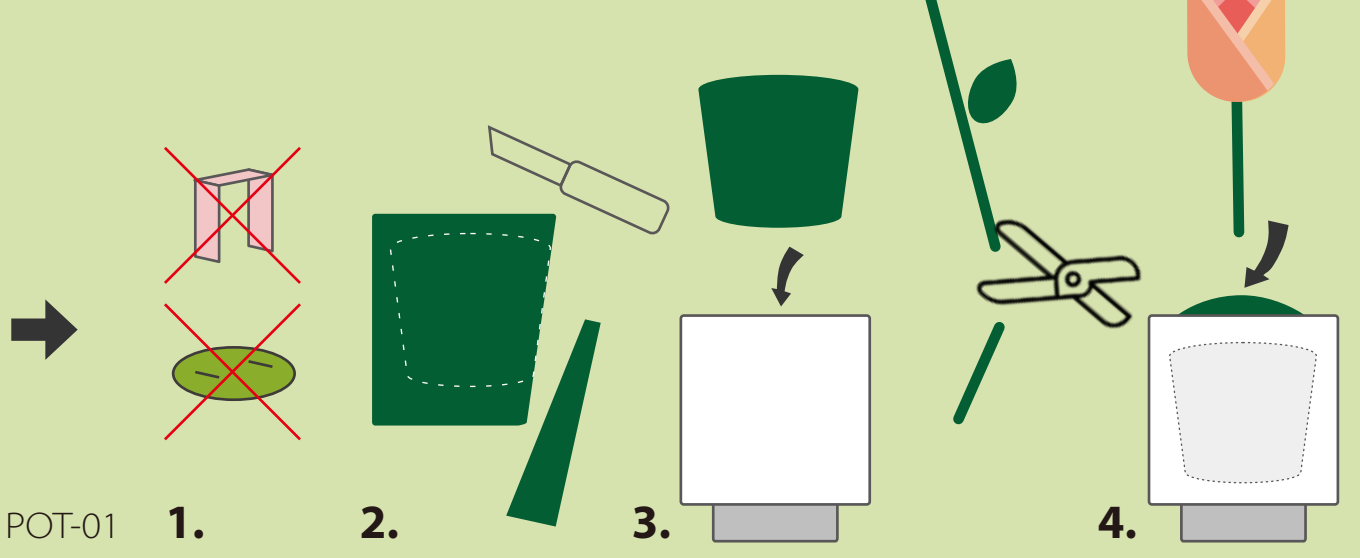



Single Tray (TG-04)



Straight Tray (TG-03)



Corner Tray (TG-05)



Self-watering Tray (TG-13)

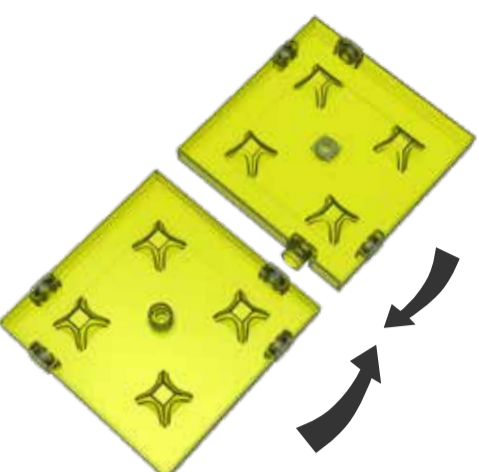

Connection installation (TG-13)



1.

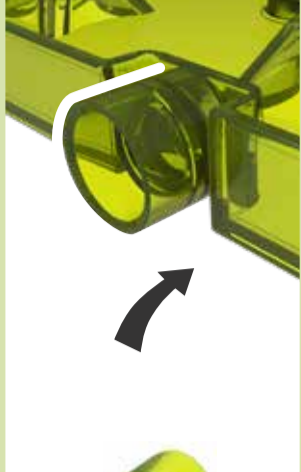

2.

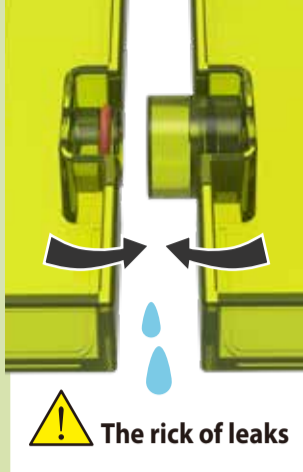

3.

⚠ The risk of leaks

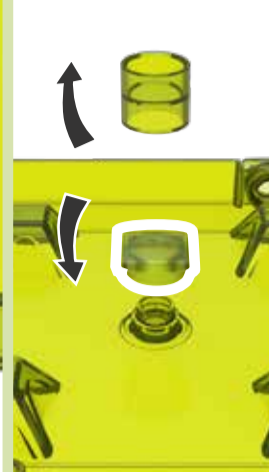

Output ≥ 30w = 6w + 6w + 6w + 12w

Power (TG-08)

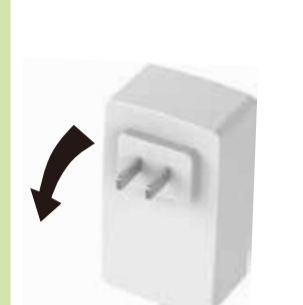

1. AC100V-240V



2.



Power ON



Power OFF



Grow Lamp (TG-06)



10000 lumens

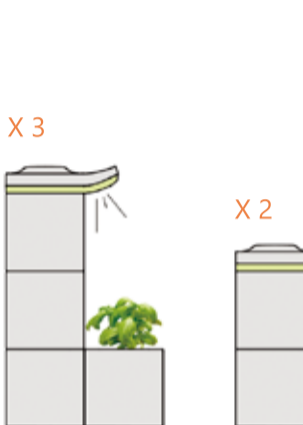

19000 lumens

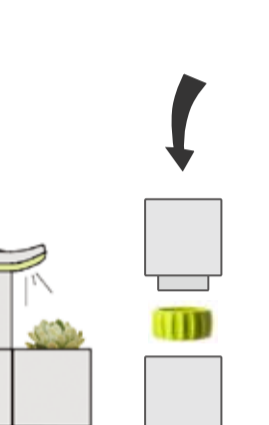

50000 lumens

Height Adjustment



Humidifier (TG-07)



1.



2.



3.

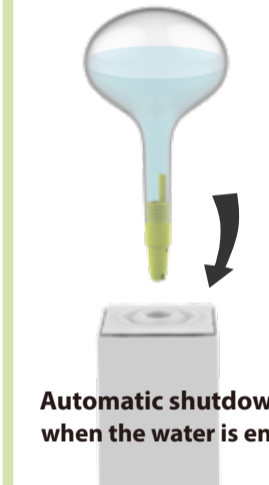

Automatic shutdown when the water is end



Speaker (TG-10)



1.



2.

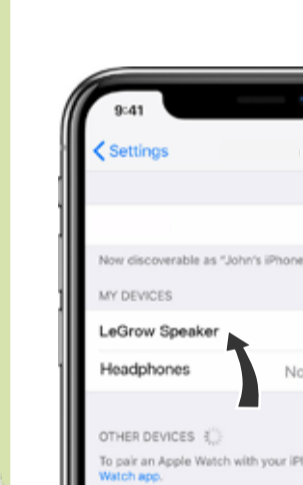

3. Power ON / Search / Power OFF



4.

* Broadcast mode (10 Devices)



Plant Clock (TG-02)



1.

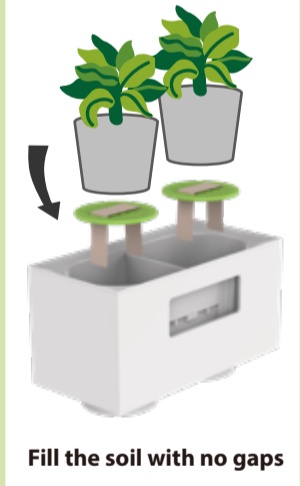

2. Fill the soil with no gaps

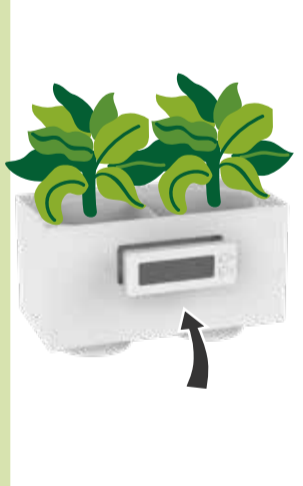

3.

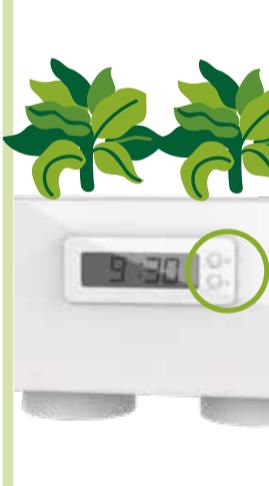

4. Set the time

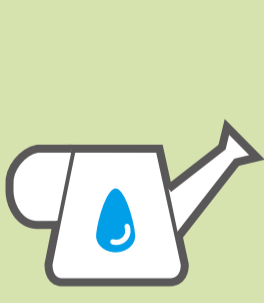

Watering
如何浇水
arrosage
Bewässerung
irrigazione
水やり
살수
tưới nước
ПОЛИВ



7 DAYS

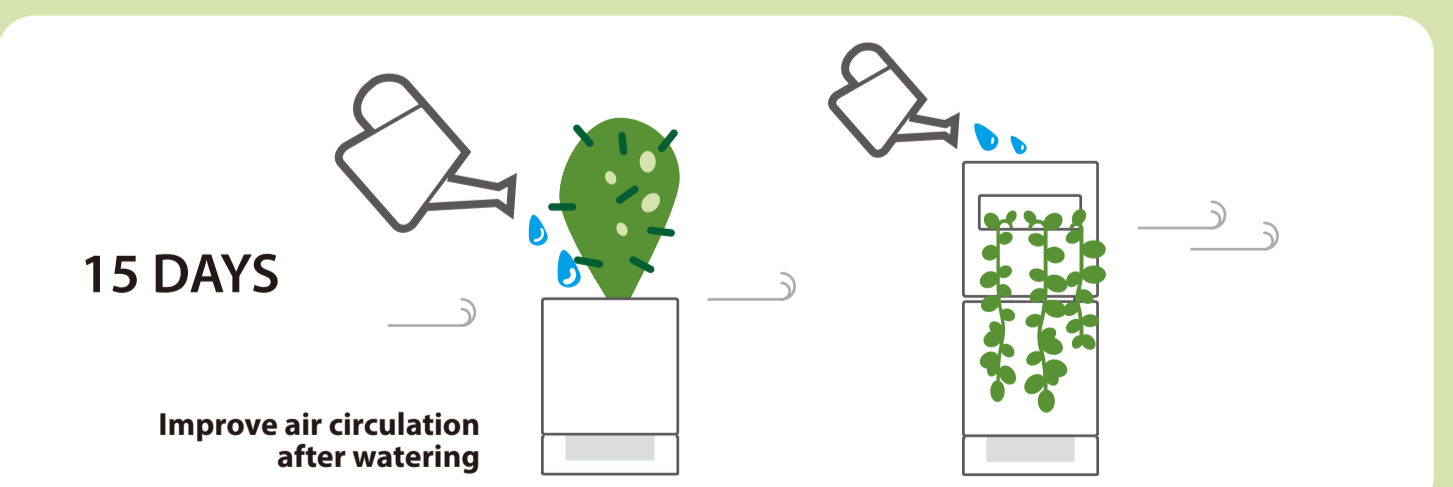

15 DAYS

Improve air circulation after watering



For combination installation , please visit

LeGrow.co