

LINK DIGITAL DUO

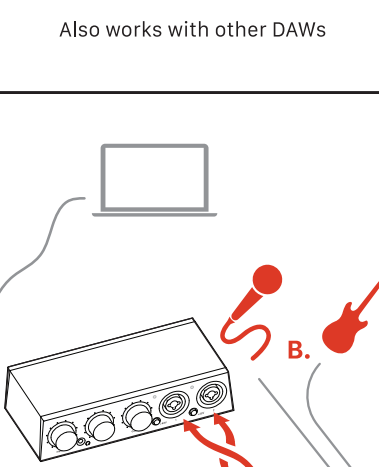

Digital Audio Interface

1.



Also works with other DAWs

2.



3.

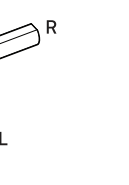
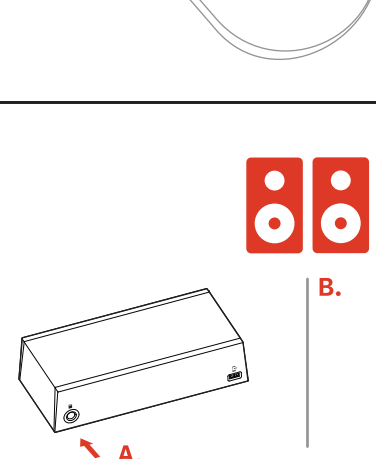

4.

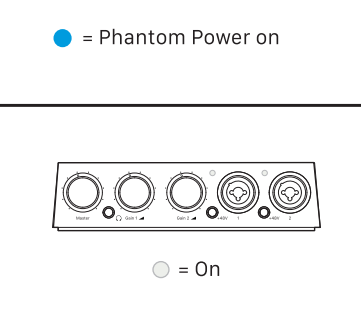

Press once to turn on Phantom Power

● = Phantom Power on

5.



● = On

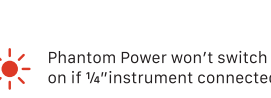

● = Input device connected



● = Phantom Power on

Trouble shooting

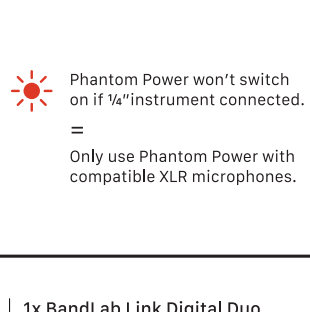

Phantom Power won't switch on if 1/4" instrument connected.

=

Only use Phantom Power with compatible XLR microphones.

1x BandLab Link Digital Duo

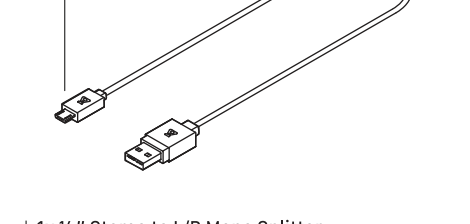

1x USB-C to Micro-B Cable

1x USB-A to Micro-B Cable

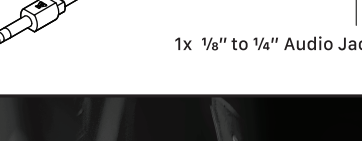

1x 1/4" Stereo to L/R Mono Splitter



1x 1/8" to 1/4" Audio Jack Adapter

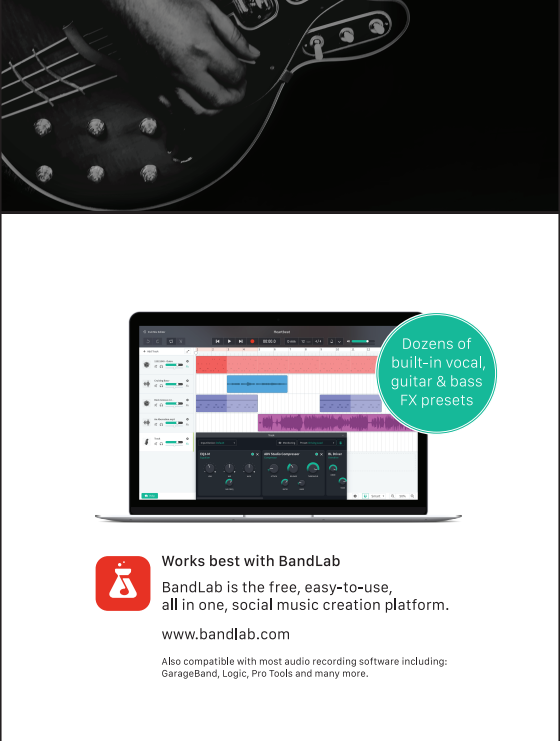

Works best with BandLab
BandLab is the free, easy-to-use, all in one, social music creation platform.
www.bandlab.com
Also compatible with most audio recording software including: GarageBand, Logic, Pro Tools and many more.

For warranty, more info, tips & tricks

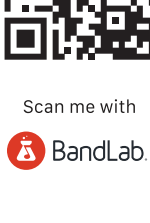

Scan me with

