

## PA-24-05

### 2.4-2.5GHz PANEL 14 dBi FOR N JACK



## Product Specifications

Frequency Range: 2.4~2.5GHz

Antenna Type: Panel

Gain: 14dBi

Beamwidth: Horizontal- 30°

Vertical- 40°

VSWR: <1.5

Polarization: Vertical

Maximum Power: 100W

Impedance 50Ω

Lightning Protection: Direct Ground

## Mechanical Specifications

Connector: N-Female

Dimensions: 223 x 200 x 60mm

Weight: 1kg

Radome Material: ABS Polymer (white)

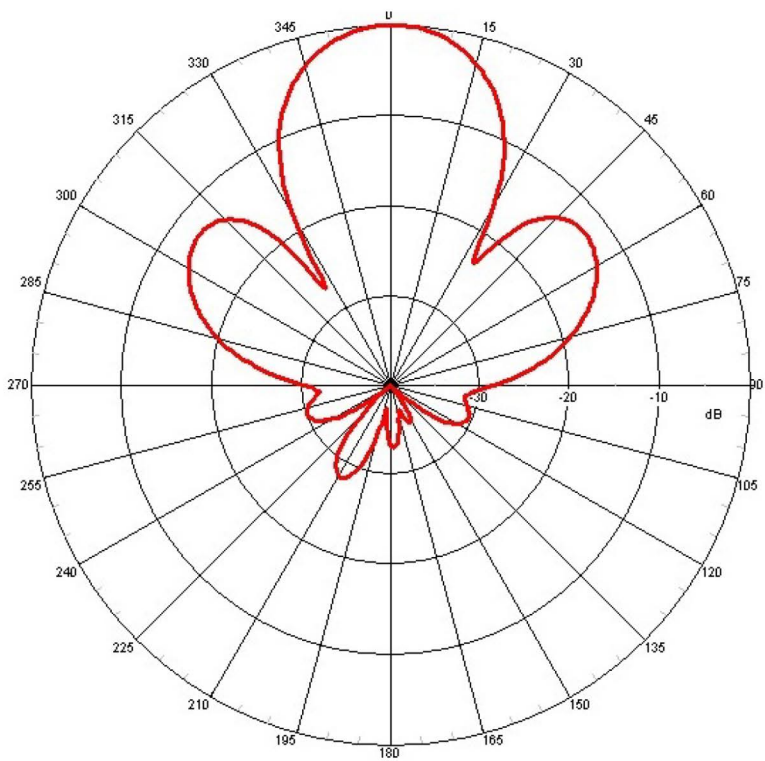

H-Plane

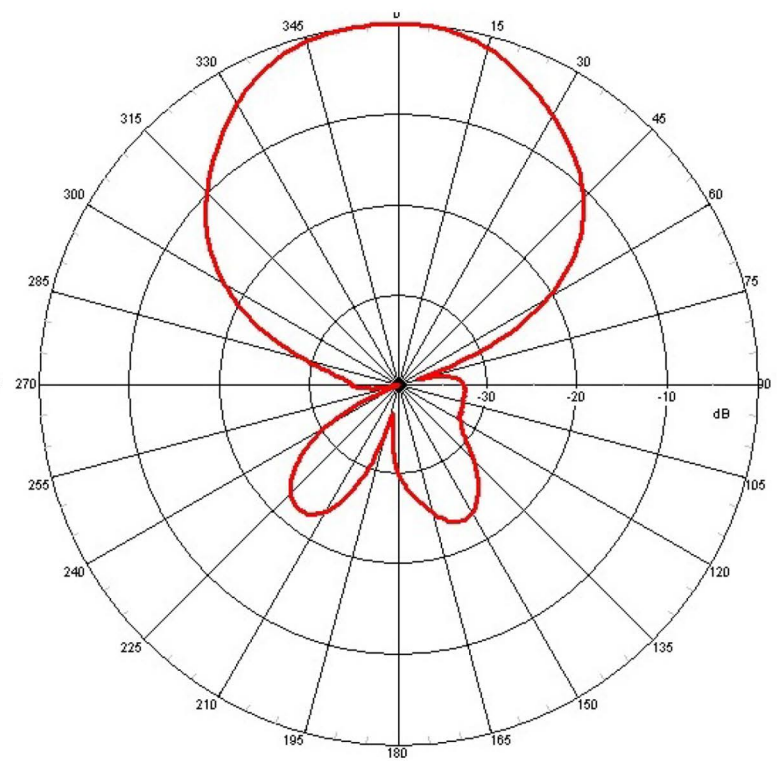

E-Plane

Trc1 S11 dB Mag 5 dB / Ref 0 dB Cal 1  
 Mem2[Trc1] S11 dB Mag 5 dB / Ref 0 dB Invisible

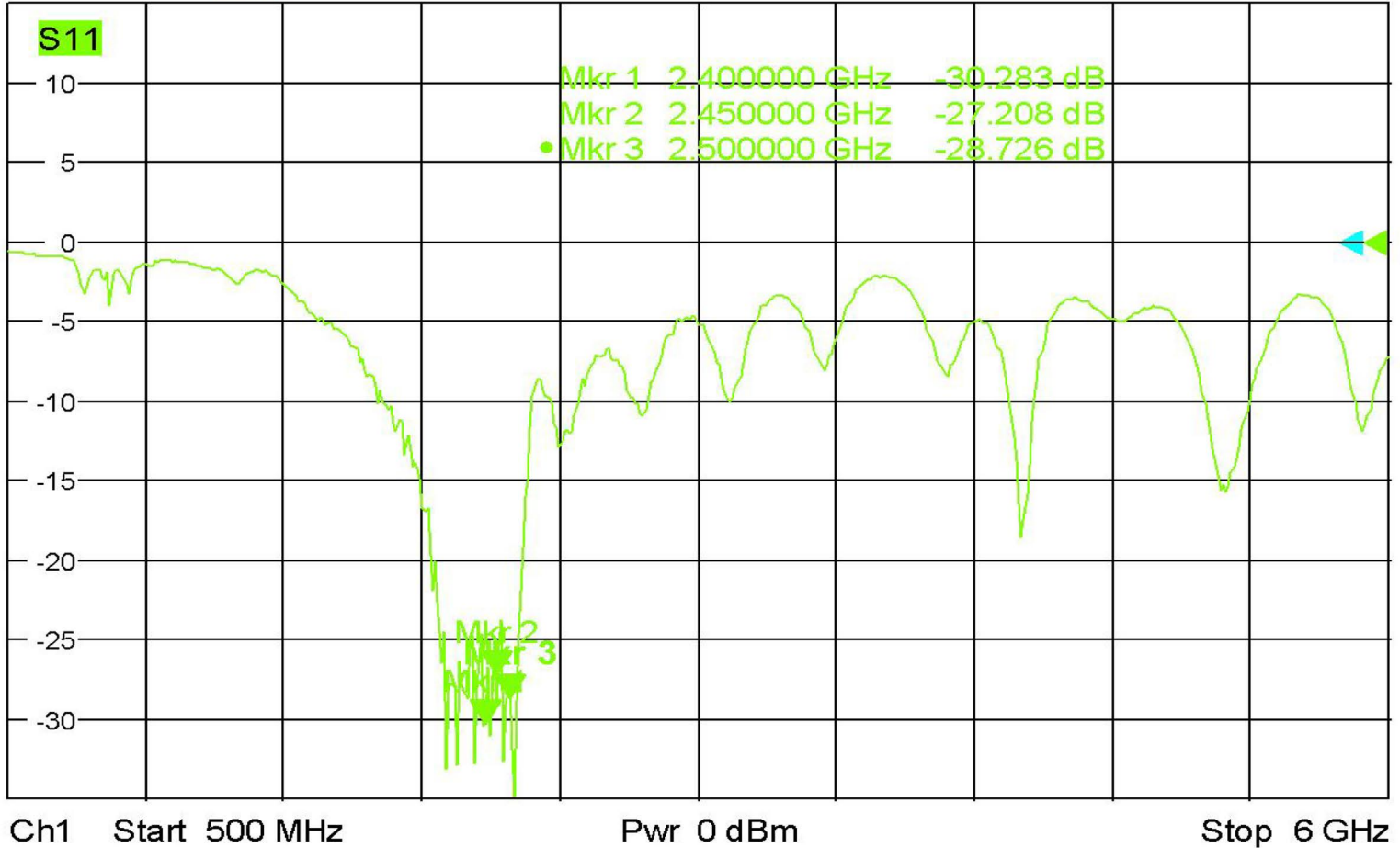

Trc1 S11 SWR 1 U / Ref 1 U Cal  
 Mem2[Trc1] S11 SWR 1 U / Ref 1 U Invisible

1

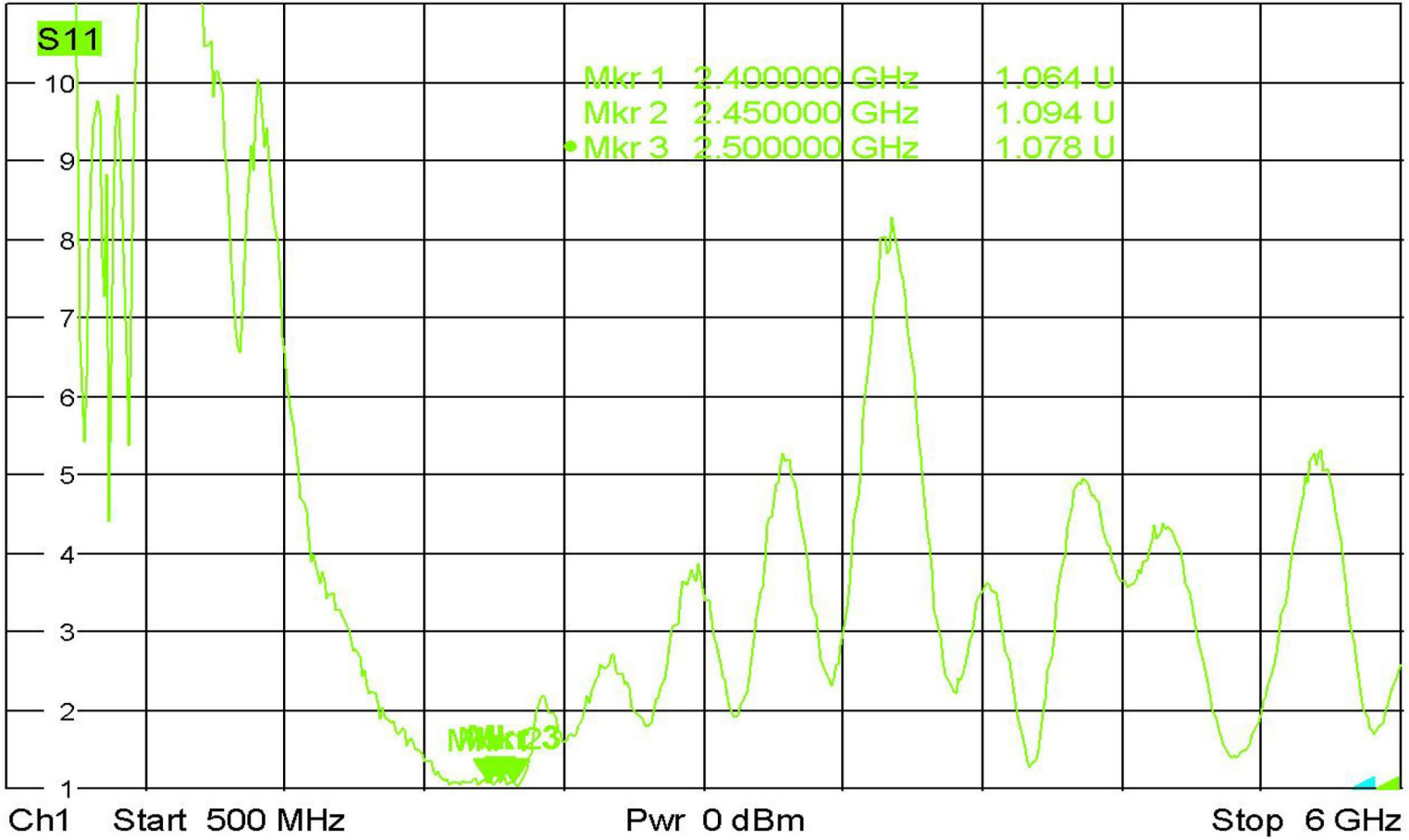

Date: 4.NOV.2009 13:22:20

PA-24-05

2.4-2.5G PANEL 14 dBi FOR N FEMALE

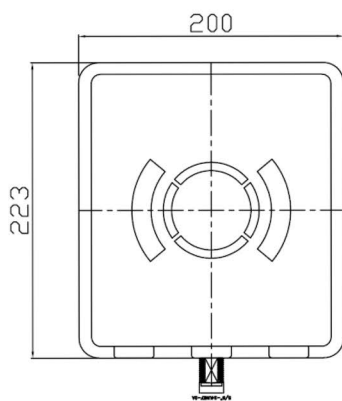

ANTENNA CONNECTOR : N FEMALE

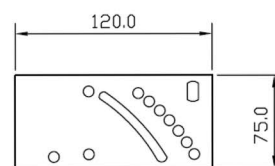
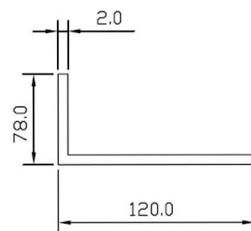
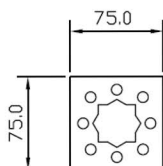
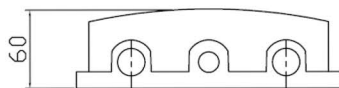

⊙ X4  
WASHER

⊙ X4  
NUT

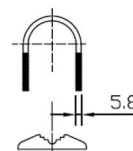
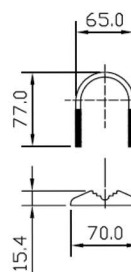

1	FREQUENCY RANGE : 2400-2500 MHz	8	Dimensions : L223XW200XH60mm
2	GAIN : 14 dBi	9	
3	VSWR : < 1.5 : 1	10	
4	IMPEDANCE : 50 Ω	11	
5	POLARIZATION : LINEAR VERTICAL	12	
6	Antenna Connector : N FEMALE	13	
7	Maximum Power : 100W		