

**The Cobra line of quality products includes:**

- CB Radios**
- Dash Cams**
- Radar Detectors**
- Marine VHF Radios**
- Power Inverters**
- Accessories**

[www.cobra.com](http://www.cobra.com)

# Cobra®

## CPP12000

### User Manual



**Portable Power - Anytime, Anywhere!**

Thank you for purchasing the Cobra CPP12000 JumPack™ XL portable jump starter PowerPack. Before using this product, please read these instructions carefully to learn about the features and capabilities of the JumPack XL and how to get the best performance.

**Note: Please charge your CPP12000 JumPack XL completely prior to using it for the first time.**

©2016 Cobra Electronics Corp. Part No. 480-1086-P Printed in China Version E

**IMPORTANT SAFETY INSTRUCTIONS**

**Charge the JumPack XL fully prior to use.**  
**Precautions when working with the JumPack XL:**

- ▲ WARNING:** Keep the unit clear of fire and water.
- ▲ WARNING: Shock Hazard.** Keep away from children. Do not insert foreign objects into the Jump Start Cable Input, the USB Output Port, or the Charge Adapter Input Jack. Do not expose this product to water, rain, snow, condensation, or spray. Do not open the JumPack XL to replace the internal battery. No user replaceable parts are inside the JumPack XL.
- ▲ WARNING: Explosion Hazard.** Do not use this product where there are flammable fumes or gases, such as an inadequately vented bilge of a boat, or near propane tanks. Do not use this product in an enclosure containing automotive-type lead-acid batteries.

The Jump Start Cable clamps must be connected positive to positive (red clamp to battery [+]) and negative to negative (black clamp to battery [-]).

- ▲ WARNING: Fire Hazard**  
 Do not crush or puncture the JumPack XL. Never allow the Jump Start Cable's red and black clamps' metal contacts to touch each other or another common metal conductor. This could cause damage to the unit and/or create a fire hazard. The jump start feature is designed only for starting vehicles, and Jump Start Cables must be disconnected from the vehicle's battery and from the JumPack XL once the vehicle starts.

When jump starting a vehicle with the JumPack XL, turn the ignition key for **no more than 3 seconds** at a time.

2

**Caution: Operating temperature**

Do not expose the JumPack XL to temperatures over +113° F (+45° C) or under -14° F (-10° C). Using the JumPack XL at high or low temperatures may reduce the internal battery capacity and shorten the battery life.

**Note:** In extreme cold weather conditions, please store the JumPack XL indoors for best results.

- ⚠** The JumPack XL is supplied with a rechargeable Li-Cobalt battery. This battery is self-contained and not consumer replaceable. Battery must be disposed of properly when it no longer holds a charge. Proper charging practices will increase the life of the batteries. For information on battery recycling call toll free 800-822-6837.

**Precautions when working with vehicle batteries:**

- ▲ WARNING: Explosion and fire hazard**
- 1. Follow all instructions published by the battery manufacturer and the manufacturer of the equipment in which the battery is installed.
- 2. Make sure the area around the battery is well-ventilated.
- 3. Never smoke or allow a spark or flame in the vicinity of the engine or batteries.
- 4. Be careful not to drop a metal object on the battery or allow a metal tool to simultaneously touch the positive and negative cable ends or battery terminals.
- 5. Remove personal metal items such as rings, bracelets, necklaces, and watches when working with batteries. Batteries produce a short-circuit current high enough to weld a ring or other similar objects to metal, causing a severe burn.
- 6. If you need to remove a battery, always remove the negative terminal from the battery first. Make sure all accessories are off to prevent causing a spark.
- 7. Someone should be within range of your voice, or close enough to come to your aid when you work near batteries.
- 8. Have plenty of fresh water, soap and a supply of baking soda on hand in the area of the batteries in case of contact with battery acid. Baking soda neutralizes lead acid battery electrolyte.

3

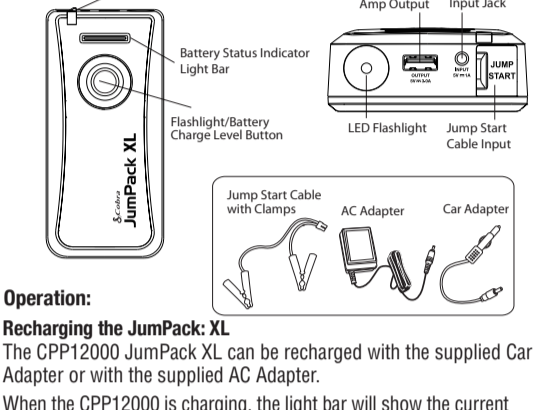

**Operation:**  
**Recharging the JumPack XL:**  
 The CPP12000 JumPack XL can be recharged with the supplied Car Adapter or with the supplied AC Adapter.

When the CPP12000 is charging, the light bar will show the current battery charge level. The last section of the light bar that is lit will blink to show that the JumPack XL is charging. When the JumPack XL is fully charged the light bar will turn off automatically.

For best battery performance the JumPack XL should be fully recharged every 3 months.



4

**Check Battery Charge Level:**

To check the battery charge level of the JumPack XL, press the button on the top of the unit with no device connected. The green light bar will show the remaining battery charge level:

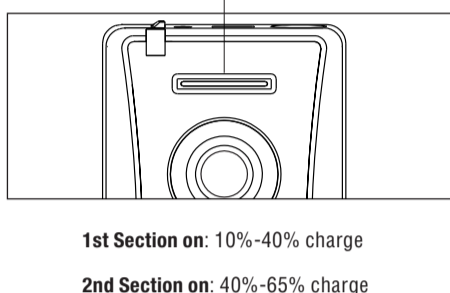

- 1st Section on:** 10%-40% charge
- 2nd Section on:** 40%-65% charge
- 3rd Section on:** 65%-85% charge
- 4th Section on:** 85%-100% charge

**Note:** When charging a device the section light may decrease because the JumPack XL cannot accurately measure the capacity during rapid charging. To confirm the actual battery charge level, disconnect the device being charged and press the Flashlight/Battery Charge Level Button.

5

**Tri-Color Jump Start Status LED:**

The Jump Start Status LED will illuminate and the color will change if the following conditions are present:

LED	CONDITION
Yellow	FAST FLASH - The JumPack XL is transferring charge to the vehicle's battery. WAIT for the LED to turn GREEN.
Green	The connection is correct. The JumPack XL is ready to help start your vehicle.
Red	FAST FLASH - Reverse polarity connection, or the vehicle battery is defective, or USB is shorted.
No LED	Connection not detected or low battery. Check the JumPack XL battery and verify the connection to the battery and the JumPack XL.
Red	FAST FLASH with GREEN LIGHT BAR - When the JumPack XL internal battery is nearly depleted the RED LED will flash and the first section of the GREEN LIGHT BAR will flash.
Yellow	SLOW FLASH - JumPack XL internal battery is too hot for a safe jump start attempt. Wait for the battery to cool down and the LED to turn green.

**NOTE:** The JumPack XL will make a clicking sound every 5 seconds. This is part of normal operation.

6

**Starting a Vehicle:**

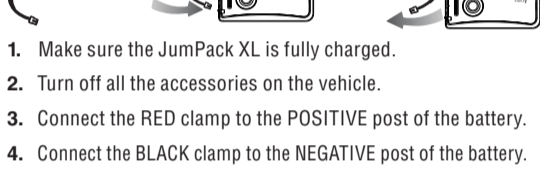

1. Make sure the JumPack XL is fully charged.
2. Turn off all the accessories on the vehicle.
3. Connect the RED clamp to the POSITIVE post of the battery.
4. Connect the BLACK clamp to the NEGATIVE post of the battery.
5. Connect the Jump Start Cable into the Jump Start Cable Input. Be sure that the plug is firmly pressed into the JumPack XL.
6. Check the Tricolor Jump Start Status LED. When the status is green the JumPack XL is ready to start the vehicle.
7. Turn the ignition key to start the vehicle. Do not crank the ignition for more than **3 SECONDS** at a time.
8. If the vehicle does not start on the first try, **WAIT FOR 1 MINUTE** before trying to start the vehicle again.

**NOTE:** If your vehicle does not start after 3 attempts, consult with a mechanic.

**If the engine starts:**

9. Immediately disconnect the Jump Start Cable from the JumPack XL, then from the battery posts.
10. Leave the engine running for at least twenty minutes to allow the vehicle's battery to recharge.

7

**Starting a Vehicle continued:**

**NOTES:** The JumPack XL is designed for gasoline and diesel powered passenger cars and light duty trucks in good working order and with batteries that are not damaged but require assistance commonly due to leaving lights on, cold temperature, sitting unused for limited periods of time.

The JumPack XL jump starter uses a special high current battery to provide up to 500 peak amps to start your engine. It can provide 300 amps starting current to jump start up to 3 cars on one charge. After this, the unit must be recharged.

The JumPack XL is intended to jump start a vehicle with a battery that is not completely discharged.

**Charging a 5V USB Device:**

To charge a 5V USB device, connect the device's cable to the JumPack XL's USB output.

The JumPack XL will turn on and start charging the device automatically. The green light bar will indicate the device is charging.

Once the device reaches its charge capacity and ceases charging, the light bar will turn off.



8

**LED Flashlight:**

Press the Flashlight/Battery/Charge Level Button for **3 seconds** to turn on the LED flashlight. Press again to activate the strobe function. Press again to activate the SOS function. Press again to turn Off.

**Product Features:**

- Lithium Cobalt rechargeable battery.
- 300 Amp Starting Current / 500 Amp Peak Current.
- 5V/3 Amp USB Output for rapid charging of portable devices.
- High Intensity work LED light, strobe and SOS.
- Rechargeable by car adapter, or 120 VAC Wall Adapter.

**Product Specification:**

- Li-Cobalt rechargeable battery: 11.1V/41.1Wh
- Size: 6.56" x 3.07" x 1.27" (165.1mm x 77.9mm x 32.25mm)
- Weight: 1 lb., 1.1 oz. (453.6g.)
- Recharge times: car or home - 4 hours
- Starting/Peak Current: 300 Amps/500 Amps
- USB Output: 5V, 3 Amps

9

**FCC Statement:**

This device complies with part 15 of the FCC Rules. Operation is subject to the following two conditions: (1) This device may not cause harmful interference, and (2) this device must accept any interference received, including interference that may cause undesired operation.

**Note:** This equipment has been tested and found to comply with the limits for a Class B digital device, pursuant to Part 15 of the FCC Rules. These limits are designed to provide reasonable protection against harmful interference in a residential installation. This equipment generates uses and can radiate radio frequency energy and, if not installed and used in accordance with the instructions, may cause harmful interference to radio communications. However, there is no guarantee that interference will not occur in a particular installation.

If this equipment does cause harmful interference to radio or television reception, which can be determined by turning the equipment off and on, the user is encouraged to try to correct the interference by one or more of the following measures:

- Reorient or relocate the receiving antenna.
- Increase the separation between the equipment and receiver.
- Connect the equipment into an outlet on a circuit different from that to which the receiver is connected.
- Consult the dealer or an experienced radio/television technician for help.

**WARNING:** Any modifications made to this device that are not expressly approved by party responsible for compliance could void the user's authority to operate this device.

Cobra® and the snake design are registered trademarks of Cobra Electronics Corporation, USA.

Cobra Electronics Corporation™ is a trademark of Cobra Electronics Corporation, USA.

PROPOSITION 65 WARNING: This product contains a chemical known to the State of California to cause cancer and birth defects or other reproductive harm.

10

**Limited 1-Year Warranty:**

**For Products Purchased in the U.S.A.**

Cobra Electronics Corporation warrants that its Cobra CPP12000 JumPack XL Charger, and the component parts thereof, will be free of defects in workmanship and materials for a period of one year from the date of first consumer purchase. This warranty may be enforced by the first consumer purchaser, provided that the product is utilized within the U.S.A. Cobra will, without charge, repair or replace, at its option, defective products or component parts within the warranty period upon delivery to the Cobra Factory Service Department, accompanied by a proof of the date of first consumer purchase, such as a duplicated copy of sales receipt. You must pay any initial shipping charges required to ship the product for warranty service, but the return charges will be at Cobra's expense, if the product is repaired. This warranty gives you specific rights, and you may also have other rights which vary from state to state.

**Exclusions:** This limited warranty does not apply:  
 1. To any product damaged by accident.  
 2. In the event of misuse or abuse of the product, or as a result of unauthorized alterations or repairs.  
 3. If the serial number has been altered, defaced or removed.  
 4. If the owner of the product resides outside the U.S.A.

All implied warranties, including warranties of merchantability and fitness for a particular purpose are limited in duration to the length of this warranty.

Cobra shall not be liable for any incidental, consequential or other damages; including, without limitation, damages resulting from loss of use or cost of installation.

Some states do not allow limitations on how long an implied warranty lasts and/or do not allow the exclusion or limitation of incidental or consequential damages, so the above limitations may not apply to you.

**For Products Purchased Outside The U.S.A.**  
 Please contact your local dealer for warranty information.

11

**Product Service:**

For any questions about operating or installing this new Cobra product, or if parts are missing, **PLEASE CALL COBRA FIRST**...do not return this product to the store. If this product should require factory service, please call Cobra before sending the product. This will ensure the fastest turn-around time on any repair. If Cobra asks that the product be sent to its factory, the following must be furnished to have the product serviced and returned:

1. For Warranty Repair include some form of proof-of-purchase, such as a mechanical reproduction or carbon of a sales receipt. Make sure the date of purchase and product model number are clearly readable. If the originals are sent, they cannot be returned;
2. Send the entire product;
3. Enclose a description of what is happening with the product. Include a typed or clearly printed name and address of where the product is to be returned, with phone number (required for shipment);
4. Pack product securely to prevent damage in transit. If possible, use the original packing material;
5. Ship prepaid and insured by way of a traceable carrier such as United Parcel Service (UPS) or Priority Mail with delivery confirmation to avoid loss in transit to: Cobra Factory Service, Cobra Electronics Corporation, 6500 West Cortland Street, Chicago, Illinois 60707 U.S.A.;

6. If the product is in warranty, upon receipt of the product it will either be repaired or exchanged depending on the model. Please allow approximately 3 - 4 weeks before contacting Cobra for status. If the product is out of warranty, a letter will automatically be sent with information as to the repair charge or replacement charge.

For any questions, please call 773-889-3087 for assistance or visit us online at [www.cobra.com](http://www.cobra.com).

12

**Customer Support & Trademarks:**

**Customer Support**

Should there be any problems with this product or further information needed on its features please visit [www.cobra.com](http://www.cobra.com) for support, frequently asked questions, Declarations of Conformity, and the electronic manual.

**Waste Electrical and Electronic Equipment Information**  
 This product has required the extraction and use of natural resources for its production. It may contain hazardous substances that could impact health and the environment, if not properly disposed. In order to avoid the dissemination of those substances in our environment and to diminish the pressure on the natural resources, we encourage you to use the appropriate take-back systems for product disposal. Those systems will reuse or recycle most of the materials of the product you are disposing in a sound way.

The crossed out wheeled bin symbol informs you that the product should not be disposed of along with municipal waste and invites you to use the appropriate separate take-back systems for product disposal.

If you need more information on the collection, reuse and recycling systems, please contact your local or regional waste administration. You may also contact your supplier for more information on the environmental performances of this product.

**The product label is located on the bottom of the unit.**

**Trademark Statement**  
 Cobra, JumPack and the snake design are proprietary trademarks of Cobra Electronics Corporation, USA.



13

**NOTES**

**NOTES**