

ALUMINUM SKID PLATE INSTALLATION MANUAL

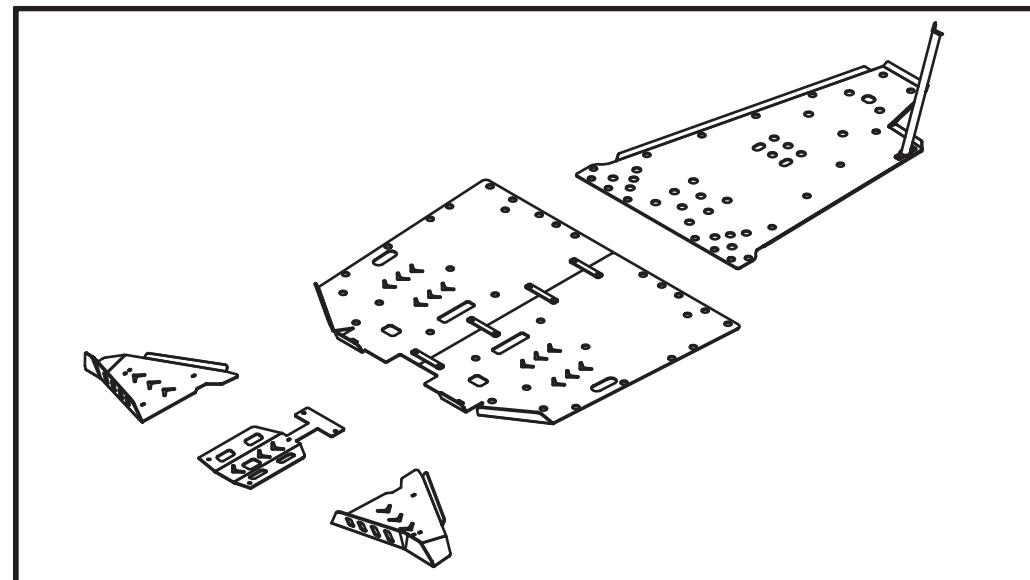

For technical support , please write us to:
info@afxmotorsports.com or call us at:
Ph. 956-242-6521

HAVE FUN AND A SAFE RIDE!

CAN AM MAVERICK X3 / XDS / XRS

SKU SKI102

THANK YOU!

FOR PURCHASING AT AF1 MOTORSPORTS



ALUMINUM SKID PLATE & ROCK SLIDERS FOR CAN AM X3 2 SEATER

HOW TO INSTALL

Pieces included:

- Aluminum Rear Plate (A).
- Steel Tube for Rear Plate (B).
- (18x) Special Washers (E).
- (18x) 1/4" x 3/4" thread cutting bolts.
- (2x) 1/4" x 1" Bolts with washers and nuts.
- (1x) 5/16" x 2 1/2" Bolt with washer and nut.
- Main Aluminum Plate (2 Parts) (C).
- (4x) Brackets for Frame Plate (F).
- (28x) Special Washers (E).
- (28x) 1/4" x 3/4" thread cutting bolts.
- (8x) 1/4" x 1" Bolts with washers and nuts.
- Aluminum Front Plate (D).
- (4x) Special Washers (E).
- (4x) 1/4" x 3/4" thread cutting bolts.
- (1x) 3/16" Drill Bit.
- (1x) 3/8" Socket.

Tools needed (Not Included):

- 7/32" Allen Key.
- 9/16" or 14 mm Combination Wrench.
- 3/16" Drill Bit.
- 1/4" Drill Bit.
- Drill.

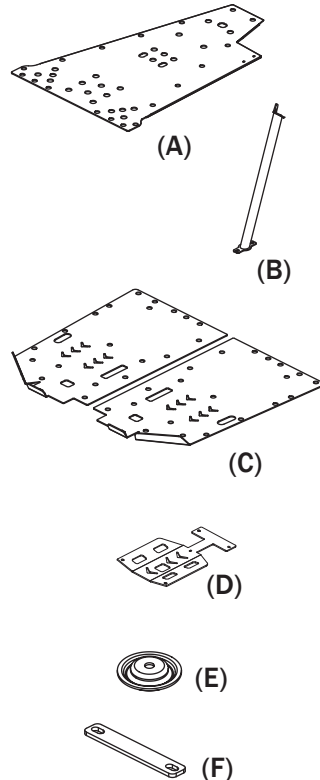

9

Place the Rear Tube for the Aluminum Rear Plate and fasten it using two 1/4" x 1" bolts with washers and nuts (Included). Don't tight them yet. Fasten the upper part of the tube with a 5/16" x 2 1/2" bolt with washer and nut (Included) to the tube of the chassis of the car using the original perforation.

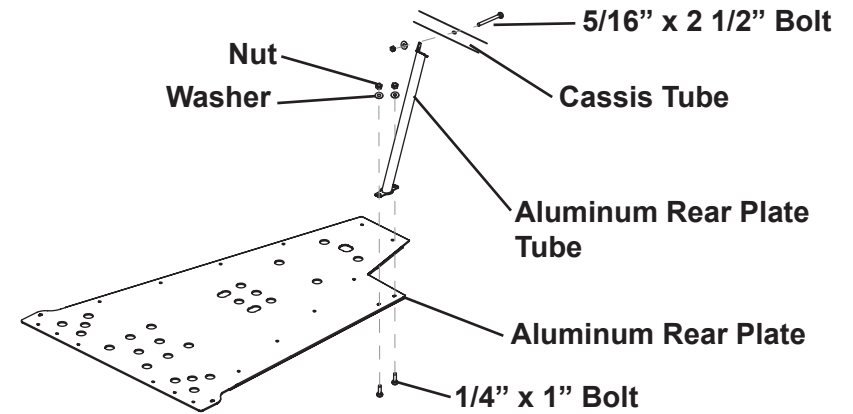

Figure 7.

10

Now your have completed the installation of the Aluminum Rear Plate, Frame Plate and Front Plate.

Liability Statement

AFX Motorsports products are designed to best fit user's ATV/UTV under stock conditions. Adding, modifying, or fabricating any factory or aftermarket parts will void any warranty provided by AFX Motorsports and is not recommended. AFX Motorsports products could interfere with other aftermarket accessories. If user has aftermarket products on machine, contact AFX Motorsports to verify that they will work together. Although AFX Motorsports has thousands of satisfied customers, user should be aware that installing bumpers, rock sliders, spare tire carriers, etc. will change the ride of machine and may increase maintenance and part wear. Operating any off-road machine while, or after, consuming alcohol and/or drugs increases risk of bodily harm or death. No warranty or representation is made as to this product's ability to protect user from severe injury or death. AFX Motorsports urges operators and occupants to wear a helmet and appropriate riding gear at all times. By purchasing and installing AFX Motorsports products, user agrees that should damages occur, AFX Motorsports will not be held responsible for loss of time, use, labor fees, replacement parts, or freight charges. AFX Motorsports, nor any 3rd party, will not be held responsible for any direct, indirect, incidental, special, or consequential damages that result from any product purchased from AFX Motorsports. The total liability of seller to user for all damages, losses, and causes of action, if any, shall not exceed the total purchase price paid for the product that gave rise to the claim. AFX Motorsports will warranty only parts provided by AFX Motorsports. Any damage or problems with OEM housings, bearings, seals, or other manufacturers' products will not be covered by AFX Motorsports. AFX Motorsports parts and products are not warrantied if item was not installed properly, misused, or modified.

7 Place the Aluminum Front Plate on the car and install it using 4 of the special washers provided and the provided 1/4" x 3/4" screws (See Figure 2) . For this, use a 3/8" socket (provided) to install each bolt (See Figure 4). Tighten the 1/4" bolts manually using a 3/8" socket.

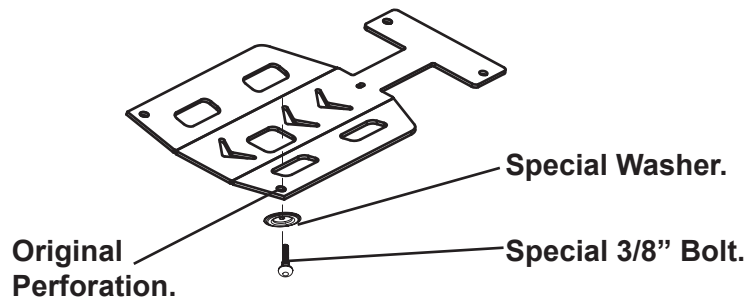

8 Tighten all the bolts on the Aluminum Frame and Rear Plates manually using a 3/8" socket.

NOTE: THE SKID PLATE INSTALLATION MUST BE MADE STARTING FROM THE REAR PART OF THE VEHICLE.

NOTE: IN CASE OF HAVING PURCHASED ALUMINUM ROCK SLIDERS, WE RECOMMEND TO INSTALL THE ALUMINUM ROCK SLIDERS BEFORE INSTALLING THE SKID PLATE.

1 Remove the rivets of the OEM Plastic Skid Plate and uninstall the OEM Plastic Protector.

2 Using a drill, pass a 3/16" drill bit (Included) on the holes were the rivets were located to increase these perforations to 3/16". Do not pass the drill bit trough all the tube.

3 Place the Rear Aluminum Plate on the car and install it using the special washers provided and the provided 1/4" x 3/4" screws. (See Figure 2) For this, use a 3/8" socket (provided) to install each bolt (See Figure 1). Do not tighten yet.

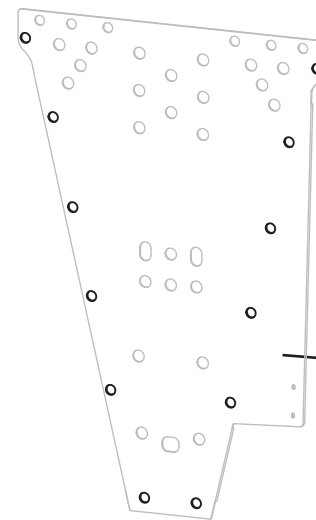

Install the special washers on the perforations marked in the image.

This face down.



Rear Aluminum Plate.
Figure 1.

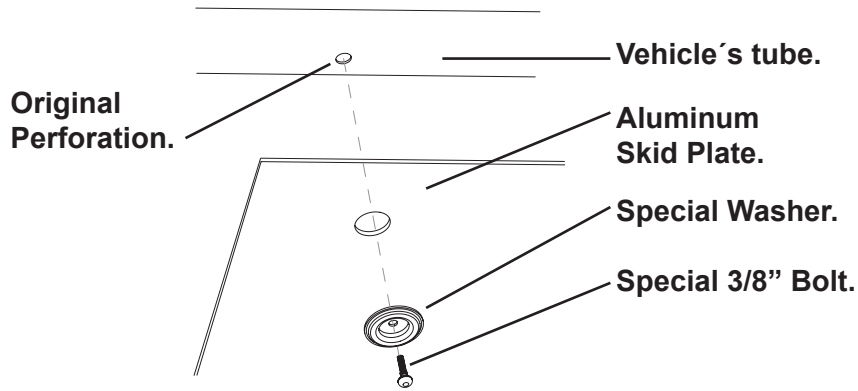

Figure 2.

4 Install the 4 brackets to join the two parts of the Aluminum Frame Plate. Use eight 1/4" x 1" Bolts with washers and nuts (Included). Use the provided 5/16" holes.

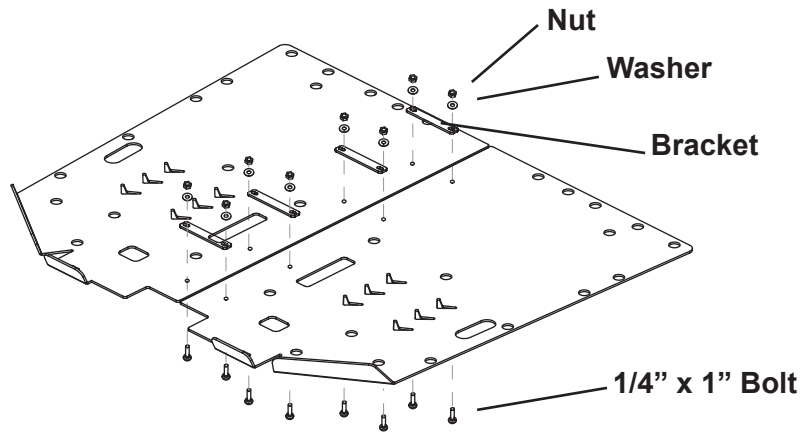
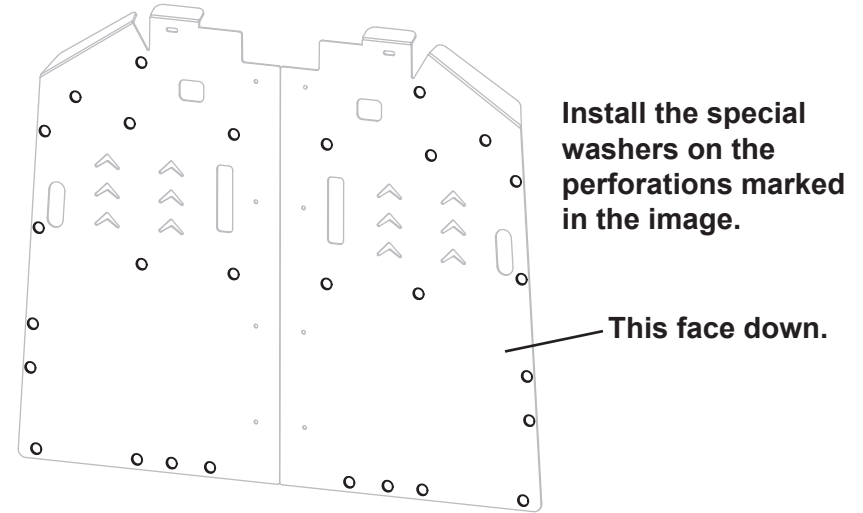

Figure 3.

5 Place the Main Aluminum Plate on the car and install it using the special washers provided and the provided 1/4" x 3/16" screws. For this, use a 3/8" socket (provided) to install each bolt. Do not tighten yet.



Rear Aluminum Plate.
Figure 4.

- (28x) Special Washers with Bolts needed.**

6 Place the Aluminum Front Plate on the car and install it using 4 of the special washers provided and the provided 1/4" x 3/4" screws (See Figure 2) . For this, use a 3/8" socket (provided) to install each bolt (See Figure 4). Tighten the 1/4" bolts manually using a 3/8" socket.

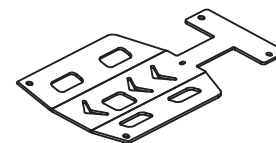

- (4x) Special Washers with Bolts needed.**