

# J.S.T.MEDICAL

MEDICAL + DENTAL + VETERINARY

## MELACONNECT FUNCTION AND FEATURES.

The MELAconnect App allows you to monitor the status and program progress of multiple devices from anywhere in a practice/clinic. The MELAconnect App also has additional features such as user manuals, YouTube tutorials, a troubleshooting tool and seal check documentation storage. The MELAconnect App can be downloaded on your mobile device via the App Store on Apple devices or Google Play for Android.

### Connecting to the MELAconnect App.

***Before you can connect the autoclave to the MELAconnect App, it must first be networked to the practice/clinics server via TCP or FTP server. The practice/clinic server must have WIFI capabilities for your mobile device to connect to. The autoclave must also have firmware Release Version V3.241 or higher.***

1. Download the MELAconnect App on your mobile device and connect your mobile device to the practice/clinic WIFI.
2. Turn on the autoclave and go to the settings menu. Navigate to the second page and select connectivity. Select MELAconnect. This will give you the QR code and IP address needed for connection.

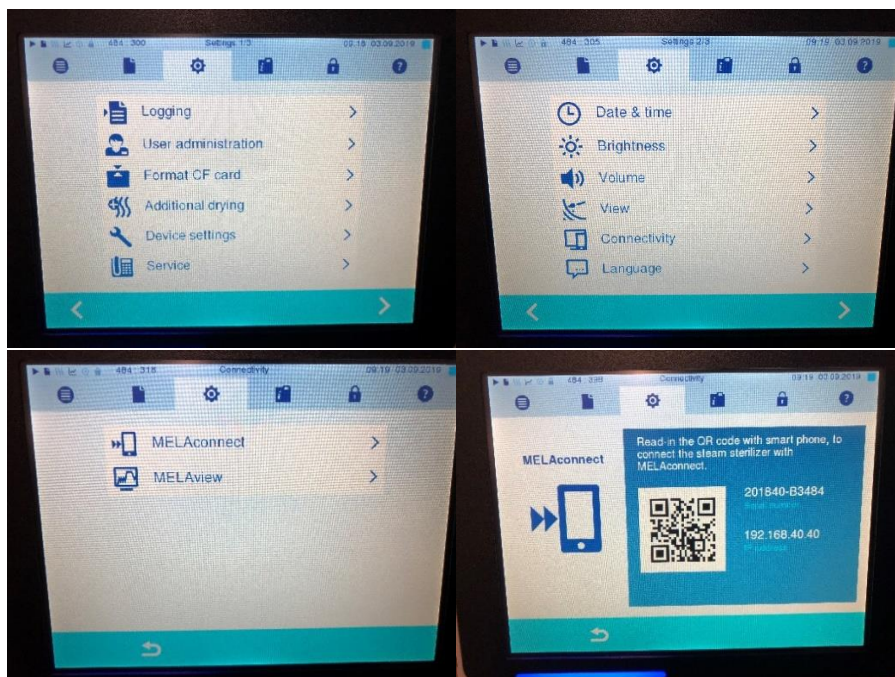

- Open the MELAconnect App and add the autoclave by either pressing on the “+” symbol or “add new device”. Select “add device manually” and then select “Premium-Class Evolution/Cliniclave 45”.

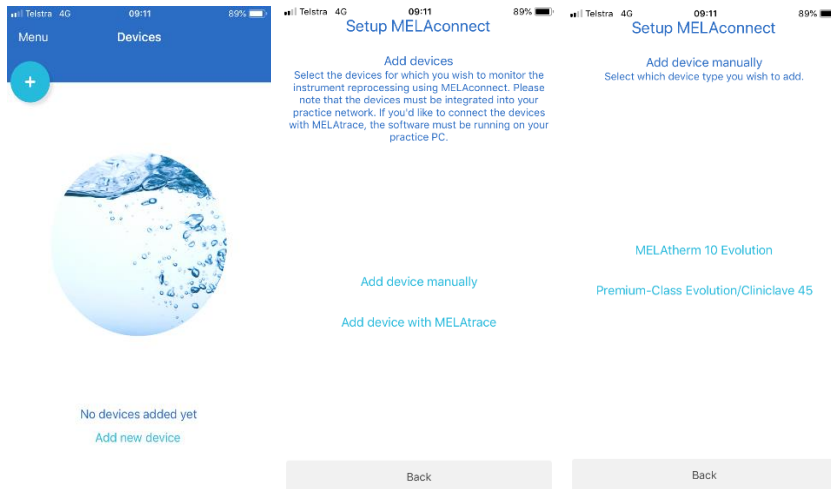

- From this point, you can either use the camera on your mobile device to scan the QR code or enter the IP address manually.

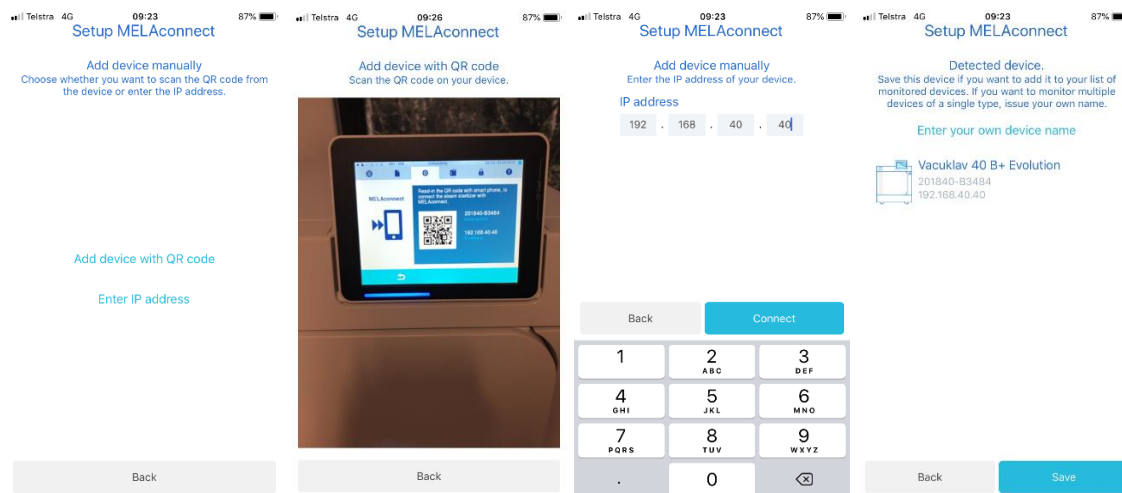

- Once properly connected, the autoclave will appear in the device list.

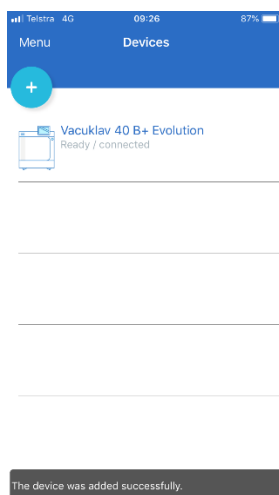

## Monitoring the Cycle.

With the autoclave now connected to the MELAconnect App, you can now remotely monitor the progress of the connected device. After the cycle has begun, the MELAconnect App will display the progressing stages and remaining minutes, until the completion of the cycle.

The image displays three screenshots of the MELAconnect App interface. The first two screenshots show the 'Quick-Program B' screen with circular progress indicators. The first shows 22 minutes remaining at 100 °C and 0.00 bar. The second shows 7 minutes remaining at 135 °C and 2.12 bar. The third screenshot shows a green checkmark and the text 'Program finished'. Below these are two screenshots of a malfunction alert for 'Malfuction 113' (sic) with a red warning triangle and the text: 'Power failure! Was autoclave possibly switched off at mains switch? Do not terminate a running program by switching off at the mains switch. Only cancel a program using "CANCEL"'. A 'Solve problem' button is visible at the bottom.

If the cycle malfunctions during operation, an alert with the malfunction number will be displayed. Along with the malfunction number, there will also be a description of the fault and step to take to troubleshoot the fault.

For battery saving purposes, the MELAconnect App does not run in the background of the mobile device it is installed on, so no alert will be given unless the App is open on the device.

## Navigating the Menu.

The menu will give you access the additional features like the troubleshooting tool, YouTube tutorials and user manuals.

The image shows four screenshots of the MELAconnect App. The first is a side menu with options: Devices, Support, Troubleshooting, Tutorials, User manuals, Routine check, Seal Checks, MELAconnect, Settings, Contact, Imprint, and Privacy Policy. The second screenshot shows the 'Troubleshooting' screen with a search bar and a list of error codes (102-112) and their descriptions. The third screenshot shows the 'Tutorials' screen with a list of video tutorials for MELAtherm 10. The fourth screenshot shows the 'User manuals' screen with a list of available online manuals for various models.

- The troubleshooting tool works with a simple search bar operation. By entering the malfunction number and the device type, it will take you directly to the information and troubleshooting options available for the entered malfunction.
- The tutorial videos available on the App cover things like the correct loading procedures and operation of the MELAtherm 10.
- The user manuals for the Premium Plus Evolution and Cliniclave 45 series, can be downloaded on the MELAconnect App. Once the manuals have been downloaded, they can be accessed at any time on your mobile device.

### Seal Check Document Storage.

The MELAconnect App allows you to document and store the seal checks for your sealing device. The App will access your mobile devices camera to document the seal check and then store the image file in a folder that can be accessed at any time. The image file of the seal check, is recorded with the time and date of when it was created, along with the sealing device, device location, who approved the seal check and any comments.

Please follow the link below for a brief video on how to use the seal check document storage.



<https://www.youtube.com/watch?v=qA-dlvTFaF0>

For technical assistance please contact James on 021667987 or email [info@jstmedical.co.nz](mailto:info@jstmedical.co.nz)

# J.S.T. MEDICAL

MEDICAL + DENTAL + VETERINARY

MELAG