

TREDPRO MOUNT



Loosen the tamper proof T30 torques on the forth rail from the end



Adjust the rail so it is 35in center to center on the slot in the track



Slide the 2 large nut plates in the the front track



Slide the 2 smaller nut plates in the the rear track



Position the like this on the rack



WARNING !

We use stainless steel hardware but when cross threaded or over tightened the bolts will gall. Please take your time and lubricate the bolt before install.



Use the inner two holes on the support at the rear.



Do not use the center hole on the support for the front mount.



Install the hardware as shown

TRED PRO MOUNT

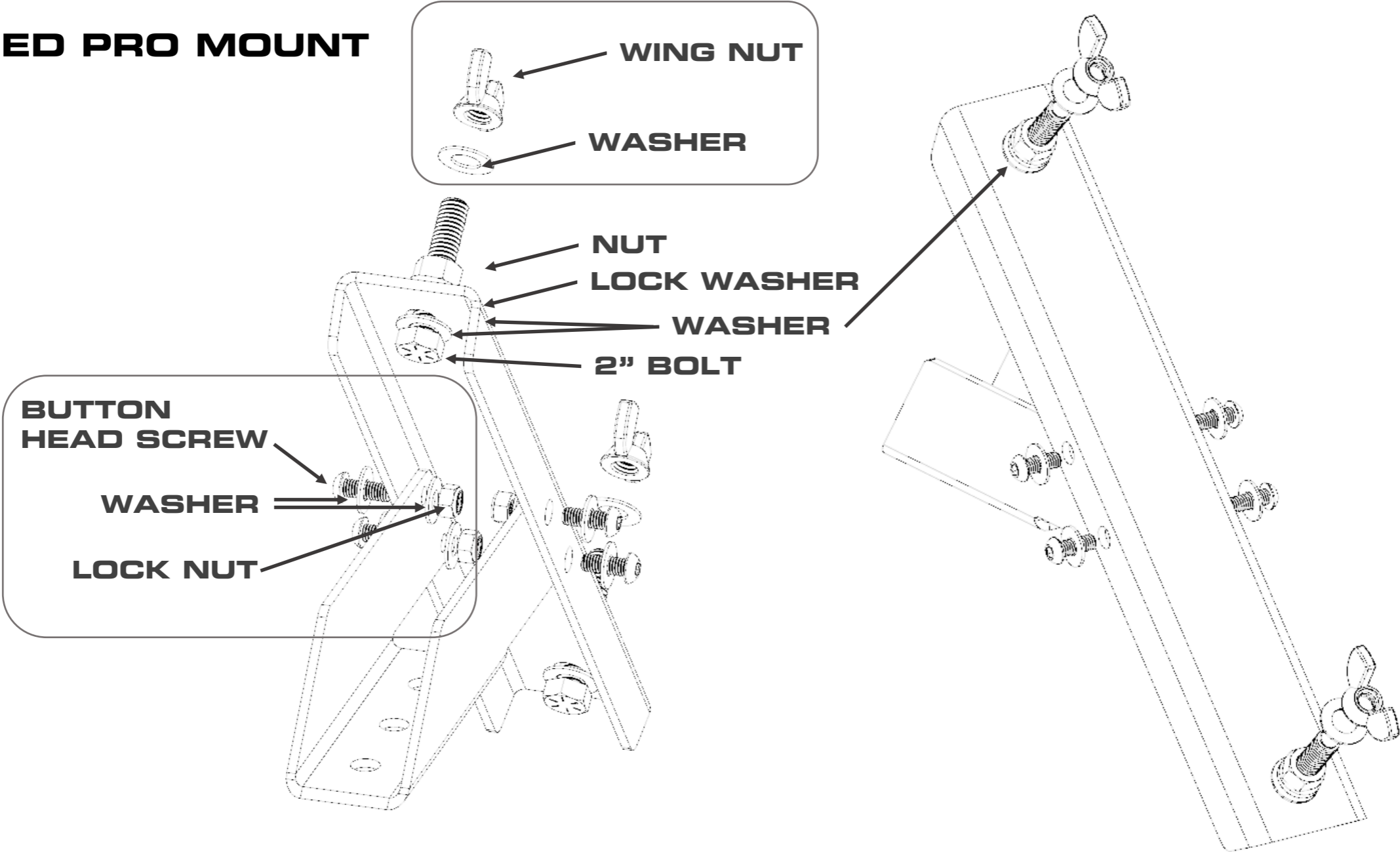

Mount the Treds and you are all set!

