



KIA FORTE SEDAN 2019

INSTALLATION MANUAL

REAR DECK SPOILER
AD PART #: KI05D09

**READ CAREFULLY
BEFORE INSTALLATION**

**WASH BEFORE
INSTALLING**

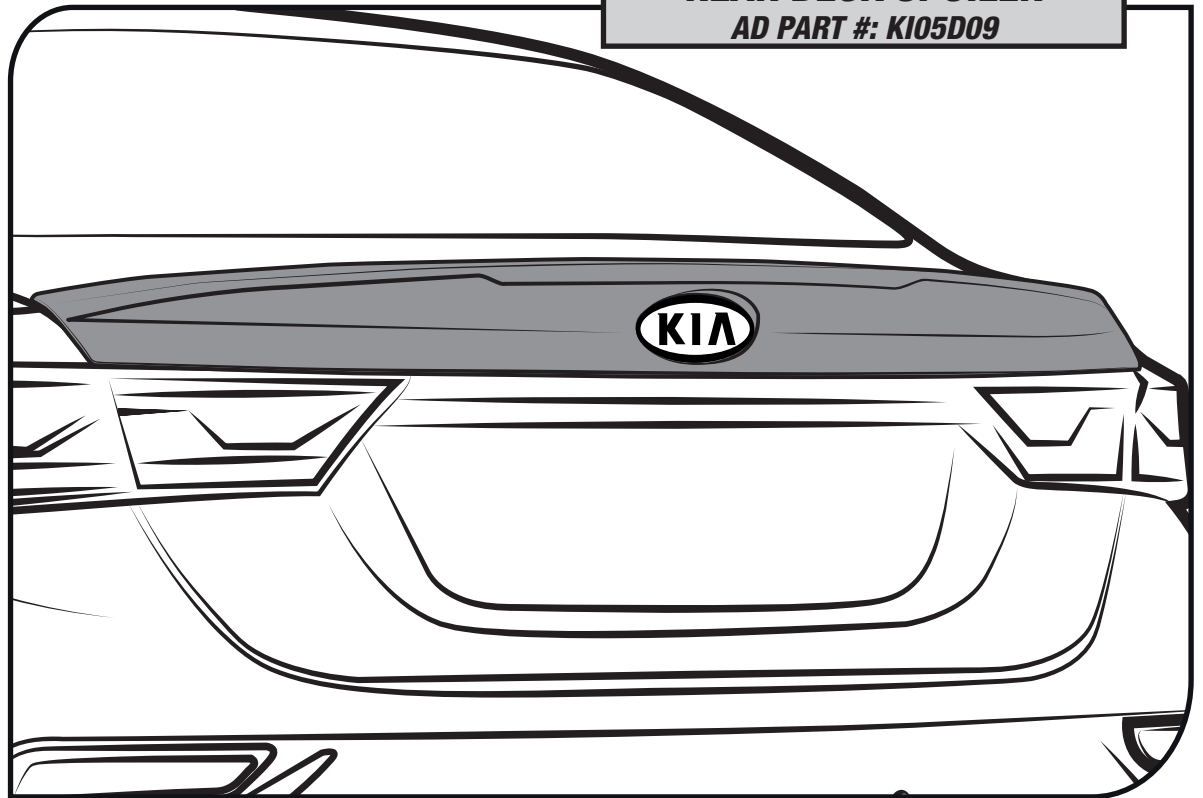



**WE RECOMMEND
2 PERSONS FOR
INSTALLATION**

AFTER INSTALLING
DO NOT WASH CAR

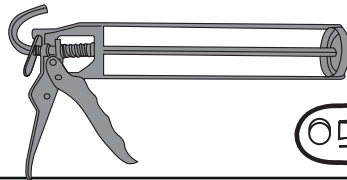

24 hrs

TOOLS



CHECK LIST

***ALREADY INSTALLED ON THE PART**

ITEM	DESCRIPTION	DRAWING	AMOUNT
A	*VHB TAPE		N/A
B	POLYURETHANE ADHESIVE 100 ml		1 PC



KIA FORTE SEDAN 2019

INSTALLATION MANUAL

The ideal temperature range of the part and the vehicle when installing must be 16°C (60°F) to 40°C (104°F), this guarantees a correct assembly.

1 CLEAN THE INSTALLATION ZONE

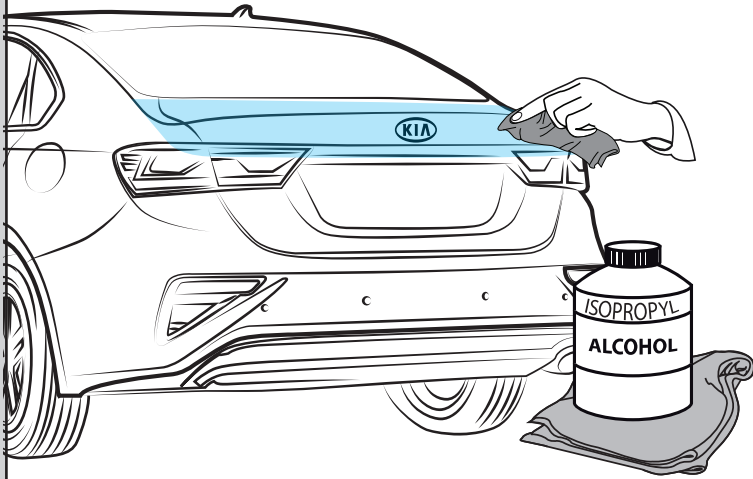

2 TEST FIT THE REAR DECK SPOILER

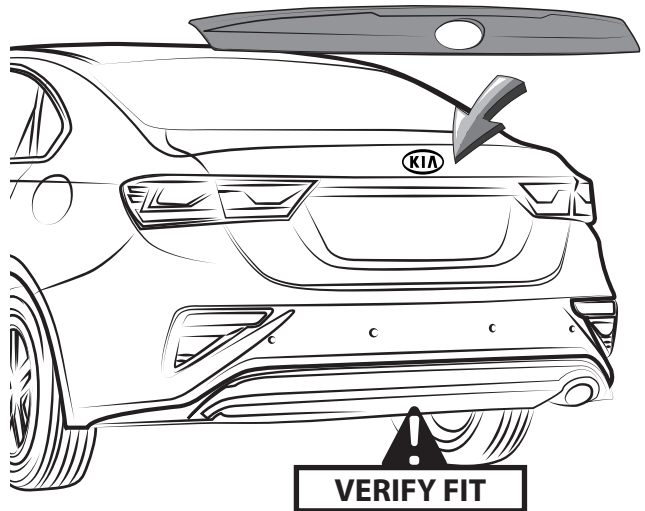

3 MARK

DRAW CENTER HASH MARK WITH MARK ON SHEET METAL, THIS WILL ENSURE PART WILL BE CENTERED TO MARK OUTLINE.

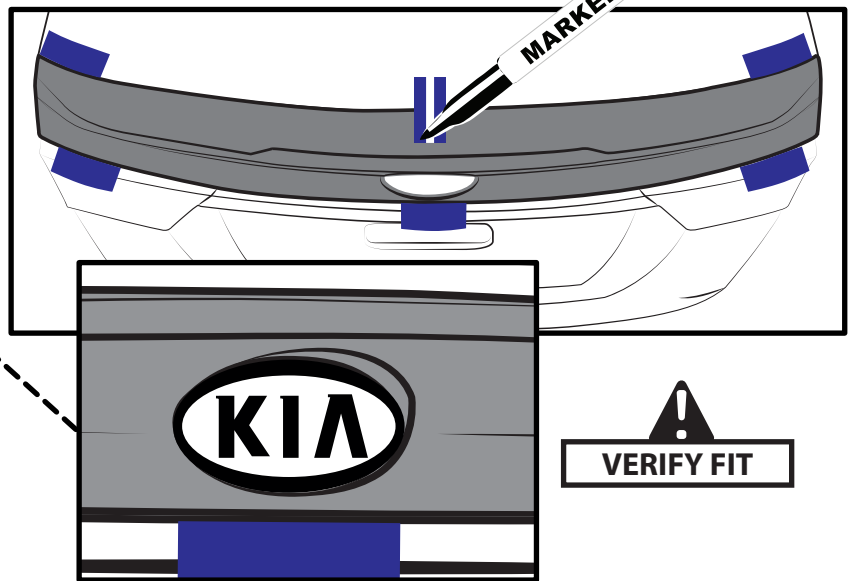
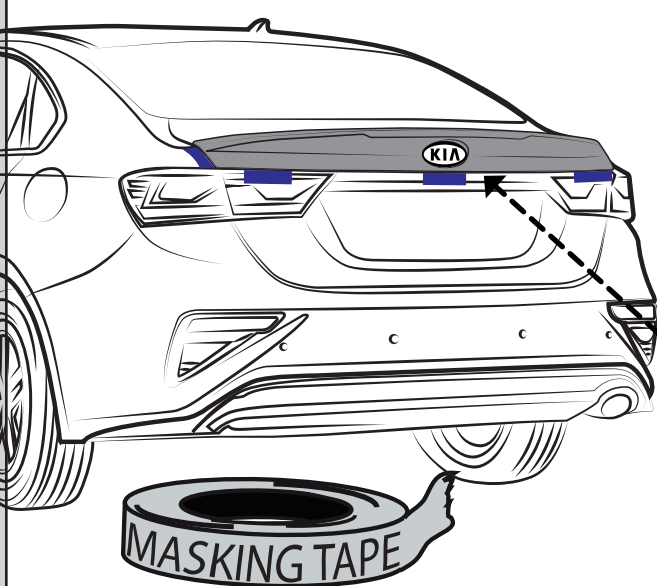

4 REMOVE THE REAR DECK SPOILER

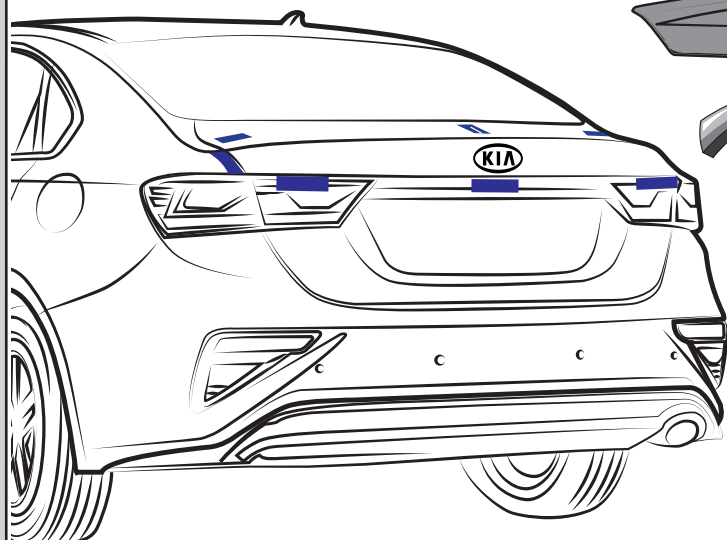

INSTALLATION MANUAL

5 CLEAN ADHESIVE CHANNEL

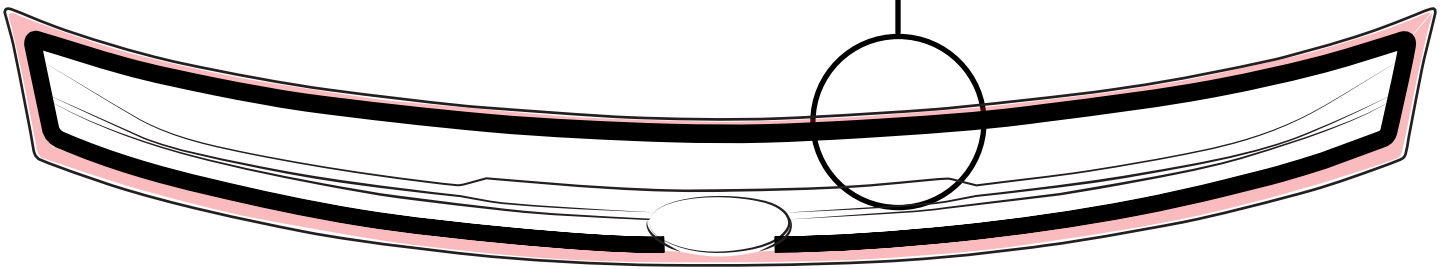
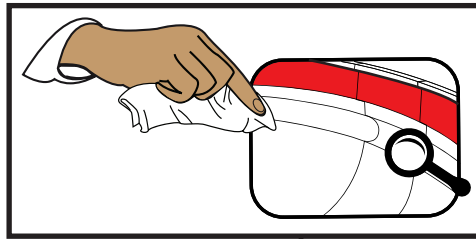

6 PEEL THE LINER LEADS

STICK THE LINER LEAD ON THE OUTSIDE

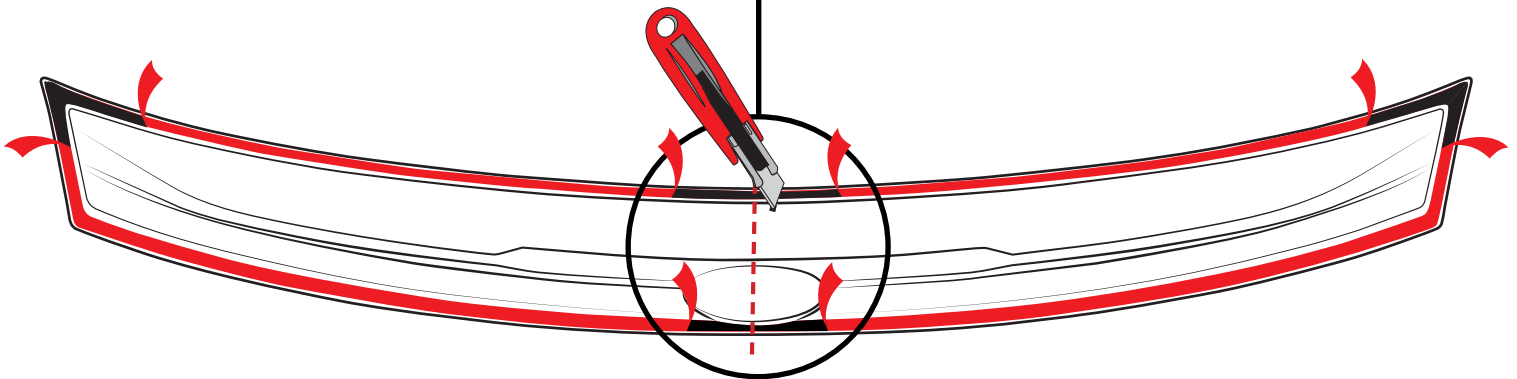
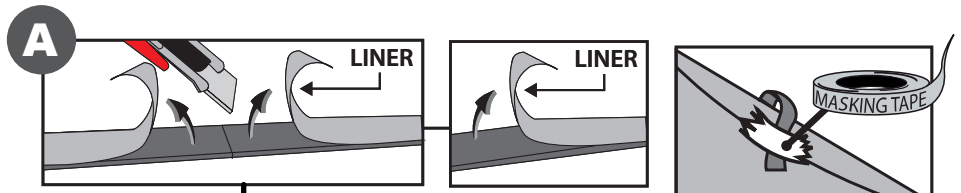

7 APPLY POLYURETHANE ADHESIVE

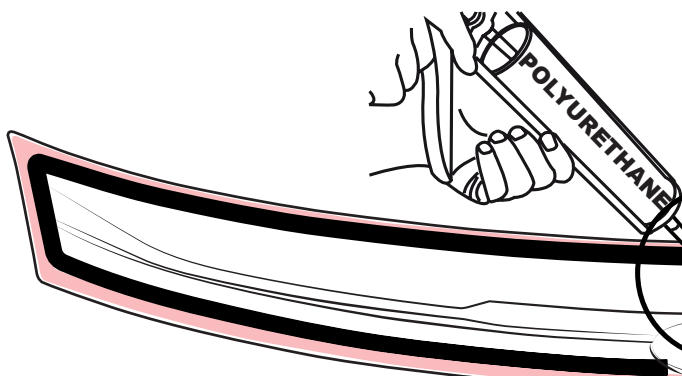
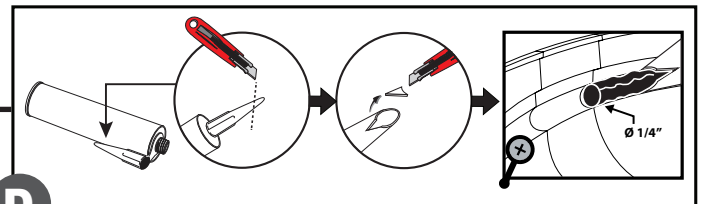



8 PLACE THE REAR DECK SPOILER

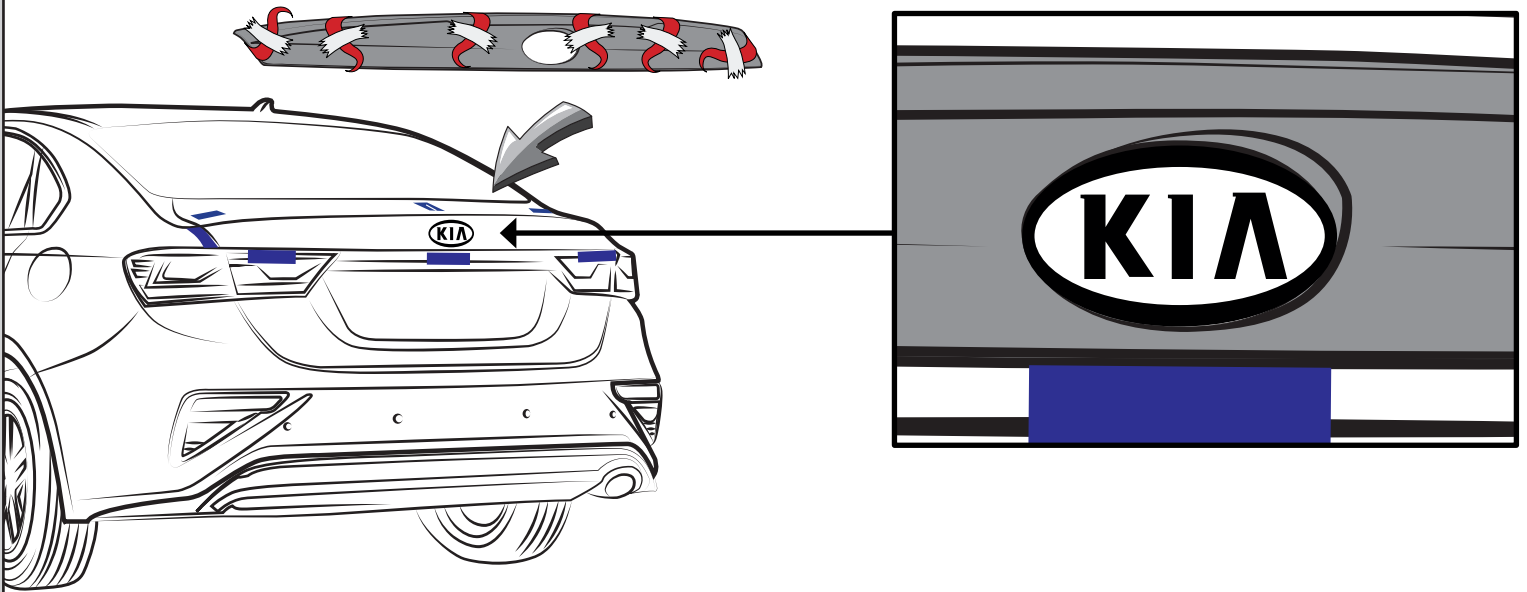

9 REMOVE THE LINER AND PRESS

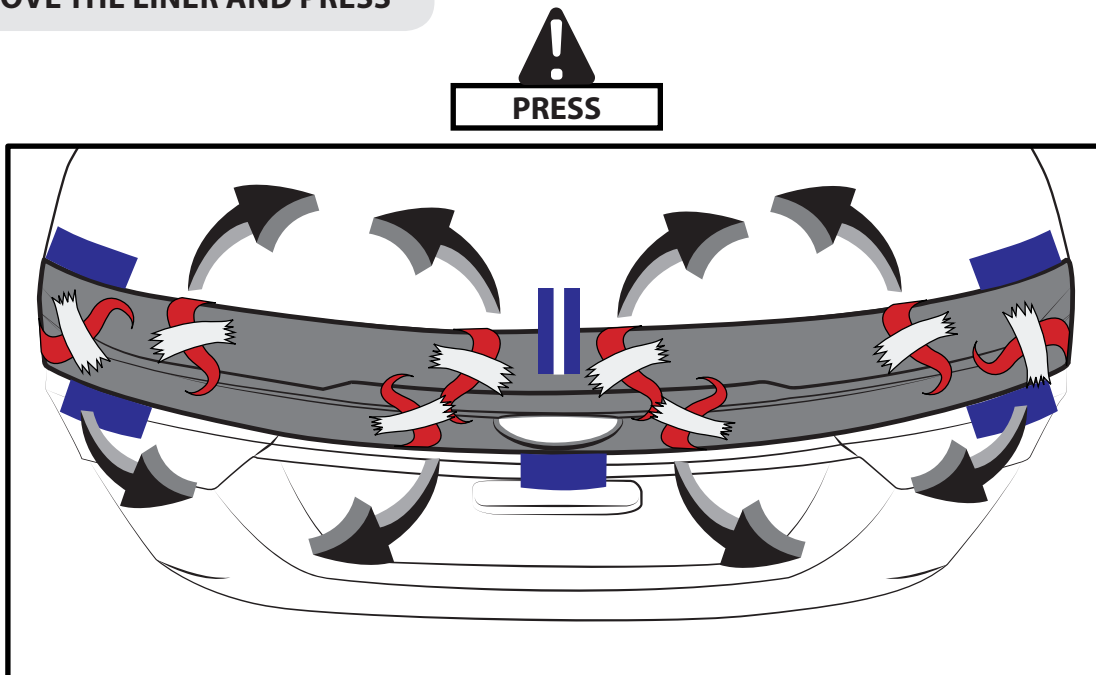

10 PRESS FIRMLY

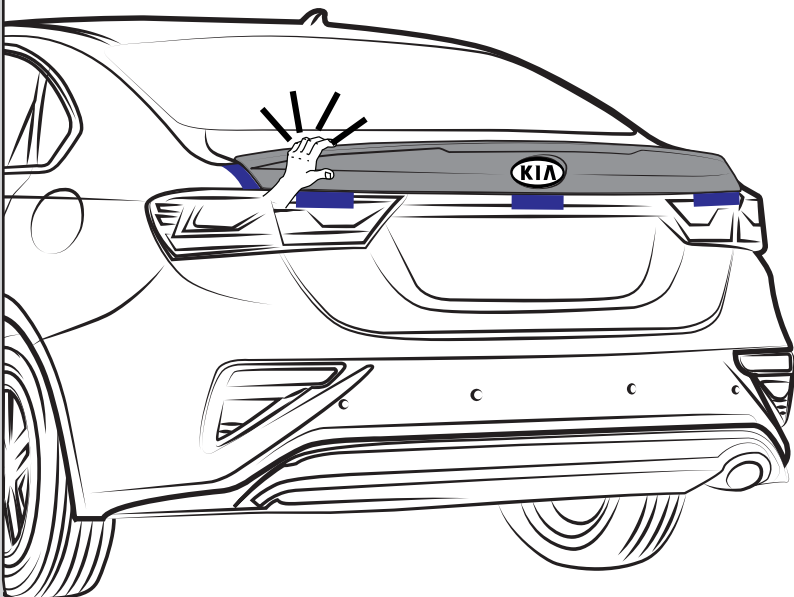

FULL AND COMPLETE CONTACT BETWEEN TAPE AND VEHICLE SURFACE IS CRUCIAL FOR GOOD ADHESION PERFORMANCE!
TAPE IS PRESSURE AND TEMPERATURE SENSITIVE!
PROPER CONTACT IS ACHIEVED BY APPLYING A PRESSURE BETWEEN 40 AND 50 N/CM². TAPE AND VEHICLE SURFACES SHOULD BE THE SAME TEMPERATURE AND MUST BE AT LEAST 60°F (25°F) DURING INSTALLATION!



INSTALLATION MANUAL

11 CLEAN

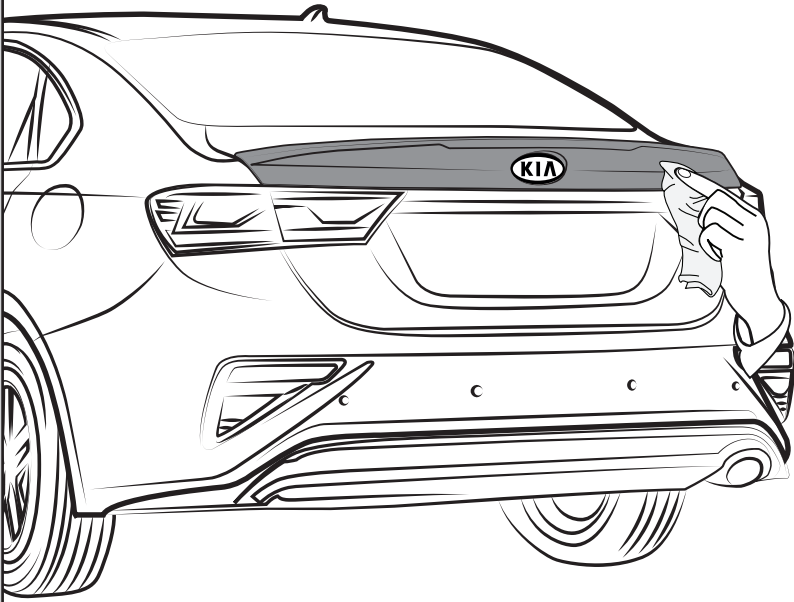

REMOVE MASKING

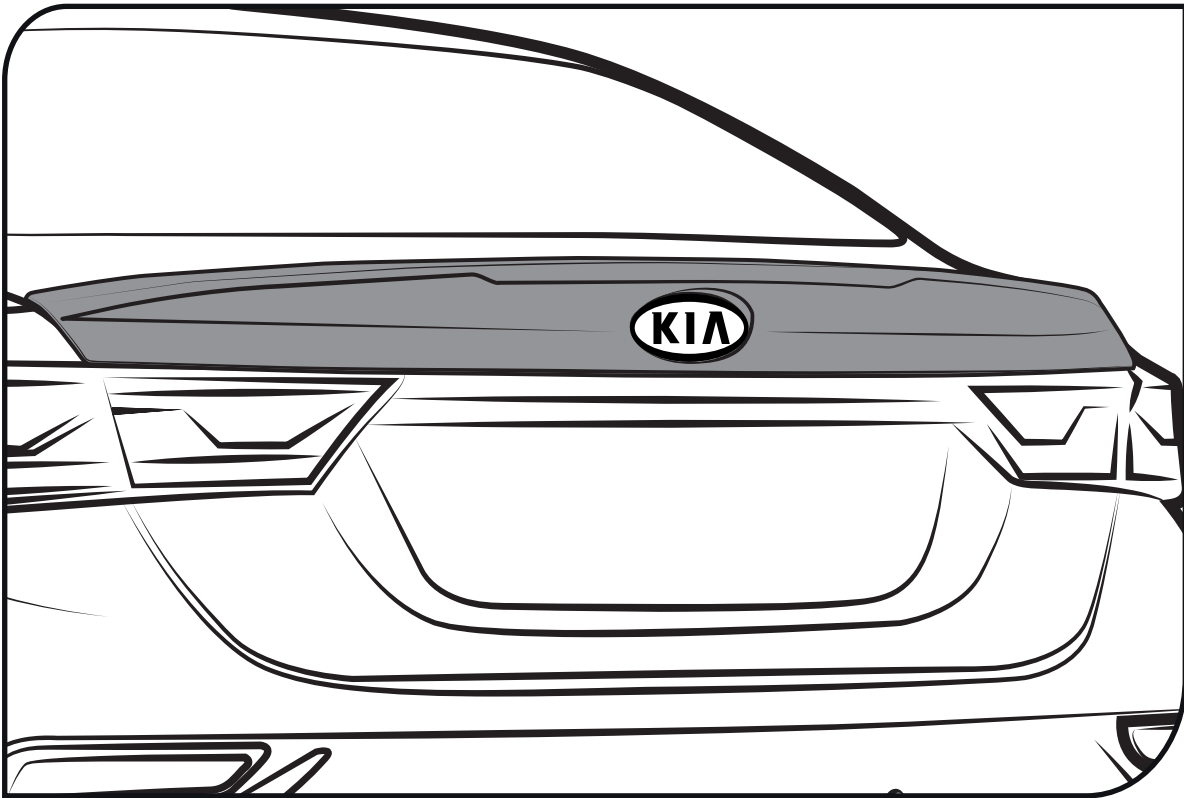

INSTALLED PART

Painting Manual



IMPORTANT



- a) Body Color Paint Procedure for Sport Kits coated in gray primer, with the lower area painted in Piano Black (or Glossy Black).
- b) KIA Sport Kit parts come from the Factory coated in gray primer (upper area) and Glossy Black (lower area).
- c) Glossy Black finish comes faded over the primer to achieve a better blending between Glossy Black finish and the base color.
- d) Please follow the next steps in order to apply the Body Color Base and the clear coat over the primer.

FOR THE FULL INSTALLATION ON THE VEHICLE, CHECK THE INCLUDED INSTRUCTION SHEET OR THE INSTALLATION VIDEO ON YOUTUBE.

STEPS TO FOLLOW

1 OUTLINE THE CONTOURS OF THE PART

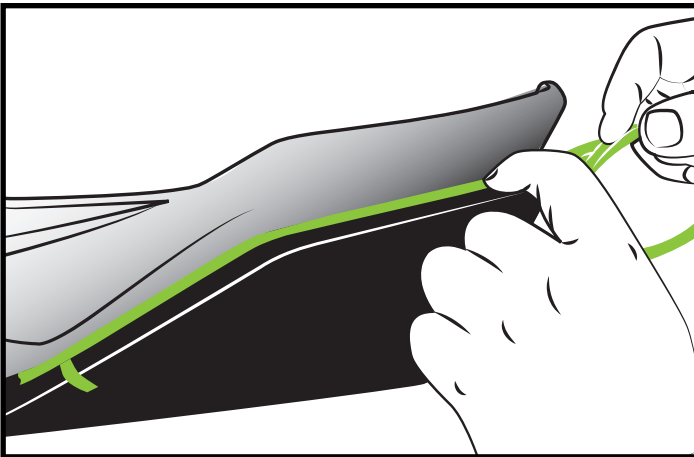

TO PROTECT THE GLOSSY BLACK FINISH, OUTLINE THE CONTOURS OF THE PART WITH MASKING TAPE SIZE 1/4 AND 3/4.



2 COVER THE GLOSSY BLACK ZONES

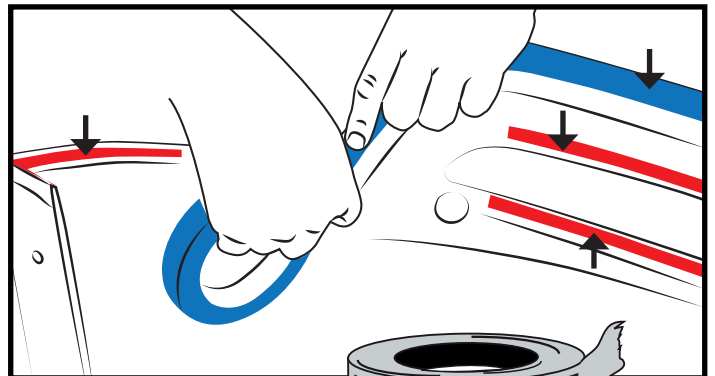
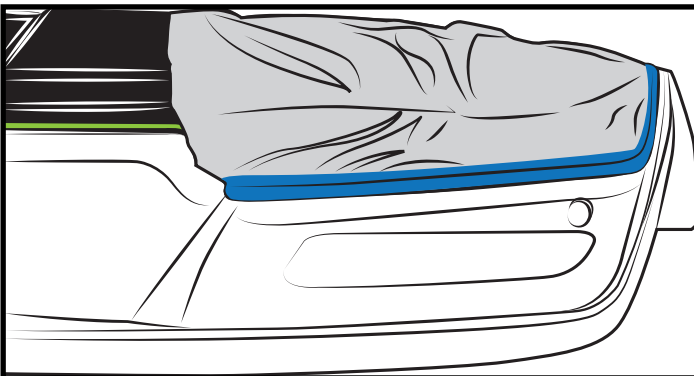

PROTECT WITH MASKING PAPER THE GLOSSY BLACK AREAS. PROTECT THE POLYURETHANE CHANNEL AND THE VHB TAPE.

INSTALLATION MANUAL

3 SANDPAPER

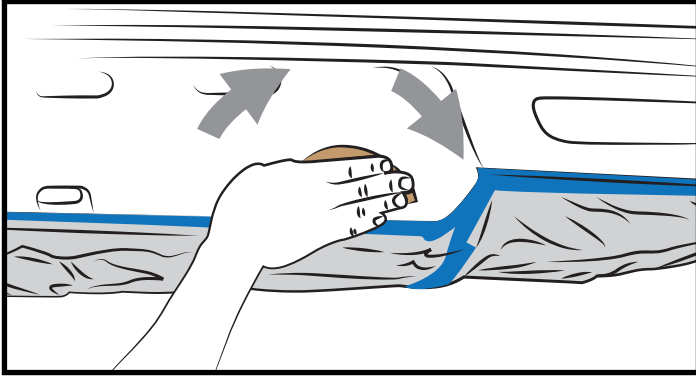

! LIGHTLY SAND THE AREA WITH 600-GRIT SANDPAPER.

4 CLEAN

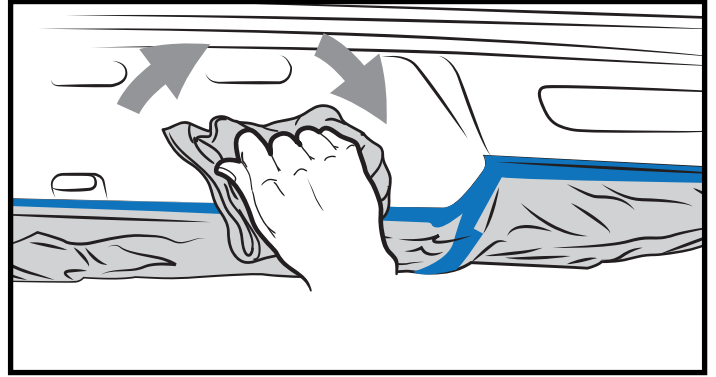

! WIPE OFF DUST WITH FLANNEL CLOTH BEFORE APPLYING THE PAINT.

5 APPLY THE BASE COLOR

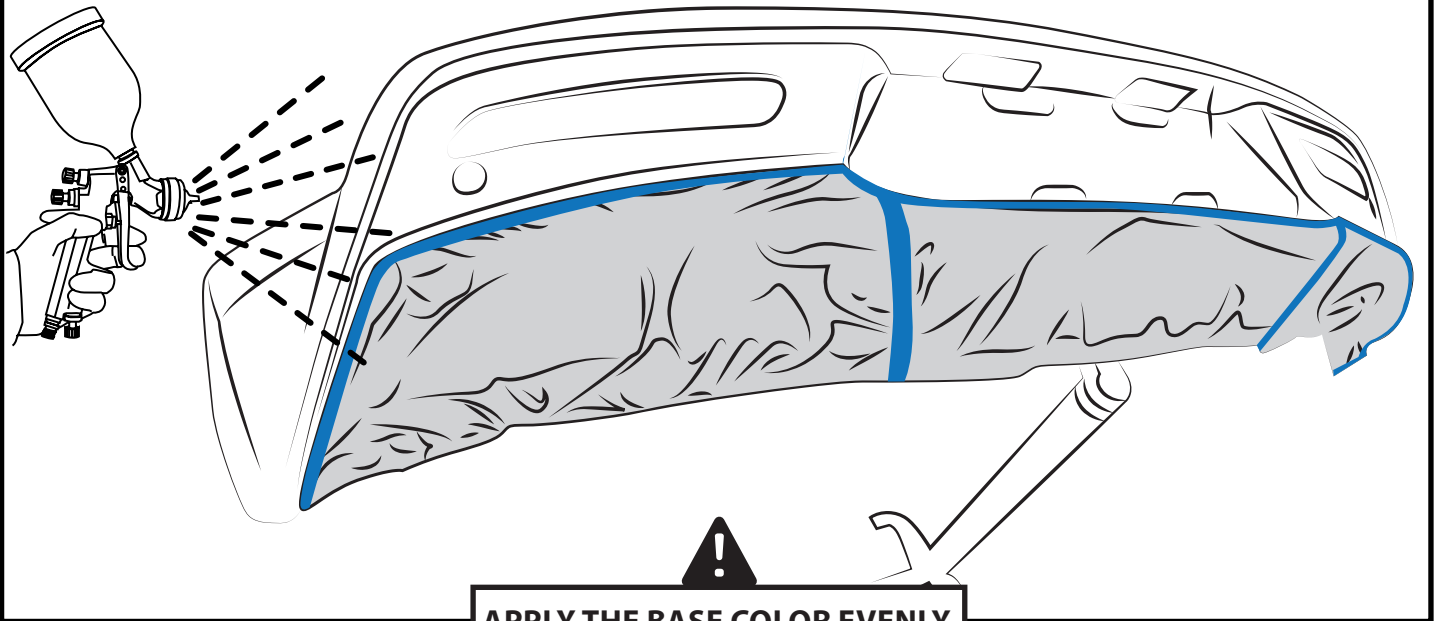

! APPLY THE BASE COLOR EVENLY.

6 APPLY THE CLEAR COAT

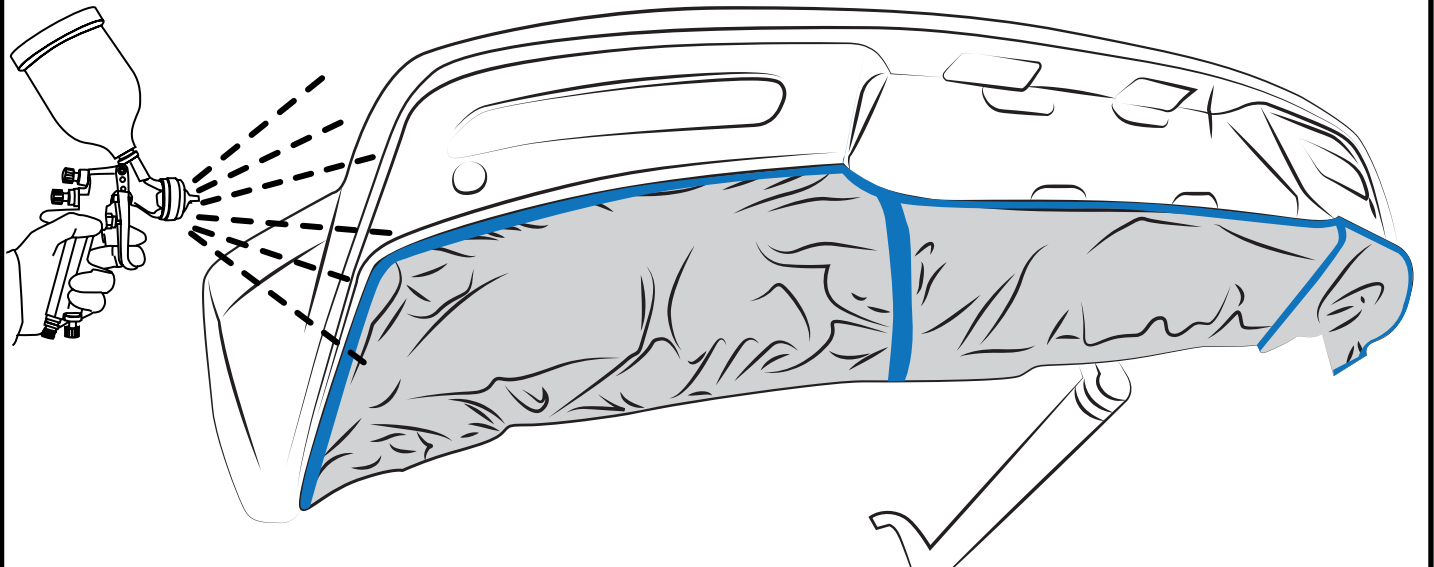

INSTALLATION MANUAL

7 CURE

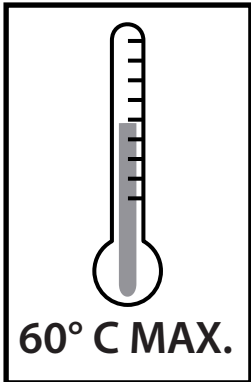

!
CURE IN AN OVEN FOR 30 MINUTES AT 60 °C MAXIMUM.

8 UNMASK

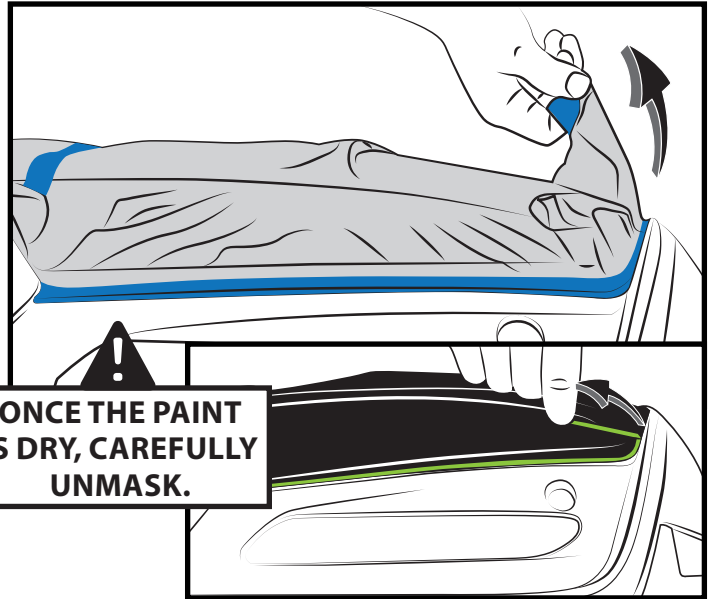

9 MICRO-POLISH AND WAX THE PART



IMPORTANT



STOCK THE PARTS IN SUITABLE RACKS TO PREVENT DAMAGE AND DEFORMATION.