



DODGE - RAM 1500 2019

INSTALLATION MANUAL

HOOD SCOOP WITHOUT INSERT AD PART #: CH07A02

This Hood Scoop doesn't fit Ram Sport and Rebel models.

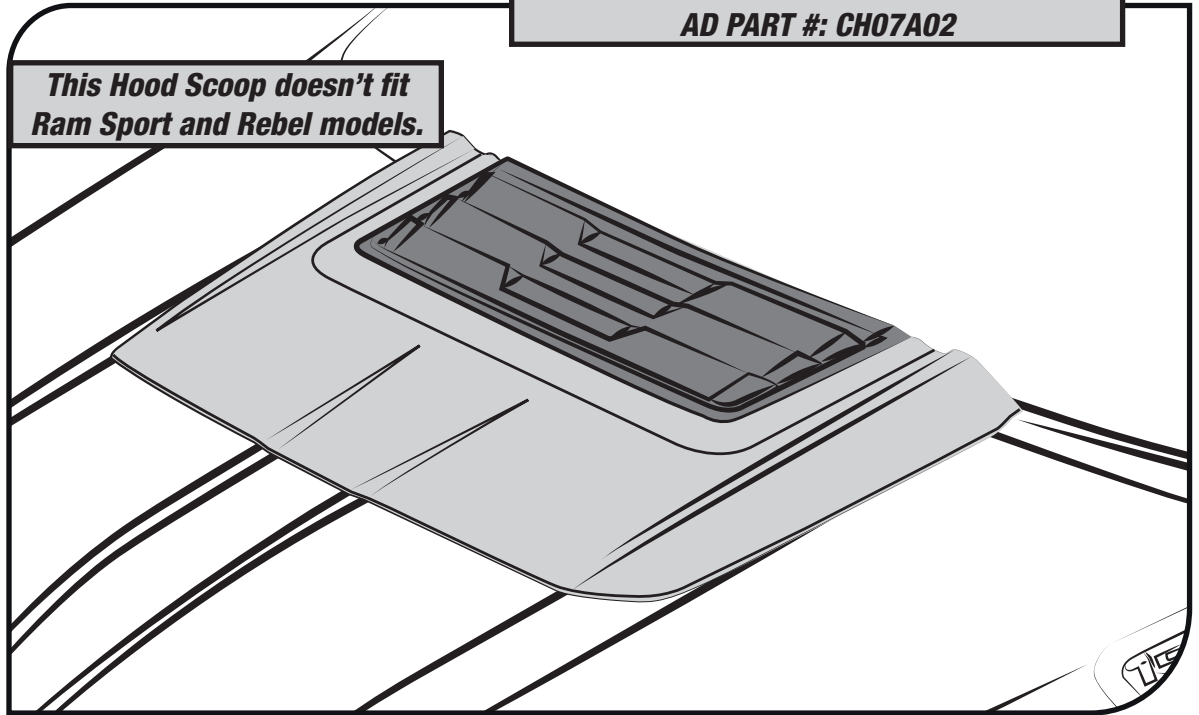

**READ CAREFULLY
BEFORE INSTALLATION**

**WASH BEFORE
INSTALLING**

**WE RECOMMEND
2 PERSONS FOR
INSTALLATION**

AFTER INSTALLING

DO NOT WASH CAR  **24 hrs**

DRIVE SLOWLY
25 mph max







TOOLS



CHECK LIST

***ALREADY INSTALLED IN THE PART**

ITEM	DESCRIPTION	DRAWING	AMOUNT
A	*VHB TAPE		*INCLUDED IN THE PART
B	AUTOMOTIVE ADHESION PROMOTER		1 PC
C	POLYURETHANE ADHESIVE 310 ml.	 ADHESIVE	1 PC

WARNING!! Do not install Hood Scoops or other Body Parts directly Over Wrapped areas. Before installation of the parts , you must leave at least a 1/4" (6 mm) perimetral clearance "Free from Vinyl" surrounding the part, before Part installation.



WARNING!! Do not install Hood Scoops Over Vinyl or Over Plastic Stripes on the Hood: 3M Adhesive Tape and PUR Adhesive must always be in contact with the Sheet Metal of the vehicle.

WARNING!! Rust Prevention Oils and other Petrol Based Anti Rust Treatments for Vehicles may affect 3M's Double Adhesive Tape and Polyurethane Adhesive performance!

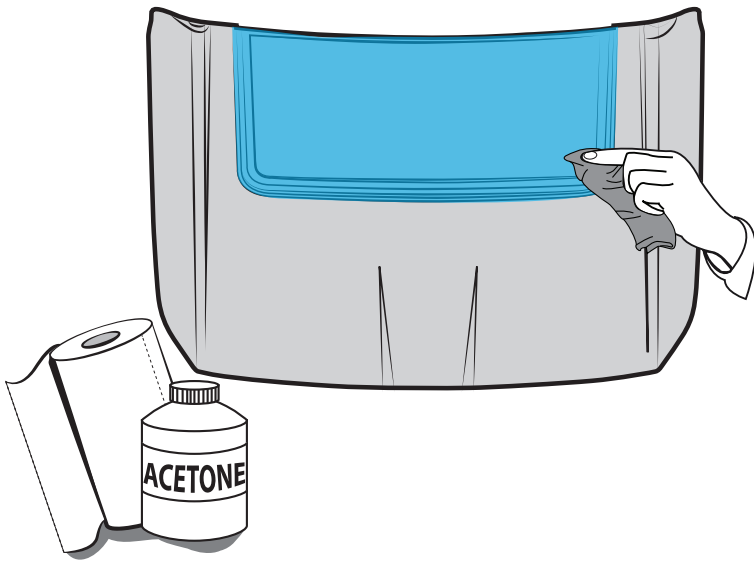
1 CLEAN

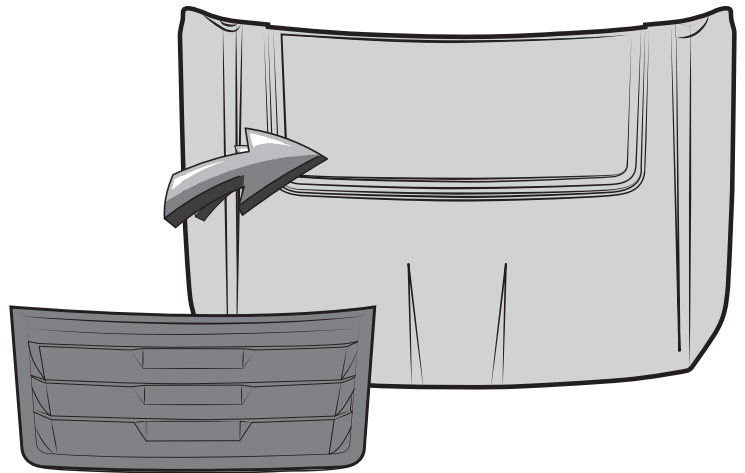

2 PRE-INSTALL



3 MARK

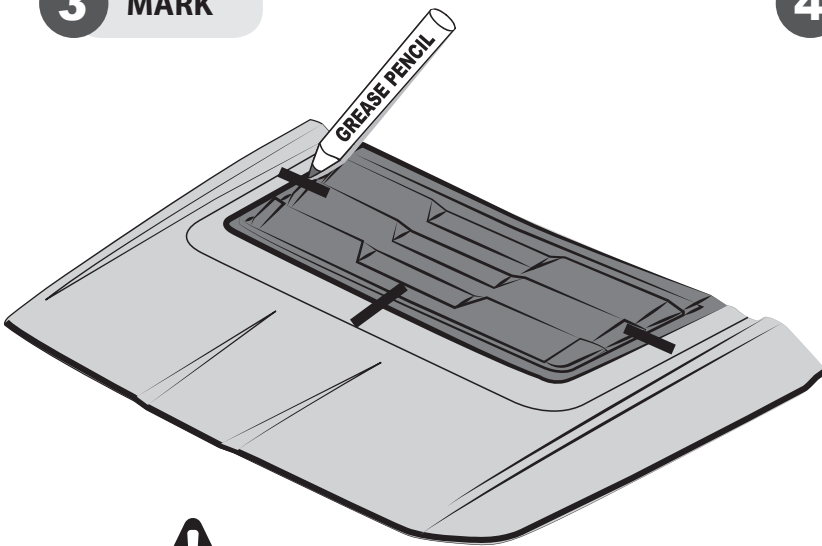

HASH MARKS

4 REMOVE

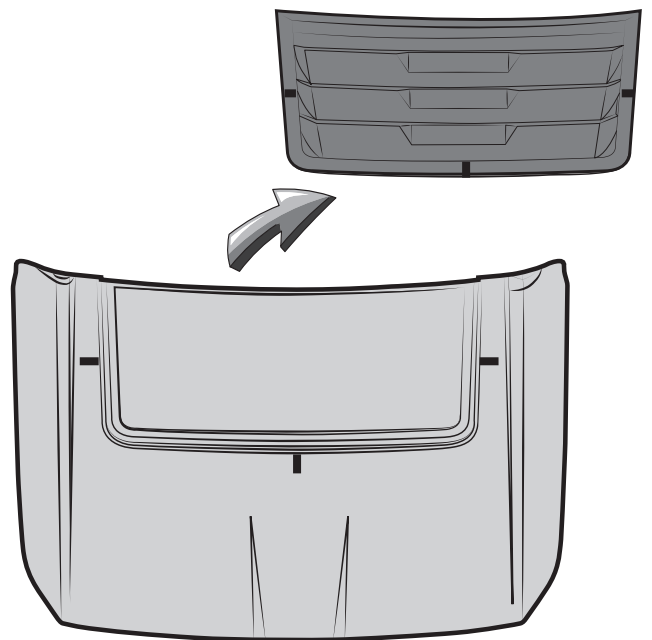

5 ADHESION PROMOTER

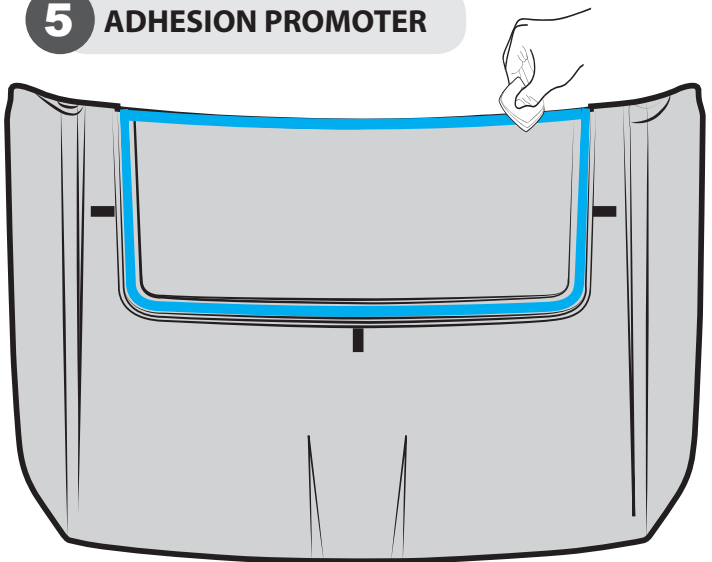

B



6 PEEL

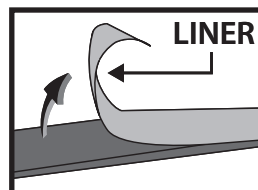
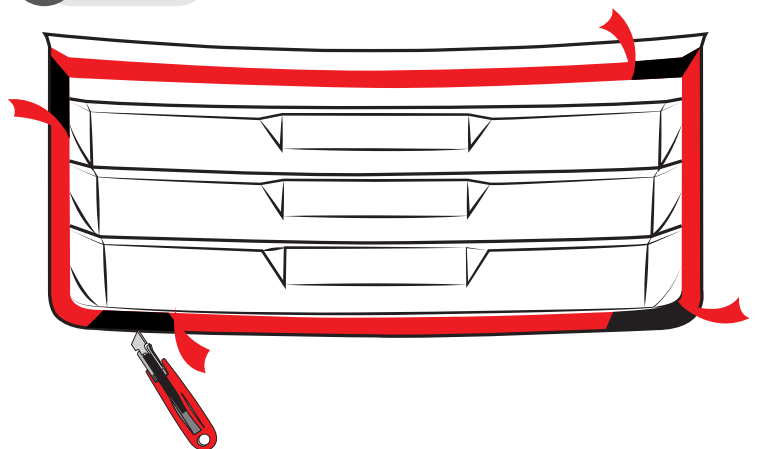

INSTALLATION MANUAL

7 PLACE

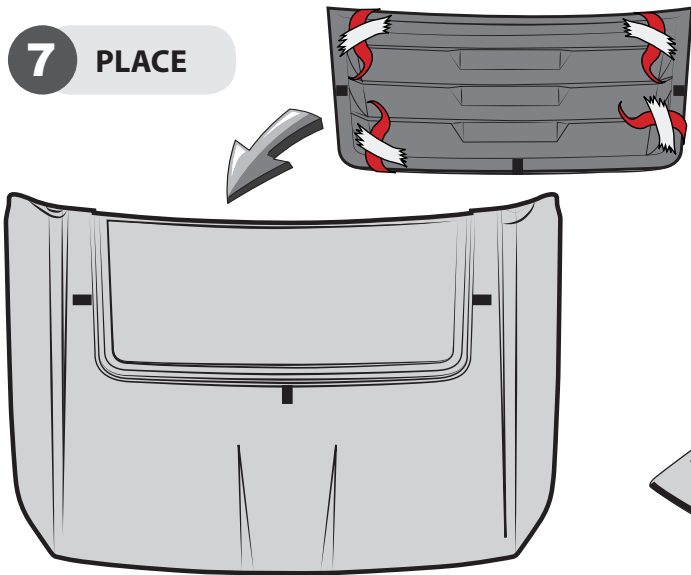

8 REMOVE LINER

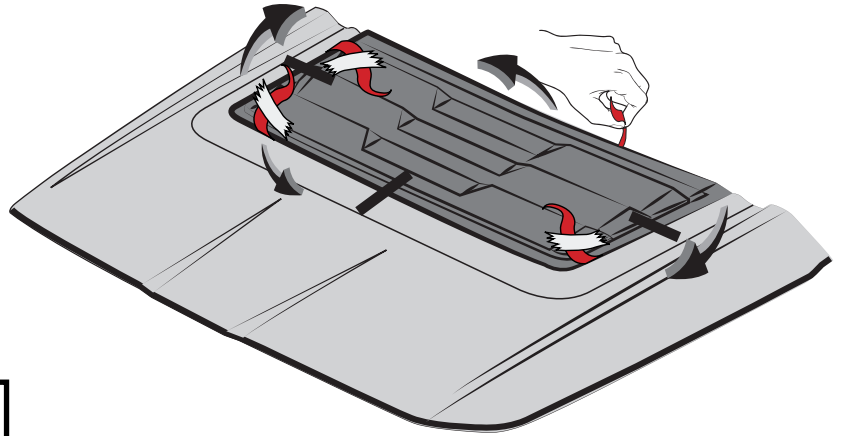

WARM SURFACES WITH HEAT GUN IF SURFACE TEMPERATURE IS TOO COLD.

9 PRESS

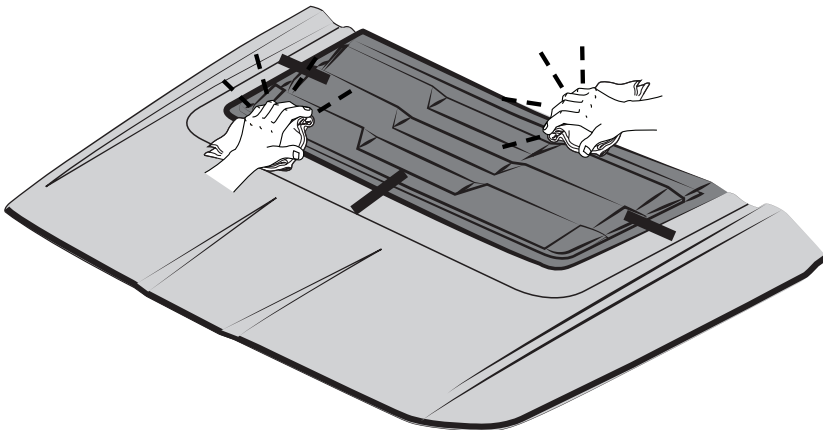

DURING APPLICATION, THE VEHICLE, ADD ON PARTS AND TAPE MUST BE AT OR ABOVE 16 °C OR 60 °F. A FULL SURFACE CONTACT BETWEEN TAPE AND SUBSTRATE IS IMPORTANT FOR GOOD ADHESION PERFORMANCE. CONTACT IS ACHIEVED BY APPLYING PRESSURE. IN PRACTICE A PRESSURE BETWEEN 40 AND 50 N/CM² IS USUALLY NEEDED.

10 CLEAN OFF GREASE PENCIL MARK

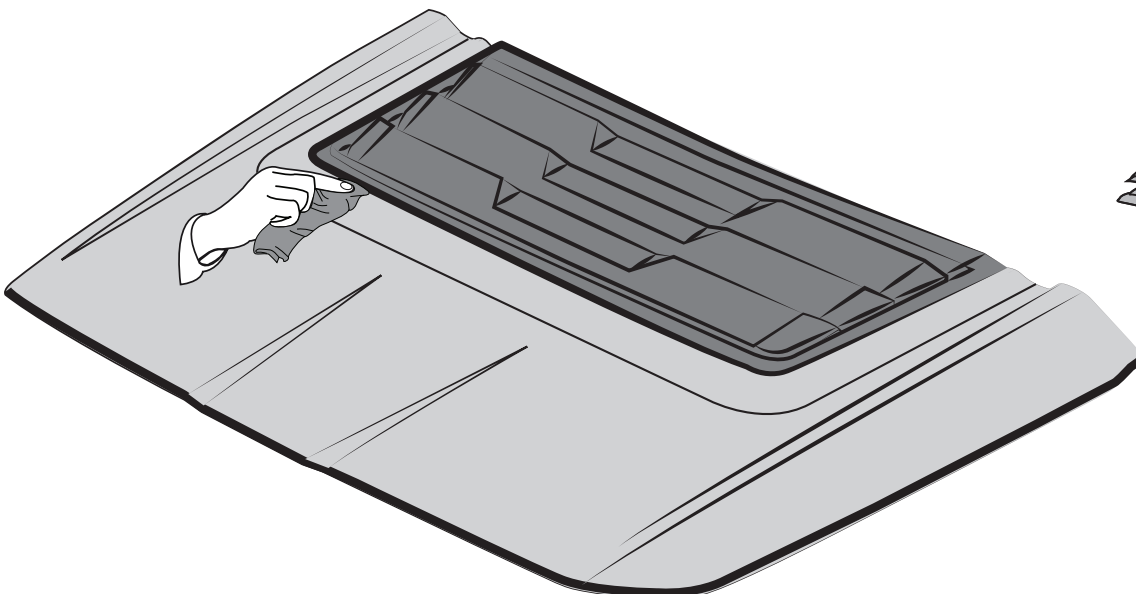

! Vehicle and part must be at 16°C or 60°F or more before installation.

Keep the vehicle and parts in an environment that is within the recommended installation temperature range for 4 hours.

11 CLEAN

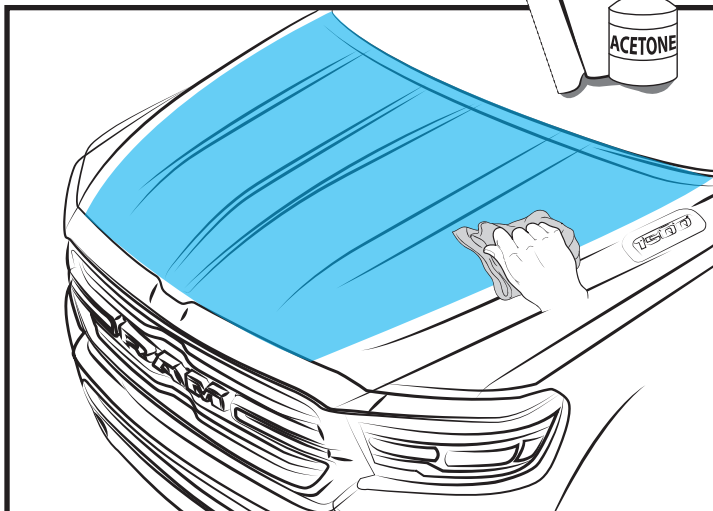

12 PRE-INSTALL

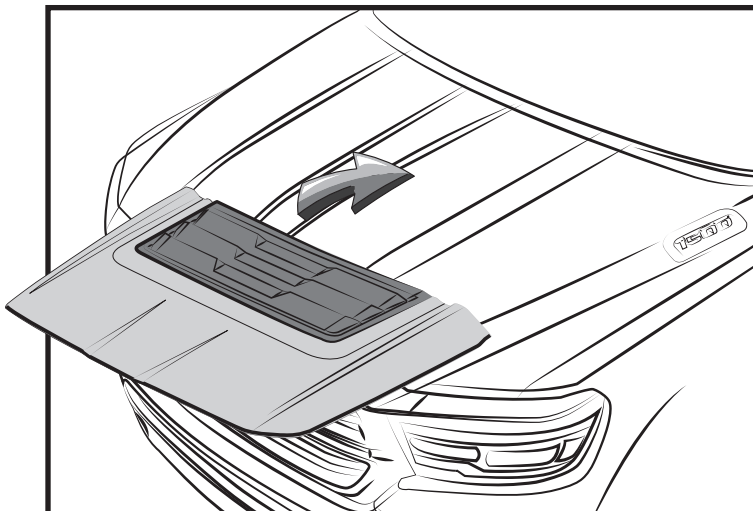

13 ALIGN & CENTER

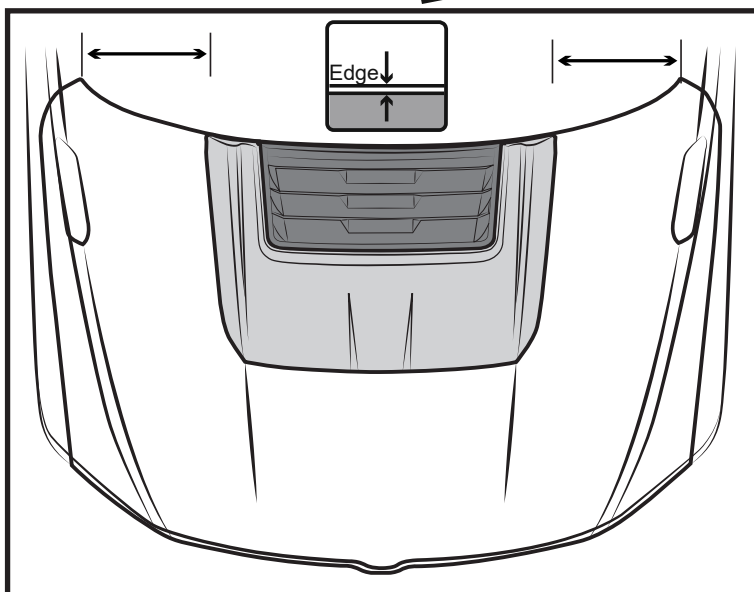

14 MARK

DRAW HASH MARK WITH GREASE PENCIL ON HOOD SCOOP AND SHEET METAL, THIS WILL ENSURE HOOD SCOOP WILL BE CENTERED TO GREASE PENCIL OUTLINE.

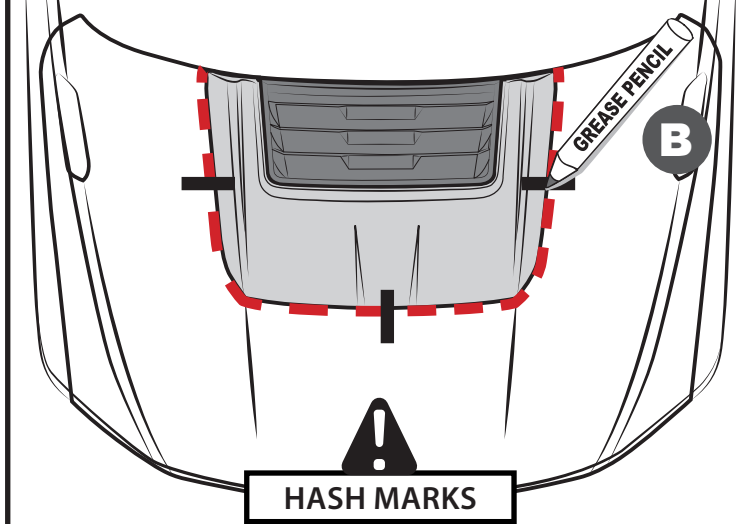

15 REMOVE

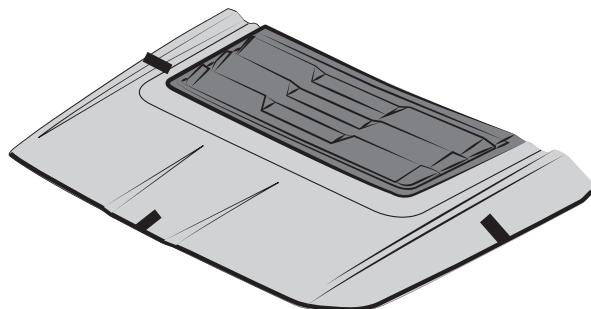
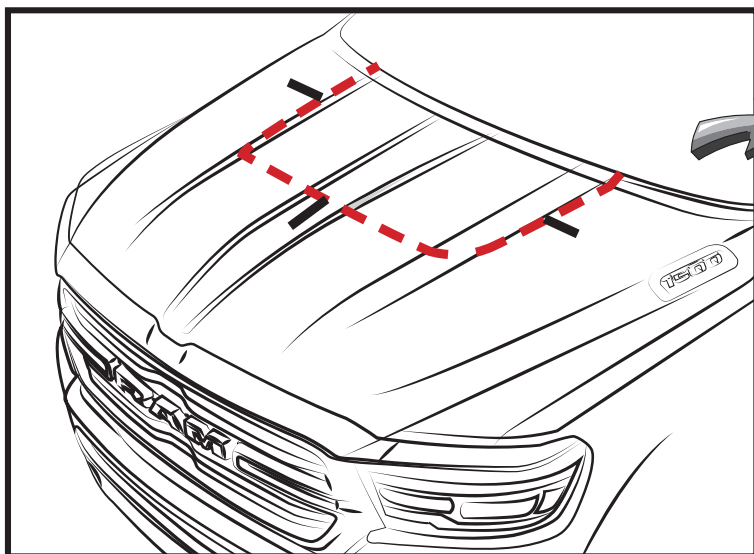

16 CLEAN INNER CHANNEL

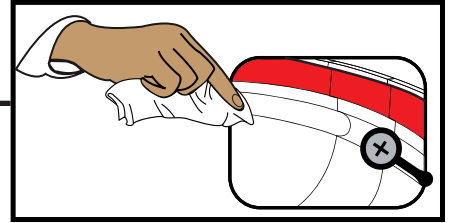
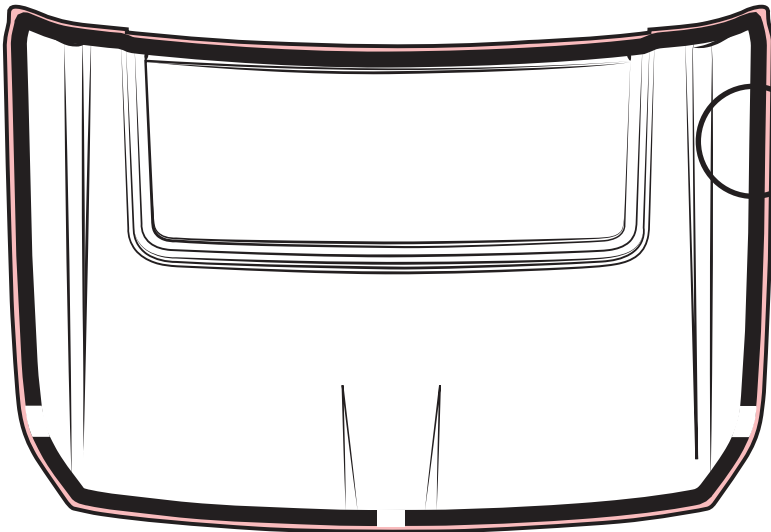

17 PEEL

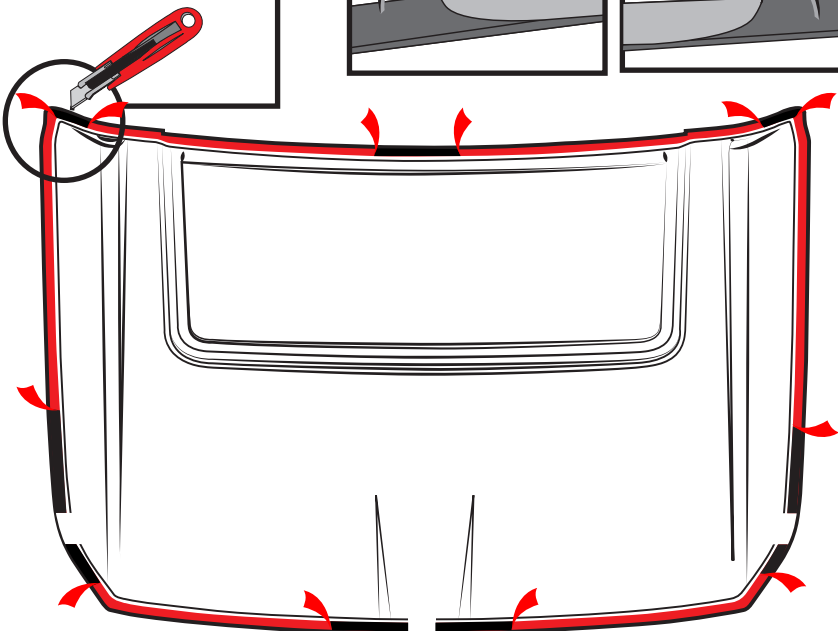
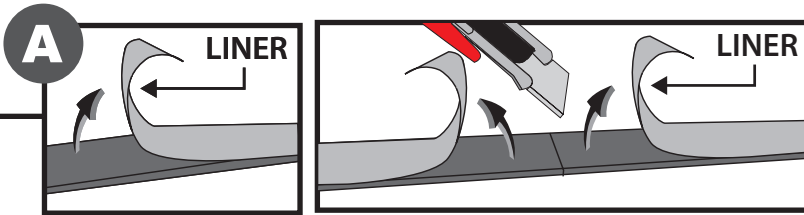

18 APPLY POLYURETHANE ADHESIVE

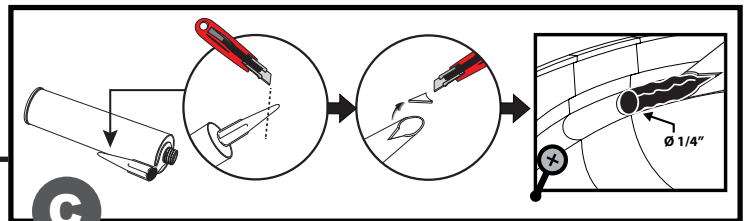
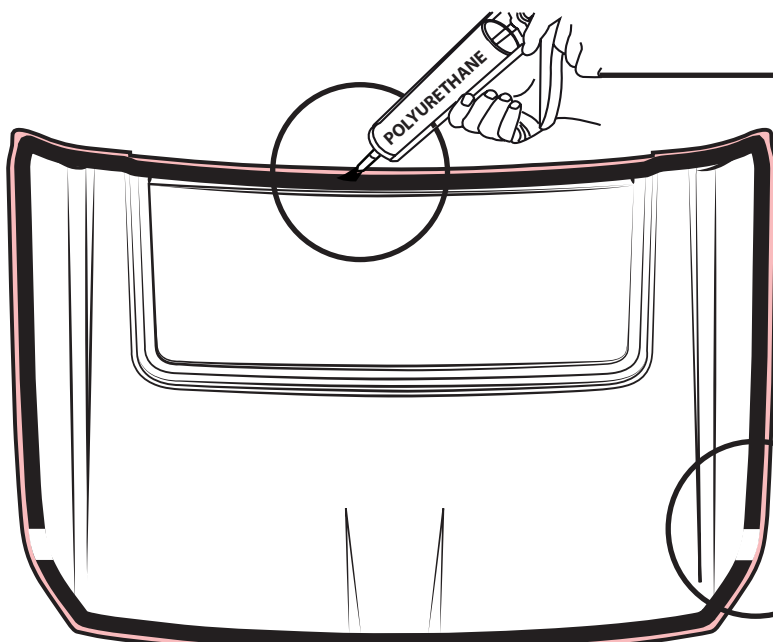

**WATER DRAIN
KEEP OPEN WITHOUT
ADHESIVE**
Keep the indicated
separation

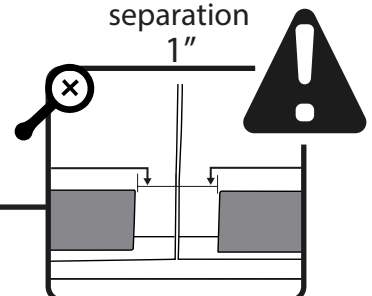

INSTALLATION MANUAL

19 PLACE

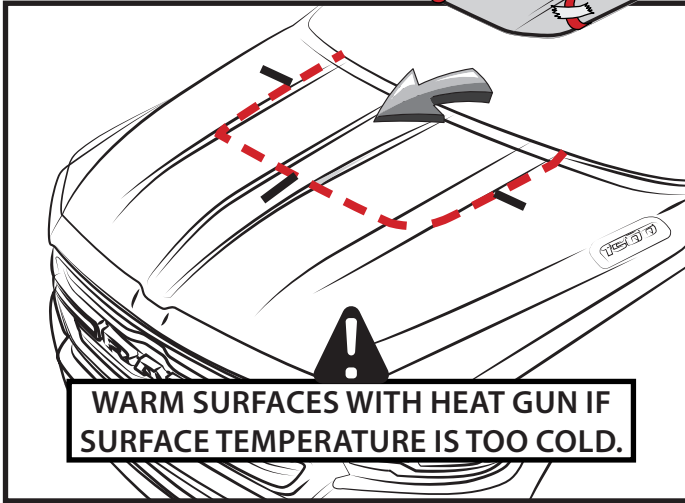
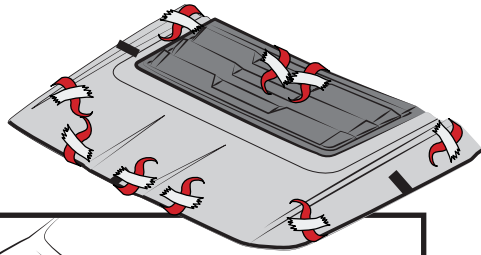

20 REMOVE LINER

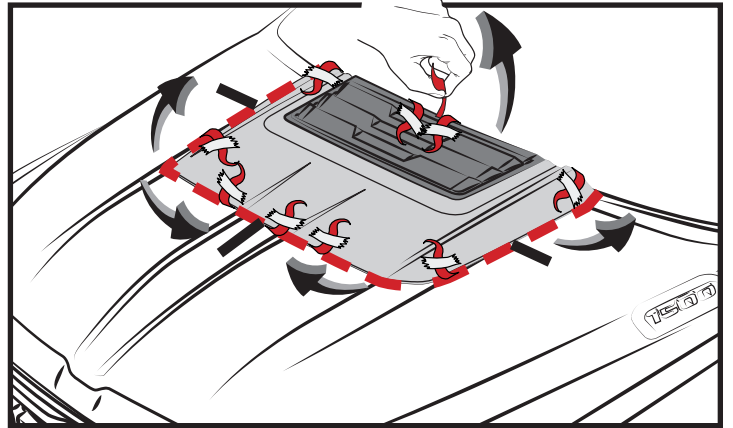

21 PRESS

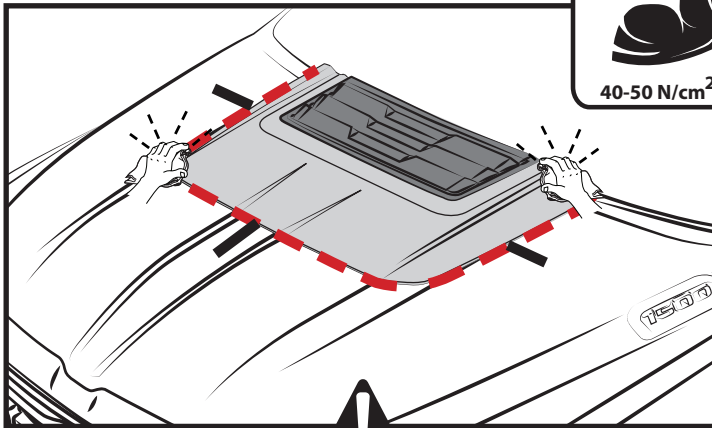

22 CLEAN OFF GREASE PENCIL MARK

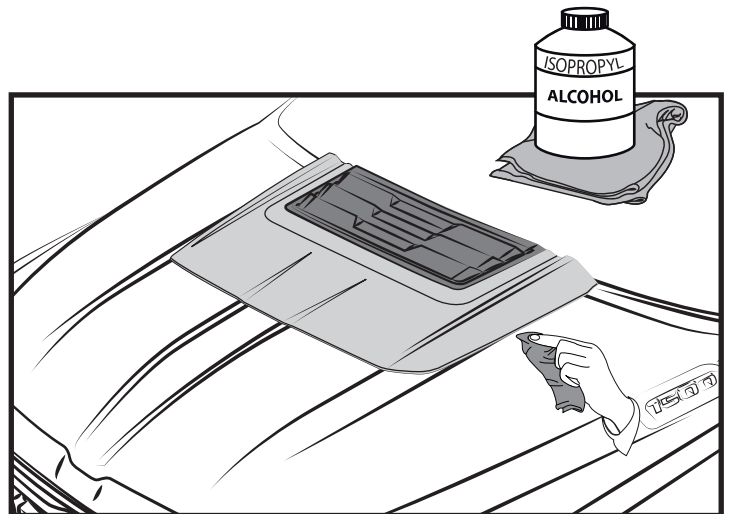

DURING APPLICATION, THE VEHICLE, ADD ON PARTS AND TAPE MUST BE AT OR ABOVE 16 °C OR 60 °F. A FULL SURFACE CONTACT BETWEEN TAPE AND SUBSTRATE IS IMPORTANT FOR GOOD ADHESION PERFORMANCE. CONTACT IS ACHIEVED BY APPLYING PRESSURE. IN PRACTICE A PRESSURE BETWEEN 40 AND 50 N/CM² IS USUALLY NEEDED.

INSTALLED PART

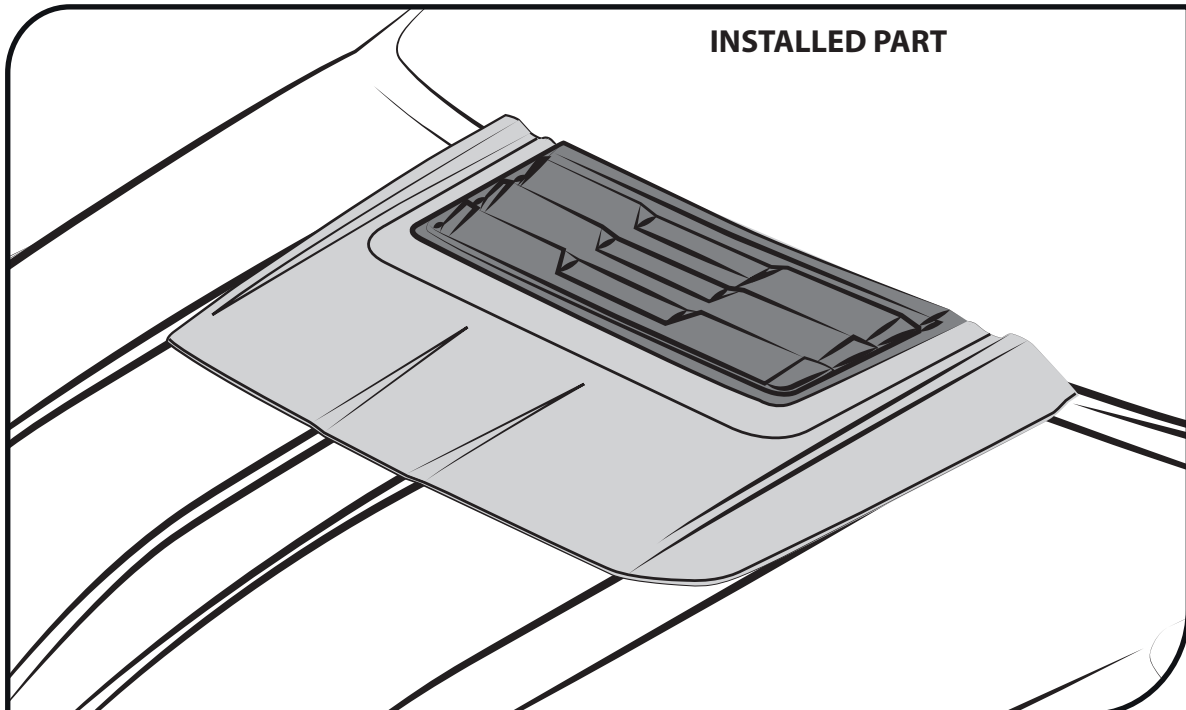

INSTRUCTIONS PAINTING

IF THE PART IS IN FIRST, APPLY THE FOLLOWING PROCESS



PLEASE READ CAREFULLY BEFORE STARTING WITH PAINTING PROCESS

BODYCOLOR PAINTING INSTRUCTIONS

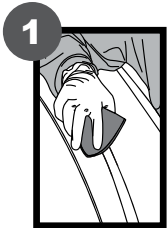

1 SAND THE PART SOFTLY WITH A 400 GRAINS SAND PAPER OR WITH A SCOTCH-BRITE RED SPONGE. BE CAREFUL NOT TO DAMAGE FACTORY SATIN BLACK FINISH. CLEAN WITH ISOPROPYL ALCOHOL AFTERWARDS.

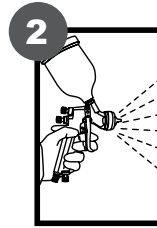

2 APPLY A GOOD QUALITY 2K PRIMER.



3 CHECK THE PARTS MINUTELY, THESE MUST HAVE A SMOOTH FINISH.



4 DUST ANY POWDER PARTICLE WITH A FLANNEL TOWEL BEFORE APPLYING THE PAINT.



5 APPLY BASE COAT TO GET A SMOOTH AND FINE FINISH.

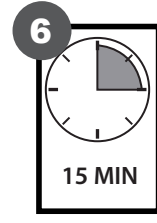

6 WAIT 15 MINUTES, CHECK MINUTELY AND DETAIL WHERE NECESSARY.



7 APPLY A THIN LAYER OF VARNISH.

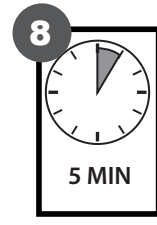

8 WAIT 5 MORE MINUTES.



9 VARNISH PLENTY UNTIL YOU GET THE DESIRED BRIGHT AND FINISH. WAIT 5 MORE MINUTES.

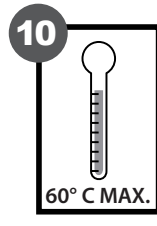

10 CURE AT A MAXIMUM TEMPERATURE OF 60°C (140°F) FOR 15 MINUTES. DO NOT EXCEED SUGGESTED TEMPERATURE.



IMPORTANT



MAKE SURE THE PART IS SECURED CORRECTLY TO THE BASE DURING PAINT AND CURE PROCESS TO AVOID ANY RISK OF FALLING.