

GRAYL

GEOPRESS®

QUICKSTART GUIDE



SCAN WITH YOUR PHONE
LET'S GO!

A CLOSER LOOK

GEOPRESS® DRINK CAP

RiverFlow® Spout

A wide contoured spout delivers a fast flow of water.

SimpleVent®

Twist the cap 1/2 turn to vent air during purification process.

SoftPress®

Comfortable pressing pad provides for an ergonomic, non-slip pressing surface.



INNER PRESS

Holds 24 oz (710 ml) of clean, filtered and purified water. **NOTE:** Dirty water never enters the Inner Press.

Filter & Purifier

8 seconds per 24 fl oz (5 liters/minute), 350 presses (250L/65 gal). Removes viruses plus bacteria and protozoa. Improves taste, smell and clarity. Filters microplastics, PFAS, and lead.

OUTER CUP

TopoGrip®

Durable, tactile non-slip grip material placed on all heavy use surfaces.

Max Fill Line

A maximum fill line is located on the backside of the Outer Cup. 24oz (710ml).

Non-Slip Base

Soft, non-slip base provides durable protection.



QUICKSTART

01

ROTATE & PULL APART.

Grasp the Handle with one hand and the Outer Cup with the other, then pull apart. A quick twist helps to initiate separation.

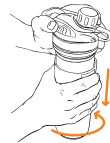

02

FILL WITH DIRTY WATER.

Scoop from a stream or lake, or fill from any bathroom sink or rustic hostel tap.

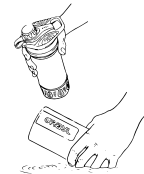

03

VENT AND PRESS.

Twist the SimpleVent® cap 1/2 turn to allow air to vent during purification process. Utilizing your body weight, press with steady downward force.

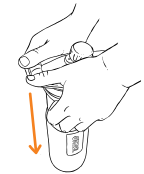

04

DRINK PURIFIED WATER.

Fast and easy; makes clean drinking water in **8 seconds** - anywhere!

NOTE: Actual "press time" will vary depending on water quality, cartridge lifespan, water temperature, and user ability.



HOW IT WORKS



ONE PRESS. GLOBAL PURIFICATION.

SPECIFICATIONS

350 PRESSES
250 L / 65 GAL
5 L / MIN

PURIFIER CARTRIDGE
REPLACEABLE



REMOVES*

VIRUSES (99.99%)
ROTAVIRUS
NOROVIRUS
HEPATITIS A

BACTERIA (99.9999%)
E. COLI
SALMONELLA
DYSENTERY

PROTOZOA (99.9%)
GIARDIA
CRYPTOSPORIDIUM
AMOEBAE

FILTERS

PARTICULATES
MICROPLASTICS
SEDIMENT
SILT

CHEMICALS
PFAS
CHLORINE
CHLOROFORM

HEAVY METALS
LEAD
ARSENIC
CHROMIUM

CARTRIDGE INSTALLATION

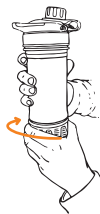

01

REMOVAL

Firmly grasp the Inner Press. Rotate the cartridge (lefty-loosey) until it separates from the Inner Press.



02

INSERT

Firmly grasp Inner Press, then insert Cartridge into bottom of Inner Press.



03

ROTATE AND LOCK

Firmly grasp Inner Press, then insert Cartridge into bottom of Inner Press.

CAUTION:

Proper installation of Cartridge prevents cross-contamination.

PRECAUTIONS

PRESS WITH FRESHWATER ONLY.

Press with freshwater only (no other liquid). NO salt or brackish water.

CROSS-CONTAMINATION.

Do not expose/fill the Inner Press with untreated water, cross contamination may occur. If this does happen, disassemble and wash GeoPress® (not Cartridge) with soapy water and rinse thoroughly. Alternatively, thoroughly dilute potential contaminants by pressing (and agitating) water through the cartridge 5-7 times.

SOURCING THE BEST WATER.

Always begin with the cleanest (least silty) water available. For instance, streams are generally better than lakes and bogs (which are often have higher levels of sediment and tannins).

CYANOBACTERIA, HIGH LEAD LEVELS, MERCURY, ETC.

Cartridges are designed to remove trace levels of chemicals and heavy metals. The GeoPress® was NOT designed to protect against industrial disasters, coal ash spills, very high lead levels, mercury, nuclear disasters or toxic blue-green algae (cyanobacteria), etc. Find another water source in these situations.

CAUTION WITH TANNINS.

Tannins are natural organic compounds that leach from decomposing vegetation and trees and can cause Cartridges to clog. In high concentrations, tannins are easily recognizable, as they turn water tea-colored and form blackwater rivers. Do not use GeoPress® in water with high tannins.

NO FREEZING.

Cartridges are not significantly degraded after one freeze/thaw cycle. However, don't use a cartridge after 3 or more freeze/thaw cycles. Protect your GeoPress® in freezing temperatures by keeping it full of water and insulate in a jacket or sleeping bag.

NO HOT (OR BOILING WATER) OR MICROWAVES.

Do not expose Cartridge to water hotter than 120F (50C), it will harm purifier media. Do not put the GeoPress® in the microwave.

DURABILITY AND ACCIDENTAL DROPS.

Withstands drop tests (at full capacity) up to 6'.

CARE & USE

WASH GEOPRESS® (NOT CARTRIDGE) BY HAND.

The Outer Cup, Inner Press, and Drink Cap can all be washed by hand with warm, soapy water. Do not put any components into a dishwasher. Do not wash Cartridge with soap or any cleaning agents.

LONG-TERM STORAGE.

Thoroughly dry wet Cartridge by pressing into an empty (no water) Outer ReFill and dump excess water. Remove **One-Way Silicone Valve** and allow Cartridge to air-dry thoroughly (depending on humidity it will take 2-4 days to completely dry). Hand wash all other parts including **One-Way Silicone Valve** with warm, soapy water. Reassemble unit to create air tight seal for storage. Cartridges can last up to three years after opening if cared for properly between uses.

LIFESPAN OF CARTRIDGE.

In clear water, a Cartridge will be effective for ~350 cycles (65 gal/ 250L). Lifespan is shortened in water containing impurities such as mud, silt or tannins. As "press time" reaches ~25 seconds (or three years have elapsed since first use) it's time to replace the Cartridge. Regardless of flow rate, Cartridges are effective (no waterborne pathogens pass).

PRO TIP: allow silt to settle out of silty water before pressing. A flocculation agent (such as Alum Power found in grocery stores) speeds up settling.

SHELF LIFE OF UNUSED CARTRIDGES.

An unused (and airtight) Cartridge has a shelf life of 10 years.

ON AN AIRPLANE.

As an airplane climbs to cruising altitude, cabin pressure drops, causing air to expand inside a Grayl. Prevent leaking by flying with the One-Way Silicone Valve (included with GeoPress®), as this will prevent leaking.

Alternatively, fly with your bottle completely empty (no water to leak) or completely full (no air to expand). Once you've reached cruising altitude, use normally.

TESTING STANDARDS.

Meets or exceeds the US EPA Guide Standard and Protocol for Testing Microbiological Water Purifiers (April 1987).

CUSTOMER SERVICE & RESOURCES.

For answers to the most common questions, live chat, and product support, please visit www.grayl.com/help

© GRAYL, INC. 2023 / ALL RIGHTS RESERVED.



CARE & USE

CARE BETWEEN USES

Thoroughly dry a wet Cartridge by pressing into an empty (no water) Outer Cup, then dump any excess water. Remove the One-Way Silicone Valve and allow Cartridge to air-dry thoroughly (**depending on humidity it will take 2-4 days to completely dry**). Clean and dry the One-Way Silicone Valve (instructions below), then reassemble your Grayl.

ONE-WAY VALVE IS DISHWASHER SAFE!

Regularly wash the One-Way Silicone Valve between uses to remove smell and residue left behind from drink mix powders or other beverages. Hand wash with warm, soapy water or place in a dishwasher. **Do not expose Cartridge to soap or cleaning agents of any kind.**

SO YOU WANT TO BE A PRO?

We all love to keep our sodium levels nice and high when we are enduring some heavy adventures. But what about after the adventure? **Try these in your drink-mix ready Grayl**

MOCKTAILS / COCKTAILS / BEER / SELTZER WATER / JUICE

CUSTOMER SERVICE & RESOURCES.

For answers to the most common questions, live chat, and product support, please visit www.grayl.com/help



© 2023 GRAYL, INC.
ALL RIGHTS RESERVED.



GRAYL | GEOPRESS®



DRINK-MIX
READY

QUICKSTART GUIDE



SCAN WITH YOUR PHONE
LET'S GO!

INSTALLATION & REMOVAL



01

INSTALLATION

Using your thumbs firmly press and seat the *One-Way Silicone Valve* into the cartridge. Insert finger into valve if needed.



02

SEATING & SECURING

Protect the cartridge media by double-checking that the valve is seated and secured. Check proper installation visually, by ensuring the rim of the silicone is flush with topside, and that the base of the Valve is flush with Cartridge floor.



03

REMOVAL

Using your fingers, firmly pinch the top of the *One-Way Silicone Valve*, then firmly grasp and remove the Valve from the Cartridge.



ONE-WAY VALVE

The **pre-installed** *One-Way Silicone Valve* prevents liquid from reversing direction and flowing back into the filter Cartridge. Allowing the use of electrolytes, drink mixes, and other beverages with your Grayl.

FILTER YOUR WATER

With a *One-Way Silicone Valve* installed, make clean filtered and purified water with your Grayl.

ADD YOUR DRINK MIX

Add electrolytes or a sport drink mix to your filtered water (only if *One-Way Silicone Valve* is installed). Alternatively, you can add any other potable (i.e. safe to consume) beverage vis a vis the Drink-Thru Cap.

WHAT'S A ONE-WAY VALVE?

A Grayl® *One-Way Silicone Valve* consists of six “duck bill valves” that both prevent water (or other beverages) in your bottle from backflowing through the Cartridge and also allow clean filtered water to pass through the Cartridge into the Inner Press.

