



TOSCANA VANITY BASIN

SINGLE BOWL

- BSN-60024
- BSN-60028
- BSN-60032
- BSN-60036
- BSN-60040
- BSN-60048

DOUBLE BOWL

- BSN-600248
- BSN-600255
- BSN-600264
- BSN-600272
- BSN-600280



Questions, problems, missing parts? Before returning to your retailer, call our customer service department at 1-888-685-8236 or email us at cs@daxib.com.

You can also visit our website at www.daxib.com.



SPECS DRAWING

24"

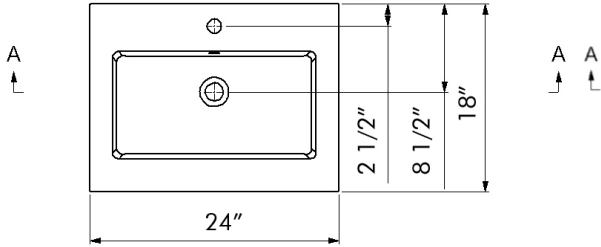

28"

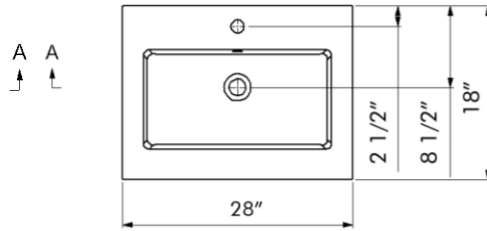

32"

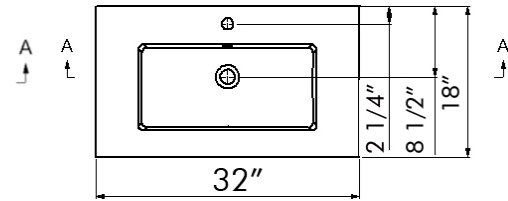

36"

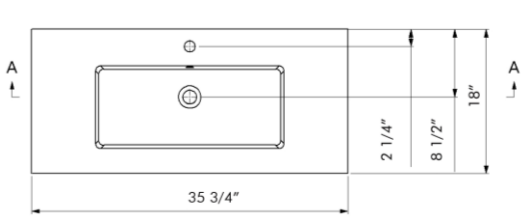

40"

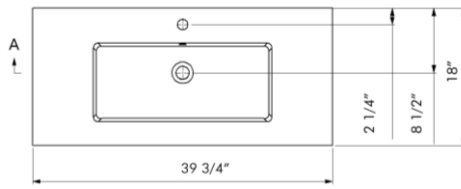

48"

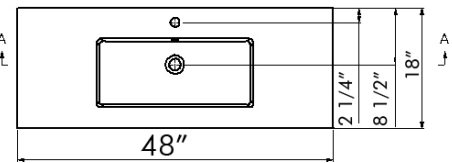

48 Double"

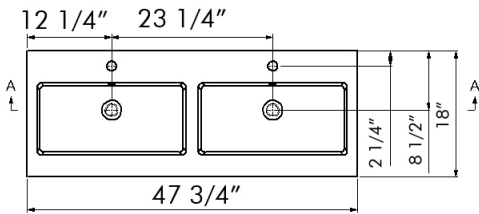

55"

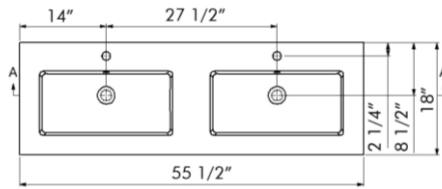

64"

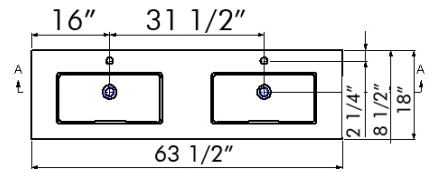

72"

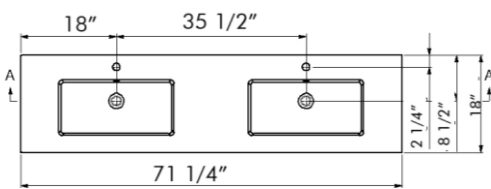

80"

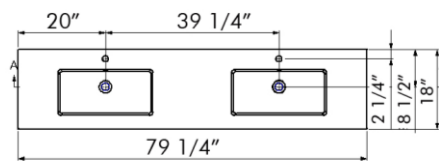



FEATURES:

- Ceramic Material
- With Overflow

FINISH:

- Matt
- Glossy

SIZES:

- 24 Inches
- 28 Inches
- 32 Inches
- 36 Inches
- 40 Inches
- 48 Inches (Single and Double Bowl)
- 55 Inches (Double Bowl)
- 64 Inches (Double Bowl)
- 72 Inches (Double Bowl)
- 80 Inches (Double Bowl)



Double Bowls and Singl Bowls



INSTALLATION INSTRUCTIONS

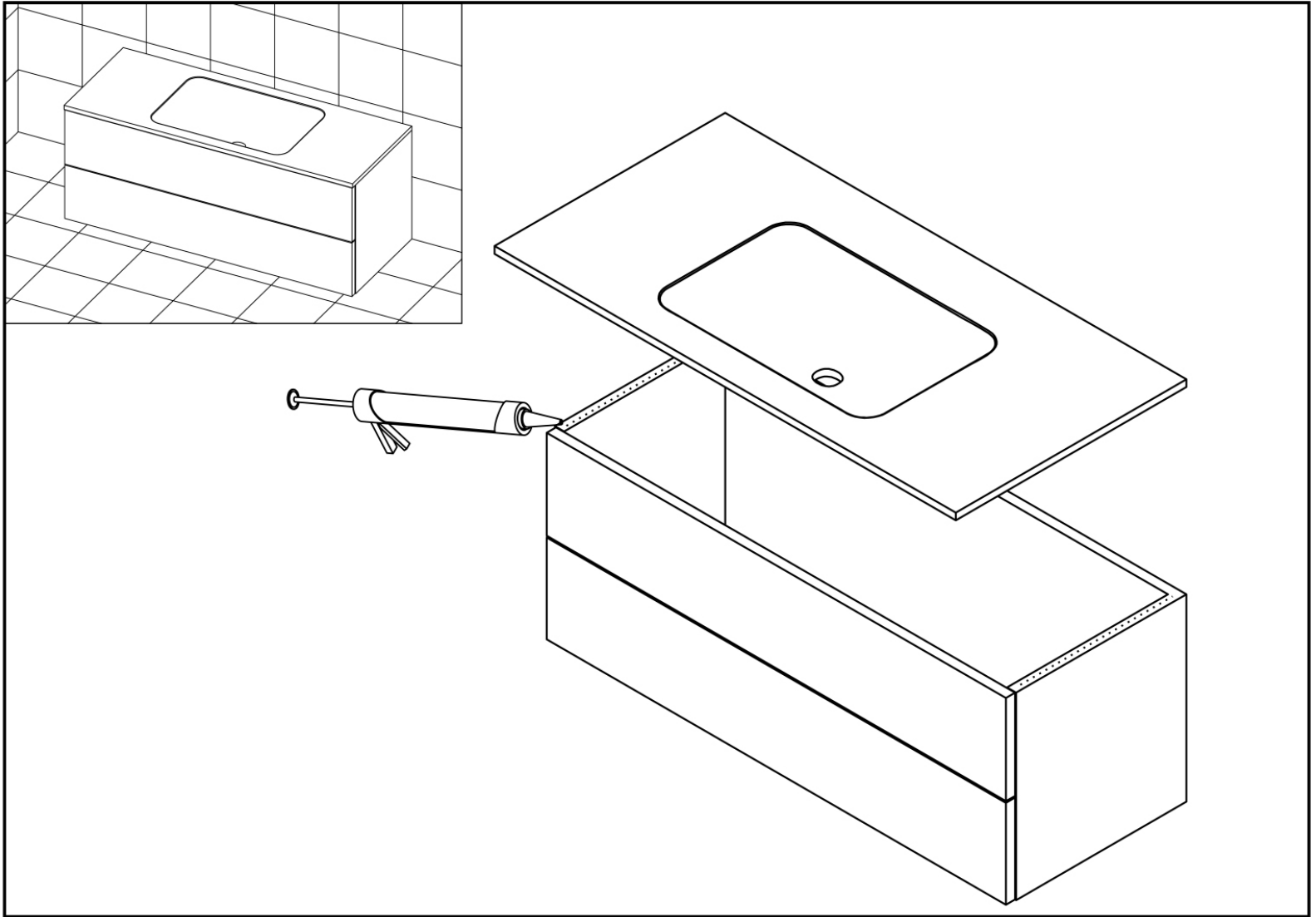

CARE AND MAINTENANCE

To keep the product clean & shining, follow the steps below:

1. Rinse with clean water & dry with a soft cloth
2. Do not clean with soaps, acid, polish, abrasives, or harsh cleaners
3. Do not use cloth with a coarse surface

Our products are designed uniquely and exclusively for inside use, as a complement to other furniture or support or closets for light materials.

They are not suitable for outside use. For the assembly of those parts that are supplied separately, please read carefully the present manual. The stability and capacity of our products will be exclusively guaranteed within the fulfillment of this guide. The shelves or top parts cannot be considered as a working surface so please refrain from any misuse. We supply expansion screws for wall fixing of our units. Please refrain from sitting or standing over the units, shelves, or drawers as this will cause major damage. Do not hang from doors or drawers. Do not open different doors or drawers at the same time. Be extremely careful with glass or mirror components. Do not place the units near any heat source superior to 45 ° C. Warranties do not cover misuse.

Notice: All data in this documentation are only indicative, the aim being to describe the product. If you have questions about how to assemble the furniture or clean, contact your point of sale. The company assumes no liability resulting from misuse of the product.

Maintenance & cleaning: We do not recommend the use of any chemical cleaning products with our furniture. We only recommend the use of warm mild soap. Water and a soft lint-free cloth. not use any chemical cleaning products. We only recommend the use of warm, mild soapy water and soft, lint-free cloth. Wipe up spills immediately. This will prevent them from setting in and causing damage. Dry the vanity thoroughly after cleaning.

This will help to prevent moisture damage. Avoid placing hot objects on the vanity. This could cause the finish to crack or warp. Do not expose vanity to direct sunlight or extreme temperatures. This could cause the finish to fade or crack.

WARRANTY

DAX products are manufactured and tested to the highest quality standards by DAX International Brokers Inc. ("DAX").

DAX extends this warranty to the original purchaser for personal household use. The warranty is non-transferable.

DAX warrants the structure and finish of the product to be free from defects in material and workmanship under normal usage for a period of one (1) year. The warranty commences from the date of purchase by the owner or trade professional, from an authorized DAX dealer.

Any product reported to the authorized dealer or to DAX as being defective within the warranty period will be repaired or replaced with a product of equal value at the option of DAX. This warranty extends to the original owner or end-user, and is not transferable to a subsequent owner.

RESTRICTIONS

This warranty does not cover discontinued or display products, whether such items are purchased at discount outlets, unauthorized dealers, and/or sold on clearance.

This warranty does not cover instances of negligence, misuse, abuse, improper installation, carelessness, accident, hard water or mineral deposits, exposure to corrosive materials, misapplication, damages caused by improper maintenance, alteration of the product, or failure to follow care or installation instructions enclosed with your product. Avoid using abrasive cleaners such as powders, bleach, ammonia, alcohol, or chlorine. Avoid using abrasive pads, steel wool, or wire brushes, as these will damage and wear down the finish.

This warranty does not apply to Products that have not been installed or operated in accordance with instructions supplied by DAX and all applicable rules, regulations, and legislation pertaining to such installations.

This warranty does not apply unless the DAX product is installed by a fully insured and licensed trade professional. DAX insists that such professionals have experience in the installation of bathroom and kitchen manufactured goods.

This warranty does not cover labor charges or costs of removal and reinstallation of said product. This warranty does not allow recovery of incidental or consequential damages such as loss of use, delay, property damage, or other consequential damages, and DAX accepts no liability for such damages.

This warranty does not cover Marine or Outdoor Installation. Except as otherwise provided above, DAX makes no warranties, expressed or implied, including warranties of merchantability and fitness for a particular purpose, or compliance with any code.

Shipping and Handling charges will be covered for the first (1) year of the warranted replacement part or product. International shipping fees are not included.