

# PRODUCT MANUAL

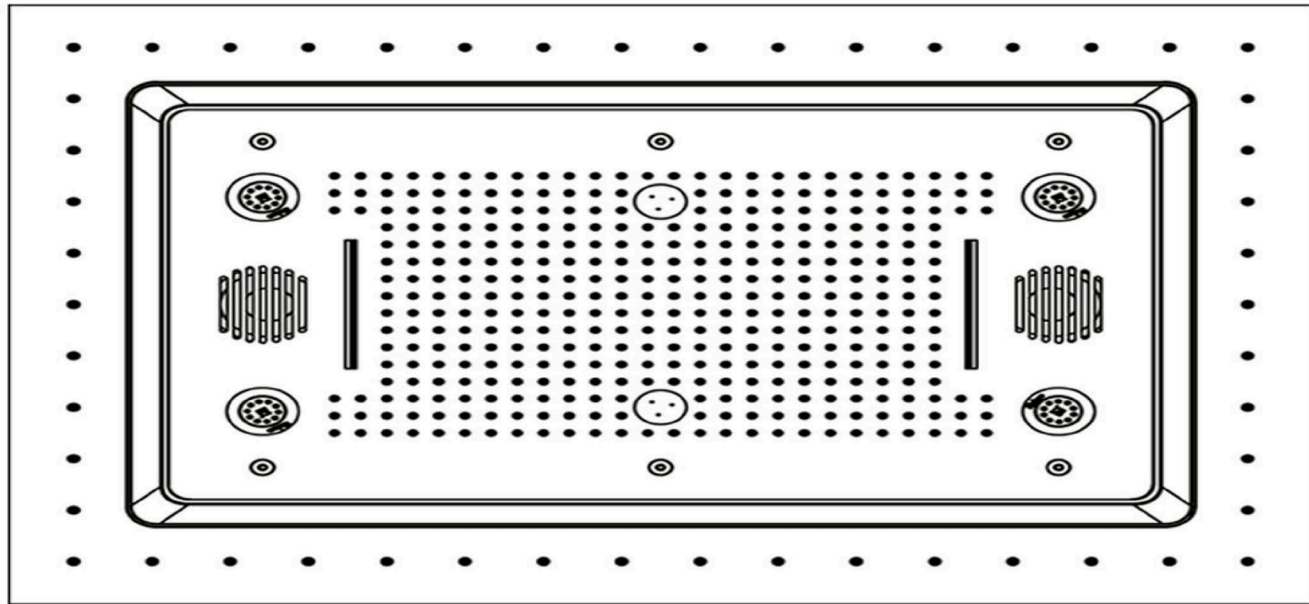

# 01 / PRODUCT

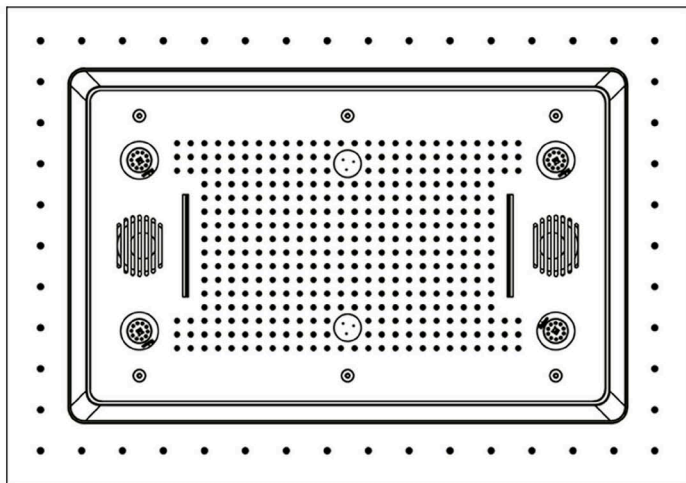

## COLOR PANEL OF CHROMOTHERAPY

1	Gradual change of seven colors (Red,Green,Blue,White,Yellow, Light Blue,Purple)
2	Gradual change of White colors
3	Gradual change of Red,Green,Blue colors
4	Jump change of seven colors (Red,Green,Blue,White,Yellow, Light Blue,Purple)
5	Jump change of Red,Green,Blue colors
6	Gradual change of Red colors+jump change
7	Gradual change of Green colors+jump change
8	Gradual change of Blue colors+jump change

# 02 / TOOLS NOT INCLUDED

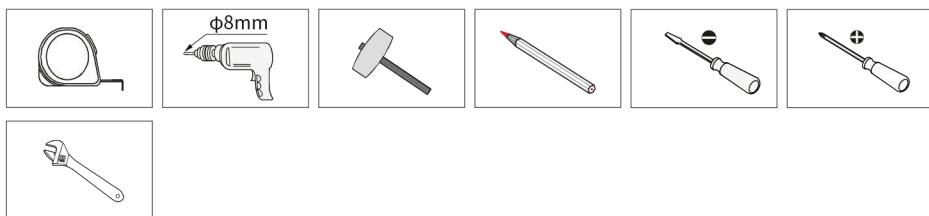

### ⚠ ATTENTION

Remote Control working voltage is DC12V and it can not work with AC voltage.

Remote Control works with nr.3batteries AAA(batteries of 12V 23A)

**IP67**   **CE**  **RoHS**

How to use

- |   |  |
|---|--|
| 1 | Press Key 1 to turn on/off   |
| 2 | Press Key 2 to enter single color changing mode(key 4 and 5 to choose the color;keys 6 and 7 to regulate color intensity)  |
| 3 | Press Key 3 once to activate color changing mode(key 4 and 5 to choose the sequence;keys 6 and 7 to increase or decrease speed of color sequence)  |
| 4 | Press Key 3 twice to activate bluetooth music modes(key 4 and 5 to choose music;keys 6 and 7 to increase or decrease music volume)   |
| 5 | <p>Matching code:</p> <ul style="list-style-type: none"> <li>- keep pressing key 2 and connect Shower Panel to power net. Light will blink 3 times if matching is successful.</li> <li>- keep pressing key 2 again and connect Shower Panel to power net. Light will blink 3 times if matching is released.</li> </ul> |

# 03/ SPARE PART LIST

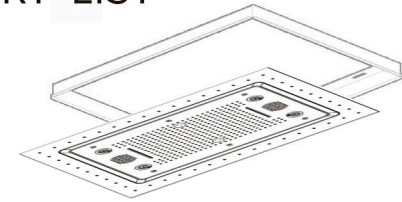

A(1PC)		E (5PC)		F (4PC)	
B(1PC)		G(8PC)		H(8PC)	
C(6PC)		I(1PC)		J(4PC)	
D(4PC)		K(1PC)		L(4PC)	
M(1PC)		N(1PC)		O(1PC)	

## 04/ DIMENSIONS

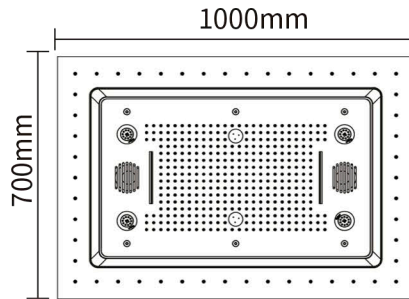

## 05/ INSTALLATION

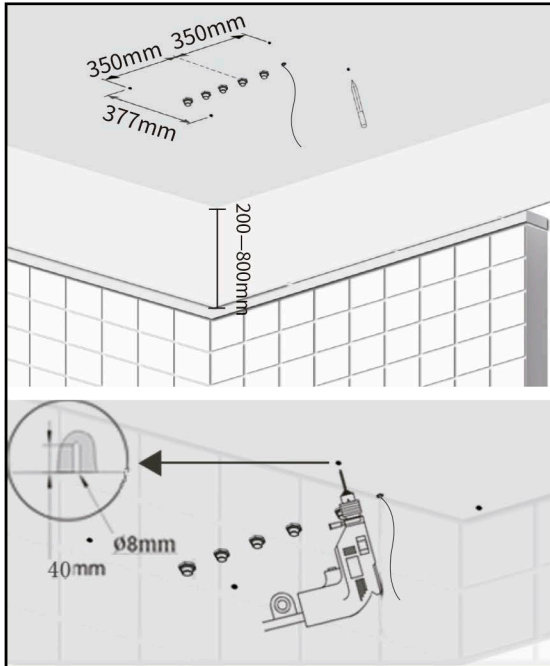

### Chart1

Embed the water pipelines accordingly in the ceiling. Draw and drill four  $\phi 8\text{mm}$  holes in the ceiling with distance of 200—800mm from the ceiling surface.

## 06/ REMOTE CONTROL USE GUIDE

**Working voltage :** DC12V/24V

**Control current :** 18A

**Total power :** 216W

**Receiving range :** 20M

**Connecting method :** common anode

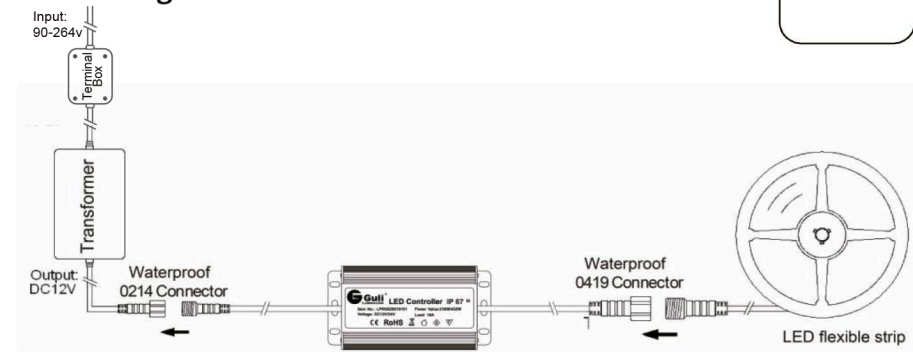
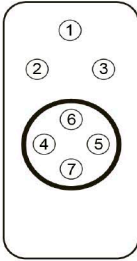

### CONNECTION FORM

Functions of Keys	
key 1	on/off
key 2	single colors mode
key 3	color changing mode/modalita bluetooth
key 4	color modes choice(backward)/music choice(backward)
key 5	color modes choice/music choice(backward)
key 6	brightness turn up/color changing mode turn up/music volume turn up
key 7	brightness turn down/color changing mode turn down/music volume turn down

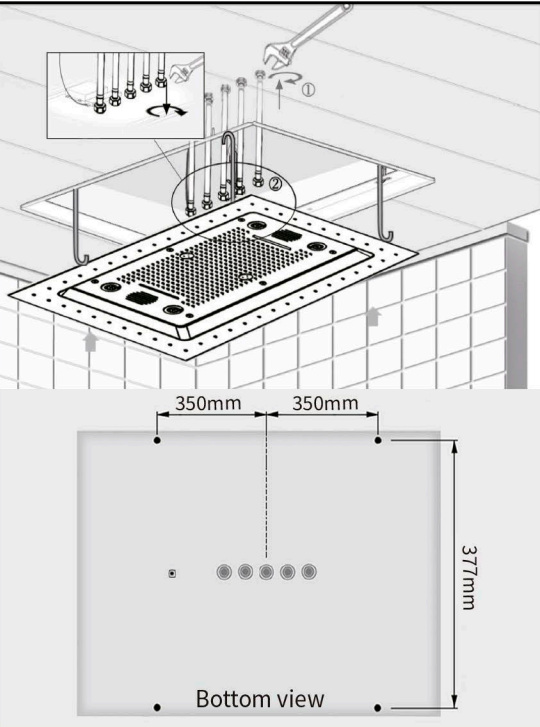

### Chart8

Use the temporary hooks (part K) to hold the weight of top shower.  
 Accurate connect the pipelines with the connectors on the back side of top shower.  
 Release the hooks after pipelines are connected.

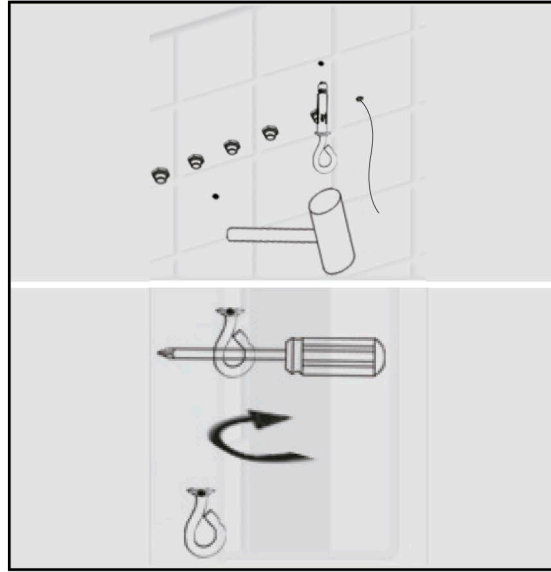

### Chart2

Insert the metal expansion screw (part D) and turn clockwise.

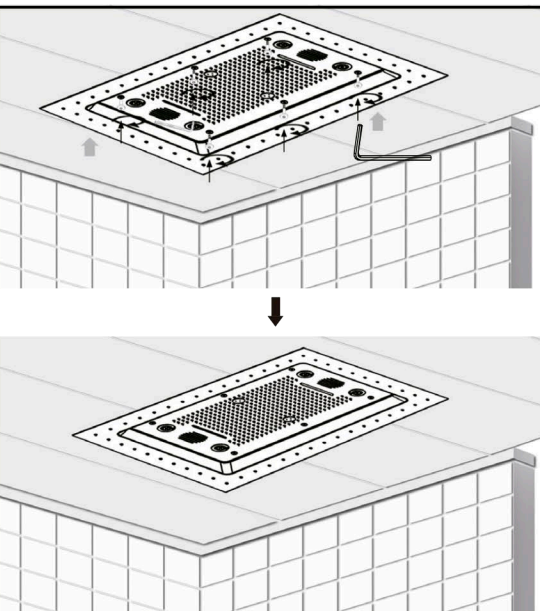

### Chart9

Fix the top shower and the installation frame with long screws (part C) provided.

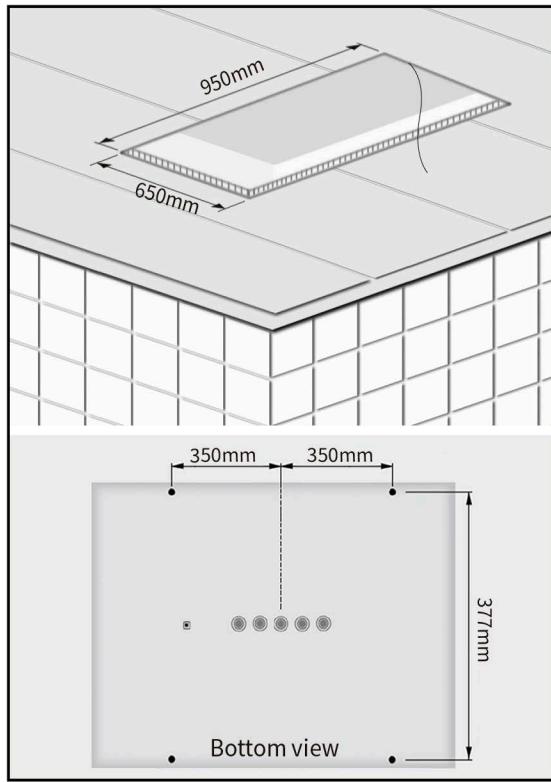

### Chart3

Create a slot on the ceiling with size of 950X650mm. (Please double check the size with real product.)

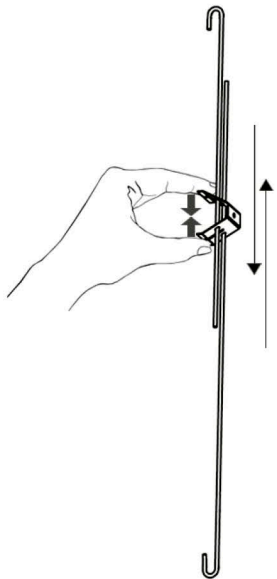

### Chart4

Hook the expansion links with expansion screws (part D).

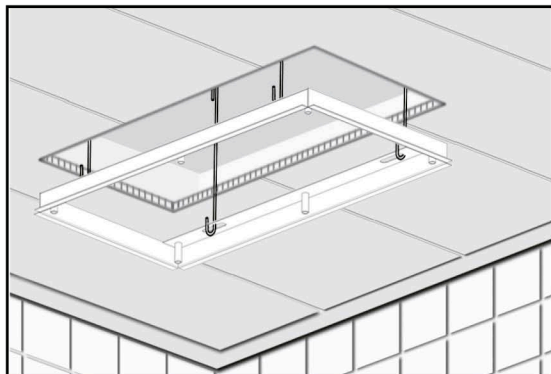
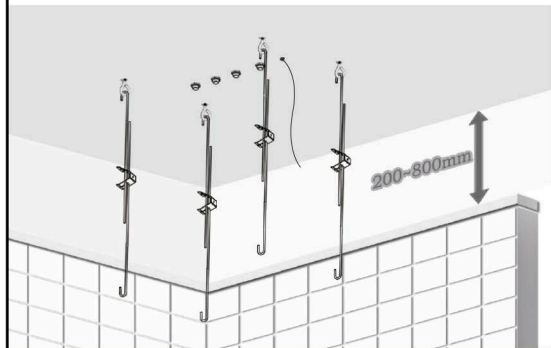

### Chart5

Put the installation frame on the expansion links and adjust the length accordingly.

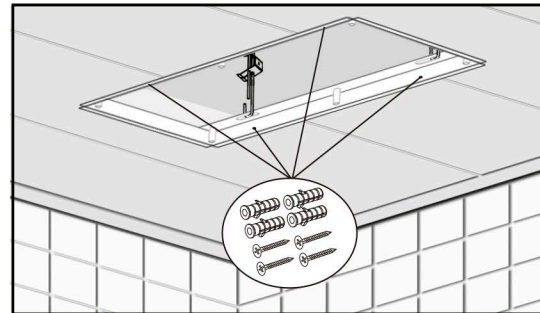

### Chart6

Screw around the installation frame. Make sure the frame is at the same line with the ceiling.



### Chart7

Flush the water supply lines thoroughly to drain debris and impurities. Shut off the water before installation.