

# Instruction Manual

## ZeroLemon Slim Power 5000mAh Battery Case for Samsung Galaxy S10 / S10 PLUS



### User Manual

Thank you for purchasing our product. For optimal performance and safety, please read these instructions carefully before operating the product. Please keep this manual for future reference.

### Specifications

Battery Capacity		5000mAh
Battery Type		Lithium Polymer
Input		DC 5V-1.8A
Output		DC 5V-1.5A
Galaxy S10	Dimensions	6.09×2.95×0.77 inches
	Weight	4.33 oz
Galaxy S10 PLUS	Dimensions	6.38×3.00×0.76 inches
	Weight	4.65 oz

### Features

- Designed for Samsung Galaxy S10 / S10 PLUS.
- Provide extra battery life.
- Strong & durable construction to protect Phone against bumps, dents and scratches.
- Protective IC circuit efficiently prevents short circuits, over charging and malfunction, even under extreme conditions.

### Installation:

1. Bend the top of the case and put the phone in the case.
2. Slide the phone into the case.
3. Ensure the charging connector port is secured to connector jack.

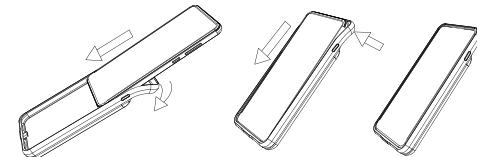

### Disassembly:

1. Bend the soft plastic top as pictured.
2. Slide out the phone parallel to the case.

Caution: Do NOT take the phone out the case at a big angle to avoid the damage to the connector and the phone port.

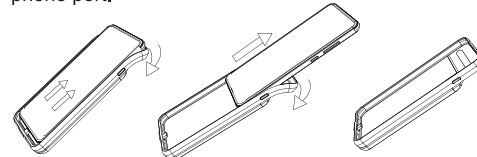

### Charging the battery case and your phone

- Connect your battery case (Phone already installed) to the power cable.
- Connect the power cable to any power source to start charging. The battery case is programmed to charge the phone first, then the battery case will be charged.
- Charge until the LED indicators indicate fully charged (all 4 LEDs are solid).

### Charging your phone using the battery case

- Press the power button once to turn on the battery case and charging starts. The phone will be charged continuously if you don't turn off the battery case.
- Press and hold the power button for 3 seconds to deactivate the battery case and stop charging.

### Package Contents

- 1 x 5000mAh Battery Case
- 1 x User Manual
- 1 x Warranty Card

### How to Test the Remaining Power

#### Charging Indicator Status

POWER	LED1#	LED2#	LED3#	LED4#
75% ~ 100%	●	●	●	●/●
50% ~ 75%	●	●	●	●
25% ~ 50%	●	●	●	○
1% ~ 25%	●	●	○	○
0%	●	○	○	○

● – On   ● – Blink   ○ – Off

#### Discharge Indicator Status

POWER	LED1#	LED2#	LED3#	LED4#
75% ~ 100%	●	●	●	●/●
50% ~ 75%	●	●	●	●
25% ~ 50%	●	●	●	○
1% ~ 25%	●	●	○	○
0%	●	○	○	○

● – On   ● – Blink   ○ – Off

Note: When the battery case is charging the phone, the LED lights will turn off. To check the remaining power, please press the power button once.

### Warning

- Read all instructions and warnings first before using this product. Improper use may result in product damage, excess heat, toxic fumes, fire or explosion. For such damages you (the Purchaser) and not the Manufacturer are responsible.
- Do not store this battery case in a high temperature environment, including in directly exposure to sunlight.
- Do not place battery case into a fire or other excessively hot environment.
- Be cautious of excessive drops, bumps, abrasions, or other impacts to this battery. If there is any damage to the battery such as dents, punctures, tears, deformities, or corrosion due to any cause, discontinue use, contact manufacturer or dispose of it in an appropriate manner at your local battery-recycling center.
- Do not disassemble this battery case or attempt to re-purpose or modify it in any manner.
- Do not expose this battery case to moisture or submerge it in liquid. Keep battery dry all the time.

- Do not attempt to charge battery case using any method, apparatus, or connection other than the device's USB connector.
- Do not attempt to replace any part of this battery.
- If the battery case is intended by Purchaser to be used by a minor, purchasing adult agrees to provide detailed instructions and warnings to any minor first before using. Failure to do so is sole responsibility of purchaser, who agrees to indemnify manufacturer for any unintended use/misuse by minor.
- All battery cases have gone through a thorough quality assurance inspection.
- If you find your battery is excessively hot, emitting, odor, deformed, abraded, cut or experiencing an abnormal phenomenon, stop using the battery immediately and contact Manufacturer.
- For extended storage, firstly charge your battery case for one hour.
- Never dispose the battery case in the garbage, which is unlawful under state and federal environment laws and regulations.

- Always take used batteries to your battery-recycling center.
- Warranty**  
This product is covered by a warranty of 365 days from the date of purchase.

### Contact US

- For any inquiries or comments concerning our products, please send an e-mail to [info@zerolemon.com](mailto:info@zerolemon.com) or call us at 1-415-685-4343, and we will respond to you as soon as possible.
- If there is any quality-related issue with the product, you may request a replacement or refund by submitting a request form at <https://zerolemon.com/pages/support>

### Statement

- We are only able to provide after-sales service for purchases made directly from ZeroLemonOfficial or our authorized resellers. If you purchased through an unauthorized retailer, please contact them for any exchange or refund requests.
- Please note that unauthorized reselling of ZeroLemon products is prohibited.

### Subscribe for more deals and news!



Sales Inquiry: [sales@zerolemon.com](mailto:sales@zerolemon.com)

Made in China

Copyright 2019 ZeroLemon, LLC All Rights Reserved

All names, brands, logos and/or trademarks used in this publication are property of their respective owners.

[www.zerolemon.com](http://www.zerolemon.com)