

Instruction Manual

ZeroLemon MagJuice+ 10000mAh
Magnetic Portable Charger



10000mAh Magnetic Portable Charger



User Manual

Thank you for purchasing our product. To ensure optimal performance and safety, please read the following instructions carefully before operating this product. Please keep this manual for future reference.

Functional Introduction

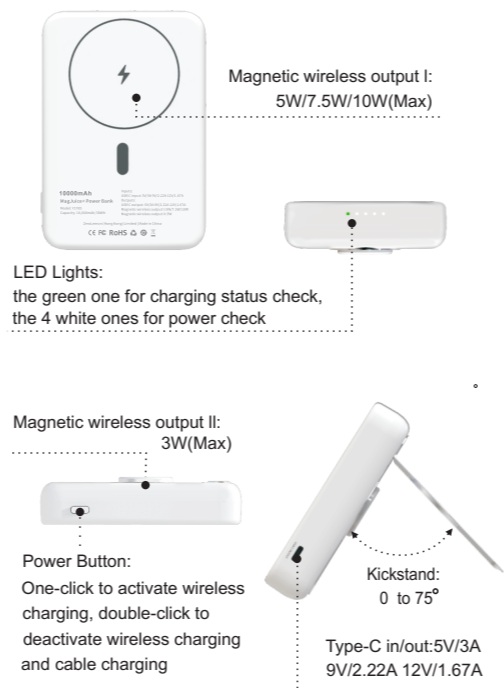

LED Lights:
the green one for charging status check,
the 4 white ones for power check

Magnetic wireless output II:
3W(Max)

Power Button:
One-click to activate wireless charging,
double-click to deactivate wireless charging
and cable charging

Kickstand:
0 to 75°

Type-C in/out:5V/3A
9V/2.22A 12V/1.67A

Product Features:

- 10000mAh Capacity: a full charge to iPhone 14 Pro Max and Apple Watch S8
- Charging pass through the magnetic portable charger
- 20W Input and output: fast charging and recharging
- Charge 3 devices simultaneously: two wireless charging and one cable charging
- Smart white LED display shows remaining power, green LED display shows charging status

Specifications

- Battery Type: Li-ion Battery
- Capacity: 10000mAh/38Wh
- Inputs:
Type-C Input: 5V/3A 9V/2.22A 12V/1.67A
- Outputs:
Type-C output 5V/3A 9V/2.22A 12V/1.67A
Magnetic wireless output I: 5W/7.5W/10W(Max)
Magnetic wireless output II: 3W(Max)
- Weight:7.98oz/226.1g
- Product Dimension: 4.25*2.91*0.88 inches

How to Charge Your Devices?

- 1.Charge your devices with a Cable:for cable charging, any connected devices will be automatically charged. DOUBLE click the power button to deactivate cable charging.
- 2.Charge your Devices Wirelessly: click the power button ONCE to activate the wireless charging mode, put your device on the wireless charging pad, and charging starts. DOUBLE click the power button to deactivate the wireless charging.

How to Charge the Magnetic Portable Charger

- 1.For optimal performance and use safety, use the official 20W USB C adapter and the USB C to C cable coming with this product to recharge. Other adapters, like the 18W ones and USB A to C cables, may cause slow charging.
- 2.It takes about 3-3.5 hours to fully charge the magnetic portable charger when using a 20W USB C PD charger and the USB C to C cable to charge it.

3.The white LED indicator will flash and the green LED indicator will be on when the magnetic portable charger is being recharged. When all the LED lights are fully lit (no longer flashing), the product is fully charged. To avoid overcharging, stop charging once the LEDs are fully lit.

How to Read the Remaining Power?

● ON ○ FLASH ○ OFF ● GREEN

Power	LED Light Status
100%	● ● ● ● ●
75%-100%	● ● ● ○ ●
50%-75%	● ● ○ ○ ●
25%-50%	● ○ ○ ○ ●
0%-25%	○ ○ ○ ○ ●

How to Deal with the Heating Problem?

- Use the product to ONLY wirelessly charge iPhone 12/13/14 series and Apple Watches. Other phones, especially Galaxy phones may cause overheating issues from the wireless charging.
- Make sure the case on the iPhone is MagSafe compatible. If not, take the case off before wirelessly charging.
- It is normal that you feel some heat on your iPhone and the product during the wireless charging process. When the phone hits 80% power, the heat will dissipate gradually.
- If you feel the phone or the product is too hot, stop using the product and contact the manufacturer or the seller.

Caution:

- Read all instructions and warnings first before using this product. Improper use may result in product damage, excess heat, toxic fumes, fire, or explosion. For such damages, you(the purchaser) and not the manufacturer are responsible.
- Do not store the battery in a high-temperature environment, including indirect exposure to sunlight, or a car under the sun.

- Do not place the battery into a fire or other excessively hot environment.
- Be cautious of excessive drops, bumps, abrasions, or other impacts to this battery. If there is any damage to the battery, such as dents punctures, tears, deformities, or corrosion due to any cause discontinue use, contact the manufacturer or dispose of it in an appropriate manner at your local battery -recycling center.
- Do not disassemble the battery and do not attempt to re-purpose or modify it in any manner.
- Do not expose this battery to moisture or submerge it in liquid. Keep the battery dry all the time.
- Do not attempt to replace any part of this battery.
- Keep the battery away from metallic objects
- Keep the battery out of the reach of children.
- If you find your battery is excessively hot emitting, odor, deformed, abraded, cut, or experiencing an abnormal phenomenon, stop using the battery immediately and contact the manufacturer
- Never dispose of the battery in the garbage, which is unlawful under state and federal environmental laws and regulations.
- Always take used batteries to your battery-recycling center.

Package Contents

- 1 x User Manual
- 1 x User C to C Charging Cable
- 1 x 10000mAh magnetic portable charger

Warranty

This product is covered by a warranty of 12 months from the date of purchase.

Contact US

- Customer satisfaction is always our #1 priority. We promise to deliver only the best quality products and offer 100% customer satisfaction.
- For any inquiries or comments concerning our products, please send an e-mail to info@zerolemon.com, and we will reply to you as soon as possible.
- If there is any quality-related issue with the product, you may request a replacement or a refund by submitting a request at <https://zerolemon.com/pages/support>

Statement:

- We are only able to provide an after-sales service for purchases made directly from ZeroLemonOfficial or our authorized retailers. If you purchase through an unauthorized retailer, please contact them for any exchange or refund request.
- Please note that unauthorized reselling of ZeroLemon products is prohibited.

Subscribe to us



Sales Inquiry: info@zerolemon.com

Designed by ZeroLemon,LLC in the USA

Made in China

Copyright 2023 ZeroLemon, LLC All Rights Reserved.

All names, brands, logos, and/or trademarks used in this publication are the property of their respective owners.

www.zerolemon.com